

**Instructions**

- A. Please type or print using black ink.
- B. Form must be signed by former operator and new operator.
- C. Outline boundaries of lease and spot well being transferred.
- D. Attach 1002A for well.
- E. Questions should be directed to Well Records (405) 521-2275.

**OKLAHOMA CORPORATION COMMISSION**

Oil & Gas Conservation Division  
 Post Office Box 52000-2000  
 Oklahoma City, OK 73152-2000

**101220605**

Form 1073  
 Rev. 1996

**Transfer of Operator**  
 OAC 165:10-1-15

API No. <b>35-063-01497</b>		OTC Prod. Unit No. <b>063-28625</b>	
Location <b>1/4 NW 1/4 NE 1/4 NW 1/4</b>		Sec. <b>12</b>	Twp. <b>8N</b> Rge. <b>8E</b>
Ft FSL of Qtr Sec <b>2310</b>		Ft FWL of Qtr Sec <b>1,750</b>	
Current Well Name/No. <b>Buchner # 1</b>		County <b>Hughes</b>	
Original Well Name/No. <b>Buchner # 1</b>			
Unit Name (if applicable)			

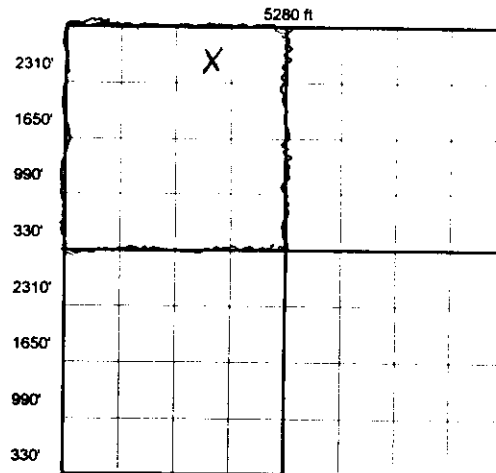

Locate Well On Grid Above

Well Class:  Oil  Gas  Dry  Plugged

Producing formation(s) <b>Cromwell</b>	
Oil Transporter/Purchaser <b>Sunoco (R+M)</b>	OTC No. <b>15234</b>
Gas Measurer <b>Duke Energy</b>	OTC No. <b>16132</b>

The effective date of transfer of this well for the purposes of Commission records, is the date the transfer is approved by the Commission.

**CURRENT OPERATOR**

Name <b>William Glenn Cook</b>		OCC No. <b>04442</b>
Address <b>P.O. Box 727</b>		
City <b>Wewoka</b>	State <b>Okla.</b>	Zip <b>74884</b>
Phone No. <b>405-257-2594</b>	FAX No. <b>—</b>	
I verify that I am the legal operator of record with authority to transfer operatorship of this well.		
Signature <b>William Glenn Cook</b>		
Name & Title (Typed or Printed) <b>William Glenn Cook - operator</b>		
Signed and sworn to before me this <b>17<sup>th</sup></b> day of <b>JANUARY</b> , 2001		
Notary Public <b>Shirley S. Reil</b>		
My commission expires: <b>June 13, 2004</b>		

**NEW OPERATOR**

Name <b>Glenco Oil &amp; Gas Corp.</b>		OCC No. <b>20762-0</b>
Address <b>P.O. Box 727</b>		
City <b>Wewoka</b>	State <b>Okla.</b>	Zip <b>74884</b>
Phone No. <b>405-257-2594</b>	FAX No. <b>—</b>	
Being the new operator, as of the effective date and time of transfer accept the facts presented as being true and correct and accept the operational responsibility for the well on the described property.		
Signature <b>William Glenn Cook</b>		
Name & Title (Typed or Printed) <b>William Glenn Cook - President</b>		
Signed and sworn to before me this <b>17<sup>th</sup></b> day of <b>JANUARY</b> , 2001		
Notary Public <b>Shirley S. Reil</b>		
My commission expires: <b>June 13, 2004</b>		

I verify under oath that I have exercised due diligence in attempting to locate the current operator of record according to OCC records, who has abandoned the above well/lease and cannot be located to obtain signature. I have attached a copy of the certified recorded assignment of lease.

**Amended well location**

Signature \_\_\_\_\_

Signed and sworn to before me this \_\_\_\_\_ day of \_\_\_\_\_

My commission expires: \_\_\_\_\_

Notary Public

**FOR OCC USE ONLY**

Surety Dept.  Approved  Rejected Date **FEB 20 2001**

Well Records Dept.  Approved  Rejected Date **FEB 23 2001**

**NOTE:** By processing this Form 1073, the Oklahoma Corporation Commission has approved the contents thereof as to form only. Oklahoma Corporation Commission does not warrant that the facts provided by the operator are true. Form is not approved until approved by Well Records.

**WDMS**