

Oklahoma Corporation Commission  
 Oil & Gas Conservation Division  
 Post Office Box 52000  
 Oklahoma City, Oklahoma 73152-2000  
 Rule 165: 10-3-25

Form 1002A

API No.: 35051245850000

**Completion Report**

Spud Date: March 17, 2019

OTC Prod. Unit No.: 051-226459-0-0000

Drilling Finished Date: May 02, 2019

1st Prod Date: December 02, 2019

Completion Date: December 02, 2019

**Drill Type: HORIZONTAL HOLE**

Well Name: DALE 5-13X12H

Purchaser/Measurer:

Location: GRADY 13 4N 6W  
 NE SW SW SE  
 450 FSL 2213 FEL of 1/4 SEC  
 Latitude: 34.81335588 Longitude: -97.7806369  
 Derrick Elevation: 0 Ground Elevation: 1201

First Sales Date:

Operator: GULFPORT MIDCON LLC 24020

3001 QUAIL SPRINGS PKWY  
 OKLAHOMA CITY, OK 73134-2640

Completion Type	
X	Single Zone
	Multiple Zone
	Commingled

Location Exception	
Order No	
686859	

Increased Density	
Order No	
684886	
686669	

Casing and Cement							
Type	Size	Weight	Grade	Feet	PSI	SAX	Top of CMT
CONDUCTOR	30	148#	SEAMPIPE	128			
SURFACE	13 3/8	68#	J-55	1520		865	SURFACE
INTERMEDIATE	9 5/8	40#	P110HC	13112		1080	7113
PRODUCTION	5 1/2	23#	P110CY	25734		2840	9646

Liner								
Type	Size	Weight	Grade	Length	PSI	SAX	Top Depth	Bottom Depth
There are no Liner records to display.								

**Total Depth: 25734**

Packer	
Depth	Brand & Type
There are no Packer records to display.	

Plug	
Depth	Plug Type
There are no Plug records to display.	

Initial Test Data

Test Date	Formation	Oil BBL/Day	Oil-Gravity (API)	Gas MCF/Day	Gas-Oil Ratio Cu FT/BBL	Water BBL/Day	Pumpin or Flowing	Initial Shut-In Pressure	Choke Size	Flow Tubing Pressure
Dec 16, 2019	WOODFORD	854	56.8	7248	8487	3151	FLOWING	2368	38/64	

**Completion and Test Data by Producing Formation**

Formation Name: WOODFORD

Code: 319WDFD

Class: OIL

**Spacing Orders**

Order No	Unit Size
636625	640
676366	640 NPT
134400	640
686858	MULTIUNIT

**Perforated Intervals**

From	To
15529	25673

**Acid Volumes**

2,105 BBLS ACID

**Fracture Treatments**

458,062 BBLS WATER & 24,280,134 LBS SAND

Formation	Top
WOODFORD	15242

Were open hole logs run? No

Date last log run:

Were unusual drilling circumstances encountered? No

Explanation:

**Other Remarks**

OCC - THIS DOCUMENT IS ACCEPTED BASED ON THE DATA SUBMITTED NEITHER THE FINAL LOCATION EXCEPTION NOR THE FINAL MULTIUNIT ORDERS HAVE BEEN ISSUED.

**Lateral Holes**

Sec: 12 TWP: 4N RGE: 6W County: GRADY

NE NW NW NE

208 FNL 2253 FEL of 1/4 SEC

Depth of Deviation: 14902 Radius of Turn: 382 Direction: 360 Total Length: 10832

Measured Total Depth: 25734 True Vertical Depth: 14902 End Pt. Location From Release, Unit or Property Line: 208

**FOR COMMISSION USE ONLY**

1144400

Status: Accepted

**RECEIVED**  
**JAN 21 2020**  
**Oklahoma Corporation**  
**Commission**

API NO. 05124585  
 OTC PROD. UNIT NO. 051226459

(PLEASE TYPE OR USE BLACK INK ONLY)

OKLAHOMA CORPORATION COMMISSION  
 Oil & Gas Conservation Division  
 Post Office Box 52000  
 Oklahoma City, Oklahoma 73152-2000  
 Rule 165:10-3-25

ORIGINAL  
 AMENDED (Reason)

COMPLETION REPORT

TYPE OF DRILLING OPERATION

STRAIGHT HOLE  DIRECTIONAL HOLE  HORIZONTAL HOLE  
 SERVICE WELL

If directional or horizontal, see reverse for bottom hole location.

COUNTY	GRADY	SEC	13	TWP	4N	RGE	6W	SPUD DATE	3/17/2019
LEASE NAME	DALE	WELL NO.	5-13X12H	DRLG FINISHED DATE	5/2/2019	DATE OF WELL COMPLETION	12/2/2019	1st PROD DATE	12/2/2019
NE 1/4 SW 1/4 SW 1/4 SE 1/4	FSL OF 1/4 SEC	450	FWL OF 1/4 SEC	2213	RECOMP DATE				
ELEVATION Derrick FL	Ground	1201	Latitude (if known)	34.813355	Longitude (if known)	-97.780637			
OPERATOR NAME	GULFPORT MIDCON LLC			OTC / OCC OPERATOR NO.	24020				
ADDRESS	3001 QUAIL SPRINGS PARKWAY								
CITY	OKLAHOMA CITY	STATE	OK	ZIP	73134				

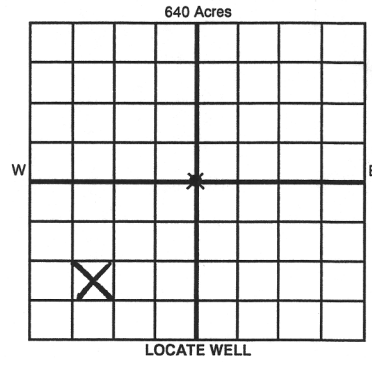

COMPLETION TYPE

<input checked="" type="checkbox"/> SINGLE ZONE	
<input type="checkbox"/> MULTIPLE ZONE	
Application Date	
<input type="checkbox"/> COMMINGLED	
Application Date	
LOCATION EXCEPTION ORDER NO.	686859
INCREASED DENSITY ORDER NO.	684886/686669

CASING & CEMENT (Attach Form 1002C)

TYPE	SIZE	WEIGHT	GRADE	FEET	PSI	SAX	TOP OF CMT	
CONDUCTOR	30	148#	SEAMPLE	128				
SURFACE		68#	J-55	1,520		865	SURFACE	
INTERMEDIATE	9 5/8	40#	PIHC	13,112		1,080	7,113	
PRODUCTION	5 1/2	23#	PIHCY	25,734		2,840	9,646	
LINER								
							TOTAL DEPTH	25,734

PACKER @ \_\_\_\_\_ BRAND & TYPE \_\_\_\_\_ PLUG @ \_\_\_\_\_ TYPE \_\_\_\_\_ PLUG @ \_\_\_\_\_ TYPE \_\_\_\_\_  
 PACKER @ \_\_\_\_\_ BRAND & TYPE \_\_\_\_\_ PLUG @ \_\_\_\_\_ TYPE \_\_\_\_\_ PLUG @ \_\_\_\_\_ TYPE \_\_\_\_\_

COMPLETION & TEST DATA BY PRODUCING FORMATION

FORMATION	WOODFORD					
SPACING & SPACING ORDER NUMBER	134400 (640)	686858 (MU)				
CLASS: Oil, Gas, Dry, Inj, Disp, Comm Disp, Svc	OIL					
PERFORATED INTERVALS	15,529-25,673					
ACID/VOLUME	2,105 bbls acid					
FRACTURE TREATMENT (Fluids/Prop Amounts)	24,280,134 lbs Sand 458,062 bbls Water					

Min Gas Allowable (165:10-17-7) OR Gas Purchaser/Measurer First Sales Date \_\_\_\_\_  
 Oil Allowable (165:10-13-3)

INITIAL TEST DATA

INITIAL TEST DATE	12/16/2019			
OIL-BBL/DAY	854			
OIL-GRAVITY (API)	56.8			
GAS-MCF/DAY	7248			
GAS-OIL RATIO CU FT/BBL	8487			
WATER-BBL/DAY	3151			
PUMPING OR FLOWING	FLOWING			
INITIAL SHUT-IN PRESSURE	2368			
CHOKE SIZE	38/64			
FLOW TUBING PRESSURE	N/A			

**AS SUBMITTED**

A record of the formations drilled through, and pertinent remarks are presented on the reverse. I declare that I have knowledge of the contents of this report and am authorized by my organization to make this report, which was prepared by me or under my supervision and direction, with the data and facts stated herein to be true, correct, and complete to the best of my knowledge and belief.

*Monica Pickens*  
 SIGNATURE MONICA PICKENS 1/20/2019 405-252-4703  
 NAME (PRINT OR TYPE) DATE PHONE NUMBER  
 3001 QUAIL SPRINGS PARKWAY OKC OK 73134  
 ADDRESS CITY STATE ZIP mpickens@gulfportenergy.com  
 EMAIL ADDRESS

PLEASE TYPE OR USE BLACK INK ONLY  
FORMATION RECORD

Give formation names and tops, if available, or descriptions and thickness of formations drilled through. Show intervals cored or drillstem tested.

LEASE NAME \_\_\_\_\_ DALE \_\_\_\_\_ WELL NO. 5-13X12H

NAMES OF FORMATIONS	TOP
WOODFORD	15,242

FOR COMMISSION USE ONLY

ITD on file  YES  NO

APPROVED \_\_\_\_\_ DISAPPROVED \_\_\_\_\_

2) Reject Codes \_\_\_\_\_

Were open hole logs run?  yes  no

Date Last log was run \_\_\_\_\_

Was CO<sub>2</sub> encountered?  yes  no at what depths? \_\_\_\_\_

Was H<sub>2</sub>S encountered?  yes  no at what depths? \_\_\_\_\_

Were unusual drilling circumstances encountered?  yes  no  
If yes, briefly explain below \_\_\_\_\_

Other remarks: \_\_\_\_\_

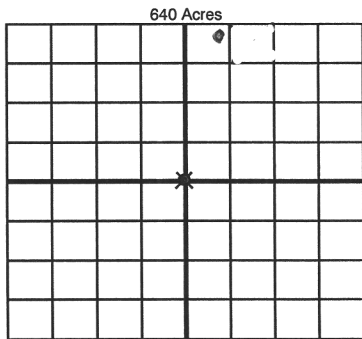

BOTTOM HOLE LOCATION FOR DIRECTIONAL HOLE

SEC	TWP	RGE	COUNTY			
Spot Location	1/4	1/4	1/4	Feet From 1/4 Sec Lines	FSL	FWL
Measured Total Depth	True Vertical Depth		BHL From Lease, Unit, or Property Line:			

BOTTOM HOLE LOCATION FOR HORIZONTAL HOLE: (LATERALS)

LATERAL #1

SEC	TWP	RGE	COUNTY								
12	04N	06W	GRADY								
Spot Location	NE 1/4	NE 1/4	NW 1/4	NE 1/4	Feet From 1/4 Sec Lines	FNL 208	FEL 2253				
Depth of Deviation	14,302		Radius of Turn	382		Direction	360-358°		Total Length	10,832	
Measured Total Depth	25,734		True Vertical Depth		14,902		BHL From Lease, Unit, or Property Line: 208				

If more than three drainholes are proposed, attach a separate sheet indicating the necessary information.

Direction must be stated in degrees azimuth. Please note, the horizontal drainhole and its end point must be located within the boundaries of the lease or spacing unit.

Directional surveys are required for all drainholes and directional wells.

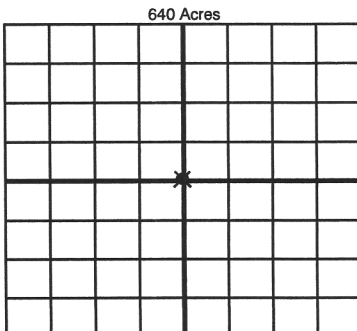

LATERAL #2

SEC	TWP	RGE	COUNTY				
Spot Location	1/4	1/4	1/4	1/4	Feet From 1/4 Sec Lines	FSL	FWL
Depth of Deviation	Radius of Turn		Direction		Total Length		
Measured Total Depth	True Vertical Depth		BHL From Lease, Unit, or Property Line:				

LATERAL #3

SEC	TWP	RGE	COUNTY				
Spot Location	1/4	1/4	1/4	1/4	Feet From 1/4 Sec Lines	FSL	FWL
Depth of Deviation	Radius of Turn		Direction		Total Length		
Measured Total Depth	True Vertical Depth		BHL From Lease, Unit, or Property Line:				