

Oklahoma Corporation Commission
Oil & Gas Conservation Division
Post Office Box 52000
Oklahoma City, Oklahoma 73152-2000
Rule 165: 10-3-25

Form 1002A

API No.: 35051244130001

Completion Report

Spud Date: October 02, 2018

OTC Prod. Unit No.: 051-225400-0-0000

Drilling Finished Date: November 08, 2018

Amended

1st Prod Date: April 13, 2019

Amend Reason: CHANGE SURFACE HOLE LOCATION AND BOTTOM HOLE LOCATION

Completion Date: April 13, 2019

Drill Type: HORIZONTAL HOLE

Well Name: JEANNIE 6-27X34H

Purchaser/Measurer:

Location: GRADY 27 5N 6W
NW SW NW SE
1879 FSL 2361 FEL of 1/4 SEC
Latitude: 34.8746828 Longitude: -97.8191631
Derrick Elevation: 0 Ground Elevation: 1148

First Sales Date:

Operator: GULFPORT MIDCON LLC 24020

3001 QUAIL SPRINGS PKWY
OKLAHOMA CITY, OK 73134-2640

Completion Type	
X	Single Zone
	Multiple Zone
	Commingled

Location Exception	
Order No	
702551	

Increased Density	
Order No	
680412	
680413	

Casing and Cement							
Type	Size	Weight	Grade	Feet	PSI	SAX	Top of CMT
CONDUCTOR	30			128			
SURFACE	13 3/8		J-55	1514		880	SURFACE
INTERMEDIATE	9 5/8		P-110	12732		985	8752
PRODUCTION	5 1/2		P-110HC	21885		1895	11469

Liner								
Type	Size	Weight	Grade	Length	PSI	SAX	Top Depth	Bottom Depth
There are no Liner records to display.								

Total Depth: 21890

Packer	
Depth	Brand & Type
There are no Packer records to display.	

Plug	
Depth	Plug Type
There are no Plug records to display.	

Initial Test Data

Test Date	Formation	Oil BBL/Day	Oil-Gravity (API)	Gas MCF/Day	Gas-Oil Ratio Cu FT/BBL	Water BBL/Day	Pumpin or Flowing	Initial Shut-In Pressure	Choke Size	Flow Tubing Pressure
May 01, 2019	WOODFORD	631	59	13781	21839	4718	FLOWING	4073	32/64	

Completion and Test Data by Producing Formation

Formation Name: WOODFORD

Code: 319WDFD

Class: GAS

Spacing Orders

Order No	Unit Size
458941	640
701831	MULTIUNIT

Perforated Intervals

From	To
15336	21740

Acid Volumes

984 GALLONS ACID

Fracture Treatments

281,611 BARRELS WATER, 14,118,104 POUNDS SAND

Formation	Top
WOODFORD	14890

Were open hole logs run? No

Date last log run:

Were unusual drilling circumstances encountered? No

Explanation:

Other Remarks

There are no Other Remarks.

Lateral Holes

Sec: 34 TWP: 5N RGE: 6W County: GRADY

SE SW SE

89 FSL 1631 FEL of 1/4 SEC

Depth of Deviation: 14622 Radius of Turn: 768 Direction: 170 Total Length: 6404

Measured Total Depth: 21890 True Vertical Depth: 15222 End Pt. Location From Release, Unit or Property Line: 150

FOR COMMISSION USE ONLY

1144256

Status: Accepted

API NO. 051-24413
OTC PROD.
UNIT NO. 051-225400-0-0000

(PLEASE TYPE OR USE BLACK INK ONLY)

OKLAHOMA CORPORATION COMMISSION
Oil & Gas Conservation Division
Post Office Box 52000
Oklahoma City, Oklahoma 73152-2000
Rule 165:10-3-25

RECEIVED

AUG 29 2019

Form 1002A
Rev. 2009

ORIGINAL
AMENDED (Reason)

Change SHL, BHL

TYPE OF DRILLING OPERATION

☐ STRAIGHT HOLE ☐ DIRECTIONAL HOLE ☒ HORIZONTAL HOLE

If directional or horizontal, see reverse for bottom hole location.

COUNTY	Grady	SEC	27	TWP	5N	RGE	6W
LEASE NAME	Jeannie			WELL NO.	6-27X34H		
NW 1/4 SW 1/4 NW 1/4 SE 1/4	FSL OF 1/4 SEC 1879			FEL OF 1/4 SEC	2361		
ELEVATION	Ground	1148	Latitude (if known)	34.8746628			Longitude (if known)
OPERATOR NAME	Gulfport MidCon LLC			OTC / OCC OPERATOR NO.	24020		
ADDRESS	3001 Quail Springs Parkway						
CITY	Oklahoma City	STATE	OK	ZIP	73134		

SPUD DATE 10/2/2018

DRLG FINISHED DATE 11/8/2018

DATE OF WELL COMPLETION 4/13/2019

1st PROD DATE 4/13/2019

RECOMP DATE

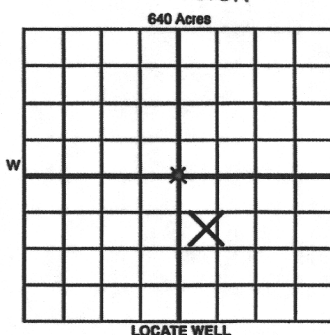

COMPLETION TYPE

<input checked="" type="checkbox"/> SINGLE ZONE	
<input type="checkbox"/> MULTIPLE ZONE	
Application Date	FO
COMINGLED	
Application Date	702551
LOCATION EXCEPTION ORDER NO.	689485
INCREASED DENSITY ORDER NO.	680412/680413

CASING & CEMENT (Attach Form 1002C)

TYPE	SIZE	WEIGHT	GRADE	FEET	PSI	SAX	TOP OF CMT
CONDUCTOR	30			128			
SURFACE	13 3/8		J55	1514		880	Surface
INTERMEDIATE	9 5/8		P110	12,732		985	8,752
PRODUCTION	5 1/2		P110HC	21,885		1,895	11,469
LINER							
						TOTAL DEPTH	21,890

PACKER @ BRAND & TYPE

PACKER @ BRAND & TYPE

PLUG @

PLUG @

TYPE

TYPE

PLUG @

PLUG @

TYPE

TYPE

TOTAL DEPTH

COMPLETION & TEST DATA BY PRODUCING FORMATION

FORMATION	Woodford	Woodford				
SPACING & SPACING ORDER NUMBER	640/#456941	MU#684981	701831 F.O.			
CLASS: Oil, Gas, Dry, Inj, Disp, Comm Disp, Svc	Gas					
PERFORATED INTERVALS	15,336-21,740					
ACID/VOLUME	984 Acid					
FRACTURE TREATMENT (Fluids/Prop Amounts)	281,611bbl Water					
	14,118,104lbs Sand					

Min Gas Allowable

(165:10-17-7)

Gas Purchaser/Messurer

☐

OR

First Sales Date

Oil Allowable

(165:10-13-3)

INITIAL TEST DATA

INITIAL TEST DATE	5/1/2019					
OIL-BBL/DAY	631					
OIL-GRAVITY (API)	59					
GAS-MCF/DAY	13,781					
GAS-OIL RATIO CU FT/BBL	21,839					
WATER-BBL/DAY	4,718					
PUMPING OR FLOWING	Flowing					
INITIAL SHUT-IN PRESSURE	4073					
CHOKE SIZE	32/64					
FLOW TUBING PRESSURE	N/A					

AS SUBMITTED

A record of the formations drilled through, and pertinent remarks are presented on the reverse. I declare that I have knowledge of the contents of this report and am authorized by my organization to make this report, which was prepared by me or under my supervision and direction, with the data and facts stated herein to be true, correct, and complete to the best of my knowledge and belief.

SIGNATURE	Monica Pickens	DATE	8/28/19	PHONE NUMBER	252-4703
ADDRESS	3001 Quail Springs Parkway	CITY	Oklahoma City	STATE	OK
		ZIP	73134	EMAIL ADDRESS	mpickens@gulfportenergy.com

PLEASE TYPE OR USE BLACK INK ONLY
FORMATION RECORD

Give formation names and tops, if available, or descriptions and thickness of formations drilled through. Show intervals cored or drillstem tested.

NAMES OF FORMATIONS	TOP
Woodford	14,890

LEASE NAME Jeannie WELL NO. 6-27X34H

FOR COMMISSION USE ONLY	
ITD on file	<input type="checkbox"/> YES <input type="checkbox"/> NO
APPROVED	DISAPPROVED
2) Reject Codes	

Were open hole logs run?	<input type="checkbox"/> yes <input checked="" type="checkbox"/> no
Date Last log was run	
Was CO ₂ encountered?	<input type="checkbox"/> yes <input checked="" type="checkbox"/> no at what depths?
Was H ₂ S encountered?	<input type="checkbox"/> yes <input checked="" type="checkbox"/> no at what depths?
Were unusual drilling circumstances encountered?	<input type="checkbox"/> yes <input checked="" type="checkbox"/> no
If yes, briefly explain below	

Other remarks:

640 Acres

If more than three drainholes are proposed, attach a separate sheet indicating the necessary information.

Direction must be stated in degrees azimuth.
Please note, the horizontal drainhole and its end point must be located within the boundaries of the lease or spacing unit.

Directional surveys are required for all drainholes and directional wells.

640 Acres

BOTTOM HOLE LOCATION FOR DIRECTIONAL HOLE

SEC	TWP	RGE	COUNTY
Spot Location	1/4	1/4	1/4
Measured Total Depth	True Vertical Depth	BHL From Lease, Unit, or Property Line:	

BOTTOM HOLE LOCATION FOR HORIZONTAL HOLE: (LATERALS)

LATERAL #1			
SEC	TWP	RGE	COUNTY
34	5N	6W	Grady
Spot Location	1/4 SE 1/4 SW 1/4 SE 1/4	Feet From 1/4 Sec Lines	FSL 89 FEL 1631
Depth of Deviation	14,622	Radius of Turn	768
Measured Total Depth	21,890	True Vertical Depth	15,222
		BHL From Lease, Unit, or Property Line:	150

LATERAL #2

SEC	TWP	RGE	COUNTY
Spot Location	1/4	1/4	1/4
Depth of Deviation	Radius of Turn	Direction	Total Length
Measured Total Depth	True Vertical Depth	BHL From Lease, Unit, or Property Line:	

LATERAL #3

SEC	TWP	RGE	COUNTY
Spot Location	1/4	1/4	1/4
Depth of Deviation	Radius of Turn	Direction	Total Length
Measured Total Depth	True Vertical Depth	BHL From Lease, Unit, or Property Line:	