

Oklahoma Corporation Commission
Oil & Gas Conservation Division
Post Office Box 52000
Oklahoma City, Oklahoma 73152-2000
Rule 165: 10-3-25

Form 1002A

API No.: 35051244150001

Completion Report

Spud Date: August 31, 2018

OTC Prod. Unit No.: 051-225217-0-0000

Drilling Finished Date: October 27, 2018

1st Prod Date: March 22, 2019

Amended

Completion Date: March 22, 2019

Amend Reason: CORRECT DEEPEST PERFORATION

Drill Type: HORIZONTAL HOLE

Well Name: JEANNIE 8-27X34H

Purchaser/Measurer:

Location: GRADY 27 5N 6W
SE SW NE SE
1449 FSL 929 FEL of 1/4 SEC
Latitude: 34.8735554 Longitude: -97.8143914
Derrick Elevation: 0 Ground Elevation: 1155

First Sales Date: 03/22/2019

Operator: GULFPORT MIDCON LLC 24020

3001 QUAIL SPRINGS PKWY
OKLAHOMA CITY, OK 73134-2640

Completion Type		Location Exception		Increased Density	
X	Single Zone	Order No		Order No	
	Multiple Zone	701834		680412	
	Commingled			680413	

Casing and Cement							
Type	Size	Weight	Grade	Feet	PSI	SAX	Top of CMT
CONDUCTOR	30			0			
SURFACE	13 3/8		J-55	1495		1005	SURFACE
INTERMEDIATE	9 5/8		P-110HP	11040		825	4660
PRODUCTION	5 1/2		CHYP-P-110	21278		885	11909

Liner								
Type	Size	Weight	Grade	Length	PSI	SAX	Top Depth	Bottom Depth
LINER	7 5/8		P-110HC	1553	0	815	10881	12434

Total Depth: 21327

Packer		Plug	
Depth	Brand & Type	Depth	Plug Type
There are no Packer records to display.		14403	CEMENT

Initial Test Data

Test Date	Formation	Oil BBL/Day	Oil-Gravity (API)	Gas MCF/Day	Gas-Oil Ratio Cu FT/BBL	Water BBL/Day	Pumpin or Flowing	Initial Shut-In Pressure	Choke Size	Flow Tubing Pressure
Apr 06, 2019	WOODFORD	561	59	12938	23062	2583	FLOWING	4077	34/64	

Completion and Test Data by Producing Formation	
Formation Name: WOODFORD	Code: 319WDFD
Class: GAS	

Spacing Orders	
Order No	Unit Size
446322	640
456941	640
701833	MULTIUNIT

Perforated Intervals	
From	To
15150	21197

Acid Volumes	
1,392 BARRELS ACID	

Fracture Treatments	
272,585 BARRELS WATER, 12,726,557 POUNDS SAND	

Formation	Top
WOODFORD	14809

Were open hole logs run? No

Date last log run:

Were unusual drilling circumstances encountered? No

Explanation:

Other Remarks
WELL HAD TO BE SIDETRACKED AND CEMENT PLUG SET 14,403 FEET. MULTIUNIT NUMBER 684082

Lateral Holes
<p>Sec: 34 TWP: 5N RGE: 6W County: GRADY</p> <p style="margin-left: 40px;">SE SE SE</p> <p>72 FSL 408 FEL of 1/4 SEC</p> <p>Depth of Deviation: 14597 Radius of Turn: 766 Direction: 170 Total Length: 6130</p> <p>Measured Total Depth: 21327 True Vertical Depth: 15197 End Pt. Location From Release, Unit or Property Line: 72</p>

FOR COMMISSION USE ONLY	
Status: Accepted	1144254

API NO. 051-24415
OTC PROD.
UNIT NO. 051-225217-0000

(PLEASE TYPE OR USE BLACK INK ONLY)

OKLAHOMA CORPORATION COMMISSION
Oil & Gas Conservation Division
Post Office Box 52000
Oklahoma City, Oklahoma 73152-2000
Rule 165:10-3-25

RECEIVED

Form 1002A
Rev. 2009

AUG 29 2019

OKLAHOMA CORPORATION
COMMISSION

640 Acres

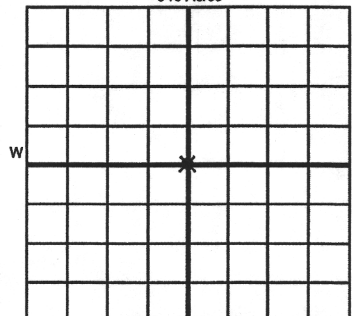

LOCATE WELL

ORIGINAL
☒ AMENDED (Reason)

Correct Perforation

COMPLETION REPORT

TYPE OF DRILLING OPERATION

☐ STRAIGHT HOLE ☐ DIRECTIONAL HOLE ☒ HORIZONTAL HOLE
☐ SERVICE WELL

If directional or horizontal, see reverse for bottom hole location.

COUNTY	Grady	SEC	27	TWP	5N	RGE	6W	SPUD DATE	8/31/2018
LEASE NAME	Jeannie			WELL NO.	8-27X34H			DRLG FINISHED DATE	10/27/2018
SE 1/4 SW 1/4 NE 1/4 SE 1/4	FSL OF 1/4 SEC 1449			FEL OF 1/4 SEC	929			DATE OF WELL COMPLETION	3/22/2019
ELEVATION	Ground	1155	Latitude (if known)	34.8735554			Longitude (if known)	-97.8143914	
OPERATOR NAME	Gulfport MidCon LLC			OTC / OCC OPERATOR NO.	24020				
ADDRESS	3001 Quail Springs Parkway								
CITY	Oklahoma City	STATE	OK	ZIP	73134				

COMPLETION TYPE

<input checked="" type="checkbox"/> SINGLE ZONE	
<input type="checkbox"/> MULTIPLE ZONE	
Application Date	F.O.
COMINGLED	
Application Date	701834
LOCATION EXCEPTION ORDER NO.	683488
INCREASED DENSITY ORDER NO.	680412/680413

CASING & CEMENT (Attach Form 1002C)

TYPE	SIZE	WEIGHT	GRADE	FEET	PSI	SAX	TOP OF CMT
CONDUCTOR	30						
SURFACE	13 3/8		J55	1,495		1,005	Surface
INTERMEDIATE	9 5/8		P110HP	11,040		825	4,660
Liner	7 5/8		P110HC	12,434		815	1,553
Production	5 1/2		CHYP P110	21,278		885	11,909
						TOTAL DEPTH	21,327

PACKER @ _____ BRAND & TYPE _____ PLUG @ 14403 TYPE CEM PLUG @ _____ TYPE _____
PACKER @ _____ BRAND & TYPE _____ PLUG @ _____ TYPE _____ PLUG @ _____ TYPE _____

COMPLETION & TEST DATA BY PRODUCING FORMATION

FORMATION	Woodford					
SPACING & SPACING ORDER NUMBER	640/ 456941	446322(640)	701833(Multiunit)			
CLASS: Oil, Gas, Dry, Inf, Disp, Comm Disp, Svc	Gas					
PERFORATED INTERVALS	15,150-21,197					
ACID/VOLUME	1,392 bbls Acid					
FRACTURE TREATMENT (Fluids/Prop Amounts)	272,585 bbls Water					
	12,726,557 lbs Sand					

Min Gas Allowable (165:10-17-7)

Gas Purchaser/Measurer

3/22/2019

OR
Oil Allowable (165:10-13-3)

First Sales Date

INITIAL TEST DATA

INITIAL TEST DATE	4/6/2019					
OIL-BBL/DAY	561					
OIL-GRAVITY (API)	59					
GAS-MCF/DAY	12,938					
GAS-OIL RATIO CU FT/BBL	23,062					
WATER-BBL/DAY	2,583					
PUMPING OR FLOWING	Flowing					
INITIAL SHUT-IN PRESSURE	4,077					
CHOKE SIZE	34/64					
FLOW TUBING PRESSURE	N/A					

AS SUBMITTED

A record of the formations drilled through, and pertinent remarks are presented on the reverse. I declare that I have knowledge of the contents of this report and am authorized by my organization to make this report, which was prepared by me or under my supervision and direction, with the data and facts stated herein to be true, correct, and complete to the best of my knowledge and belief.

Monica Pickens
SIGNATURE
3001 Quail Springs Parkway
ADDRESS
Oklahoma City
CITY
OK
STATE
73134
ZIP
8/28/2019
DATE
252-4703
PHONE NUMBER
mpickens@gulfportenergy.com
EMAIL ADDRESS

PLEASE TYPE OR USE BLACK INK ONLY

FORMATION RECORD

Give formation names and tops, if available, or descriptions and thickness of formations drilled through. Show intervals cored or drillstem tested.

NAMES OF FORMATIONS	TOP
Woodford	14,809

LEASE NAME Jeannie WELL NO. 8-27X34H

FOR COMMISSION USE ONLY	
ITD on file <input type="checkbox"/> YES <input type="checkbox"/> NO	
APPROVED _____	DISAPPROVED _____
2) Reject Codes	

Were open hole logs run?	yes	<input checked="" type="checkbox"/> no
Date Last log was run	_____	
Was CO ₂ encountered?	yes	<input checked="" type="checkbox"/> no at what depths? _____
Was H ₂ S encountered?	yes	<input checked="" type="checkbox"/> no at what depths? _____
Were unusual drilling circumstances encountered?	<input checked="" type="checkbox"/> yes <input type="checkbox"/> no	
If yes, briefly explain below _____		

Other remarks: Well had to be sidetracked and cement plug set 14403ft. MU# 684082

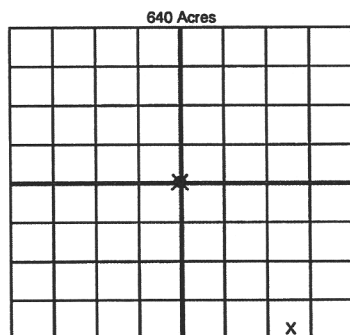

If more than three drainholes are proposed, attach a separate sheet indicating the necessary information.

Direction must be stated in degrees azimuth. Please note, the horizontal drainhole and its end point must be located within the boundaries of the lease or spacing unit.

Directional surveys are required for all drainholes and directional wells.

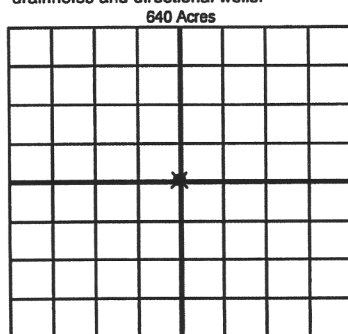

BOTTOM HOLE LOCATION FOR DIRECTIONAL HOLE

SEC	TWP	RGE	COUNTY
Spot Location	1/4	1/4	1/4
Measured Total Depth	True Vertical Depth		BHL From Lease, Unit, or Property Line:

BOTTOM HOLE LOCATION FOR HORIZONTAL HOLE: (LATERALS)

LATERAL #1			
SEC	TWP	RGE	COUNTY
34	5N	6W	Grady
Spot Location	1/4	SE 1/4	SE 1/4
Depth of Deviation	14,597	Radius of Turn	766
Measured Total Depth	21,327	True Vertical Depth	15,197
Feet From 1/4 Sec Lines		FSL	72
Direction		170	Total Length
BHL From Lease, Unit, or Property Line:		72	

LATERAL #2			
SEC	TWP	RGE	COUNTY
Spot Location	1/4	1/4	1/4
Depth of Deviation	Radius of Turn		Direction
Measured Total Depth	True Vertical Depth		BHL From Lease, Unit, or Property Line:

LATERAL #3			
SEC	TWP	RGE	COUNTY
Spot Location	1/4	1/4	1/4
Depth of Deviation	Radius of Turn		Direction
Measured Total Depth	True Vertical Depth		BHL From Lease, Unit, or Property Line: