

Oklahoma Corporation Commission
Oil & Gas Conservation Division
Post Office Box 52000
Oklahoma City, Oklahoma 73152-2000
Rule 165: 10-3-25

Form 1002A

API No.: 35087221520002

Completion Report

Spud Date: August 25, 2018

OTC Prod. Unit No.: 087-224499-0-0000

Drilling Finished Date: September 10, 2018

1st Prod Date: November 02, 2018

Amended

Completion Date: November 02, 2018

Amend Reason: AMEND BOTTOM PERFORATION DEPTH

Drill Type: HORIZONTAL HOLE

Min Gas Allowable: Yes

Well Name: MCMAHAN 0112 1H

Purchaser/Measurer: ENABLE GATHERING & PROCESSING

First Sales Date: 11/02/2018

Location: MCCLAIN 36 9N 4W
NE SW SW SW
525 FSL 388 FWL of 1/4 SEC
Derrick Elevation: 0 Ground Elevation: 1254

Operator: EOG RESOURCES INC 16231

3817 NW EXPRESSWAY STE 500
OKLAHOMA CITY, OK 73112-1483

Completion Type		Location Exception		Increased Density	
X	Single Zone	Order No		Order No	
	Multiple Zone	693377		N/A	
	Commingled				

Casing and Cement							
Type	Size	Weight	Grade	Feet	PSI	SAX	Top of CMT
SURFACE	9 5/8	36	J-55	1006		400	SURFACE
PRODUCTION	5 1/2 X 7	29 / 32	P-110	16997		1965	8711

Liner								
Type	Size	Weight	Grade	Length	PSI	SAX	Top Depth	Bottom Depth
There are no Liner records to display.								

Total Depth: 17004

Packer		Plug	
Depth	Brand & Type	Depth	Plug Type
There are no Packer records to display.		There are no Plug records to display.	

Initial Test Data										
Test Date	Formation	Oil BBL/Day	Oil-Gravity (API)	Gas MCF/Day	Gas-Oil Ratio Cu FT/BBL	Water BBL/Day	Pumpin or Flowing	Initial Shut-In Pressure	Choke Size	Flow Tubing Pressure
Nov 09, 2018	WOODFORD	403	38	193	479	2563	FLOWING	500	128	1610

Completion and Test Data by Producing Formation

Formation Name: WOODFORD

Code: 319WDFD

Class: OIL

Spacing Orders

Order No	Unit Size
684683	640
687006	640
693376	MULTIUNIT

Perforated Intervals

From	To
9794	16901

Acid Volumes

2,516 GALLONS 7.5% HCL TOTAL ACID

Fracture Treatments

10,236,972 GALLONS TOTAL FLUID, 13,279,800 POUNDS TOTAL PROPPANT
--

Formation	Top
WOODFORD	9143

Were open hole logs run? No

Date last log run:

Were unusual drilling circumstances encountered? No

Explanation:

Other Remarks

WELL NAME CHANGED FROM THAT ON APPROVED PERMIT TO DRILL TO INCLUDE "0112" IN LEASE NAME RATHER THAN WELL NUMBER. 8-3/4" PILOT HOLE DRILLED TO 9,512', PLUGGED BACK WITH 2 CEMENT PLUGS. PLUG 1 FROM 8,812' - 9,512', CEMENTED WITH 300 SACKS. PLUG 2 FROM 8,312' - 8,812' CEMENTED WITH 270 SACKS. SIDETRACK 8-3/4" PILOT HOLE @ 8,520' MD AND DRILLED SIDETRACK 1 TO 17,004' MD. 7" X 5-1/2" PRODUCTION CASING SET AT 16,997' AND CEMENTED WITH 1,965 SACKS. OCC - THIS DOCUMENT IS ACCEPTED BASED ON THE DATA SUBMITTED NEITHER THE FINAL LOCATION EXCEPTION NOR THE FINAL MULTIUNIT ORDERS HAVE BEEN ISSUED.

Lateral Holes

Sec: 36 TWP: 9N RGE: 4W County: MCCLAIN

SE NW SW SW

669 FSL 476 FWL of 1/4 SEC

Depth of Deviation: 8665 Radius of Turn: 398 Direction: 34 Total Length: 393

Measured Total Depth: 9456 True Vertical Depth: 9454 End Pt. Location From Release, Unit or Property Line: 476

Sec: 12 TWP: 8N RGE: 4W County: MCCLAIN

NE SW SW NW

2169 FNL 387 FWL of 1/4 SEC

Depth of Deviation: 8520 Radius of Turn: 2198 Direction: 179 Total Length: 6286

Measured Total Depth: 17004 True Vertical Depth: 9387 End Pt. Location From Release, Unit or Property Line: 387

FOR COMMISSION USE ONLY

1142815

PLEASE TYPE OR USE BLACK INK ONLY

FORMATION RECORD

Give formation names and tops, if available, or descriptions and thickness of formations drilled through. Show intervals cored or drillstem tested.

NAMES OF FORMATIONS	TOP
WOODFORD	9,143

LEASE NAME _____

WELL NO. _____

FOR COMMISSION USE ONLY	
ITD on file	<input type="checkbox"/> YES <input type="checkbox"/> NO
APPROVED	DISAPPROVED
2) Reject Codes	

Were open hole logs run?	yes <input type="checkbox"/> no <input checked="" type="checkbox"/>
Date Last log was run	N/A
Was CO ₂ encountered?	yes <input type="checkbox"/> no <input checked="" type="checkbox"/> at what depths? _____
Was H ₂ S encountered?	yes <input type="checkbox"/> no <input checked="" type="checkbox"/> at what depths? _____
Were unusual drilling circumstances encountered?	yes <input type="checkbox"/> no <input checked="" type="checkbox"/>
If yes, briefly explain below:	

Other remarks:

NAME CHANGED FROM THAT ON APPROVED PERMIT TO DRILL TO INCLUDE "0112" IN LEASE NAME RATHER THAN WELL NO.

8-3/4" Pilot hole drilled to 9,512', plugged back with 2 cement plugs. Plug 1 from 8,812' - 9,512', cemented w/300 sacks. Plug 2 from 8,312' - 8,812' cemented w/270 sacks. Sidetrack 8-3/4" pilot hole @8,520' MD and drilled sidetrack 1 to 17,004' MD. 7" x 5-1/2" production casing set at 16,997' and cemented w/1965 sacks.

640 Acres

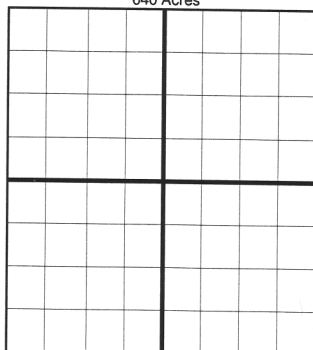

If more than three drainholes are proposed, attach a separate sheet indicating the necessary information.

Direction must be stated in degrees azimuth.

Please note, the horizontal drainhole and its end point must be located within the boundaries of the lease or spacing unit.

Directional surveys are required for all drainholes and directional wells.

640 Acres

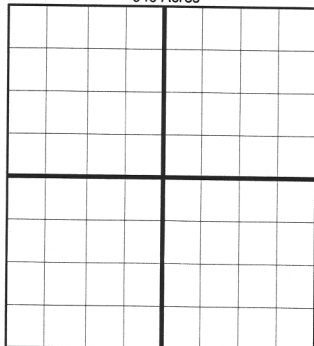

BOTTOM HOLE LOCATION FOR DIRECTIONAL HOLE

SEC	TWP	RGE	COUNTY
Spot Location	1/4	1/4	1/4
Measured Total Depth	True Vertical Depth	BHL From Lease, Unit, or Property Line:	

BOTTOM HOLE LOCATION FOR HORIZONTAL HOLE: (LATERALS)

OPEN HOLE LATERAL

SEC	TWP	RGE	COUNTY
36	9N	4W	MCCLAIN
Spot Location	SE 1/4	NW 1/4	SW 1/4
Depth of Deviation	8,665	Radius of Turn	398
Measured Total Depth	9,456	True Vertical Depth	9,454
Feet From 1/4 Sec Lines	FSL 669	FWL 476	
Direction	34	Total Length	393
BHL From Lease, Unit, or Property Line:	476		

LATERAL ST1

SEC	TWP	RGE	COUNTY
12	8N	4W	McClain
Spot Location	NE 1/4	SW 1/4	NW 1/4
Depth of Deviation	8,520	Radius of Turn	2198
Measured Total Depth	17,004	True Vertical Depth	9,387
Feet From 1/4 Sec Lines	FNL 2,169	FWL 387	
Direction	179	Total Length	6,286
BHL From Lease, Unit, or Property Line:	387		

LATERAL 2

SEC	TWP	RGE	COUNTY
Spot Location	1/4	1/4	1/4
Depth of Deviation	Radius of Turn	Direction	Total Length
Measured Total Depth	True Vertical Depth	BHL From Lease, Unit, or Property Line:	