

OKLAHOMA CORPORATION COMMISSION  
OIL & GAS CONSERVATION DIVISION  
P.O. BOX 52000  
OKLAHOMA CITY, OK 73152-2000  
(Rule 165:10-3-1)

API NUMBER: 073 26485

Approval Date: 03/14/2019  
Expiration Date: 09/14/2020

Horizontal Hole Oil & Gas  
Multi Unit

PERMIT TO DRILL

WELL LOCATION: Sec: 01 Twp: 15N Rge: 8W County: KINGFISHER  
SPOT LOCATION:  NE  NE  NW  NW FEET FROM QUARTER: FROM NORTH FROM WEST  
SECTION LINES: 235 1140

Lease Name: FRANKLIN FIU 1508 Well No: 5H-1X Well will be 235 feet from nearest unit or lease boundary.

Operator Name: NEWFIELD EXPLORATION MID-CON INC Telephone: 2812105100; 9188781 OTC/OCC Number: 20944 0

NEWFIELD EXPLORATION MID-CON INC  
4 WATERWAY SQUARE PL STE 100  
THE WOODLANDS, TX 77380-2764

PAUL E. ELLIS  
2309 EL CAMINO ST.  
PONCA CITY OK 74604

Formation(s) (Permit Valid for Listed Formations Only):

Name	Depth	Name	Depth
1 MISSISSIPPIAN (LESS CHESTER)	8342	6	
2 WOODFORD	8871	7	
3		8	
4		9	
5		10	

Spacing Orders: 641015 Location Exception Orders: 688764 Increased Density Orders: 686959  
688763 688771 686960

Pending CD Numbers:

Special Orders:

Total Depth: 18830 Ground Elevation: 1101 **Surface Casing: 1500** Depth to base of Treatable Water-Bearing FM: 280

Under Federal Jurisdiction: No Fresh Water Supply Well Drilled: No Surface Water used to Drill: No

PIT 1 INFORMATION

Type of Pit System: CLOSED Closed System Means Steel Pits

Type of Mud System: WATER BASED

Chlorides Max: 5000 Average: 3000

Is depth to top of ground water greater than 10ft below base of pit? Y

Within 1 mile of municipal water well? N

Wellhead Protection Area? N

Pit is located in a Hydrologically Sensitive Area.

Category of Pit: C

Liner not required for Category: C

Pit Location is BED AQUIFER

Pit Location Formation: CEDAR HILLS

Approved Method for disposal of Drilling Fluids:

- D. One time land application -- (REQUIRES PERMIT) PERMIT NO: 19-36228
- E. Haul to Commercial pit facility: Sec. 31 Twn. 12N Rng. 8W Cnty. 17 Order No: 587498
- H. SEE MEMO

This permit does not address the right of entry or settlement of surface damages.  
The duration of this permit is SIX MONTHS, except as otherwise provided by Rule 165: 10-3-1.  
Rule 165: 10-3-4 (c) (7) (e) - The Operator shall give 24 Hours notice by telephone to the appropriate District Office of the Conservation Division as to when Surface Casing will be run.

PIT 2 INFORMATION

Type of Pit System: CLOSED Closed System Means Steel Pits

Type of Mud System: OIL BASED

Chlorides Max: 300000 Average: 200000

Is depth to top of ground water greater than 10ft below base of pit? Y

Within 1 mile of municipal water well? N

Wellhead Protection Area? N

Pit is located in a Hydrologically Sensitive Area.

Category of Pit: C

Liner not required for Category: C

Pit Location is BED AQUIFER

Pit Location Formation: CEDAR HILLS

HORIZONTAL HOLE 1

Sec 12 Twp 15N Rge 8W County KINGFISHER

Spot Location of End Point: SE SW SE SW

Feet From: SOUTH 1/4 Section Line: 85

Feet From: WEST 1/4 Section Line: 1867

Depth of Deviation: 7752

Radius of Turn: 477

Direction: 175

Total Length: 10329

Measured Total Depth: 18830

True Vertical Depth: 8871

End Point Location from Lease,  
Unit, or Property Line: 85

Notes:

Category

Description

DEEP SURFACE CASING

2/6/2019 - G71 - APPROVED; NOTIFY OCC FIELD INSPECTOR IMMEDIATELY FOR ANY LOSS OF CIRCULATION OR FAILURE TO CIRCULATE CEMENT TO SURFACE ON CONDUCTOR OR SURFACE CASING

EXCEPTION TO RULE - 688771

3/14/2019 - G75 - (I.O.) 1 & 12-15N-8W  
X165:10-3-28(C)(2)(B) MSNLC (FRANKLIN FED 1508 5H-1X) \*\*  
MAY BE CLOSER THAN 600' TO EXISTING/PROPOSED WELL  
NEWFIELD EXLOR. MID-CONT. INC.  
12-21-2018

\*\* S/B FRANKLIN FIU 1508 5H-1X; TO BE CORRECTED AT HEARING FOR FINAL ORDER PER ATTORNEY FOR OPERATOR

HYDRAULIC FRACTURING

2/6/2019 - G71 - OCC 165:10-3-10 REQUIRES:

1) PRIOR TO COMMENCEMENT OF HYDRAULIC FRACTURING OPERATIONS FOR HORIZONTAL WELLS, NOTICE GIVEN FIVE BUSINESS DAYS IN ADVANCE TO OFFSET OPERATORS WITH WELLS COMPLETED IN THE SAME COMMON SOURCE OF SUPPLY WITHIN 1/2 MILE;

2) WITH NOTICE ALSO GIVEN 48 HOURS IN ADVANCE OF HYDRAULIC FRACTURING ALL WELLS TO BOTH THE OCC CENTRAL OFFICE AND LOCAL DISTRICT OFFICES, USING THE "FRAC NOTICE FORM" FOUND AT THE FOLLOWING LINK: [OCCEWEB.COM/OG/OGFORMS.HTML](http://OCCEWEB.COM/OG/OGFORMS.HTML); AND,

3) THE CHEMICAL DISCLOSURE OF HYDRAULIC FRACTURING INGREDIENTS FOR ALL WELLS TO BE REPORTED TO FRACFOCUS WITHIN 60 DAYS AFTER THE CONCLUSION THE HYDRAULIC FRACTURING OPERATIONS, USING THE FOLLOWING LINK: [FRACFOCUS.ORG](http://FRACFOCUS.ORG)

This permit does not address the right of entry or settlement of surface damages.

The duration of this permit is SIX MONTHS, except as otherwise provided by Rule 165: 10-3-1.

Rule 165: 10-3-4 (c) (7) (e) - The Operator shall give 24 Hours notice by telephone to the appropriate District Office of the Conservation Division as to when Surface Casing will be run.

073 26485 FRANKLIN FIU 1508 5H-1X

Category	Description
INCREASED DENSITY - 686959	3/14/2019 - G75 - 1-15N-8W X641015 MSNLC 6 WELLS NEWFIELD EXLOR. MID-CONT. INC. 11-20-2018
INCREASED DENSITY - 686960	3/14/2019 - G75 - 12-15N-8W X641015 MSNLC 6 WELLS NEWFIELD EXLOR. MID-CONT. INC. 11-20-2018
INTERMEDIATE CASING	2/6/2019 - G71 - DUE TO THE KNOWN POTENTIAL RISK OF ENCOUNTERING AN OVER-PRESSURED ZONE IN THE MORROW SERIES IN THIS AREA, THE TECHNICAL MANAGER RECOMMENDS SETTING AN INTERMEDIATE STRING OF CASING IMMEDIATELY ABOVE THE MORROW SERIES
LOCATION EXCEPTION - 688764	3/14/2019 - G75 - (I.O.) 1 & 12-15N-8W X641015 MSNLC, WDFD COMPL. INT. (1-15N-8W) NCT 165' FNL, NCT 0' FSL, NCT 1320' FWL COMPL. INT. (12-15N-8W) NCT 0' FNL, NCT 165' FSL, NCT 1320' FWL NEWFIELD EXLOR. MID-CONT. INC. 12-21-2018
MEMO	2/6/2019 - G71 - PIT 1 & 2 - CLOSED SYSTEM = STEEL PITS (REQUIRED - DEAD INDIAN CREEK); WBM, WBM & OBM CUTTINGS CAPTURED IN STEEL HALF PITS; WBM & CUTTINGS TO BE SOIL -FARMED; OBM CUTTINGS TO R360 (ORDER # 587498); PIT 2 - OBM TO VENDOR
SPACING - 641015	3/14/2019 - G75 - (640)(HOR) 1 & 12-15N-8W EST MSNLC EXT 637023 WDFD COMPL. INT. (MSNLC) NLT 660' FB COMPL. INT. (WDFD) NLT 165' FNL & FSL, NLT 330' FEL & FWL (COEXIST SP. ORDER # 246203 MSSLM, MSSSD 1-15N-8W & ORDER # 567318 MSSLM 12-15N-8W)
SPACING - 688763	3/14/2019 - G75 - (I.O.) 1 & 12-15N-8W EST MULTIUNIT HORIZONTAL WELL X641015 MSNLC, WDFD (WDFD ADJACENT COMMON SOURCE OF SUPPLY TO MSNLC) 50% 1-15N-8W 50% 12-15N-8W NEWFIELD EXLOR. MID-CONT. INC. 12-21-2018

This permit does not address the right of entry or settlement of surface damages.  
The duration of this permit is SIX MONTHS, except as otherwise provided by Rule 165: 10-3-1.  
Rule 165: 10-3-4 (c) (7) (e) - The Operator shall give 24 Hours notice by telephone to the appropriate District Office of the Conservation Division as to when Surface Casing will be run.

**TOPOGRAPHIC LAND SURVEYORS OF OKLAHOMA**

13800 WIRELESS WAY, OKLA. CITY, OKLA. 73134 \* LOCAL (405) 843-4847 \* OUT OF STATE (800) 654-3219  
 Certificate of Authorization No. 1293 LS

NAD-27
X 2001628.34
Y 295780.89
NAD-83
X 1970029.86
Y 295804.66

KINGFISHER County, Oklahoma

235°FNL-1140°FWL Section 1 Township 15N Range 8W I.M.

API 073-26485

**PERMIT PLAT**



- NOTES:**
- The information shown herein is for construction purposes ONLY.
  - Part of section 1 is within a flood zone.
  - All bearings shown are Grid, NAD-27, Oklahoma North.
  - Landing Point, Last Take Point, Bottom Hole, and Drill Path information provided by client listed, not surveyed.

NAD-27
X 1996354.25
Y 295769.89
NAD-83
X 1964755.70
Y 295793.64

NAD-27
X 1998991.29
Y 295775.41
NAD-83
X 1967392.60
Y 295799.12

NAD-27
X 1996346.20
Y 293120.78
NAD-83
X 1964747.69
Y 293144.53

LANDING POINT
165°FNL-1867°FWL
NAD-27 (US Feet)
35°48'43.5"N
98°00'21.6"W
35.812093°N
98.006003°W
X= 1998221
Y= 295609
NAD-83 (US Feet)
35°48'43.7"N
98°00'22.8"W
35.812139°N
98.006333°W
X= 1966622
Y= 295633

NAD-27
X 2001631.60
Y 293147.86
NAD-83
X 1970033.16
Y 293171.63

NAD-27
X 1996337.60
Y 290470.62
NAD-83
X 1964739.12
Y 290494.38

NAD-27
X 1998986.30
Y 290494.51
NAD-83
X 1967387.61
Y 290518.22

NAD-27
X 2001634.35
Y 290517.40
NAD-83
X 1970035.95
Y 290541.17

NAD-27
X 1996330.88
Y 287827.35
NAD-83
X 1964732.19
Y 287851.06

LAST TAKE POINT
165°FSL-1867°FWL
NAD-27 (US Feet)
35°47'02.2"N
98°00'22.0"W
35.783937°N
98.006100°W
X= 1998191
Y= 285360
NAD-83 (US Feet)
35°47'02.3"N
98°00'23.2"W
35.783984°N
98.006431°W
X= 1966592
Y= 285384

NAD-27
X 2001636.80
Y 287863.34
NAD-83
X 1970038.43
Y 287867.10

BOTTOM HOLE
85°FSL-1867°FWL
NAD-27 (US Feet)
35°47'01.4"N
98°00'22.0"W
35.783717°N
98.006101°W
X= 1998191
Y= 285280
NAD-83 (US Feet)
35°47'01.5"N
98°00'23.2"W
35.783764°N
98.006432°W
X= 1966592
Y= 285304

NAD-27
X 1998985.32
Y 285196.47
NAD-83
X 1967386.63
Y 285220.18

NAD-27
X 2001639.17
Y 285209.01
NAD-83
X 1970040.83
Y 285232.77

NAD-27	NAD-83
X 1996323.67	X 1964724.97
Y 285191.08	Y 285214.79

**SURFACE LOCATION**  
 DATUM: NAD-27  
 LAT: 35°48'42.8" N  
 LONG: 98°00'30.4" W  
 LAT: 35.811896° N  
 LONG: 98.008455° W  
 STATE PLANE  
 COORDINATES: (US Feet)  
 ZONE: OK NORTH  
 X: 1997494  
 Y: 295537

DATUM: NAD-83  
 LAT: 35°48'43.0" N  
 LONG: 98°00'31.6" W  
 LAT: 35.811942° N  
 LONG: 98.008786° W  
 STATE PLANE  
 COORDINATES: (US Feet)  
 ZONE: OK NORTH  
 X: 1965895  
 Y: 295561

(This information was gathered with a GPS receiver with ±1 foot Horiz./Vert. accuracy.)

**CERTIFICATE:**

I, Thomas L. Howell an Oklahoma Licensed Land Surveyor and an authorized agent of Topographic Land Surveyors of Oklahoma, do hereby certify to the information shown herein

*Thomas L. Howell*  
 Oklahoma Lic. No. 1433

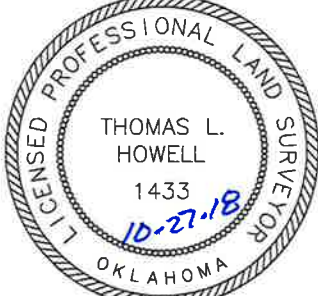

Operator: NEWFIELD EXPLORATION  
 Lease Name: FRANKLIN FIU 1508  
 Topography & Vegetation Loc. fell in level plowed field.

Date of Drawing: Oct. 26, 2018  
 Invoice # 300861 Date Staked: Sept. 27, 2018 TR  
 Well No.: 5H-1X

**ELEVATION:**  
 1101' Gr. at Stake (NGVD29)

Good Drill Site? Yes Reference Stakes or Alternate Location Stakes Set None  
 Best Accessibility to Location From North off county road.  
 Distance & Direction from Hwy Jct or Town From the junction of St. Hwy. 33 and US Hwy. 81, go South ±3.3 miles on US Hwy. 81, then West ±4 miles to the Northwest corner of section 1-T15N-R8W.