

Oklahoma Corporation Commission
Oil & Gas Conservation Division
Post Office Box 52000
Oklahoma City, Oklahoma 73152-2000
Rule 165: 10-3-25

Form 1002A

API No.: 35125239280000

Completion Report

Spud Date: October 02, 2017

OTC Prod. Unit No.:

Drilling Finished Date: October 13, 2017

1st Prod Date: February 02, 2018

Completion Date: January 31, 2018

Drill Type: STRAIGHT HOLE

Well Name: OK STATE 4-16

Purchaser/Measurer:

Location: POTTAWATOMIE 16 8N 5E
N2 SE NW SW
1815 FSL 990 FWL of 1/4 SEC
Derrick Elevation: 915 Ground Elevation: 905

First Sales Date:

Operator: RIDLEY DAVID OIL LLC 22368

46167 RUBEN RIVERS RD
TECUMSEH, OK 74873-7906

| Completion Type | |
|-----------------|---------------|
| X | Single Zone |
| | Multiple Zone |
| | Commingled |

| Location Exception | |
|---|--|
| Order No | |
| There are no Location Exception records to display. | |

| Increased Density | |
|--|--|
| Order No | |
| There are no Increased Density records to display. | |

| Casing and Cement | | | | | | | |
|-------------------|-------|--------|-------|------|-----|-----|------------|
| Type | Size | Weight | Grade | Feet | PSI | SAX | Top of CMT |
| SURFACE | 8 5/8 | 24 | J-55 | 1072 | | 600 | SURFACE |
| PRODUCTION | 5 1/2 | 15.5 | J-55 | 4662 | | 215 | |

| Liner | | | | | | | | |
|--|------|--------|-------|--------|-----|-----|-----------|--------------|
| Type | Size | Weight | Grade | Length | PSI | SAX | Top Depth | Bottom Depth |
| There are no Liner records to display. | | | | | | | | |

Total Depth: 4662

| Packer | |
|---|--------------|
| Depth | Brand & Type |
| There are no Packer records to display. | |

| Plug | |
|-------|-----------|
| Depth | Plug Type |
| 4265 | CIBP |

| Initial Test Data | | | | | | | | | | |
|-------------------|-----------|-------------|-------------------|-------------|-------------------------|---------------|-------------------|--------------------------|------------|----------------------|
| Test Date | Formation | Oil BBL/Day | Oil-Gravity (API) | Gas MCF/Day | Gas-Oil Ratio Cu FT/BBL | Water BBL/Day | Pumpin or Flowing | Initial Shut-In Pressure | Choke Size | Flow Tubing Pressure |
| Jan 29, 2018 | WILCOX | | | | | | | | | |
| Feb 02, 2018 | WILCOX | 28 | 40 | | | | PUMPING | | | |

Completion and Test Data by Producing Formation

Formation Name: WILCOX

Code: 202WLCX

Class: OIL

Spacing Orders

| Order No | Unit Size |
|------------|-----------|
| NOT SPACED | |

Perforated Intervals

| From | To |
|------|------|
| 4237 | 4239 |

Acid Volumes

| |
|------|
| NONE |
|------|

Fracture Treatments

| |
|------|
| NONE |
|------|

Formation Name: WILCOX

Code: 202WLCX

Class: DRY

Spacing Orders

| Order No | Unit Size |
|------------|-----------|
| NOT SPACED | |

Perforated Intervals

| From | To |
|------|------|
| 4278 | 4279 |

Acid Volumes

| |
|------|
| NONE |
|------|

Fracture Treatments

| |
|------|
| NONE |
|------|

| Formation | Top |
|-----------|------|
| WOODFORD | 3848 |
| HUNTON LS | 3994 |
| VIOLA | 4124 |
| WILCOX | 4236 |

Were open hole logs run? Yes

Date last log run: October 13, 2017

Were unusual drilling circumstances encountered? No

Explanation:

Other Remarks

There are no Other Remarks.

FOR COMMISSION USE ONLY

1139447

Status: Accepted

RECEIVED

Form 1002A Rev. 2009

API NO. 12523928
OTC PROD. UNIT NO. 22368

PLEASE TYPE OR USE BLACK INK ONLY
NOTE:

Attach copy of original 1002A if recompletion or reentry.

OKLAHOMA CORPORATION COMMISSION
Oil & Gas Conservation Division
Post Office Box 52000
Oklahoma City, Oklahoma 73152-2000

APR 16 2018

OKLAHOMA CORPORATION COMMISSION

ORIGINAL
 AMENDED (Reason)

Rule 165-10-3-25

COMPLETION REPORT

TYPE OF DRILLING OPERATION

STRAIGHT HOLE DIRECTIONAL HOLE HORIZONTAL HOLE
 SERVICE WELL

If directional or horizontal, see reverse for bottom hole location.

County: Pottawatomie, SEC 16, TWP 8N, RGE 5E
LEASE NAME: OK STATE, WELL NO. 4-16
N2 1/4 SE 1/4 NW 1/4 SW 1/4, FSL OF 1/4 SEC 1815, FWL OF 1/4 SEC 950/990
ELEVATION: 915, Ground: 905
OPERATOR NAME: Ridley David Oil LLC, OTC/OCC OPERATOR NO. 22368
ADDRESS: 46167 Ruben Rivers RD
CITY: Tecumseh, STATE: OK, ZIP: 74873

SPUD DATE: 10-2-2017
DRLG FINISHED DATE: 10-13-2017
DATE OF WELL COMPLETION: 1/31/2018
1st PROD DATE: 2/2/2018
RECOMP DATE: [blank]
Longitude (if known): [blank]

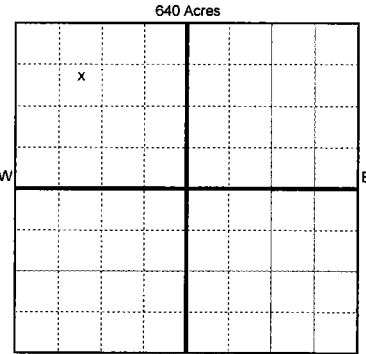

LOCATE WELL

COMPLETION TYPE

SINGLE ZONE
 MULTIPLE ZONE
Application Date COMMINGLED
Application Date
LOCATION EXCEPTION ORDER NO.
INCREASED DENSITY ORDER NO.

CASING & CEMENT (Form 1002C must be attached)

| TYPE | SIZE | WEIGHT | GRADE | FEET | PSI | SAX | TOP OF CMT |
|--------------|-------|--------|-------|------|-----|-----|------------|
| CONDUCTOR | | | | | | | |
| SURFACE | 8 5/8 | 24# | J55 | 1072 | | 600 | surface |
| INTERMEDIATE | | | | | | | |
| PRODUCTION | 5 1/2 | 15.5# | J55 | 4662 | | 215 | |
| LINER | | | | | | | |

Per 1002C

PACKER @ _____ BRAND & TYPE **CIBP** PLUG @ 4265 TYPE **CIBP** PLUG @ _____ TYPE _____
PACKER @ _____ BRAND & TYPE _____ PLUG @ _____ TYPE _____ PLUG @ _____ TYPE _____

TOTAL DEPTH 4,662

COMPLETION & TEST DATA BY PRODUCING FORMATION

| FORMATION | Wilcox | Wilcox | |
|---|-----------|-----------|--|
| SPACING & SPACING ORDER NUMBER | NS | NS | |
| CLASS: Oil, Gas, Dry, Inj, Disp, Comm Disp, Svc | Oil | Dry | |
| | 4237-4239 | 4278-4279 | |
| PERFORATED INTERVALS | | | |
| ACID/VOLUME | None | None | |
| FRACTURE TREATMENT (Fluids/Prop Amounts) | None | None | |

No Frac

Min Gas Allowable OR Oil Allowable (165:10-13-3) (165:10-17-7)

Gas Purchaser/Measurer
First Sales Date

INITIAL TEST DATA

| | | |
|--------------------------|----------|-----------|
| INITIAL TEST DATE | 2/2/2018 | 1/29/2018 |
| OIL-BBL/DAY | 28 | Dry |
| OIL-GRAVITY (API) | 40 | |
| GAS-MCF/DAY | | |
| GAS-OIL RATIO CU FT/BBL | | |
| WATER-BBL/DAY | 0 | |
| PUMPING OR FLOWING | Pumping | |
| INITIAL SHUT-IN PRESSURE | | |
| CHOKE SIZE | | |
| FLOW TUBING PRESSURE | | |

AS SUBMITTED

A record of the formations drilled through, and pertinent remarks are presented on the reverse. I declare that I have knowledge of the contents of this report and am authorized by my organization to make this report, which was prepared by me or under my supervision and direction, with the data and facts stated herein to be true, correct, and complete to the best of my knowledge and belief.

SIGNATURE: *David Ridley* NAME (PRINT OR TYPE): David Ridley
ADDRESS: 46167 Ruben Rivers Rd. CITY: Tecumseh STATE: OK ZIP: 74873
DATE: 4-5-18 PHONE NUMBER: 405 205 9819
EMAIL ADDRESS: ridleyoil@mbon.net

PLEASE TYPE OR USE BLACK INK ONLY
FORMATION RECORD

Give formation names and tops, if available, or descriptions and thickness of formations drilled through. Show intervals cored or drillstem tested.

LEASE NAME _____ WELL NO. _____

| NAMES OF FORMATIONS | TOP |
|---------------------|-------|
| Woodford | 3,848 |
| Hunton LS | 3,994 |
| Viola | 4124 |
| Wilcox | 4,236 |

FOR COMMISSION USE ONLY

ITD on file YES NO

APPROVED _____ DISAPPROVED _____ 2) Reject Codes _____

Were open hole logs run? yes no *per operator*

Date last log was run 10-13-2017

Was CO₂ encountered? yes no at what depths? _____

Was H₂S encountered? yes no at what depths? _____

Were unusual drilling circumstances encountered? yes no

If yes, briefly explain below: _____

Other remarks: _____

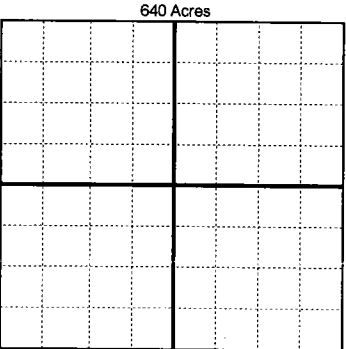

If more than three drainholes are proposed, attach a separate sheet indicating the necessary information.

Direction must be stated in degrees azimuth. Please note, the horizontal drainhole and its end point must be located within the boundaries of the lease or spacing unit.

Directional surveys are required for all drainholes and directional wells.

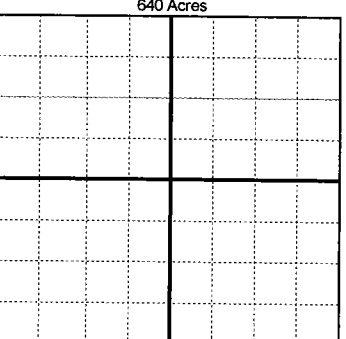

BOTTOM HOLE LOCATION FOR DIRECTIONAL HOLE

| SEC | TWP | RGE | COUNTY | | | | |
|----------------------|---------------------|-----|---|-----|-------------------------|-----|-----|
| Spot Location | 1/4 | 1/4 | 1/4 | 1/4 | Feet From 1/4 Sec Lines | FSL | FWL |
| Measured Total Depth | True Vertical Depth | | BHL From Lease, Unit, or Property Line: | | | | |

BOTTOM HOLE LOCATION FOR HORIZONTAL HOLE: (LATERALS)

LATERAL #1

| SEC | TWP | RGE | COUNTY | | | | |
|----------------------|---------------------|-----|---|-----|-------------------------|-----|-----|
| Spot Location | 1/4 | 1/4 | 1/4 | 1/4 | Feet From 1/4 Sec Lines | FSL | FWL |
| Depth of Deviation | Radius of Turn | | Direction | | Total Length | | |
| Measured Total Depth | True Vertical Depth | | BHL From Lease, Unit, or Property Line: | | | | |

LATERAL #2

| SEC | TWP | RGE | COUNTY | | | | |
|----------------------|---------------------|-----|---|-----|-------------------------|-----|-----|
| Spot Location | 1/4 | 1/4 | 1/4 | 1/4 | Feet From 1/4 Sec Lines | FSL | FWL |
| Depth of Deviation | Radius of Turn | | Direction | | Total Length | | |
| Measured Total Depth | True Vertical Depth | | BHL From Lease, Unit, or Property Line: | | | | |

LATERAL #3

| SEC | TWP | RGE | COUNTY | | | | |
|----------------------|---------------------|-----|---|-----|-------------------------|-----|-----|
| Spot Location | 1/4 | 1/4 | 1/4 | 1/4 | Feet From 1/4 Sec Lines | FSL | FWL |
| Depth of Deviation | Radius of Turn | | Direction | | Total Length | | |
| Measured Total Depth | True Vertical Depth | | BHL From Lease, Unit, or Property Line: | | | | |