

Oklahoma Corporation Commission  
Oil & Gas Conservation Division  
Post Office Box 52000  
Oklahoma City, Oklahoma 73152-2000  
Rule 165: 10-3-25

Form 1002A

API No.: 35133252610000

**Completion Report**

Spud Date: November 01, 2017

OTC Prod. Unit No.: 133-13817

Drilling Finished Date: November 09, 2017

1st Prod Date: April 12, 2018

Completion Date: April 11, 2018

**Drill Type: STRAIGHT HOLE**

Well Name: CLUCK A 18

Purchaser/Measurer:

Location: SEMINOLE 11 8N 5E  
NE NW NW SE  
2539 FSL 549 FWL of 1/4 SEC  
Derrick Elevation: 926 Ground Elevation: 916

First Sales Date:

Operator: CUESTA PETROLEUM INC 14397

23 E 9TH ST STE 403  
SHAWNEE, OK 74801-6963

| Completion Type |               |
|-----------------|---------------|
| X               | Single Zone   |
|                 | Multiple Zone |
|                 | Commingled    |

| Location Exception                                  |  |
|---|--|
| Order No  |  |
| There are no Location Exception records to display. |  |

| Increased Density                                  |  |
|--|--|
| Order No   |  |
| There are no Increased Density records to display. |  |

| Casing and Cement |       |        |       |      |     |     |            |
|-------------------|-------|--------|-------|------|-----|-----|------------|
| Type              | Size  | Weight | Grade | Feet | PSI | SAX | Top of CMT |
| SURFACE           | 8 5/8 | 24     | J-55  | 1150 |     | 550 | SURFACE    |
| PRODUCTION        | 5 1/2 | 17     | J-55  | 4431 |     | 150 | 3410       |

| Liner                                  |      |        |       |        |     |     |           |              |
|--|------|--------|-------|--------|-----|-----|-----------|--------------|
| Type                                   | Size | Weight | Grade | Length | PSI | SAX | Top Depth | Bottom Depth |
| There are no Liner records to display. |      |        |       |        |     |     |           |              |

**Total Depth: 4461**

| Packer                                  |              |
|---|--------------|
| Depth                                   | Brand & Type |
| There are no Packer records to display. |              |

| Plug  |           |
|-------|-----------|
| Depth | Plug Type |
| 4200  | CIBP      |

| Initial Test Data |            |             |                   |             |                         |               |                   |                          |            |                      |
|-------------------|------------|-------------|-------------------|-------------|-------------------------|---------------|-------------------|--------------------------|------------|----------------------|
| Test Date         | Formation  | Oil BBL/Day | Oil-Gravity (API) | Gas MCF/Day | Gas-Oil Ratio Cu FT/BBL | Water BBL/Day | Pumpin or Flowing | Initial Shut-In Pressure | Choke Size | Flow Tubing Pressure |
| Jan 05, 2018      | 2ND WILCOX | 1           | 40                |             |                         | 80            | PUMPING           |                          |            |                      |
| Apr 11, 2018      | 1ST WILCOX | 10          | 40                |             |                         | 400           | PUMPING           |                          |            |                      |

**Completion and Test Data by Producing Formation**

Formation Name: 2ND WILCOX

Code: 202WLCX2

Class: OIL

**Spacing Orders**

| Order No | Unit Size |
|----------|-----------|
| N/A      |           |

**Perforated Intervals**

| From | To   |
|------|------|
| 4212 | 4216 |

**Acid Volumes**

|                  |
|------------------|
| 150 GALLONS ACID |
|------------------|

**Fracture Treatments**

|     |
|-----|
| N/A |
|-----|

Formation Name: 1ST WILCOX

Code: 202WLCX1

Class: OIL

**Spacing Orders**

| Order No | Unit Size |
|----------|-----------|
| N/A      |           |

**Perforated Intervals**

| From | To   |
|------|------|
| 4113 | 4115 |

**Acid Volumes**

|      |
|------|
| NONE |
|------|

**Fracture Treatments**

|     |
|-----|
| N/A |
|-----|

| Formation     | Top  |
|---------------|------|
| WOODFORD      | 3830 |
| SYLVAN        | 3944 |
| FERNVALE      | 4023 |
| VIOLA TRENTON | 4070 |
| 1ST WILCOX    | 4113 |
| MARSHALL      | 4156 |
| 2ND WILCOX    | 4190 |

Were open hole logs run? Yes

Date last log run: November 09, 2017

Were unusual drilling circumstances encountered? No

Explanation:

**Other Remarks**

There are no Other Remarks.

**FOR COMMISSION USE ONLY**

1139446

Status: Accepted

API NO. 133-25261  
 OTC PROD. UNIT NO. 133-13817

PLEASE TYPE OR USE BLACK INK ONLY  
 NOTE:

Attach copy of original 1002A if recompletion or reentry.

OKLAHOMA CORPORATION COMMISSION  
 Oil & Gas Conservation Division  
 Post Office Box 52000  
 Oklahoma City, Oklahoma 73152-2000  
 Rule 165:10-3-25

RECEIVED

Form 1002A  
 Rev. 2009

APR 16 2018

OKLAHOMA CORPORATION COMMISSION

ORIGINAL  
 AMENDED (Reason)

COMPLETION REPORT

TYPE OF DRILLING OPERATION

STRAIGHT HOLE  DIRECTIONAL HOLE  HORIZONTAL HOLE  
 SERVICE WELL

If directional or horizontal, see reverse for bottom hole location.

SPUD DATE 11-1-17  
 DRILLING FINISHED DATE 11-9-17  
 DATE OF WELL COMPLETION 4-11-18  
 1st PROD DATE 4-12-18  
 RECOMP DATE  
 Longitude (if known)  
 OTC/OCC OPERATOR NO. 14397  
 ADDRESS 23 E. 9TH STREET, SUITE 403  
 CITY SHAWNEE STATE OK ZIP 74801

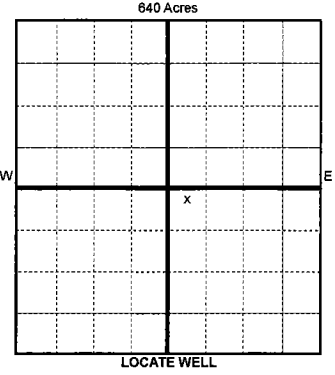

COUNTY SEMINOLE SEC 11 TWP 8N RGE 5E  
 LEASE NAME CLUCK A WELL NO. 18  
 NE 1/4 NW 1/4 NW 1/4 SE 1/4 FSL OF 1/4 SEC 2539 FWL OF 1/4 SEC 549  
 ELEVATION 926 Ground 916  
 OPERATOR NAME CUESTA PETROLEUM, INC  
 CITY SHAWNEE STATE OK ZIP 74801

COMPLETION TYPE

SINGLE ZONE  
 MULTIPLE ZONE  
 COMMINGLED  
 INCREASED DENSITY  
 EXCEPTION ORDER NO.  
 ORDER NO.

CASING & CEMENT (Form 1002C must be attached)

| TYPE         | SIZE   | WEIGHT | GRADE | FEET | PSI | SAX | TOP OF CMT |
|--------------|--------|--------|-------|------|-----|-----|------------|
| CONDUCTOR    |        |        |       |      |     |     |            |
| SURFACE      | 8 5/8" | 24#    | J-55  | 1150 |     | 550 | SURFACE    |
| INTERMEDIATE |        |        |       |      |     |     |            |
| PRODUCTION   | 5 1/2  | 17#    | J-55  | 4431 |     | 150 | 3410       |
| LINER        |        |        |       |      |     |     |            |
| TOTAL DEPTH  |        |        |       |      |     |     | 4,461      |

PACKER @ \_\_\_\_\_ BRAND & TYPE \_\_\_\_\_ PLUG @ 4200 TYPE CIBP PLUG @ \_\_\_\_\_ TYPE \_\_\_\_\_  
 PACKER @ \_\_\_\_\_ BRAND & TYPE \_\_\_\_\_ PLUG @ \_\_\_\_\_ TYPE \_\_\_\_\_ PLUG @ \_\_\_\_\_ TYPE \_\_\_\_\_

COMPLETION & TEST DATA BY PRODUCING FORMATION

| FORMATION                                       | 2ND WILCOX   | 1ST WILCOX    |         |
|---|--------------|---------------|---------|
| SPACING & SPACING ORDER NUMBER                  | NA           | NA            | No Frac |
| CLASS: Oil, Gas, Dry, Inj, Disp, Comm Disp, Svc | OIL          | OIL           |         |
| PERFORATED INTERVALS                            | 4212-4216    | 4113.5-4115.5 |         |
| ACID/VOLUME                                     | 150 GAL Acid | NONE          |         |
| FRACTURE TREATMENT (Fluids/Prop Amounts)        | NA           | NA            |         |

Min Gas Allowable (165:10-17-7) OR  Oil Allowable (165:10-13-3)  
 Gas Purchaser/Measurer \_\_\_\_\_  
 First Sales Date \_\_\_\_\_

INITIAL TEST DATA

| INITIAL TEST DATE        | 1/5/2018 | 4/11/2018 |
|--------------------------|----------|-----------|
| OIL-BBL/DAY              | 1        | 10        |
| OIL-GRAVITY (API)        | 40       | 40        |
| GAS-MCF/DAY              |          |           |
| GAS-OIL RATIO CU FT/BBL  |          |           |
| WATER-BBL/DAY            | 80       | 400       |
| PUMPING OR FLOWING       | PUMPING  | PUMPING   |
| INITIAL SHUT-IN PRESSURE |          |           |
| CHOKE SIZE               |          |           |
| FLOW TUBING PRESSURE     |          |           |

AS SUBMITTED

A record of the formations drilled through, and pertinent remarks are presented on the reverse. I declare that I have knowledge of the contents of this report and am authorized by my organization to make this report, which was prepared by me or under my supervision and direction, with the data and facts stated herein to be true, correct, and complete to the best of my knowledge and belief.

J.E. Richardson  
 SIGNATURE NAME (PRINT OR TYPE) J.E. RICHARDSON  
 23 E. 9TH STREET, SUITE 403 SHAWNEE OK 74801  
 ADDRESS CITY STATE ZIP  
 DATE 4/1/18 PHONE NUMBER 405-878-0744  
 EMAIL ADDRESS cuestapetroleum@gmail.com

PLEASE TYPE OR USE BLACK INK ONLY  
 FORMATION RECORD

CLUCK A

#18

Give formation names and tops, if available, or descriptions and thickness of formations drilled through. Show intervals cored or drillstem tested.

LEASE NAME CLUCKA WELL NO. #18

| NAMES OF FORMATIONS | TOP   |
|---------------------|-------|
| WOODFORD            | 3830  |
| SYLVAN              | 3,944 |
| FERNVALE            | 4,023 |
| VIOLA TRENTON       | 4,070 |
| 1ST WILCOX          | 4,113 |
| MARSHALL            | 4,156 |
| 2ND WILCOX          | 4,190 |
| TOTAL DEPTH         | 4,461 |

FOR COMMISSION USE ONLY

ITD on file  YES  NO

APPROVED \_\_\_\_\_ DISAPPROVED \_\_\_\_\_ 2) Reject Codes \_\_\_\_\_

\_\_\_\_\_

\_\_\_\_\_

\_\_\_\_\_

\_\_\_\_\_

Were open hole logs run?  yes  no

Date Last log was run 11-9-17

Was CO<sub>2</sub> encountered?  yes  no at what depths? \_\_\_\_\_

Was H<sub>2</sub>S encountered?  yes  no at what depths? \_\_\_\_\_

Were unusual drilling circumstances encountered?  yes  no

If yes, briefly explain below \_\_\_\_\_

Other remarks: \_\_\_\_\_

\_\_\_\_\_

\_\_\_\_\_

\_\_\_\_\_

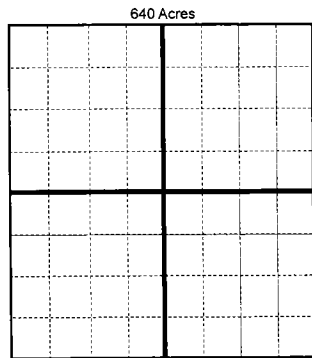

**BOTTOM HOLE LOCATION FOR DIRECTIONAL HOLE**

| SEC                  | TWP                 | RGE | COUNTY                                  |     |                         |     |     |
|----------------------|---------------------|-----|---|-----|-------------------------|-----|-----|
| Spot Location        | 1/4                 | 1/4 | 1/4                                     | 1/4 | Feet From 1/4 Sec Lines | FSL | FWL |
| Measured Total Depth | True Vertical Depth |     | BHL From Lease, Unit, or Property Line: |     |                         |     |     |

**BOTTOM HOLE LOCATION FOR HORIZONTAL HOLE: (LATERALS)**

**LATERAL #1**

| SEC                  | TWP                 | RGE | COUNTY                                  |     |                         |     |     |
|----------------------|---------------------|-----|---|-----|-------------------------|-----|-----|
| Spot Location        | 1/4                 | 1/4 | 1/4                                     | 1/4 | Feet From 1/4 Sec Lines | FSL | FWL |
| Depth of Deviation   | Radius of Turn      |     | Direction                               |     | Total Length            |     |     |
| Measured Total Depth | True Vertical Depth |     | BHL From Lease, Unit, or Property Line: |     |                         |     |     |

If more than three drainholes are proposed, attach a separate sheet indicating the necessary information.

Direction must be stated in degrees azimuth. Please note, the horizontal drainhole and its end point must be located within the boundaries of the lease or spacing unit.

Directional surveys are required for all drainholes and directional wells.

**LATERAL #2**

| SEC                  | TWP                 | RGE | COUNTY                                  |     |                         |     |     |
|----------------------|---------------------|-----|---|-----|-------------------------|-----|-----|
| Spot Location        | 1/4                 | 1/4 | 1/4                                     | 1/4 | Feet From 1/4 Sec Lines | FSL | FWL |
| Depth of Deviation   | Radius of Turn      |     | Direction                               |     | Total Length            |     |     |
| Measured Total Depth | True Vertical Depth |     | BHL From Lease, Unit, or Property Line: |     |                         |     |     |

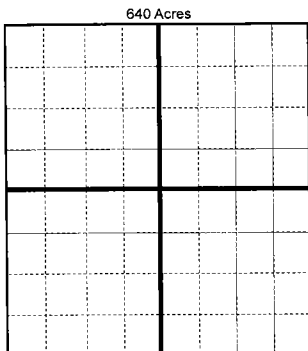

**LATERAL #3**

| SEC                  | TWP                 | RGE | COUNTY                                  |     |                         |     |     |
|----------------------|---------------------|-----|---|-----|-------------------------|-----|-----|
| Spot Location        | 1/4                 | 1/4 | 1/4                                     | 1/4 | Feet From 1/4 Sec Lines | FSL | FWL |
| Depth of Deviation   | Radius of Turn      |     | Direction                               |     | Total Length            |     |     |
| Measured Total Depth | True Vertical Depth |     | BHL From Lease, Unit, or Property Line: |     |                         |     |     |