

Oklahoma Corporation Commission
Oil & Gas Conservation Division
Post Office Box 52000
Oklahoma City, Oklahoma 73152-2000
Rule 165: 10-3-25

Form 1002A

API No.: 35083244080001

Completion Report

Spud Date: July 23, 2017

OTC Prod. Unit No.:

Drilling Finished Date: August 11, 2017

1st Prod Date: October 10, 2017

Completion Date: October 03, 2017

Drill Type: HORIZONTAL HOLE

Min Gas Allowable: Yes

Well Name: ALICIA JOY (ALICIA JOY 2-18H) 1-18MH

Purchaser/Measurer: SONORA GAS

Location: LOGAN 19 17N 2W
NW NE NW NE
210 FNL 1745 FEL of 1/4 SEC
Latitude: 35.941458049 Longitude: -97.448830075
Derrick Elevation: 1055 Ground Elevation: 1039

First Sales Date: 10/13/2017

Operator: ARNOLD OIL PROPERTIES LLC 22061

6816 N ROBINSON AVE
OKLAHOMA CITY, OK 73116-9039

Completion Type	
X	Single Zone
	Multiple Zone
	Commingled

Location Exception	
Order No	
665773	

Increased Density	
Order No	
665638	

Casing and Cement							
Type	Size	Weight	Grade	Feet	PSI	SAX	Top of CMT
CONDUCTOR	20	94	J-55	40		9	SURFACE
SURFACE	9 5/8	40	P-110	500		185	SURFACE
PRODUCTION	7	29	P-110	5849		205	3850

Liner								
Type	Size	Weight	Grade	Length	PSI	SAX	Top Depth	Bottom Depth
LINER	4 1/2	13.5	P-110	0	0	490	SURFACE	4820

Total Depth: 10525

Packer	
Depth	Brand & Type
There are no Packer records to display.	

Plug	
Depth	Plug Type
There are no Plug records to display.	

Initial Test Data

Test Date	Formation	Oil BBL/Day	Oil-Gravity (API)	Gas MCF/Day	Gas-Oil Ratio Cu FT/BBL	Water BBL/Day	Pumpin or Flowing	Initial Shut-In Pressure	Choke Size	Flow Tubing Pressure
Oct 22, 2017	MISSISSIPPIAN	227	42	594	2617	450	PUMPING	100	32/64	550

Completion and Test Data by Producing Formation

Formation Name: MISSISSIPPIAN

Code: 359MSSP

Class: OIL

Spacing Orders

Order No	Unit Size
629141	640

Perforated Intervals

From	To
5955	10462

Acid Volumes

39,000 GALLONS HCL

Fracture Treatments

116,666 BARRELS SLICK WATER, 238,335 100 MESH, 3,254,275 POUNDS 30/50 WHITE SAND

Formation	Top
TONKAWA	3702
AVANT	3998
COTTAGE GROVE	4421
HOGSHOOTER	4686
CHECKERBOARD	4841
BIG LIME	5148
OSWEGO	5148
VERDIGRIS	5353
RED FORK	5444
MISSISSIPPI	5493
MISSISSIPPI B	5541

Were open hole logs run? Yes

Date last log run: August 11, 2017

Were unusual drilling circumstances encountered? No

Explanation:

Other Remarks

OCC - THIS DOCUMENT IS ACCEPTED BASED ON THE DATA SUBMITTED THE FINAL LOCATION EXCEPTION HAS NOT BEEN ISSUED.

Lateral Holes

Sec: 18 TWP: 17N RGE: 2W County: LOGAN

NW NW NE NE

166 FNL 1253 FEL of 1/4 SEC

Depth of Deviation: 4900 Radius of Turn: 600 Direction: 1 Total Length: 4570

Measured Total Depth: 10525 True Vertical Depth: 5512 End Pt. Location From Release, Unit or Property Line: 166

FOR COMMISSION USE ONLY

Status: Accepted

1139385

RECEIVED

Form 1002A Rev. 2009

APR 11 2018

OKLAHOMA CORPORATION COMMISSION

API NO. 083 24408

PLEASE TYPE OR USE BLACK INK ONLY

NOTE:

Attach copy of original 1002A if recompletion or reentry.

OKLAHOMA CORPORATION COMMISSION

Oil & Gas Conservation Division

Post Office Box 52000

Oklahoma City, Oklahoma 73152-2000

Rule 165:10-3-25

COMPLETION REPORT

ORIGINAL AMENDED (Reason)

TYPE OF DRILLING OPERATION

STRAIGHT HOLE DIRECTIONAL HOLE HORIZONTAL HOLE SERVICE WELL

If directional or horizontal, see reverse for bottom hole location.

Well location and completion data including County (LOGAN), Lease Name (ALICIA JOY), Well No. (1-18MH), and Operator (ARNOLD OIL PROPERTIES, LLC).

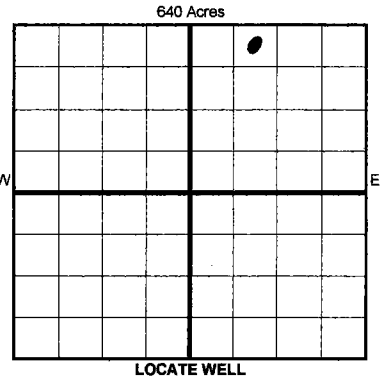

Completion type section with 'SINGLE ZONE' selected and location exception order number 665773.

CASING & CEMENT table with columns for TYPE, SIZE, WEIGHT, GRADE, FEET, PSI, SAX, and TOP OF CMT.

PACKER @ BRAND & TYPE PLUG @ TYPE PLUG @ TYPE

COMPLETION & TEST DATA BY PRODUCING FORMATION 359MSSP

Table with 5 columns for completion and test data, including Formation (MISSISSIPPIAN) and Spacing & Spacing Order Number (629141).

Min Gas Allowable (165:10-17-7) Gas Purchaser/Measurer SONORA GAS First Sales Date 10/13/2017

INITIAL TEST DATA table with 5 columns, including Initial Test Date (10/22/2017) and Oil-BBL/Day (227).

AS SUBMITTED

Signature and contact information for Scott Thompson, including address (6816 N. ROBINSON) and phone number (405-842-1488).

**PLEASE TYPE OR USE BLACK INK ONLY
FORMATION RECORD**

Give formation names and tops, if available, or descriptions and thickness of formations drilled through. Show intervals cored or drillstem tested.

LEASE NAME ALICIA JOY WELL NO. 1-18MH

NAMES OF FORMATIONS	TOP
TONKAWA	3,702
AVANT	3,998
COTTAGE GROVE	4,421
HOG SHOOTER	4,686
CHECKERBOARD	4,841
BIG LIME	5,148
OSWEGO	5,148
VERDIGRIS	5,353
RED FORK	5,444
MISSISSIPPI	5,493
MISSISSIPPI B	5,541

FOR COMMISSION USE ONLY	
ITD on file	<input type="checkbox"/> YES <input type="checkbox"/> NO
APPROVED	DISAPPROVED
2) Reject Codes	

Were open hole logs run?	<input checked="" type="checkbox"/> yes <input type="checkbox"/> no
Date Last log was run	<u>8/11/2017</u>
Was CO ₂ encountered?	<input type="checkbox"/> yes <input checked="" type="checkbox"/> no at what depths? _____
Was H ₂ S encountered?	<input type="checkbox"/> yes <input checked="" type="checkbox"/> no at what depths? _____
Were unusual drilling circumstances encountered?	<input type="checkbox"/> yes <input checked="" type="checkbox"/> no
If yes, briefly explain below.	

Other remarks:

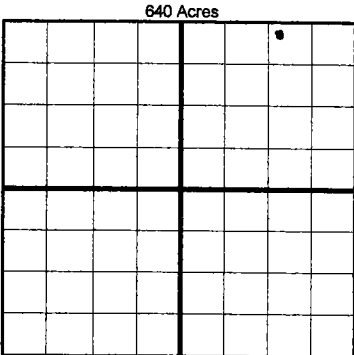

BOTTOM HOLE LOCATION FOR DIRECTIONAL HOLE

SEC	TWP	RGE	COUNTY					
Spot Location		1/4	1/4	1/4	1/4	Feet From 1/4 Sec Lines	FSL	FWL
Measured Total Depth		True Vertical Depth		BHL From Lease, Unit, or Property Line:				

BOTTOM HOLE LOCATION FOR HORIZONTAL HOLE: (LATERALS)

LATERAL #1

SEC	TWP	RGE	COUNTY						
18	17N	2W	LOGAN						
Spot Location		NW 1/4	NW 1/4	NE 1/4	NE 1/4	Feet From 1/4 Sec Lines	FSL	FWL	
Depth of Deviation		4,900		Radius of Turn	600'	Direction	1 NORTH	Total Length	4,570
Measured Total Depth		10,525		True Vertical Depth		5,512		BHL From Lease, Unit, or Property Line:	166 FT

Exc 1124 FEL 1253 FWL 87

If more than three drainholes are proposed, attach a separate sheet indicating the necessary information.

Direction must be stated in degrees azimuth. Please note, the horizontal drainhole and its end point must be located within the boundaries of the lease or spacing unit.

Directional surveys are required for all drainholes and directional wells.

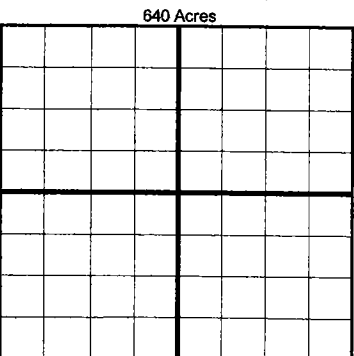

LATERAL #2

SEC	TWP	RGE	COUNTY					
Spot Location		1/4	1/4	1/4	1/4	Feet From 1/4 Sec Lines	FSL	FWL
Depth of Deviation		Radius of Turn		Direction		Total Length		
Measured Total Depth		True Vertical Depth		BHL From Lease, Unit, or Property Line:				

LATERAL #3

SEC	TWP	RGE	COUNTY					
Spot Location		1/4	1/4	1/4	1/4	Feet From 1/4 Sec Lines	FSL	FWL
Depth of Deviation		Radius of Turn		Direction		Total Length		
Measured Total Depth		True Vertical Depth		BHL From Lease, Unit, or Property Line:				