

Oklahoma Corporation Commission
 Oil & Gas Conservation Division
 Post Office Box 52000
 Oklahoma City, Oklahoma 73152-2000
 Rule 165: 10-3-25

Form 1002A

API No.: 35073258160000

Completion Report

Spud Date: November 20, 2017

OTC Prod. Unit No.:

Drilling Finished Date: December 10, 2017

1st Prod Date:

Completion Date: January 08, 2018

Drill Type: STRAIGHT HOLE

SERVICE WELL

Well Name: CHOATE SWD 2

Purchaser/Measurer:

Location: KINGFISHER 1 17N 6W
 SE NW SW SW
 760 FSL 420 FWL of 1/4 SEC
 Derrick Elevation: 1111 Ground Elevation: 1095

First Sales Date:

Operator: CHOATE DISPOSAL SERVICES LLC 23594
 PO BOX 597
 16123 E 650 RD
 HENNESSEY, OK 73742-0597

Completion Type	
<input type="checkbox"/>	Single Zone
<input type="checkbox"/>	Multiple Zone
<input type="checkbox"/>	Commingled

Location Exception	
Order No	
There are no Location Exception records to display.	

Increased Density	
Order No	
There are no Increased Density records to display.	

Casing and Cement							
Type	Size	Weight	Grade	Feet	PSI	SAX	Top of CMT
SURFACE	9 5/8			508		250	SURFACE
PRODUCTION	7			8358		850	2595

Liner								
Type	Size	Weight	Grade	Length	PSI	SAX	Top Depth	Bottom Depth
There are no Liner records to display.								

Total Depth: 8370

Packer	
Depth	Brand & Type
3686	ASI

Plug	
Depth	Plug Type
There are no Plug records to display.	

Initial Test Data

Test Date	Formation	Oil BBL/Day	Oil-Gravity (API)	Gas MCF/Day	Gas-Oil Ratio Cu FT/BBL	Water BBL/Day	Pumpin or Flowing	Initial Shut-In Pressure	Choke Size	Flow Tubing Pressure
-----------	-----------	-------------	-------------------	-------------	-------------------------	---------------	-------------------	--------------------------	------------	----------------------

There are no Initial Data records to display.

Completion and Test Data by Producing Formation

Formation Name: VIRGILIAN

Code: 406VRGN

Class: COMM DISP

Spacing Orders

Order No	Unit Size
There are no Spacing Order records to display.	

Perforated Intervals

From	To
3733	4844

Acid Volumes

56,000 GALLONS 20% HCL, 218,676 GALLONS WATER

Fracture Treatments

There are no Fracture Treatments records to display.

Formation Name: SIMPSON

Code: 202SMPS

Class: COMM DISP

Spacing Orders

Order No	Unit Size
There are no Spacing Order records to display.	

Perforated Intervals

From	To
8360	8500

Acid Volumes

There are no Acid Volume records to display.

Fracture Treatments

There are no Fracture Treatments records to display.

Formation	Top
VIRGILIAN	3720
SIMPSON	7350

Were open hole logs run? No

Date last log run:

Were unusual drilling circumstances encountered? No

Explanation:

Other Remarks

PERMIT NUMBER 1804159142

FOR COMMISSION USE ONLY

1139384

Status: Accepted

RECEIVED

Form 1002A Rev. 2009

APR 11 2018

OKLAHOMA CORPORATION COMMISSION

API NO. 073-25816
OTC PROD.
UNIT NO.

PLEASE TYPE OR USE BLACK INK ONLY
NOTE:

Attach copy of original 1002A
if recompletion or reentry.

OKLAHOMA CORPORATION COMMISSION
Oil & Gas Conservation Division
Post Office Box 52000
Oklahoma City, Oklahoma 73152-2000
Rule 165:10-3-25

ORIGINAL
 AMENDED (Reason)

COMPLETION REPORT

TYPE OF DRILLING OPERATION

STRAIGHT HOLE DIRECTIONAL HOLE HORIZONTAL HOLE
 SERVICE WELL

If directional or horizontal, see reverse for bottom hole location.

SPUD DATE 11/20/2017
DRLG FINISHED DATE 12/10/2017
DATE OF WELL COMPLETION 1/8/2018
1st PROD DATE NA
RECOMP DATE
Longitude (if known)
Latitude (if known)
OTC/OCC OPERATOR NO. 23594
ADDRESS P.O. BOX 597
CITY HENNESSEY STATE OK ZIP 73742

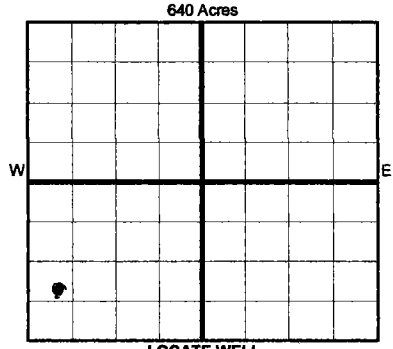

LOCATE WELL

COMPLETION TYPE

SINGLE ZONE
MULTIPLE ZONE
Application Date
COMMINGLED
Application Date
LOCATION
EXCEPTION ORDER
INCREASED DENSITY
ORDER NO.

CASING & CEMENT (Form 1002C must be attached)

TYPE	SIZE	WEIGHT	GRADE	FEET	PSI	SAX	TOP OF CMT
CONDUCTOR							
SURFACE	9 5/8"			508'		250	Surface
INTERMEDIATE							
PRODUCTION	7"			8358		850	2595'
LINER							
TOTAL DEPTH							8,370

PACKER @ 3,686 BRAND & TYPE ASI PLUG @ TYPE PLUG @ TYPE
PACKER @ BRAND & TYPE PLUG @ TYPE PLUG @ TYPE

COMPLETION & TEST DATA BY PRODUCING FORMATION

406 VRGN 202 SMP3

FORMATION	VIRGILIAN-PENN	SIMPSON
SPACING & SPACING ORDER NUMBER		
CLASS: Oil, Gas, Dry, Inj, Disp, Comm Disp, Svc	commercial disposal	
PERFORATED INTERVALS	3733-4844	8360-8500
ACID/VOLUME	20% HCL 56000 gal	
FRACTURE TREATMENT (Fluids/Prop Amounts)	218676 Gal Water	

Min Gas Allowable (165:10-17-7) OR Oil Allowable (165:10-13-3) Gas Purchaser/Measurer First Sales Date

INITIAL TEST DATA

NA-DISP-WELL

INITIAL TEST DATE	
OIL-BBL/DAY	
OIL-GRAVITY (API)	
GAS-MCF/DAY	
GAS-OIL RATIO CU FT/BBL	
WATER-BBL/DAY	
PUMPING OR FLOWING	
INITIAL SHUT-IN PRESSURE	
CHOKE SIZE	
FLOW TUBING PRESSURE	

AS SUBMITTED

A record of the formations drilled through, and pertinent remarks are presented on the reverse. I declare that I have knowledge of the contents of this report and am authorized by my organization to make this report, which was prepared by me or under my supervision and direction, with the data and facts stated herein to be true, correct, and complete to the best of my knowledge and belief.

SIGNATURE: Saleem Nizami-Consultant
P.O. BOX 597 HENNESSEY OK 73742
ADDRESS CITY STATE ZIP
DATE: 3/18/2018 PHONE NUMBER: 405-513-6055
EMAIL ADDRESS: APECAPEC@MSN.COM

PLEASE TYPE OR USE BLACK INK ONLY
FORMATION RECORD

Give formation names and tops, if available, or descriptions and thickness of formations drilled through. Show intervals cored or drillstem tested.

LEASE NAME CHOATE SWD WELL NO. 2

NAMES OF FORMATIONS	TOP
VIRGILIAN PENN	3,720
SIMPSON	7350

FOR COMMISSION USE ONLY

ITD on file YES NO

APPROVED _____ DISAPPROVED _____

2) Reject Codes _____

Were open hole logs run? yes no

Date Last log was run _____

Was CO₂ encountered? yes no at what depths? _____

Was H₂S encountered? yes no at what depths? _____

Were unusual drilling circumstances encountered? yes no
If yes, briefly explain below _____

Other remarks: Permit 1804159142

640 Acres

If more than three drainholes are proposed, attach a separate sheet indicating the necessary information.

Direction must be stated in degrees azimuth. Please note, the horizontal drainhole and its end point must be located within the boundaries of the lease or spacing unit.

Directional surveys are required for all drainholes and directional wells.

640 Acres

BOTTOM HOLE LOCATION FOR DIRECTIONAL HOLE

SEC	TWP	RGE	COUNTY							
Spot Location				1/4	1/4	1/4	1/4	Feet From 1/4 Sec Lines	FSL	FWL
Measured Total Depth				True Vertical Depth		BHL From Lease, Unit, or Property Line:				

BOTTOM HOLE LOCATION FOR HORIZONTAL HOLE: (LATERALS)

LATERAL #1

SEC	TWP	RGE	COUNTY							
Spot Location				1/4	1/4	1/4	1/4	Feet From 1/4 Sec Lines	FSL	FWL
Depth of Deviation				Radius of Turn		Direction		Total Length		
Measured Total Depth				True Vertical Depth		BHL From Lease, Unit, or Property Line:				

LATERAL #2

SEC	TWP	RGE	COUNTY							
Spot Location				1/4	1/4	1/4	1/4	Feet From 1/4 Sec Lines	FSL	FWL
Depth of Deviation				Radius of Turn		Direction		Total Length		
Measured Total Depth				True Vertical Depth		BHL From Lease, Unit, or Property Line:				

LATERAL #3

SEC	TWP	RGE	COUNTY							
Spot Location				1/4	1/4	1/4	1/4	Feet From 1/4 Sec Lines	FSL	FWL
Depth of Deviation				Radius of Turn		Direction		Total Length		
Measured Total Depth				True Vertical Depth		BHL From Lease, Unit, or Property Line:				