

Oklahoma Corporation Commission  
 Oil & Gas Conservation Division  
 Post Office Box 52000  
 Oklahoma City, Oklahoma 73152-2000  
 Rule 165: 10-3-25

Form 1002A

API No.: 35087356020003

**Completion Report**

Spud Date: April 25, 1959

OTC Prod. Unit No.:

Drilling Finished Date: June 23, 1959

**Amended**

1st Prod Date:

Amend Reason: RE-CLASSIFY - COMMERCIAL DISPOSAL

Completion Date: August 15, 1959

Recomplete Date: March 08, 2018

**Drill Type: STRAIGHT HOLE**

**SERVICE WELL**

Well Name: ALSUP (ALSUP 1) 1-19

Purchaser/Measurer:

Location: MCCLAIN 19 6N 3W  
 E2 W2 NE NW  
 1980 FSL 1965 FWL of 1/4 SEC  
 Derrick Elevation: 1086 Ground Elevation: 1074

First Sales Date:

Operator: S & H TANK SERVICE OF OKLA 18010  
 PO BOX 773  
 103 W CHEROKEE ST  
 LINDSAY, OK 73052-0773

Completion Type	
<input type="checkbox"/>	Single Zone
<input type="checkbox"/>	Multiple Zone
<input type="checkbox"/>	Commingled

Location Exception	
Order No	
There are no Location Exception records to display.	

Increased Density	
Order No	
There are no Increased Density records to display.	

Casing and Cement							
Type	Size	Weight	Grade	Feet	PSI	SAX	Top of CMT
CONDUCTOR	16	32		58		150	SURFACE
SURFACE	10 3/4	32.75	J-55	832		550	SURFACE
PRODUCTION	7	23 - 29	N-80	11085		900	7810

Liner								
Type	Size	Weight	Grade	Length	PSI	SAX	Top Depth	Bottom Depth
There are no Liner records to display.								

**Total Depth: 11085**

Packer	
Depth	Brand & Type
9769	AS-1X

Plug	
Depth	Plug Type
There are no Plug records to display.	

Initial Test Data

Test Date	Formation	Oil BBL/Day	Oil-Gravity (API)	Gas MCF/Day	Gas-Oil Ratio Cu FT/BBL	Water BBL/Day	Pumpin or Flowing	Initial Shut-In Pressure	Choke Size	Flow Tubing Pressure
-----------	-----------	-------------	-------------------	-------------	-------------------------	---------------	-------------------	--------------------------	------------	----------------------

There are no Initial Data records to display.

**Completion and Test Data by Producing Formation**

Formation Name: HUNTON

Code: 269HNTN

Class: COMM DISP

**Spacing Orders**

Order No	Unit Size
There are no Spacing Order records to display.	

**Perforated Intervals**

From	To
9804	9830

**Acid Volumes**

2,500 GALLONS 15%
-------------------

**Fracture Treatments**

NONE
------

Formation Name: VIOLA

Code: 202VIOL

Class: COMM DISP

**Spacing Orders**

Order No	Unit Size
There are no Spacing Order records to display.	

**Perforated Intervals**

From	To
10648	10671

**Acid Volumes**

18,000 GALLONS ACID AND 22,500 GALLONS GELLED WATER (ORIGINAL)
--

**Fracture Treatments**

There are no Fracture Treatments records to display.
--

Formation Name: BROMIDE

Code: 202BRMD

Class: COMM DISP

**Spacing Orders**

Order No	Unit Size
There are no Spacing Order records to display.	

**Perforated Intervals**

From	To
10980	11070

**Acid Volumes**

NONE
------

**Fracture Treatments**

NONE
------

Formation	Top
SEE ORIGINAL RECORDS	0

Were open hole logs run? Yes  
Date last log run: June 23, 1959

Were unusual drilling circumstances encountered? No  
Explanation:

Other Remarks
UIC PERMIT NUMBER 1503270095. THIS EXISTING COMMERCIAL WELL WAS ACQUIRED BY S & H ON MARCH 7, 2018. THE WELL WAS CLEANED OUT AND PARTIALLY RE-PERFORATED WITHIN THE EXISTING BROMIDE PERFORATED INTERVAL. THE WELL WAS ACIDIZED AND PASSED AN MIT ON APRIL 5, 2018. PACKER DEPTH 9,769'.

Status: Accepted

API NO. **087-35602**  
 OTC PROD. UNIT NO.

PLEASE TYPE OR USE BLACK INK ONLY  
 NOTE:

Attach copy of original 1002A if recompletion or reentry.

OKLAHOMA CORPORATION COMMISSION  
 Oil & Gas Conservation Division  
 Post Office Box 52000  
 Oklahoma City, Oklahoma 73152-2000  
 Rule 165:10-3-25

APR 11 2018

Form 1002A Rev. 2009

ORIGINAL  
 AMENDED (Reason) **RE-CLASSIFY- COMM DISPOSAL**

COMPLETION REPORT

TYPE OF DRILLING OPERATION

STRAIGHT HOLE  DIRECTIONAL HOLE  HORIZONTAL HOLE  
 SERVICE WELL

If directional or horizontal, see reverse for bottom hole location.

COUNTY	McCLAIN	SEC	19	TWP	6 N	RGE	3W	SPUD DATE	4-25-59
LEASE NAME	ALSUP			WELL NO.	1-19			DRILG FINISHED DATE	6-23-59
ELEVATION	1086	Ground	1074	FSL OF 1/4 SEC	1980'	FWL OF 1/4 SEC	1965'	DATE OF WELL COMPLETION	8-15-59
OPERATOR NAME	S & H TANKS SERVICE OF OKLAHOMA			1st PROD DATE				RECOMP DATE	3-8-18
ADDRESS	P. O. BOX 773			OTC/OCC OPERATOR NO.				Longitude (if known)	
CITY	LINDSAY	STATE	OK	ZIP	73052				

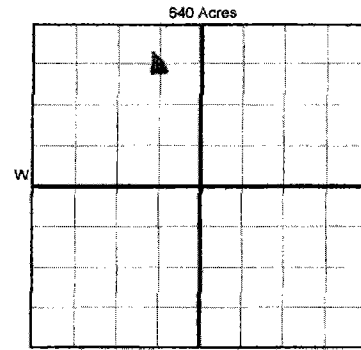

RECEIVED  
 APR 11 2018  
 OKLAHOMA CORPORATION COMMISSION

COMPLETION TYPE

SINGLE ZONE  
 MULTIPLE ZONE  
 Application Date  
 COMMINGLED  
 Application Date  
 LOCATION  
 EXCEPTION ORDER  
 INCREASED DENSITY  
 ORDER NO.

CASING & CEMENT (Form 1002C must be attached)

TYPE	SIZE	WEIGHT	GRADE	FEET	PSI	SAX	TOP OF CMT
CONDUCTOR	16"	32		58'		150	SURFACE
SURFACE	10 3/4"	32.75	J-55	832'		550	SURFACE
INTERMEDIATE							
PRODUCTION	7"	23-29	N-80	11,085'		900	7810'
LINER							

PACKER @ 9769' BRAND & TYPE AS-1X PLUG @ NONE TYPE NONE PLUG @  TYPE  TOTAL DEPTH 11,085'

COMPLETION & TEST DATA BY PRODUCING FORMATION 269 HUNTN, 202 VIOL, 202 BRMD

FORMATION	HUNTON	VIOLA	BROMIDE
SPACING & SPACING ORDER NUMBER			
CLASS: Oil, Gas, Dry, Inj, Disp, Comm Disp, Svc	COMM DISP	COMM DISP	COMM DISP
PERFORATED INTERVALS	9804'- 9830'	10,648'- 10,671'	10,980'-10,990' 11,010'-11,070'
ACID/VOLUME	2500 GALS 15%	<del>NONE</del> <b>ALL PERFS COMMINGLED</b> <i>18,000 gal acid + 22,500 gals gelled water (original)</i>	
FRACTURE TREATMENT (Fluids/Prop Amounts)	NONE	<del>NONE</del> <b>NONE</b>	

Min Gas Allowable (165:10-17-7) OR  Gas Purchaser/Measurer First Sales Date

INITIAL TEST DATA

INITIAL TEST DATE	
CIL-BBL/DAY	
OIL-GRAVITY ( API)	
GAS-MCF/DAY	COMMERCIAL DISPOSAL WELL
GAS-OIL RATIO CU FT/BBL	
WATER-BBL/DAY	
PUMPING OR FLOWING	
INITIAL SHUT-IN PRESSURE	
CHOKE SIZE	
FLOW TUBING PRESSURE	

**AS SUBMITTED**

A record of the formations drilled through, and pertinent remarks are presented on the reverse. I declare that I have knowledge of the contents of this report and am authorized by my organization to make this report, which was prepared by me or under my supervision and direction, with the data and facts stated herein to be true, correct, and complete to the best of my knowledge and belief.

*Danny L Ray*  
 SIGNATURE DANNY L RAY NAME (PRINT OR TYPE)  
P. O. BOX 773 ADDRESS LINDSAY OK 73052 CITY STATE ZIP  
4/5/2018 DATE 405-756-2269 PHONE NUMBER  
 EMAIL ADDRESS

PLEASE TYPE OR USE BLACK INK ONLY  
FORMATION RECORD

Give formation names and tops, if available, or descriptions and thickness of formations drilled through. Show intervals cored or drillstem tested.

LEASE NAME ALSUP WELL NO. 1-19

NAMES OF FORMATIONS	TOP
SEE ORIGINL RECORDS	

FOR COMMISSION USE ONLY

ITD on file  YES  NO

APPROVED \_\_\_\_\_ DISAPPROVED \_\_\_\_\_

2) Reject Codes

\_\_\_\_\_

\_\_\_\_\_

\_\_\_\_\_

Were open hole logs run?  yes  no

Date Last log was run 6/23/1959

Was CO<sub>2</sub> encountered?  yes  no at what depths? \_\_\_\_\_

Was H<sub>2</sub>S encountered?  yes  no at what depths? \_\_\_\_\_

Were unusual drilling circumstances encountered?  yes  no

If yes, briefly explain below

Other remarks: UIC PERMIT # 1503270095

THIS EXISTING COMMERCIAL WELL WAS ACQUIRED BY S&H ON 3-7-2018. THE WELL WAS CLEANED OUT AND PARTIALLY RE- PERFD WITHIN THE EXISTING BROMIDE PERF INTERVAL. THE WELL WAS ACIDIZED AND PASSED AN MIT ON 4-5-2018. PACKER DEPTH 9769'.

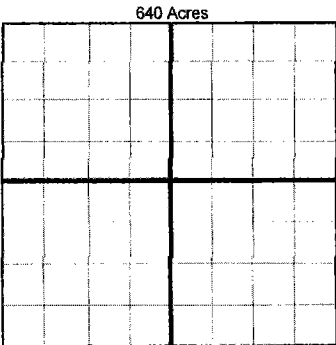

If more than three drainholes are proposed, attach a separate sheet indicating the necessary information.

Direction must be stated in degrees azimuth. Please note, the horizontal drainhole and its end point must be located within the boundaries of the lease or spacing unit.

Directional surveys are required for all drainholes and directional wells.

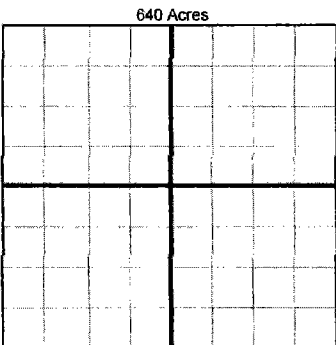

BOTTOM HOLE LOCATION FOR DIRECTIONAL HOLE

SEC	TWP	RGE	COUNTY	Feet From 1/4 Sec Lines	FSL	FWL
Spot Location	1/4	1/4	1/4	1/4		
Measured Total Depth	True Vertical Depth		BHL From Lease, Unit, or Property Line:			

BOTTOM HOLE LOCATION FOR HORIZONTAL HOLE: (LATERALS)

LATERAL #1

SEC	TWP	RGE	COUNTY	Feet From 1/4 Sec Lines	FSL	FWL
Spot Location	1/4	1/4	1/4	1/4		
Depth of Deviation	Radius of Turn		Direction	Total Length		
Measured Total Depth	True Vertical Depth		BHL From Lease, Unit, or Property Line:			

LATERAL #2

SEC	TWP	RGE	COUNTY	Feet From 1/4 Sec Lines	FSL	FWL
Spot Location	1/4	1/4	1/4	1/4		
Depth of Deviation	Radius of Turn		Direction	Total Length		
Measured Total Depth	True Vertical Depth		BHL From Lease, Unit, or Property Line:			

LATERAL #3

SEC	TWP	RGE	COUNTY	Feet From 1/4 Sec Lines	FSL	FWL
Spot Location	1/4	1/4	1/4	1/4		
Depth of Deviation	Radius of Turn		Direction	Total Length		
Measured Total Depth	True Vertical Depth		BHL From Lease, Unit, or Property Line:			