

Oklahoma Corporation Commission  
 Oil & Gas Conservation Division  
 Post Office Box 52000  
 Oklahoma City, Oklahoma 73152-2000  
 Rule 165: 10-3-25

Form 1002A

API No.: 35123238760000

**Completion Report**

Spud Date: January 02, 2018

OTC Prod. Unit No.: 123-222884

Drilling Finished Date: January 10, 2018

1st Prod Date: March 20, 2018

Completion Date: March 13, 2018

**Drill Type: STRAIGHT HOLE**

Min Gas Allowable: Yes

Well Name: BRAUM 4-9

Purchaser/Measurer: N/A

Location: PONTOTOC 9 5N 4E  
 C E2 SW NE  
 660 FSL 990 FWL of 1/4 SEC  
 Latitude: 34.921581 Longitude: -96.883142  
 Derrick Elevation: 987 Ground Elevation: 972

First Sales Date:

Operator: GULF EXPLORATION LLC 20983

9701 N BROADWAY EXT  
 OKLAHOMA CITY, OK 73114-6316

Completion Type	
X	Single Zone
	Multiple Zone
	Commingled

Location Exception	
Order No	
There are no Location Exception records to display.	

Increased Density	
Order No	
There are no Increased Density records to display.	

Casing and Cement							
Type	Size	Weight	Grade	Feet	PSI	SAX	Top of CMT
CONDUCTOR	16	44	A-242	40	500	6	SURFACE
SURFACE	8.625	24	J-55	168	1000	130	SURFACE
PRODUCTION	5.50	17	N-80	3249	4000	200	2059

Liner								
Type	Size	Weight	Grade	Length	PSI	SAX	Top Depth	Bottom Depth
There are no Liner records to display.								

**Total Depth: 3600**

Packer	
Depth	Brand & Type
There are no Packer records to display.	

Plug	
Depth	Plug Type
There are no Plug records to display.	

Initial Test Data

Test Date	Formation	Oil BBL/Day	Oil-Gravity (API)	Gas MCF/Day	Gas-Oil Ratio Cu FT/BBL	Water BBL/Day	Pumpin or Flowing	Initial Shut-In Pressure	Choke Size	Flow Tubing Pressure
Mar 20, 2018	2ND WILCOX	39	33			67	PUMPING	160	N/A	

**Completion and Test Data by Producing Formation**

Formation Name: 2ND WILCOX

Code: 202WLCX2

Class: OIL

**Spacing Orders**

Order No	Unit Size
There are no Spacing Order records to display.	

**Perforated Intervals**

From	To
3067	3105

**Acid Volumes**

1,000 GALLONS 7.5%
--------------------

**Fracture Treatments**

NONE
------

Formation	Top
WEWOKA	2150
CALVIN	2430
PENN BASAL UNCONFORMITY SAND	2565
HUNTON	2590
SYLVAN	2650
VIOLA	2750
SIMPSON DOLOMITE	2872
WILCOX	2980

Were open hole logs run? Yes

Date last log run: January 08, 2018

Were unusual drilling circumstances encountered? No

Explanation:

**Other Remarks**

There are no Other Remarks.

**FOR COMMISSION USE ONLY**

1139369

Status: Accepted

RECEIVED

Form 1002A Rev. 2009

APR 10 2018

OKLAHOMA CORPORATION COMMISSION

API NO. 123 23876
OTC PROD. UNIT NO. 123 222884

PLEASE TYPE OR USE BLACK INK ONLY
NOTE:

Attach copy of original 1002A if recompletion or reentry.

OKLAHOMA CORPORATION COMMISSION
Oil & Gas Conservation Division
Post Office Box 52000
Oklahoma City, Oklahoma 73152-2000
Rule 165:10-3-25

ORIGINAL
AMENDED (Reason)

COMPLETION REPORT

TYPE OF DRILLING OPERATION
STRAIGHT HOLE
DIRECTIONAL HOLE
HORIZONTAL HOLE
SERVICE WELL

SPUD DATE 1/2/18
DRLG FINISHED DATE 1/10/18
DATE OF WELL COMPLETION 3/13/18
1st PROD DATE 3/20/18
RECOMP DATE N/A
ELEVATION Derrick FL 987 Ground 972
Latitude (if known) 34.921581
Longitude (if known) -96.883142
OPERATOR NAME GULF EXPLORATION, L.L.C.
ADDRESS 9701 N. Broadway Extension
CITY Oklahoma City STATE Ok ZIP 73114

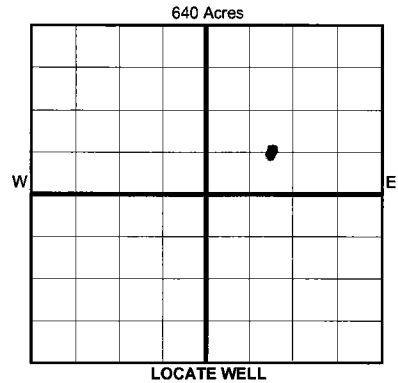

COUNTY PONTOTOC SEC 9 TWP 5N RGE 4E
LEASE NAME BRAUM WELL NO. 4-9
C 1/4 E/2 1/4 SW 1/4 NE 1/4
FSL OF 1/4 SEC 660 FWL OF 1/4 SEC 990
OPERATOR NAME GULF EXPLORATION, L.L.C.
ADDRESS 9701 N. Broadway Extension
CITY Oklahoma City STATE Ok ZIP 73114

COMPLETION TYPE
SINGLE ZONE
MULTIPLE ZONE
COMINGLED
LOCATION
EXCEPTION ORDER
INCREASED DENSITY
ORDER NO.

Table with 8 columns: TYPE, SIZE, WEIGHT, GRADE, FEET, PSI, SAX, TOP OF CMT. Rows include CONDUCTOR, SURFACE, INTERMEDIATE, PRODUCTION, LINER, and TOTAL DEPTH (3,600).

PACKER @ BRAND & TYPE PLUG @ TYPE PLUG @ TYPE PLUG @ TYPE

COMPLETION & TEST DATA BY PRODUCING FORMATION 202WLCX-2

Table with 8 columns: FORMATION, SPACING & SPACING ORDER NUMBER, PERFORATED INTERVALS, ACID/VOLUME, FRACTURE TREATMENT. Includes handwritten entries like '2nd Wilcox' and 'No Frac'.

Min Gas Allowable (165:10-17-7) Gas Purchaser/Measurer N/A
Oil Allowable (165:10-13-3) First Sales Date

INITIAL TEST DATA

Table with 8 columns: INITIAL TEST DATE, OIL-BBL/DAY, OIL-GRAVITY (API), GAS-MCF/DAY, GAS-OIL RATIO CU FT/BBL, WATER-BBL/DAY, PUMPING OR FLOWING, INITIAL SHUT-IN PRESSURE, CHOKER SIZE, FLOW TUBING PRESSURE.

AS SUBMITTED

A record of the formations drilled through and pertinent remarks are presented on the reverse. I declare that I have knowledge of the contents of this report and am authorized by my organization to make this report, which was prepared by me or under my supervision and direction, with the data and facts stated herein to be true, correct, and complete to the best of my knowledge and belief.

SIGNATURE Pat McGraw NAME (PRINT OR TYPE)
DATE 3/26/2018 PHONE NUMBER 405-840-3371
ADDRESS 9701 N. Broadway Extension CITY Oklahoma City STATE Ok ZIP 73114
EMAIL ADDRESS pmcgraw@gulfexploration.com

PLEASE TYPE OR USE BLACK INK ONLY

FORMATION RECORD

Give formation names and tops, if available, or descriptions and thickness of formations drilled through. Show intervals cored or drillstem tested.

LEASE NAME BRAUM WELL NO. 4-9

NAMES OF FORMATIONS	TOP
Wewoka	2,150
Calvin	2,430
Penn Basal Unconformity Sand	2,565
Hunton	2,590
Sylvan	2,650
Viola	2,750
Simpson Dolomite	2,872
Wilcox	2,980
TD	3,600

**FOR COMMISSION USE ONLY**

ITD on file  YES  NO

APPROVED \_\_\_\_\_ DISAPPROVED \_\_\_\_\_ 2) Reject Codes \_\_\_\_\_

\_\_\_\_\_

\_\_\_\_\_

\_\_\_\_\_

\_\_\_\_\_

Were open hole logs run?  yes  no

Date Last log was run 1/8/2018

Was CO<sub>2</sub> encountered?  yes  no at what depths? \_\_\_\_\_

Was H<sub>2</sub>S encountered?  yes  no at what depths? \_\_\_\_\_

Were unusual drilling circumstances encountered?  yes  no  
If yes, briefly explain below

Other remarks:

\_\_\_\_\_

\_\_\_\_\_

\_\_\_\_\_

\_\_\_\_\_

\_\_\_\_\_

640 Acres

If more than three drainholes are proposed, attach a separate sheet indicating the necessary information.

Direction must be stated in degrees azimuth. Please note, the horizontal drainhole and its end point must be located within the boundaries of the lease or spacing unit.

**Directional surveys are required for all drainholes and directional wells.**

640 Acres

**BOTTOM HOLE LOCATION FOR DIRECTIONAL HOLE**

SEC	TWP	RGE	COUNTY
Spot Location			
1/4	1/4	1/4	1/4
Measured Total Depth		True Vertical Depth	BHL From Lease, Unit, or Property Line:

**BOTTOM HOLE LOCATION FOR HORIZONTAL HOLE: (LATERALS)**

**LATERAL #1**

SEC	TWP	RGE	COUNTY
Spot Location			
1/4	1/4	1/4	1/4
Depth of Deviation		Radius of Turn	Direction
Measured Total Depth		True Vertical Depth	Total Length
		BHL From Lease, Unit, or Property Line:	

**LATERAL #2**

SEC	TWP	RGE	COUNTY
Spot Location			
1/4	1/4	1/4	1/4
Depth of Deviation		Radius of Turn	Direction
Measured Total Depth		True Vertical Depth	Total Length
		BHL From Lease, Unit, or Property Line:	

**LATERAL #3**

SEC	TWP	RGE	COUNTY
Spot Location			
1/4	1/4	1/4	1/4
Depth of Deviation		Radius of Turn	Direction
Measured Total Depth		True Vertical Depth	Total Length
		BHL From Lease, Unit, or Property Line:	