

Oklahoma Corporation Commission
 Oil & Gas Conservation Division
 Post Office Box 52000
 Oklahoma City, Oklahoma 73152-2000
 Rule 165: 10-3-25

Form 1002A

API No.: 35049251370000

Completion Report

Spud Date: July 01, 2017

OTC Prod. Unit No.: 049-222559

Drilling Finished Date: July 23, 2017

1st Prod Date: March 10, 2018

Completion Date: March 22, 2018

Drill Type: DIRECTIONAL HOLE

Min Gas Allowable: Yes

Well Name: THE DONALD 1

Purchaser/Measurer: ONEOK

Location: GARVIN 9 4N 3W
 C NW NW
 1980 FSL 660 FWL of 1/4 SEC
 Derrick Elevation: 1008 Ground Elevation: 992

First Sales Date: 03/10/2018

Operator: GLB EXPLORATION INC 18634
 7716 MELROSE LN
 OKLAHOMA CITY, OK 73127-6002

Completion Type	
X	Single Zone
	Multiple Zone
	Commingled

Location Exception	
Order No	
There are no Location Exception records to display.	

Increased Density	
Order No	
There are no Increased Density records to display.	

Casing and Cement							
Type	Size	Weight	Grade	Feet	PSI	SAX	Top of CMT
CONDUCTOR	16	48	J-55	60		5	SURFACE
SURFACE	8 5/8	24	J-55	512	600	300	SURFACE
PRODUCTION	5 1/2	17	P-110	9976	1500	550	6506

Liner								
Type	Size	Weight	Grade	Length	PSI	SAX	Top Depth	Bottom Depth
There are no Liner records to display.								

Total Depth: 10138

Packer	
Depth	Brand & Type
There are no Packer records to display.	

Plug	
Depth	Plug Type
8820	CIBP
8995	CIBP
9360	CIBP
9534	CIBP
9620	CIBP

Initial Test Data

Test Date	Formation	Oil BBL/Day	Oil-Gravity (API)	Gas MCF/Day	Gas-Oil Ratio Cu FT/BBL	Water BBL/Day	Pumpin or Flowing	Initial Shut-In Pressure	Choke Size	Flow Tubing Pressure
Sep 19, 2017	2ND BROMIDE					12	SWAB	30		
Sep 26, 2017	1ST BROMIDE					21	SWAB	470		
Oct 09, 2017	1ST BROMIDE					76	SWAB	230		
Oct 18, 2017	1ST BROMIDE					66	SWAB	90		
Nov 07, 2017	VIOLA			436		416	FLOWING	1400	3/4	
Mar 22, 2018	VIOLA	20	36	303	15150		PUMPING	600		

Completion and Test Data by Producing Formation

Formation Name: 2ND BROMIDE

Code: 202BRMD2

Class: DRY

Spacing Orders

Order No	Unit Size
154165	160

Perforated Intervals

From	To
9661	9665

Acid Volumes

1,000 GALLONS 7 1/2 NEFE HCL

Fracture Treatments

NONE

Formation Name: 1ST BROMIDE

Code: 202BRMD1

Class: DRY

Spacing Orders

Order No	Unit Size
154165	160

Perforated Intervals

From	To
9569	9574

Acid Volumes

500 GALLONS 7 1/2 NEFE HCL

Fracture Treatments

NONE

Formation Name: 1ST BROMIDE

Code: 202BRMD1

Class: DRY

Spacing Orders

Order No	Unit Size
154165	160

Perforated Intervals

From	To
9414	9421

Acid Volumes

500 GALLONS 7 1/2 NEFE HCL

Fracture Treatments

389 BARRELS 4% X-LINKED, 4% HCL WATER + 16,500 POUNDS 20/40 RESIN COATED SAND

Formation Name: 1ST BROMIDE

Code: 202BRMD1

Class: DRY

Spacing Orders

Order No	Unit Size
154165	160

Perforated Intervals

From	To
9145	9248

Acid Volumes

5,000 GALLONS GELLED 15% NEFE HCL

Fracture Treatments

NONE

Formation Name: VIOLA

Code: 202VIOL

Class: DRY

Spacing Orders

Order No	Unit Size
154165	160

Perforated Intervals

From	To
8848	8870

Acid Volumes

2,000 GALLONS GELLED 15% NEFE HCL

Fracture Treatments

3,500 BARRELS SLICK WATER WITH 39,800 POUNDS 40/70 SAND + 18,900 POUNDS 40/70 RESIN COATED SAND

Formation Name: VIOLA

Code: 202VIOL

Class: GAS

Spacing Orders

Order No	Unit Size
154165	160

Perforated Intervals

From	To
7996	8298

Acid Volumes

3,000 GALLONS 15% GELLED NEFE HCL

Fracture Treatments

4,853 BARRELS SLICK WATER WITH 100,257 POUNDS 40/70 SAND + 24,295 POUNDS RESIN COATED SAND
--

Formation	Top
WOODFORD	7200
HUNTON	7270
SYLVAN	7776
VIOLA	7893

Were open hole logs run? Yes

Date last log run: July 21, 2017

Were unusual drilling circumstances encountered? No

Explanation:

Other Remarks

There are no Other Remarks.

Bottom Holes

Sec: 9 TWP: 4N RGE: 3W County: GARVIN

SW NE SW NW

933 FSL 983 FWL of 1/4 SEC

Depth of Deviation: 0 Radius of Turn: 0 Direction: 0 Total Length: 0

Measured Total Depth: 10138 True Vertical Depth: 10000 End Pt. Location From Release, Unit or Property Line: 933

FOR COMMISSION USE ONLY

1139340

Status: Accepted

RECEIVED

Form 1002A Rev. 2009

APR 11 2018

API NO. 049-25137
OTC PROD. UNIT NO. 049-222559

PLEASE TYPE OR USE BLACK INK ONLY
NOTE: Attach copy of original 1002A if recompletion or rec

OKLAHOMA CORPORATION COMMISSION
Oil & Gas Conservation Division
Post Office Box 52000
Oklahoma City, Oklahoma 73152-2000
Rule 165:10-3-25

OKLAHOMA CORPORATION COMMISSION

ORIGINAL
 AMENDED (Reason)

COMPLETION REPORT

TYPE OF DRILLING OPERATION
 STRAIGHT HOLE DIRECTIONAL HOLE HORIZONTAL HOLE
 SERVICE WELL

SPUD DATE 7/1/17
DRLG FINISHED DATE 7/23/17

COUNTY GARVIN SEC 9 TWP 4N RGE 3W
LEASE NAME THE DONALD WELL NO. 1
C 1/4 NW 1/4 NW 1/4 1/4 FSL 1980 FWL OF 1/4 SEC 660
ELEVATION N Derrick 1008 Ground 992
OPERATOR NAME GLB EXPLORATION, INC
ADDRESS 7716 MELROSE LANE
CITY OKLAHOMA CITY STATE OK ZIP 73127

DATE OF WELL COMPLETION 3/22/18
1st PROD DATE 3/10/18
RECOMP DATE

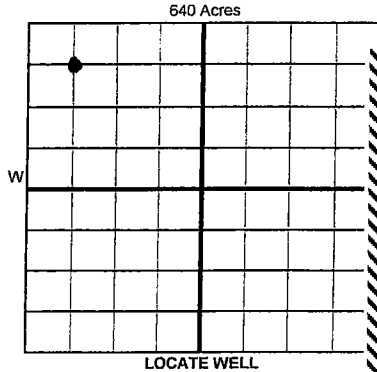

AS SUBMITTED

COMPLETION TYPE
 SINGLE ZONE
 MULTIPLE ZONE
 COMMINGLED
LOCATION EXCEPTION ORDER INCREASED DENSITY ORDER NO.

CASING & CEMENT (Form 1002C must be attached)

TYPE	SIZE	WEIGHT	GRADE	FEET	PSI	SAX	TOP OF CMT
CONDUCTOR	16	48	J-55	60	-	5 1/2 lbs	SURF
SURFACE	8 5/8	24	J-55	512	600	300	SURF
INTERMEDIATE							
PRODUCTION	5 1/2	17	P-110	9976	1500	550	6506
LINER							

PACKER @ BRAND & TYPE PLUG @ 9620 TYPE CIBP PLUG @ 9360 TYPE CIBP TOTAL DEPTH 10,138
PACKER @ BRAND & TYPE PLUG @ 9534 TYPE CIBP PLUG @ 8995 TYPE CIBP

COMPLETION & TEST DATA BY PRODUCING FORMATION 202 BRIMDZ 202 BRIMDZ 202 VIO LA

FORMATION	200 BRIMIDE	1st BRIMIDE	1st BRIMIDE	1st BRIMIDE	VIO LA	VIO LA
SPACING & SPACING ORDER NUMBER	160-154165+ 344773	160-154165+ 344773	154165 (160)	154165 (160)	154165 (160)	154165 (160)
CLASS: Oil, Gas, Dry, Inj, Disp, Comm Disp, Svc	DRY	DRY	DRY	DRY	DRY	GAS
PERFORATED INTERVALS	9661-65	9569-74	9414-21	9145-60, 9174-96, 9192-9266, 9230-34, 9244-48	8848-70	7996-8014, 8028-32, 8162-06, 8236-40, 8164-68, 820-14, 8226-32, 8248-52, 8272-98
ACID/VOLUME	1000 gal 7 1/2 WE FE HCL	500 gal 7 1/2 WE FE HCL	500 gal 7 1/2 WE FE HCL	5000 gal 9 acid 15% WE FE HCL	2000 gal 6 acid 15% WE FE HCL	3000 gal 15% WE FE HCL
FRACTURE TREATMENT (Fluids/Prop Amounts)	NONE	NONE	389 bbls 4% X-LINKED + 406 HCL WTR + 1,500 #	NONE	3500 bbls slick water w/ 39,800 # 40/70 SD + 18,900 # 40/70 SD + 24,295 Resin COATED	4853 bbls slick water w/ 100,257 # 46/70 SD + 24,295 # Resin COATED

3 Frac's Reported to Frac Focus

Min Gas Allowable (165:10-17-7) OR Oil Allowable (165:10-13-3) Gas Purchaser/Measurer First Sales Date ONEOK 3/10/18

INITIAL TEST DATA

INITIAL TEST DATE	9/19/17	9/26/17	10/9/17	10/18/17	11/07/17	3/22/2018
OIL-BBL/DAY	Trace	Trace	Trace +	0	Trace	20
OIL-GRAVITY (API)	-	-	-	-	-	36
GAS-MCF/DAY	-	-	Trace	0	436	303
GAS-OIL RATIO CU FT/BBL	-	-	-	-	-	15,150:1
WATER-BBL/DAY	12 BBLW 2hrs	21 BBLW Per Hr.	76	66	416	0
PUMPING OR FLOWING	SWAB	SWAB	SWAB	SWAB	Flowing	Pumping
INITIAL SHUT-IN PRESSURE	30	470	230	90	1400	600
CHOKE SIZE	-	-	-	-	3/4"	-
FLOW TUBING PRESSURE	-	-	-	-	0	-

A record of the formations drilled through, and pertinent remarks are presented on the reverse. I declare that I have knowledge of the contents of this report and am authorized by my organization to make this report, which was prepared by me or under my supervision and direction, with the data and facts stated herein to be true, correct, and complete to the best of my knowledge and belief.

SIGNATURE: GLENN BLUMSTEIN
NAME (PRINT OR TYPE): GLENN BLUMSTEIN
DATE: 4/10/18
PHONE NUMBER: 405-757-0049
ADDRESS: 7716 MELROSE LANE
CITY: OKC STA: OK ZIP: 73127
EMAIL ADDRESS: glb@glbexplorationinc.com

PLEASE TYPE OR USE BLACK INK ONLY
FORMATION RECORD

Give formation names and tops, if available, or descriptions and thickness of formations drilled through. Show intervals cored or drillstem tested.

LEASE NAME THE DONALD WELL NO. 1

NAMES OF FORMATIONS	TOP
WOODFORD	7200
HUTTON	7270
SYLVAN	7776
VIOLA	7893

FOR COMMISSION USE ONLY

ITD on file YES NO

APPROVED _____ DISAPPROVED _____

2) Reject Codes

Were open hole logs run? yes no

Date Last log was run 7/21/17

Was CO₂ encountered? yes no at what depths? _____

Was H₂S encountered? yes no at what depths? _____

Were unusual drilling circumstances encountered? yes no
If yes, briefly explain below

Other remarks:

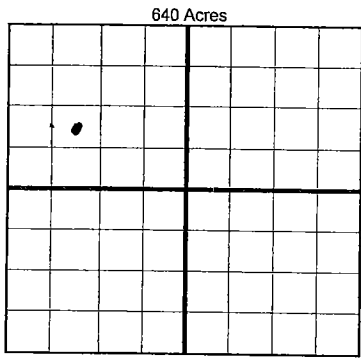

BOTTOM HOLE LOCATION FOR DIRECTIONAL HOLE

SEC <u>9</u>	TWP <u>4N</u>	RGE <u>3W</u>	COUNTY <u>GARVIN</u>
Spot Location <u>SW 1/4 NE 1/4 SW 1/4 NW 1/4</u>			
Measured Total Depth <u>10138</u>		True Vertical Depth <u>10,000.6</u>	Feet From 1/4 Sec Lines FSL <u>933</u> FWL <u>983</u>
BHL From Lease, Unit, or Property Line: <u>933</u>			

BOTTOM HOLE LOCATION FOR HORIZONTAL HOLE: (LATERALS)

LATERAL #1

SEC	TWP	RGE	COUNTY
Spot Location <u>1/4 1/4 1/4 1/4</u>			
Depth of Deviation		Radius of Turn	Direction
Measured Total Depth		True Vertical Depth	Total Length
BHL From Lease, Unit, or Property Line:			

LATERAL #2

SEC	TWP	RGE	COUNTY
Spot Location <u>1/4 1/4 1/4 1/4</u>			
Depth of Deviation		Radius of Turn	Direction
Measured Total Depth		True Vertical Depth	Total Length
BHL From Lease, Unit, or Property Line:			

LATERAL #3

SEC	TWP	RGE	COUNTY
Spot Location <u>1/4 1/4 1/4 1/4</u>			
Depth of Deviation		Radius of Turn	Direction
Measured Total Depth		True Vertical Depth	Total Length
BHL From Lease, Unit, or Property Line:			

If more than three drainholes are proposed, attach a separate sheet indicating the necessary information.

Direction must be stated in degrees azimuth.
Please note, the horizontal drainhole and its end point must be located within the boundaries of the lease or spacing unit.

Directional surveys are required for all drainholes and directional wells.

