

Oklahoma Corporation Commission
 Oil & Gas Conservation Division
 Post Office Box 52000
 Oklahoma City, Oklahoma 73152-2000
 Rule 165: 10-3-25

Form 1002A

API No.: 35019212260002

Completion Report

Spud Date: October 03, 1973

OTC Prod. Unit No.:

Drilling Finished Date: October 05, 1973

Amended

1st Prod Date: October 10, 1973

Amend Reason: TEMPORARILY ABANDONED

Completion Date: October 10, 1973

Recomplete Date: April 11, 2018

Drill Type: STRAIGHT HOLE

Well Name: NORTHWEST HEALDTON UNIT (STEWART 2) 4-2

Purchaser/Measurer:

Location: CARTER 34 3S 3W
 W2 SW SE SE
 330 FSL 1485 FWL of 1/4 SEC
 Latitude: 34.243938 Longitude: -97.5024
 Derrick Elevation: 0 Ground Elevation: 0

First Sales Date:

Operator: KINGERY DRILLING COMPANY INC 1214
 PO BOX 1588
 210 W BROADWAY
 ARDMORE, OK 73402-1588

Completion Type	
X	Single Zone
	Multiple Zone
	Commingled

Location Exception	
Order No	
There are no Location Exception records to display.	

Increased Density	
Order No	
There are no Increased Density records to display.	

Casing and Cement							
Type	Size	Weight	Grade	Feet	PSI	SAX	Top of CMT
CONDUCTOR	8 5/8	24	E	61		60	SURFACE
PRODUCTION	5 1/2	14	E	1880		450	SURFACE

Liner								
Type	Size	Weight	Grade	Length	PSI	SAX	Top Depth	Bottom Depth
There are no Liner records to display.								

Total Depth: 1880

Packer	
Depth	Brand & Type
1700	ARROW TENSION

Plug	
Depth	Plug Type
There are no Plug records to display.	

Initial Test Data

Test Date	Formation	Oil BBL/Day	Oil-Gravity (API)	Gas MCF/Day	Gas-Oil Ratio Cu FT/BBL	Water BBL/Day	Pumpin or Flowing	Initial Shut-In Pressure	Choke Size	Flow Tubing Pressure
-----------	-----------	-------------	-------------------	-------------	-------------------------	---------------	-------------------	--------------------------	------------	----------------------

There are no Initial Data records to display.

Completion and Test Data by Producing Formation

Formation Name: DAUBE

Code: 405DUBE

Class: TA

Spacing Orders

Order No	Unit Size
There are no Spacing Order records to display.	

Perforated Intervals

From	To
1784	1804

Acid Volumes

There are no Acid Volume records to display.
--

Fracture Treatments

There are no Fracture Treatments records to display.
--

Formation	Top
SEE ORIGINAL 1002A	0

Were open hole logs run? Yes

Date last log run:

Were unusual drilling circumstances encountered? No

Explanation:

Other Remarks

There are no Other Remarks.

FOR COMMISSION USE ONLY

Status: Accepted

1139280

RECEIVED

APR 04 2018

Form 1002A Rev. 2009

API NO. 019-21226
OTC PROD. UNIT NO.

PLEASE TYPE OR USE BLACK INK ONLY
NOTE:

Attach copy of original 1002A if recompletion or reentry.

OKLAHOMA CORPORATION COMMISSION
Oil & Gas Conservation Division
Post Office Box 52000
Oklahoma City, Oklahoma 73152-2000
Rule 165-10-3-25

OKLAHOMA CORPORATION COMMISSION

ORIGINAL
 AMENDED (Reason)

Temporary Abandon

COMPLETION REPORT

TYPE OF DRILLING OPERATION
 STRAIGHT HOLE DIRECTIONAL HOLE HORIZONTAL HOLE
 SERVICE WELL

SPUD DATE 10/3/1973
DRLG FINISHED DATE 10/5/1973
DATE OF WELL COMPLETION 10/10/1973
1st PROD DATE 10/10/1973
RECOMP DATE 4-11-18
Longitude (if known) -97.5024
OTC/OCC OPERATOR NO. 1214

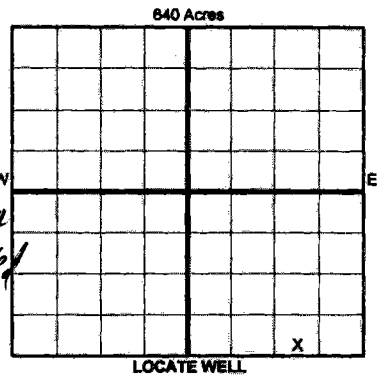

COUNTY Carter SEC 34 TWP 3S RGE 3W
LEASE NAME Stewart (NW Healdton UT-TR 4) WELL NO. 2
W/2 1/4 SW 1/4 SE 1/4 SE 1/4 FSL OF 1/4 SEC 330 FWL OF 1/4 SEC 1485
ELEVATIO Ground Latitude (if known) 34.243938 Longitude (if known) -97.5024
OPERATOR NAME Kingery Drilling Co., Inc. ADDRESS P.O. Box 1588
CITY Ardmore STATE OK ZIP 73402

COMPLETION TYPE
 SINGLE ZONE
 MULTIPLE ZONE
COMMINGLED
LOCATION EXCEPTION ORDER INCREASED DENSITY ORDER NO.

CASING & CEMENT (Form 1002C must be attached)

TYPE	SIZE	WEIGHT	GRADE	FEET	PSI	SAX	TOP OF CMT
CONDUCTOR							
SURFACE	8 5/8	24	E	61		60	Surface
INTERMEDIATE							
PRODUCTION	5 1/2	14	E	1880		450	Surface
LINER							

PACKER @ 1,700 BRAND & TYPE Arrow Tensor PLUG @ TYPE PLUG @ TYPE
PACKER @ BRAND & TYPE PLUG @ TYPE PLUG @ TYPE

TOTAL DEPTH 1,880

COMPLETION & TEST DATA BY PRODUCING FORMATION

FORMATION	Daube						
SPACING & SPACING ORDER NUMBER							
CLASS: Oil, Gas, Dry, Inj, Disp, Comm Disp, Svc	T & A						
PERFORMED INTERVALS	1784-1804						
ACID/VOLUME							
FRACTURE TREATMENT (Fluids/Prop Amounts)							

Min Gas Allowable (165-10-17-7) OR Gas Purchaser/Measurer First Sales Date
 Oil Allowable (165-10-13-3)

INITIAL TEST DATA

INITIAL TEST DATE	10/17/1973						
OIL-BBL/DAY	85						
OIL-GRAVITY (API)	35						
GAS-MCF/DAY	TSTM						
GAS-OIL RATIO CU FT/BBL							
WATER-BBL/DAY	0						
PUMPING OR FLOWING	Pumping						
INITIAL SHUT-IN PRESSURE							
CHOKE SIZE							
FLOW TUBING PRESSURE							

AS SUBMITTED

RECEIVED
APR 04 2018

OKLAHOMA CORPORATION COMMISSION
DUNCAN OFFICE

A record of the formations drilled through, and pertinent remarks are presented on the reverse. I declare that I have knowledge of the contents of this report and am authorized by my organization to make this report, which was prepared by me or under my supervision and direction, with the data and facts stated herein to be true, correct, and complete to the best of my knowledge and belief.
Signature: Bruce Ayles
NAME (PRINT OR TYPE) Bruce Ayles
DATE 3/27/2018 PHONE NUMBER 580-223-6823
ADDRESS P.O. Box 1588 Ardmore, OK, 73402
CITY Ardmore STATE OK ZIP 73402
EMAIL ADDRESS bruce@kingeryenergy.com

PLEASE TYPE OR USE BLACK INK ONLY
FORMATION RECORD

Give formation names and tops, if available, or descriptions and thickness of formations drilled through. Show intervals cored or drillstem tested.

LEASE NAME Stewart (Northwest Haldton Unit) WELL NO. 4-2

NAMES OF FORMATIONS	TOP
See Original 1002A	

FOR COMMISSION USE ONLY

ITD on file YES NO

APPROVED _____ DISAPPROVED _____

2) Reject Codes

Were open hole logs run? yes no

Date Last log was run _____

Was CO₂ encountered? yes no at what depths? _____

Was H₂S encountered? yes no at what depths? _____

Were unusual drilling circumstances encountered? yes no

If yes, briefly explain below _____

Other remarks: _____

RECEIVED

APR 04 2018

OKLAHOMA
CORPORATION COMMISSION
DUNCAN OFFICE

640 Acres

If more than three drainholes are proposed, attach a separate sheet indicating the necessary information.

Direction must be stated in degrees azimuth. Please note, the horizontal drainhole and its end point must be located within the boundaries of the lease or spacing unit.

Directional surveys are required for all drainholes and directional wells.

640 Acres

BOTTOM HOLE LOCATION FOR DIRECTIONAL HOLE

SEC	TWP	RGE	COUNTY							
Spot Location				1/4	1/4	1/4	1/4	Feet From 1/4 Sec Lines	FSL	FWL
Measured Total Depth				True Vertical Depth		BHL From Lease, Unit, or Property Line:				

BOTTOM HOLE LOCATION FOR HORIZONTAL HOLE: (LATERALS)

LATERAL #1

SEC	TWP	RGE	COUNTY							
Spot Location				1/4	1/4	1/4	1/4	Feet From 1/4 Sec Lines	FSL	FWL
Depth of Deviation				Radius of Turn		Direction		Total Length		
Measured Total Depth				True Vertical Depth		BHL From Lease, Unit, or Property Line:				

LATERAL #2

SEC	TWP	RGE	COUNTY							
Spot Location				1/4	1/4	1/4	1/4	Feet From 1/4 Sec Lines	FSL	FWL
Depth of Deviation				Radius of Turn		Direction		Total Length		
Measured Total Depth				True Vertical Depth		BHL From Lease, Unit, or Property Line:				

LATERAL #3

SEC	TWP	RGE	COUNTY							
Spot Location				1/4	1/4	1/4	1/4	Feet From 1/4 Sec Lines	FSL	FWL
Depth of Deviation				Radius of Turn		Direction		Total Length		
Measured Total Depth				True Vertical Depth		BHL From Lease, Unit, or Property Line:				