

Oklahoma Corporation Commission
Oil & Gas Conservation Division
Post Office Box 52000
Oklahoma City, Oklahoma 73152-2000
Rule 165: 10-3-25

Form 1002A

API No.: 35003232890000

Completion Report

Spud Date: September 23, 2017

OTC Prod. Unit No.: 003-223210

Drilling Finished Date: October 09, 2017

1st Prod Date: March 17, 2018

Completion Date: March 10, 2018

Drill Type: HORIZONTAL HOLE

Min Gas Allowable: Yes

Well Name: ARUBA 2412 2H-15 B

Purchaser/Measurer: SEMGAS

Location: ALFALFA 15 24N 12W
NE NW NW NE
210 FNL 2042 FEL of 1/4 SEC
Latitude: 36.563887568 Longitude: -98.469031901
Derrick Elevation: 0 Ground Elevation: 1319

First Sales Date: 03/23/2018

Operator: MIDSTATES PETROLEUM CO LLC 23079

321 S BOSTON AVE STE 1000
TULSA, OK 74103-3322

Completion Type	
X	Single Zone
	Multiple Zone
	Commingled

Location Exception	
Order No	
668428	

Increased Density	
Order No	
668555	

Casing and Cement							
Type	Size	Weight	Grade	Feet	PSI	SAX	Top of CMT
SURFACE	13 3/8	48	J-55	460		500	SURFACE
INTERMEDIATE	9 5/8	36	J-55	1285		470	SURFACE
PRODUCTION	7	26	P-110	7272		480	4348

Liner								
Type	Size	Weight	Grade	Length	PSI	SAX	Top Depth	Bottom Depth
LINER	4.5	11.6	P-110	4892	0	550	6980	11872

Total Depth: 11872

Packer	
Depth	Brand & Type
There are no Packer records to display.	

Plug	
Depth	Plug Type
There are no Plug records to display.	

Initial Test Data

Test Date	Formation	Oil BBL/Day	Oil-Gravity (API)	Gas MCF/Day	Gas-Oil Ratio Cu FT/BBL	Water BBL/Day	Pumpin or Flowing	Initial Shut-In Pressure	Choke Size	Flow Tubing Pressure
Apr 04, 2018	MISSISSIPPIAN	31	26	92	2968	3152	FLOWING	49	64/64	3732

Completion and Test Data by Producing Formation

Formation Name: MISSISSIPPIAN

Code: 359MSSP

Class: OIL

Spacing Orders

Order No	Unit Size
661283	640

Perforated Intervals

From	To
7320	11775

Acid Volumes

2,304 BARRELS 15% HCL

Fracture Treatments

257,384 BARRELS SLICK WATER, 6,857,924 POUNDS ROCK SALT

Formation	Top
ENDICOTT	4619
HASKELL	4940
TONKAWA	4972
AVANT	5358
COTTAGE GROVE	5414
HOGSHOOTER	5560
BIG LIME	5742
OSWEGO	5786
CHEROKEE	5913
MISSISSIPPI	6304

Were open hole logs run? No

Date last log run:

Were unusual drilling circumstances encountered? No

Explanation:

Other Remarks

OCC - THIS DOCUMENT IS ACCEPTED BASED ON THE DATA SUBMITTED THE FINAL LOCATION EXCEPTION HAS NOT BEEN ISSUED.

Lateral Holes

Sec: 15 TWP: 24N RGE: 12W County: ALFALFA

NW SE SE SW

464 FSL 1988 FWL of 1/4 SEC

Depth of Deviation: 7273 Radius of Turn: 1376 Direction: 181 Total Length: 4600

Measured Total Depth: 11872 True Vertical Depth: 6385 End Pt. Location From Release, Unit or Property Line: 464

FOR COMMISSION USE ONLY

1139276

Status: Accepted

RECEIVED

Form 1002A Rev. 2009

APR 06 2018

OKLAHOMA CORPORATION COMMISSION

API NO. 003 23289
OTC PROD. UNIT NO. 003 223210

PLEASE TYPE OR USE BLACK INK ONLY
NOTE:

Attach copy of original 1002A if recompletion or reentry.

OKLAHOMA CORPORATION COMMISSION
Oil & Gas Conservation Division
Post Office Box 52000
Oklahoma City, Oklahoma 73152-2000
Rule 165:10-3-25

ORIGINAL
AMENDED (Reason)

COMPLETION REPORT

TYPE OF DRILLING OPERATION
STRAIGHT HOLE
DIRECTIONAL HOLE
HORIZONTAL HOLE
SERVICE WELL
If directional or horizontal, see reverse for bottom hole location.

SPUD DATE 09/23/2017
DRLG FINISHED DATE 10/09/2017
DATE OF WELL COMPLETION 03/10/2018
1st PROD DATE 03/17/2018
RECOMP DATE
Longitude (if known) -98.469031901
OTC/OCC OPERATOR NO. 23079

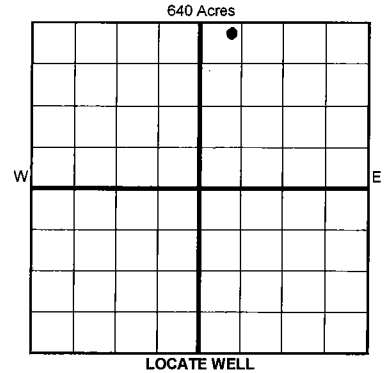

COUNTY Alfalfa SEC 15 TWP 24N RGE 12W
LEASE NAME Aruba 2412
WELL NO. 2H-15 B
NE 1/4 NW 1/4 NW 1/4 NE 1/4 OF 1/4 SEC 210N OF 1/4 SEC 2042E
ELEVATIO N Demick Ground 1319 Latitude (if known) 36.563887568
OPERATOR NAME Midstates Petroleum Company LLC
ADDRESS 321 South Boston, Suite 1000
CITY Tulsa STATE OK ZIP 74103

COMPLETION TYPE
SINGLE ZONE
MULTIPLE ZONE
COMINGLED
LOCATION EXCEPTION ORDER 668428 I.D.
INCREASED DENSITY ORDER NO. 668555

Table with 8 columns: TYPE, SIZE, WEIGHT, GRADE, FEET, PSI, SAX, TOP OF CMT. Rows include CONDUCTOR, SURFACE, INTERMEDIATE, PRODUCTION, LINER, and TOTAL DEPTH.

PACKER @ BRAND & TYPE PLUG @ TYPE PLUG @ TYPE
PACKER @ BRAND & TYPE PLUG @ TYPE PLUG @ TYPE

COMPLETION & TEST DATA BY PRODUCING FORMATION 359 MESSP

Table with 8 columns: FORMATION, SPACING & SPACING ORDER NUMBER, CLASS, PERFORATED INTERVALS, ACID/VOLUME, FRACTURE TREATMENT, Min Gas Allowable, Gas Purchaser/Measurer, First Sales Date.

INITIAL TEST DATA

Table with 8 columns: INITIAL TEST DATE, OIL-BBL/DAY, OIL-GRAVITY (API), GAS-MCF/DAY, GAS-OIL RATIO CU FT/BBL, WATER-BBL/DAY, PUMPING OR FLOWING, INITIAL SHUT-IN PRESSURE, CHOKE SIZE, FLOW TUBING PRESSURE.

AS SUBMITTED

A record of the formations drilled through, and pertinent remarks are presented on the reverse. I declare that I have knowledge of the contents of this report and am authorized by my organization to make this report, which was prepared by me or under my supervision and direction, with the data, and facts stated herein to be true, correct, and complete to the best of my knowledge and belief.
Signature: Chelce Rouse
Date: 02/28/2018
Phone Number: 918-947-4647
Address: 321 South Boston, Suite 1000 Tulsa, OK 74103
Email: chelce.rouse@midstatespetroleum.com

PLEASE TYPE OR USE BLACK INK ONLY
FORMATION RECORD

Give formation names and tops, if available, or descriptions and thickness of formations drilled through. Show intervals cored or drillstem tested.

LEASE NAME Aruba 2412

WELL NO. 2H-15 B

NAMES OF FORMATIONS	TOP
ENDICOTT	4,619
HASKELL	4,940
TONKAWA	4,972
AVANT	5,358
COTTAGE GROVE	5,414
HOGSHOOTER	5,560
BIG LIME	5,742
OSWEGO	5,786
CHEROKEE	5,913
MISSISSIPPI	6,304

FOR COMMISSION USE ONLY

ITD on file YES NO

APPROVED _____ DISAPPROVED _____

2) Reject Codes

Were open hole logs run? yes no

Date Last log was run N/A

Was CO₂ encountered? yes no at what depths? _____

Was H₂S encountered? yes no at what depths? _____

Were unusual drilling circumstances encountered? yes no

If yes, briefly explain below

Other remarks:

640 Acres

If more than three drainholes are proposed, attach a separate sheet indicating the necessary information.

Direction must be stated in degrees azimuth. Please note, the horizontal drainhole and its end point must be located within the boundaries of the lease or spacing unit.

Directional surveys are required for all drainholes and directional wells.

640 Acres

BOTTOM HOLE LOCATION FOR DIRECTIONAL HOLE

SEC	TWP	RGE	COUNTY			
Spot Location	1/4	1/4	1/4	Feet From 1/4 Sec Lines	FSL	FWL
Measured Total Depth	True Vertical Depth		BHL From Lease, Unit, or Property Line:			

BOTTOM HOLE LOCATION FOR HORIZONTAL HOLE: (LATERALS)

LATERAL #1

SEC	TWP	RGE	COUNTY				
15	24N	12W	Alfalfa				
Spot Location	1/4	1/4	1/4	Feet From 1/4 Sec Lines	FSL	FWL	
SE NW 1/4 SE 1/4 SW 1/4				464	1988		
Depth of Deviation	7,273	Radius of Turn	1,376	Direction	180.90	Total Length	4,600
Measured Total Depth	11,872	True Vertical Depth	6,385	BHL From Lease, Unit, or Property Line: 464			

LATERAL #2

SEC	TWP	RGE	COUNTY			
Spot Location	1/4	1/4	1/4	Feet From 1/4 Sec Lines	FSL	FWL
Depth of Deviation	Radius of Turn		Direction		Total Length	
Measured Total Depth	True Vertical Depth		BHL From Lease, Unit, or Property Line:			

LATERAL #3

SEC	TWP	RGE	COUNTY			
Spot Location	1/4	1/4	1/4	Feet From 1/4 Sec Lines	FSL	FWL
Depth of Deviation	Radius of Turn		Direction		Total Length	
Measured Total Depth	True Vertical Depth		BHL From Lease, Unit, or Property Line:			