

Oklahoma Corporation Commission
 Oil & Gas Conservation Division
 Post Office Box 52000
 Oklahoma City, Oklahoma 73152-2000
 Rule 165: 10-3-25

Form 1002A

API No.: 35081241270001

Completion Report

Spud Date: April 18, 2013

OTC Prod. Unit No.:

Drilling Finished Date: April 29, 2013

Amended

1st Prod Date:

Amend Reason: ARBUCKLE SALT WATER DISPOSAL PLUGBACK

Completion Date: November 15, 2013

Recomplete Date: November 04, 2015

Drill Type: STRAIGHT HOLE

SERVICE WELL

Well Name: DONALDSON 1-21 SWD

Purchaser/Measurer:

Location: LINCOLN 21 17N 6E
 NW NE NE NE
 2415 FSL 2290 FWL of 1/4 SEC
 Latitude: 35.9419346 Longitude: -96.660980098
 Derrick Elevation: 866 Ground Elevation: 849

First Sales Date:

Operator: MEASON PETROLEUM LLC 23036

234 W 13TH ST
 TULSA, OK 74119-3026

Completion Type	
X	Single Zone
	Multiple Zone
	Commingled

Location Exception
Order No
There are no Location Exception records to display.

Increased Density
Order No
There are no Increased Density records to display.

Casing and Cement							
Type	Size	Weight	Grade	Feet	PSI	SAX	Top of CMT
SURFACE	9 5/8	36	J-55	785	400	325	SURFACE
PRODUCTION	7	26	N-80	3953	1250	225	1720

Liner								
Type	Size	Weight	Grade	Length	PSI	SAX	Top Depth	Bottom Depth
There are no Liner records to display.								

Total Depth: 5130

Packer	
Depth	Brand & Type
3943	AS-1X

Plug	
Depth	Plug Type
4819	CEMENT

Initial Test Data

Test Date	Formation	Oil BBL/Day	Oil-Gravity (API)	Gas MCF/Day	Gas-Oil Ratio Cu FT/BBL	Water BBL/Day	Pumpin or Flowing	Initial Shut-In Pressure	Choke Size	Flow Tubing Pressure
-----------	-----------	-------------	-------------------	-------------	-------------------------	---------------	-------------------	--------------------------	------------	----------------------

There are no Initial Data records to display.

Completion and Test Data by Producing Formation

Formation Name: ARBUCKLE

Code: 169ABCK

Class: DISP

Spacing Orders

Order No	Unit Size
There are no Spacing Order records to display.	

Perforated Intervals

From	To
There are no Perf. Intervals records to display.	

Acid Volumes

There are no Acid Volume records to display.
--

Fracture Treatments

NO TREATMENT

Formation	Top
1ST OSWEGO	2605
2ND OSWEGO	2659
SKINNER	2802
RED FORK	2994
ATOKA	3219
MISSISSIPPIAN	3288
WOODFORD	3414
VIOLA	3490
BROMIDE	3555
ARBUCKLE	3915
ARBUCKLE (BASE)	4986

Were open hole logs run? Yes

Date last log run: April 25, 2013

Were unusual drilling circumstances encountered? No

Explanation:

Other Remarks

WELL IS AN OPEN HOLE COMPLETION FROM THE BOTTOM OF THE 7" CASING @ 3,953' TO PBTD AT 4,819'. UIC PERMIT NUMBER 1305570017. WELL WAS PLUGGED BACK PER OCC - UIC REQUIREMENTS. OPERATIONS WERE PERFORMED "THROUGH-TUBING", THEREFORE PACKER WAS NOT MOVED NOR MIT REQUIRED.

FOR COMMISSION USE ONLY

1139273

Status: Accepted

RECEIVED

Form 1002A Rev. 2009

APR 06 2018

OKLAHOMA CORPORATION COMMISSION

API NO. 081-24127

PLEASE TYPE OR USE BLACK INK ONLY NOTE:

Attach copy of original 1002A if recompletion or reentry.

OKLAHOMA CORPORATION COMMISSION Oil & Gas Conservation Division Post Office Box 52000 Oklahoma City, Oklahoma 73152-2000 Rule 165.10-3-2b

ORIGINAL AMENDED (Reason)

Arbuckle SWD plugback

COMPLETION REPORT

TYPE OF DRILLING OPERATION

STRAIGHT HOLE SERVICE WELL DIRECTIONAL HOLE HORIZONTAL HOLE

if directional or horizontal, see reverse for bottom hole location.

Form with fields: COUNTY Lincoln, SEC 21, TWP 17N, RGE 6E, LEASE NAME Donaldson, WELL NO - 21 SWD, NW 1/4 NE 1/4 NE 1/4 NE 1/4, ELEVATION 866' KB Ground 849', OPERATOR Meason Petroleum LLC, ADDRESS 234 W. 13th St, CITY Tulsa, STATE Oklahoma, ZIP 74119

Form with fields: SPUD DATE 4/18/2013, DRILLING FINISHED DATE 4/29/2013, DATE OF WELL COMPLETION 11/15/2013, 1st PROD DATE N/A, RECOMP DATE 11/4/2015, Longitude - 96.660980098

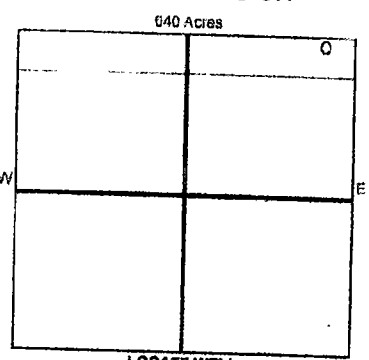

COMPLETION TYPE: SINGLE ZONE, MULTIPLE ZONE, LOCATION, EXCEPTION ORDER, INCREASED DENSITY, ORDER NO.

CASING & CEMENT (Form 1002C must be attached) table with columns: TYPE, SIZE, WEIGHT, GRADE, FEET, IPS, SAG, TOP OF CMT. Rows include CONDUCTION, SURFACE, INTERMEDIATE, PRODUCTION, LINER.

PACKER @ 3,943' BRAND & TYPE AS-1X PLUG @ 4819' TYPE CMT TOTAL DEPTH 5130'

COMPLETION & TEST DATA BY PRODUCING FORMATION: Arbuckle, ORDER NUMBER (plugback 11/4/15), CLASS Oil, Gas, Dry, Inj., Disp, Comm Disp, Svc, PERFORATED INTERVALS open hole, ACID/VOLUME no treatment, FRACTURE TREATMENT (Fluids/Prop Amounts)

INITIAL TEST DATA: Min Gas Allowable OR Gas Purchaser/Measurer, Oil Allowable First Sales Date

INITIAL TEST DATE None, OIL-BBL/DAY, OIL-GRAVITY (API), GAS-MCF/DAY, GAS-OIL RATIO CU FT/BBL, WATER-BBL/DAY, PUMPING OR FLOWING, INITIAL SHUT-IN PRESSURE, CHOKE SIZE, FLOW TUBING PRESSURE

AS SUBMITTED

A record of the formations drilled through and pertinent remarks are presented on the reverse. I declare that I have knowledge of the contents of this report and am authorized by my organization to make this report, which was prepared by me or under my supervision and direction with the data and facts stated herein to be true, correct, and complete to the best of my knowledge and belief. SIGNATURE Steven R. Hasn, EXACT Engrg Inc, ADDRESS 20 E 5th, Ste 310, Tulsa, OK 74103, DATE 2/25/2016, PHONE NUMBER 918-599-9400, EMAIL ADDRESS stevehash@exactengineering.com

