

Oklahoma Corporation Commission
Oil & Gas Conservation Division
Post Office Box 52000
Oklahoma City, Oklahoma 73152-2000
Rule 165: 10-3-25

Form 1002A

API No.: 35109223870003

Completion Report

Spud Date: August 23, 2012

OTC Prod. Unit No.: N/A

Drilling Finished Date: October 04, 2012

Amended

1st Prod Date:

Amend Reason: CHANGE FORMATION / PACKER DEPTH

Completion Date: December 22, 2012

Recomplete Date: March 01, 2018

Drill Type: STRAIGHT HOLE

SERVICE WELL

Well Name: DAHL SWD FACILITY 1

Purchaser/Measurer:

Location: OKLAHOMA 31 14N 3W
SE SE NW SE
1636 FSL 1005 FWL of 1/4 SEC
Derrick Elevation: 1157 Ground Elevation: 1144

First Sales Date:

Operator: DAHL SWD FACILITY #1 LLC 23986

5661 N CLASSEN BLVD
OKLAHOMA CITY, OK 73118-4015

Completion Type	
X	Single Zone
	Multiple Zone
	Commingled

Location Exception	
Order No	
There are no Location Exception records to display.	

Increased Density	
Order No	
There are no Increased Density records to display.	

Casing and Cement							
Type	Size	Weight	Grade	Feet	PSI	SAX	Top of CMT
CONDUCTOR	20	94	J-55	42	4000	10	SURFACE
SURFACE	9 5/8	36	J-55	90	4000	540	SURFACE
PRODUCTION	7	26	J-55	7230	7000	290	5540

Liner								
Type	Size	Weight	Grade	Length	PSI	SAX	Top Depth	Bottom Depth
There are no Liner records to display.								

Total Depth: 9705

Packer	
Depth	Brand & Type
6586	AS-IX NP

Plug	
Depth	Plug Type
7130	CIBP
9651	CEMENT

Initial Test Data

Test Date	Formation	Oil BBL/Day	Oil-Gravity (API)	Gas MCF/Day	Gas-Oil Ratio Cu FT/BBL	Water BBL/Day	Pumpin or Flowing	Initial Shut-In Pressure	Choke Size	Flow Tubing Pressure
-----------	-----------	-------------	-------------------	-------------	-------------------------	---------------	-------------------	--------------------------	------------	----------------------

There are no Initial Data records to display.

Completion and Test Data by Producing Formation

Formation Name: WILCOX

Code: 202WLCX

Class: COMM DISP

Spacing Orders

Order No

Unit Size

There are no Spacing Order records to display.

Perforated Intervals

From

To

6625

6630

6650

6770

Acid Volumes

5,600 GALLONS 15% HCL

Fracture Treatments

NO

Formation	Top
WILCOX	6602

Were open hole logs run? Yes

Date last log run: November 02, 2012

Were unusual drilling circumstances encountered? No

Explanation:

Other Remarks

LAID DOWN 4-1/2" SEAL-TITE TUBING. SET CIBP @ 7,130', WITNESSED BY OCC. MAKE BAILER RUN WITH 2 SACKS CEMENT ON PLUG. PERFORATE, ACIDIZE, RUN 4-1/2" SEAL-TITE TUBING AND PACKER. PERFORM MIT. APPROVED BY OCC. ORDER NUMBER 674191

FOR COMMISSION USE ONLY

1139237

Status: Accepted

109-22387-03

RECEIVED

Form 1002A Rev. 2009

MAR 29 2018

API NO. 109-22387-03
OTC PROD. NA
UNIT NO.

PLEASE TYPE OR USE BLACK INK ONLY

NOTE:

Attach copy of original 1002A if recompletion or reentry.

OKLAHOMA CORPORATION COMMISSION
Oil & Gas Conservation Division
Post Office Box 52000
Oklahoma City, Oklahoma 73152-2000
Rule 165:10-3-25

OKLAHOMA CORPORATION COMMISSION

ORIGINAL
[X] AMENDED (Reason)

Change FORMATION / Packer Depth

COMPLETION REPORT

TYPE OF DRILLING OPERATION
[X] STRAIGHT HOLE
[X] SERVICE WELL

SPUD DATE 08/23/12
DRLG FINISHED DATE 10/04/12
DATE OF WELL COMPLETION 12/22/12
1st PROD DATE NA
RECOMP DATE NA

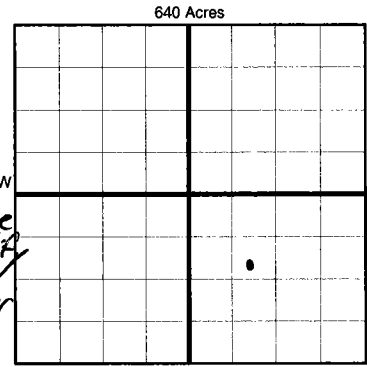

COUNTY OKLAHOMA SEC 31 TWP 14N RGE 3W
LEASE NAME DAHL SWD FACILITY WELL NO. 1

SE 1/4 NW 1/4 SE 1/4 1/4 FSL OF 1/4 SEC 1638 FWL OF 1/4 SEC 1005
ELEVATION Derrick FL 1157 Ground 1144 Latitude (if known)

OPERATOR NAME DAHL SWD FACILITY #1, LLC OTC/OCC OPERATOR NO. 23986

ADDRESS 5661 N. Classen Blvd

CITY OKla city STATE OK ZIP 73118-4015

COMPLETION TYPE
[X] SINGLE ZONE
MULTIPLE ZONE
LOCATION
EXCEPTION ORDER
INCREASED DENSITY
ORDER NO.

Table with 8 columns: TYPE, SIZE, WEIGHT, GRADE, FEET, PSI, SAX, TOP OF CMT. Rows include CONDUCTOR, SURFACE, INTERMEDIATE, PRODUCTION, LINER.

PACKER @ 6586' BRAND & TYPE AS-IX NP PLUG @ 7130' TYPE CIBP PLUG @ 9651' TYPE CEMENT TOTAL DEPTH 9705

COMPLETION & TEST DATA BY PRODUCING FORMATION
FORMATION WILCOX
SPACING & SPACING ORDER NUMBER COMM.DISPOSAL
PERFORATED INTERVALS 6625'-6630' - 4SPF
ACID/VOLUME 5,600 GAL, 15% HCL
FRACTURE TREATMENT NO

Min Gas Allowable (165:10-17-7) OR Oil Allowable (165:10-13-3) Gas Purchaser/Measurer First Sales Date

INITIAL TEST DATA table with columns for INITIAL TEST DATE, OIL-BBL/DAY, GAS-MCF/DAY, etc.

AS SUBMITTED

A record of the formations drilled through, and pertinent remarks are presented on the reverse. I declare that I have knowledge of the contents of this report and am authorized by my organization to make this report which was prepared by me or under my supervision and direction, with the data and facts stated herein to be true, correct, and complete to the best of my knowledge and belief.
WILLIAM M. TAYLOR
5661 N. CLASSEN BOULEVARD OKLAHOMA CITY OK 73118

PLEASE TYPE OR USE BLACK INK ONLY

FORMATION RECORD

Give formation names and tops, if available, or descriptions and thickness of formations drilled through. Show intervals cored or drillstem tested.

LEASE NAME DAHL SWD FACILITY WELL NO. 1

NAMES OF FORMATIONS	TOP
WILCOX	6,602

FOR COMMISSION USE ONLY

ITD on file YES NO

APPROVED _____ DISAPPROVED _____

2) Reject Codes

Were open hole logs run? yes no

Date Last log was run 11/2/2012

Was CO₂ encountered? yes no at what depths? _____

Was H₂S encountered? yes no at what depths? _____

Were unusual drilling circumstances encountered? yes no

If yes, briefly explain below

Other remarks: Laid down 4-1/2" seal-tite tubing. Set CIBP @ 7,130', witnessed by OCC. Make bailer run w/2 sacks cement on plug. Perforate acidize, run 4-1/2" seal-tite tubing and packer. Perform MIT. Approved by OCC. ORDER 674191

640 Acres

If more than three drainholes are proposed, attach a separate sheet indicating the necessary information.

Direction must be stated in degrees azimuth. Please note, the horizontal drainhole and its end point must be located within the boundaries of the lease or spacing unit.

Directional surveys are required for all drainholes and directional wells.

640 Acres

BOTTOM HOLE LOCATION FOR DIRECTIONAL HOLE

SEC	TWP	RGE	COUNTY							
Spot Location				1/4	1/4	1/4	1/4	Feet From 1/4 Sec Lines	FSL	FWL
Measured Total Depth				True Vertical Depth		BHL From Lease, Unit, or Property Line:				

BOTTOM HOLE LOCATION FOR HORIZONTAL HOLE: (LATERALS)

LATERAL #1

SEC	TWP	RGE	COUNTY							
Spot Location				1/4	1/4	1/4	1/4	Feet From 1/4 Sec Lines	FSL	FWL
Depth of Deviation				Radius of Turn		Direction		Total Length		
Measured Total Depth				True Vertical Depth		BHL From Lease, Unit, or Property Line:				

LATERAL #2

SEC	TWP	RGE	COUNTY							
Spot Location				1/4	1/4	1/4	1/4	Feet From 1/4 Sec Lines	FSL	FWL
Depth of Deviation				Radius of Turn		Direction		Total Length		
Measured Total Depth				True Vertical Depth		BHL From Lease, Unit, or Property Line:				

LATERAL #3

SEC	TWP	RGE	COUNTY							
Spot Location				1/4	1/4	1/4	1/4	Feet From 1/4 Sec Lines	FSL	FWL
Depth of Deviation				Radius of Turn		Direction		Total Length		
Measured Total Depth				True Vertical Depth		BHL From Lease, Unit, or Property Line:				