

OKLAHOMA CORPORATION COMMISSION
OIL & GAS CONSERVATION DIVISION
P.O. BOX 52000
OKLAHOMA CITY, OK 73152-2000
(Rule 165:10-3-1)

API NUMBER: 063 24775

Approval Date: 02/23/2018
Expiration Date: 08/23/2018

Horizontal Hole Oil & Gas

PERMIT TO DRILL

WELL LOCATION: Sec: 27 Twp: 8N Rge: 10E County: HUGHES
SPOT LOCATION: SE NE NW NW FEET FROM QUARTER: FROM NORTH FROM WEST
SECTION LINES: 340 1185

Lease Name: DEBRA Well No: 3-22/15H Well will be 340 feet from nearest unit or lease boundary.

Operator Name: TRINITY OPERATING (USG) LLC Telephone: 9185615631 OTC/OCC Number: 23879 0

TRINITY OPERATING (USG) LLC
1717 S BOULDER AVE STE 201
TULSA, OK 74119-4842

WADE BAGWELL
2465 HIGHWAY 75
WETUMKA OK 74883

Formation(s) (Permit Valid for Listed Formations Only):

Name	Depth	Name	Depth
1 WOODFORD	4229	6	
2		7	
3		8	
4		9	
5		10	

Spacing Orders: 671322

Location Exception Orders:

Increased Density Orders:

Pending CD Numbers: 201800462
201800463
201800464
201800465
201800456

Special Orders:

Total Depth: 14807 Ground Elevation: 797 Surface Casing: 410 Depth to base of Treatable Water-Bearing FM: 360

Under Federal Jurisdiction: No Fresh Water Supply Well Drilled: No Surface Water used to Drill: No

PIT 1 INFORMATION

Type of Pit System: ON SITE
Type of Mud System: AIR

Is depth to top of ground water greater than 10ft below base of pit? Y
Within 1 mile of municipal water well? N
Wellhead Protection Area? N

Pit is not located in a Hydrologically Sensitive Area.

Category of Pit: 4

Liner not required for Category: 4

Pit Location is NON HSA

Pit Location Formation: WETUMKA

Mud System Change to Water-Based or Oil-Based Mud Requires an Amended Intent (Form 1000).

Approved Method for disposal of Drilling Fluids:

A. Evaporation/dewater and backfilling of reserve pit.

E. Haul to Commercial pit facility: Sec. 19 Twn. 8N Rng. 5E Cnty. 125 Order No: 274874

H. SEE MEMO

This permit does not address the right of entry or settlement of surface damages.
The duration of this permit is SIX MONTHS, except as otherwise provided by Rule 165: 10-3-1.
Rule 165: 10-3-4 (c) (7) (e) - The Operator shall give 24 Hours notice by telephone to the appropriate District Office of the Conservation Division as to when Surface Casing will be run.

PIT 2 INFORMATION

Type of Pit System: CLOSED Closed System Means Steel Pits

Type of Mud System: WATER BASED

Chlorides Max: 8000 Average: 5000

Is depth to top of ground water greater than 10ft below base of pit? Y

Within 1 mile of municipal water well? N

Wellhead Protection Area? N

Pit is not located in a Hydrologically Sensitive Area.

Category of Pit: C

Liner not required for Category: C

Pit Location is NON HSA

Pit Location Formation: WETUMKA

PIT 3 INFORMATION

Type of Pit System: CLOSED Closed System Means Steel Pits

Type of Mud System: OIL BASED

Chlorides Max: 300000 Average: 200000

Is depth to top of ground water greater than 10ft below base of pit? Y

Within 1 mile of municipal water well? N

Wellhead Protection Area? N

Pit is not located in a Hydrologically Sensitive Area.

Category of Pit: C

Liner not required for Category: C

Pit Location is NON HSA

Pit Location Formation: WETUMKA

HORIZONTAL HOLE 1

Sec 15 Twp 8N Rge 10E County HUGHES

Spot Location of End Point: NW NE NW NW

Feet From: NORTH 1/4 Section Line: 1

Feet From: WEST 1/4 Section Line: 830

Depth of Deviation: 3729

Radius of Turn: 496

Direction: 355

Total Length: 10299

Measured Total Depth: 14807

True Vertical Depth: 4229

End Point Location from Lease,
Unit, or Property Line: 1

Notes:

This permit does not address the right of entry or settlement of surface damages.
The duration of this permit is SIX MONTHS, except as otherwise provided by Rule 165: 10-3-1.
Rule 165: 10-3-4 (c) (7) (e) - The Operator shall give 24 Hours notice by telephone to the appropriate District Office of the Conservation Division as to when Surface Casing will be run.

Category	Description
HYDRAULIC FRACTURING	2/20/2018 - G71 - OCC 165:10-3-10 REQUIRES: 1) PRIOR TO COMMENCEMENT OF HYDRAULIC FRACTURING OPERATIONS FOR HORIZONTAL WELLS, NOTICE GIVEN FIVE BUSINESS DAYS IN ADVANCE TO OFFSET OPERATORS WITH WELLS COMPLETED IN THE SAME COMMON SOURCE OF SUPPLY WITHIN 1/2 MILE; 2) WITH NOTICE ALSO GIVEN 48 HOURS IN ADVANCE OF HYDRAULIC FRACTURING ALL WELLS TO BOTH THE OCC CENTRAL OFFICE AND LOCAL DISTRICT OFFICES, USING THE "FRAC NOTICE FORM" FOUND AT THE FOLLOWING LINK: OCCEWEB.COM/OG/OGFORMS.HTML ; AND, 3) THE CHEMICAL DISCLOSURE OF HYDRAULIC FRACTURING INGREDIENTS FOR ALL WELLS TO BE REPORTED TO FRACFOCUS WITHIN 60 DAYS AFTER THE CONCLUSION THE HYDRAULIC FRACTURING OPERATIONS, USING THE FOLLOWING LINK: FRACFOCUS.ORG
MEMO	2/20/2018 - G71 - PIT 2 & 3 - CLOSED SYSTEM=STEEL PITS PER OPERATOR REQUEST, WBM & OBM CUTTINGS CAPTURED IN CONCRETE-LINED PIT, SOLIDIFIED AND HELD UNTIL DISPOSAL APPROVED BY OCC; PIT 3 - OBM TO VENDOR
PENDING CD - 201800456	2/23/2018 - G58 - (640)(HOR) 15-8N-10E EXT OTHERS EXT 670240 WDFD, OTHER COMPL. INT. NCT 165' FNL & FSL, NCT 330' FEL & FWL (COEXIST SP. ORDER 162928 OTHER; SP. ORDER 147633 OTHER) REC 2/5/2018 (DUNN)
PENDING CD - 201800462	2/23/2018 - G58 - (I.O.) 15 & 22-8N-10E EST MULTIUNIT HORIZONTAL WELL X201800456 WDFD (15-8N-10E) X671322 WDFD (22-8N-10E) 50% 15-8N-10E 50% 22-8N-10E NO OP. NAMED REC 2/5/2018 (DUNN)
PENDING CD - 201800463	2/23/2018 - G58 - (I.O.) 15 & 22-8N-10E X201800456 WDFD (15-8N-10E) X671322 WDFD (22-8N-10E) COMPL. INT. (22-8N-10E) NCT 0' FNL, NCT 165' FSL, NCT 330' FWL COMPL. INT. (15-8N-10E) NCT 0' FSL, NCT 165' FNL, NCT 330' FWL NO OP. NAMED REC 2/5/2018 (DUNN)
PENDING CD - 201800464	2/23/2018 - G58 - (I.O.) 15-8N-10E X201800456 WDFD 2 WELLS NO OP. NAMED REC 2/5/2018 (DUNN)
PENDING CD - 201800465	2/23/2018 - G58 - (I.O.) 22-8N-10E X671322 WDFD 2 WELLS NO OP. NAMED REC 2/5/2018 (DUNN)
SPACING - 671322	2/23/2018 - G58 - (640)(HOR) 22-8N-10E EST WDFD, OTHERS COMPL. INT. NCT 165' FNL & FSL, NCT 330' FEL & FWL (COEXIST SP. ORDER 147633, OTHERS)

This permit does not address the right of entry or settlement of surface damages.
The duration of this permit is SIX MONTHS, except as otherwise provided by Rule 165: 10-3-1.
Rule 165: 10-3-4 (c) (7) (e) - The Operator shall give 24 Hours notice by telephone to the appropriate District Office of the Conservation Division as to when Surface Casing will be run.



Well Location Plat

S.H.L. Sec. 27-8N-10E I.M.
B.H.L. Sec. 15-8N-10E I.M.

Operator: TRINITY OPERATING
Lease Name and No.: DEBRA 3-22/15H
Footage: 340' FNL - 1185' FWL Gr. Elevation: 797'
Section: 27 Township: 8N Range: 10E I.M.
County: Hughes State of Oklahoma
Terrain at Loc.: Location fell in open pasture.

063-24775



All bearings shown
are grid bearings.



1" = 1500'

GPS DATUM
NAD 27
OK SOUTH ZONE

Surface Hole Loc.:
Lat: 35°08'37.88"N
Lon: 96°14'36.64"W
X: 2525126
Y: 663454

Landing Point:
Lat: 35°08'43.92"N
Lon: 96°14'40.90"W
X: 2524761
Y: 664058

Bottom Hole Loc.:
Lat: 35°10'25.79"N
Lon: 96°14'40.90"W
X: 2524582
Y: 674357

Please note that the location was obtained on the ground under the supervision of a Licensed Professional Land Surveyor, but the accuracy of the survey is not guaranteed. Please contact Arkoma Surveying and Mapping, PLLC if any inconsistency is determined. GPS data is obtained from RTK - GPS. The accuracy of the GPS data is dependent on the quality of the GPS receiver and the quality of the ground, and further, does NOT represent a true boundary. Surveyed section distances may be assumed from a Government Survey Plat or returned as a proportionate distance from opposing section corners, or occupation measured as the surveyor's survey.

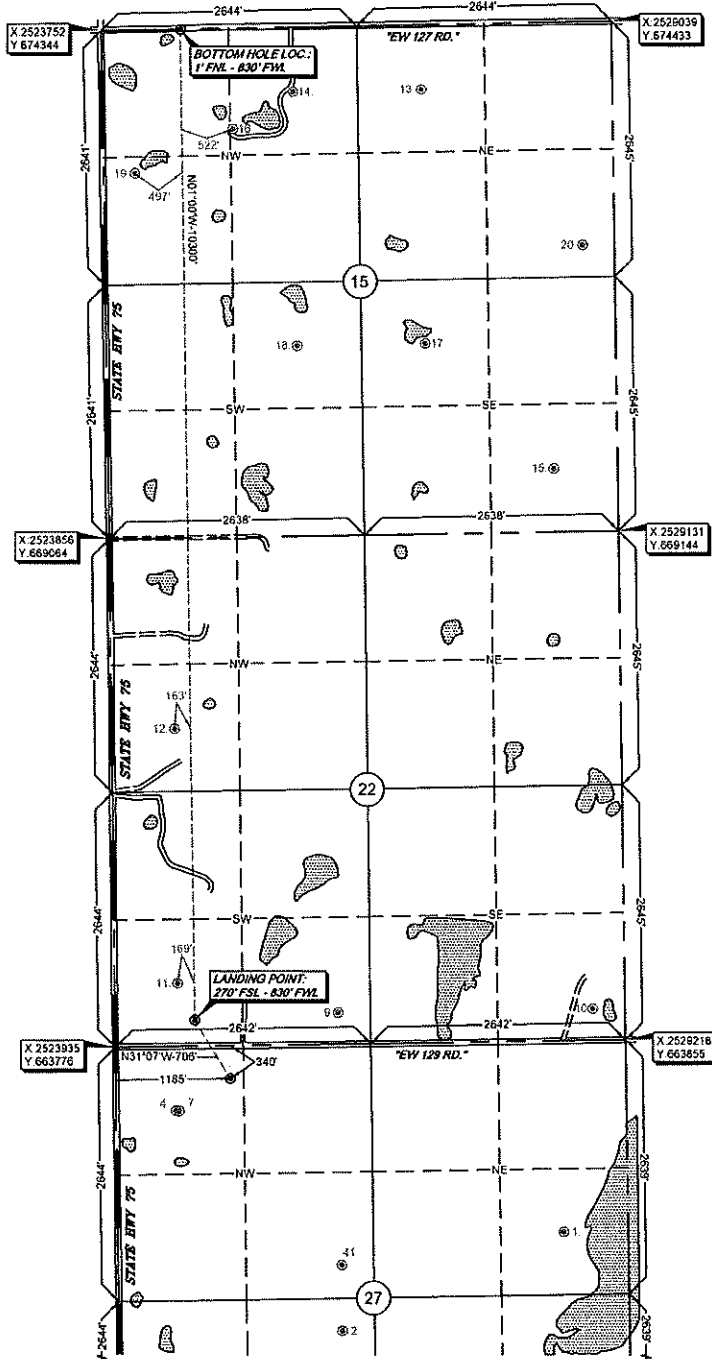

Survey and plat by:
Arkoma Surveying and Mapping, PLLC
P.O. Box 238 Wilburton, OK 74578
Ph. 918-465-5711 Fax 918-465-5030
Certificate of Authorization No. 5348
Expires June 30, 2018

Invoice #7623-B
Date Staked: 12/11/17 By: D.A.
Date Drawn: 12/13/17 By: C.K.

Certification:
This is to certify that this Well Location Plat represents the results of a survey made on the ground performed under the supervision of the undersigned.

LANCE G. MATHIS
12/22/17
OK LPLS 1664

