

Oklahoma Corporation Commission
 Oil & Gas Conservation Division
 Post Office Box 52000
 Oklahoma City, Oklahoma 73152-2000
 Rule 165: 10-3-25

Form 1002A

API No.: 35053234580000

Completion Report

Spud Date: October 03, 2017

OTC Prod. Unit No.:

Drilling Finished Date: October 14, 2017

1st Prod Date:

Completion Date: December 14, 2017

Drill Type: STRAIGHT HOLE

Well Name: GLENDA 1-14

Purchaser/Measurer:

Location: GRANT 14 26N 8W
 NW NW NW NW
 2458 FSL 210 FWL of 1/4 SEC
 Derrick Elevation: 1120 Ground Elevation: 1107

First Sales Date:

Operator: UNION VALLEY PETROLEUM CORP 12075

5302 N HIGHWAY 81
 ENID, OK 73701-6932

| Completion Type | |
|-------------------------------------|---------------|
| <input type="checkbox"/> | Single Zone |
| <input type="checkbox"/> | Multiple Zone |
| <input checked="" type="checkbox"/> | Commingled |

| Location Exception |
|---|
| Order No |
| There are no Location Exception records to display. |

| Increased Density |
|--|
| Order No |
| There are no Increased Density records to display. |

| Casing and Cement | | | | | | | |
|-------------------|-------|--------|-------|------|-----|-----|------------|
| Type | Size | Weight | Grade | Feet | PSI | SAX | Top of CMT |
| SURFACE | 8.625 | 24 | J-55 | 510 | | 285 | SURFACE |
| PRODUCTION | 5.5 | 17 | J-55 | 6059 | | 230 | 4460 |

| Liner | | | | | | | | |
|--|------|--------|-------|--------|-----|-----|-----------|--------------|
| Type | Size | Weight | Grade | Length | PSI | SAX | Top Depth | Bottom Depth |
| There are no Liner records to display. | | | | | | | | |

Total Depth: 6059

| Packer | |
|---|--------------|
| Depth | Brand & Type |
| There are no Packer records to display. | |

| Plug | |
|-------|-----------|
| Depth | Plug Type |
| 5900 | CIBP |

| Initial Test Data |
|-------------------|
| |

| Test Date | Formation | Oil BBL/Day | Oil-Gravity (API) | Gas MCF/Day | Gas-Oil Ratio Cu FT/BBL | Water BBL/Day | Pumpin or Flowing | Initial Shut-In Pressure | Choke Size | Flow Tubing Pressure |
|--------------|------------------|-------------|-------------------|-------------|-------------------------|---------------|-------------------|--------------------------|------------|----------------------|
| Nov 03, 2017 | MISENER | | | | | 18 | PUMPING | | 64/64 | |
| Nov 08, 2017 | MISSISSIPPI CHAT | 5 | 39 | 92 | 18400 | 90 | PUMPING | 710 | 64/64 | |
| Dec 14, 2017 | OSWEGO | 1 | 40 | 78 | 78000 | 26 | PUMPING | 780 | 64/64 | |

Completion and Test Data by Producing Formation

Formation Name: MISENER

Code: 319MSNR

Class: DRY

Spacing Orders

| Order No | Unit Size |
|----------|-----------|
| 666845 | 640 |

Perforated Intervals

| From | To |
|------|------|
| 5942 | 5944 |

Acid Volumes

There are no Acid Volume records to display.

Fracture Treatments

There are no Fracture Treatments records to display.

Formation Name: MISSISSIPPI CHAT

Code: 401MSSCT

Class: GAS

Spacing Orders

| Order No | Unit Size |
|----------|-----------|
| 666845 | 640 |

Perforated Intervals

| From | To |
|------|------|
| 5287 | 5298 |

Acid Volumes

2,850 GALLONS

Fracture Treatments

There are no Fracture Treatments records to display.

Formation Name: OSWEGO

Code: 404OSWG

Class: GAS

Spacing Orders

| Order No | Unit Size |
|----------|-----------|
| 666845 | 640 |

Perforated Intervals

| From | To |
|------|------|
| 4886 | 4956 |

Acid Volumes

1,000 GALLONS

Fracture Treatments

There are no Fracture Treatments records to display.

| Formation | Top |
|-------------|------|
| TONKAWA | 4100 |
| CHEROKEE | 5022 |
| MISSISSIPPI | 5287 |
| WOODFORD | 5850 |
| WILCOX | 6052 |

Were open hole logs run? Yes

Date last log run: October 12, 2017

Were unusual drilling circumstances encountered? No

Explanation:

Other Remarks

There are no Other Remarks.

Status: Accepted

RECEIVED

Form 1002A Rev. 2009

JAN 08 2018

API NO. 053-23458
OTC PROD. UNIT NO.

PLEASE TYPE OR USE BLACK INK ONLY
NOTE: Attach copy of original 1002A if recompletion or reentry.

OKLAHOMA CORPORATION COMMISSION
Oil & Gas Conservation Division
Post Office Box 52000
Oklahoma City, Oklahoma 73152-2000
Rule 165-10-3-25

ORIGINAL
 AMENDED (Reason)

COMPLETION REPORT

TYPE OF DRILLING OPERATION
 STRAIGHT HOLE DIRECTIONAL HOLE HORIZONTAL HOLE
 SERVICE WELL

SPUD DATE 10/3/2017
DRLG FINISHED DATE 10/14/2017
DATE OF WELL COMPLETION 12/14/2017
1st PROD DATE
RECOMP DATE
Longitude (if known)

COUNTY Grant SEC 14 TWP 26N RGE 8W
LEASE NAME Glenda WELL NO. 1-14
NW 1/4 NW 1/4 NW 1/4 NW 1/4 FSL 2458 FWL OF 1/4 SEC 210
ELEVATION 1120 Ground 1107 Latitude (if known)
OPERATOR NAME Union Valley Petroleum Corporation OTC/OCC OPERATOR NO. 12075
ADDRESS 5302 N. Us Highway 81
CITY Enid STATE OK ZIP 73701

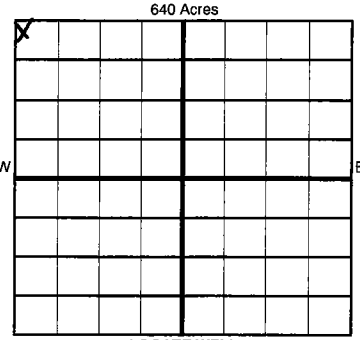

COMPLETION TYPE
 SINGLE ZONE
 MULTIPLE ZONE
 COMMINGLED Application Date 1/4/2017
LOCATION EXCEPTION ORDER INCREASED DENSITY ORDER NO.

CASING & CEMENT (Form 1002C must be attached)

| TYPE | SIZE | WEIGHT | GRADE | FEET | PSI | SAX | TOP OF CMT |
|--------------|-------|--------|-------|------|-----|-----|------------|
| CONDUCTOR | | | | | | | |
| SURFACE | 8.625 | 24 | J-55 | 510 | | 285 | Surface |
| INTERMEDIATE | | | | | | | |
| PRODUCTION | 5.5 | 17 | J-55 | 6059 | | 230 | 4460 |
| LINER | | | | | | | |

PACKER @ _____ BRAND & TYPE _____ PLUG @ 5900 TYPE CIBP PLUG @ _____ TYPE _____ TOTAL DEPTH 6,059
PACKER @ _____ BRAND & TYPE _____ PLUG @ _____ TYPE _____ PLUG @ _____ TYPE _____

COMPLETION & TEST DATA BY PRODUCING FORMATION *319MENSR / 401MSSCT / 404 OSWUG*

| FORMATION | Misener | Mississippi Chat | Oswego | |
|---|--------------|------------------|-------------------------------------|---------|
| SPACING & SPACING ORDER NUMBER | 666845/640ac | 666845/640ac | 666845/640ac | No Frac |
| CLASS: Oil, Gas, Dry, Inj, Disp, Comm Disp, Svc | Dry | Gas | Gas | |
| PERFORATED INTERVALS | 5942-5944 | 5287-5298 | 4950-4956 4940-4942 4886-4890 | |
| ACID/VOLUME | | 2850 gl | 1000 gl | |
| FRACTURE TREATMENT (Fluids/Prop Amounts) | | | | |

Min Gas Allowable (165:10-17-7) OR Oil Allowable (165:10-13-3) Gas Purchaser/Measurer First Sales Date

INITIAL TEST DATA

| INITIAL TEST DATE | 11/3/2017 | 11/8/2017 | 12/14/2017 |
|--------------------------|-----------|-----------|------------|
| OIL-BBL/DAY | 0 | 5 | 1 |
| OIL-GRAVITY (API) | n/a | 39 | 40 |
| GAS-MCF/DAY | 0 | 92 | 78 |
| GAS-OIL RATIO CU FT/BBL | n/a | 18400 | 78000 |
| WATER-BBL/DAY | 18 | 90 | 26 |
| PUMPING OR FLOWING | P | P | P |
| INITIAL SHUT-IN PRESSURE | 0 | 710# | 780# |
| CHOKE SIZE | 64/64 | 64/64 | 64/64 |
| FLOW TUBING PRESSURE | | | |

AS SUBMITTED

A record of the formations drilled through, and pertinent remarks are presented on the reverse. I declare that I have knowledge of the contents of this report and am authorized by my organization to make this report, which was prepared by me or under my supervision and direction, with the data and facts stated herein to be true, correct, and complete to the best of my knowledge and belief.

Dustin Johnson
SIGNATURE NAME (PRINT OR TYPE) DATE PHONE NUMBER
5302 N. US Highway 81 Enid OK 73701 1/5/2017 580-237-3959
ADDRESS CITY STATE ZIP EMAIL ADDRESS
d.johnson@uvpcorp.com

PLEASE TYPE OR USE BLACK INK ONLY
FORMATION RECORD

Give formation names and tops, if available, or descriptions and thickness of formations drilled through. Show intervals cored or drillstem tested.

LEASE NAME Glenda WELL NO. 1-14

| NAMES OF FORMATIONS | TOP |
|---------------------|-------|
| Tonkawa | 4,100 |
| Cherokee | 5,022 |
| Mississippi | 5287 |
| Woodford | 5,850 |
| Wilcox | 6,052 |

FOR COMMISSION USE ONLY

ITD on file YES NO

APPROVED _____ DISAPPROVED _____

2) Reject Codes _____

Were open hole logs run? yes no

Date Last log was run 10/12/2017

Was CO₂ encountered? yes no at what depths? _____

Was H₂S encountered? yes no at what depths? _____

Were unusual drilling circumstances encountered? yes no
 If yes, briefly explain below _____

Other remarks _____

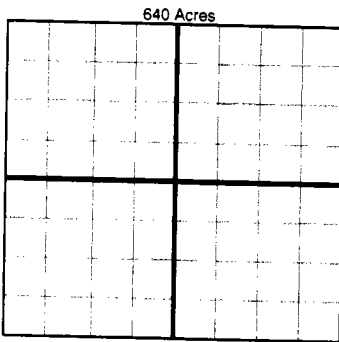

If more than three drainholes are proposed, attach a separate sheet indicating the necessary information.

Direction must be stated in degrees azimuth. Please note, the horizontal drainhole and its end point must be located within the boundaries of the lease or spacing unit.

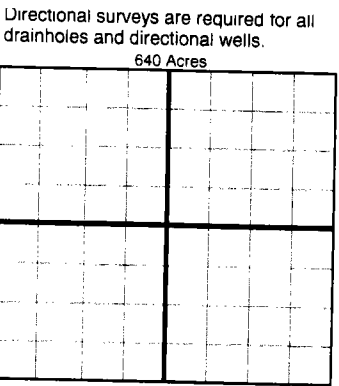

Directional surveys are required for all drainholes and directional wells.

BOTTOM HOLE LOCATION FOR DIRECTIONAL HOLE

| SEC | TWP | RGE | COUNTY |
|---|---------------------|-----|---------------------------------|
| Spot Location | | | |
| 1/4 | 1/4 | 1/4 | 1/4 |
| Measured Total Depth | True Vertical Depth | | Feet From 1/4 Sec Lines FSL FWL |
| BHL From Lease, Unit, or Property Line: _____ | | | |

BOTTOM HOLE LOCATION FOR HORIZONTAL HOLE: (LATERALS)

LATERAL #1

| SEC | TWP | RGE | COUNTY |
|---|---------------------|-----------|---------------------------------|
| Spot Location | | | |
| 1/4 | 1/4 | 1/4 | 1/4 |
| Depth of Deviation | Radius of Turn | Direction | Feet From 1/4 Sec Lines FSL FWL |
| Measured Total Depth | True Vertical Depth | | Total Length |
| BHL From Lease, Unit, or Property Line: _____ | | | |

LATERAL #2

| SEC | TWP | RGE | COUNTY |
|---|---------------------|-----------|---------------------------------|
| Spot Location | | | |
| 1/4 | 1/4 | 1/4 | 1/4 |
| Depth of Deviation | Radius of Turn | Direction | Feet From 1/4 Sec Lines FSL FWL |
| Measured Total Depth | True Vertical Depth | | Total Length |
| BHL From Lease, Unit, or Property Line: _____ | | | |

LATERAL #3

| SEC | TWP | RGE | COUNTY |
|---|---------------------|-----------|---------------------------------|
| Spot Location | | | |
| 1/4 | 1/4 | 1/4 | 1/4 |
| Depth of Deviation | Radius of Turn | Direction | Feet From 1/4 Sec Lines FSL FWL |
| Measured Total Depth | True Vertical Depth | | Total Length |
| BHL From Lease, Unit, or Property Line: _____ | | | |

4/1/18

RECEIVED

Form 1002A Rev. 2009

JAN 08 2018

1016EZ

API NO. 053-23458
OTC PBOB UNIT NO. 053-223204

PLEASE TYPE OR USE BLACK INK ONLY
NOTE: Attach copy of original 1002A if recompletion or reentry.

OKLAHOMA CORPORATION COMMISSION
Oil & Gas Conservation Division
Post Office Box 52000
Oklahoma City, Oklahoma 73152-2000
Rule 165-10-3-25

OKLAHOMA CORPORATION COMMISSION

ORIGINAL
 AMENDED (Reason)

COMPLETION REPORT

TYPE OF DRILLING OPERATION
 STRAIGHT HOLE DIRECTIONAL HOLE HORIZONTAL HOLE
 SERVICE WELL

SPUD DATE 10/3/2017
DRLG FINISHED DATE 10/14/2017
DATE OF WELL COMPLETION 12/14/2017
1st PROD DATE 3/1

If directional or horizontal, see reverse for bottom hole location.

COUNTY Grant SEC 14 TWP 26N RGE 8W
LEASE NAME Glenda WELL NO. 1-14
NW 1/4 NW 1/4 NW 1/4 NW 1/4 FSL 2458 FWL OF 1/4 SEC 210
ELEVATION N Derrick 1120 Ground 1107 Latitude (if known) Longitude (if known)
OPERATOR NAME Union Valley Petroleum Corporation OTC/OCC OPERATOR NO. 12075
ADDRESS 5302 N. Us Highway 81
CITY Enid STATE OK ZIP 73701

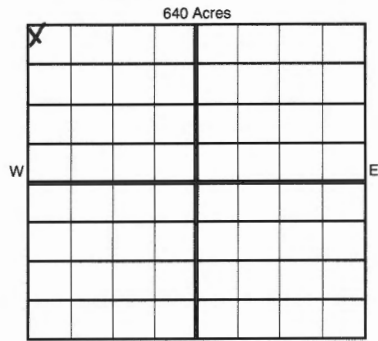

COMPLETION TYPE
 SINGLE ZONE
 MULTIPLE ZONE
 COMMINGLED Application Date 1/4/2017
LOCATION EXCEPTION ORDER INCREASED DENSITY ORDER NO.

CASING & CEMENT (Form 1002C must be attached)

| TYPE | SIZE | WEIGHT | GRADE | FEET | PSI | SAX | TOP OF CMT |
|--------------|-------|--------|-------|------|-----|-----|------------|
| CONDUCTOR | | | | | | | |
| SURFACE | 8.625 | 24 | J-55 | 510 | | 285 | Surface |
| INTERMEDIATE | | | | | | | |
| PRODUCTION | 5.5 | 17 | J-55 | 6059 | | 230 | 4460 |
| LINER | | | | | | | |

PACKER @ _____ BRAND & TYPE _____ PLUG @ 5900 TYPE CIBP PLUG @ _____ TYPE _____ TOTAL DEPTH 6,059
PACKER @ _____ BRAND & TYPE _____ PLUG @ _____ TYPE _____ PLUG @ _____ TYPE _____

COMPLETION & TEST DATA BY PRODUCING FORMATION

| FORMATION | Misener | Mississippi Chat | Oswego | |
|---|--------------|------------------|-------------------------------------|----------|
| SPACING & SPACING ORDER NUMBER | 666845/640ac | 666845/640ac | 666845/640ac | 999 OGMP |
| CLASS: Oil, Gas, Dry, Inj, Disp, Comm Disp, Svc | Dry | Gas | Gas | |
| PERFORATED INTERVALS | 5942-5944 | 5287-5298 | 4950-4956 4940-4942 4886-4890 | |
| ACID/VOLUME | | 2850 gl | 1000 gl | |
| FRACTURE TREATMENT (Fluids/Prop Amounts) | | | | |

Min Gas Allowable (165-10-17-7) OR Oil Allowable (165-10-13-3) Gas Purchaser/Measurer First Sales Date TARGA 3/20/18

INITIAL TEST DATA

| INITIAL TEST DATE | 11/3/2017 | 11/8/2017 | 12/14/2017 |
|--------------------------|-----------|-----------|------------|
| OIL-BBL/DAY | 0 | 5 | 1 |
| OIL-GRAVITY (API) | n/a | 39 | 40 |
| GAS-MCF/DAY | 0 | 92 | 78 |
| GAS-OIL RATIO CU FT/BBL | n/a | 18400 | 78000 |
| WATER-BBL/DAY | 18 | 90 | 26 |
| PUMPING OR FLOWING | P | P | P |
| INITIAL SHUT-IN PRESSURE | 0 | 710# | 780# |
| CHOKE SIZE | 64/64 | 64/64 | 64/64 |
| FLOW TUBING PRESSURE | | | |

AS SUBMITTED

A record of the formations drilled through, and pertinent remarks are presented on the reverse. I declare that I have knowledge of the contents of this report and am authorized by my organization to make this report, which was prepared by me or under my supervision and direction, with the data and facts stated herein to be true, correct, and complete to the best of my knowledge and belief.
Signature: Dustin Johnson
Address: 5302 N. US Highway 81
City: Enid State: OK ZIP: 73701
Date: 1/5/2017
Phone Number: 580-237-3959
Email Address: d.johnson@uvpcorp.com

Scanned

EL

DR form