

Oklahoma Corporation Commission  
Oil & Gas Conservation Division  
Post Office Box 52000  
Oklahoma City, Oklahoma 73152-2000  
Rule 165: 10-3-25

Form 1002A

API No.: 35029213510000

**Completion Report**

Spud Date: January 08, 2017

OTC Prod. Unit No.: 029-21351-0-00

Drilling Finished Date: February 18, 2017

1st Prod Date: June 20, 2017

Completion Date: May 12, 2017

**Drill Type: HORIZONTAL HOLE**

Well Name: LDC 1-24/25H

Purchaser/Measurer: SOUTHWEST ENERGY LP

Location: COAL 13 2N 9E  
NW SW SW SW  
343 FSL 225 FWL of 1/4 SEC  
Derrick Elevation: 763 Ground Elevation: 748

First Sales Date: 06/20/2017

Operator: CANYON CREEK ENERGY OPERATING LLC 23443

2431 E 61ST ST STE 400  
TULSA, OK 74136-1237

| Completion Type |               |
|-----------------|---------------|
| X               | Single Zone   |
|                 | Multiple Zone |
|                 | Commingled    |

| Location Exception |
|--------------------|
| Order No           |
| 663101             |

| Increased Density                                  |
|--|
| Order No   |
| There are no Increased Density records to display. |

| Casing and Cement |       |        |       |       |     |      |            |
|-------------------|-------|--------|-------|-------|-----|------|------------|
| Type              | Size  | Weight | Grade | Feet  | PSI | SAX  | Top of CMT |
| CONDUCTOR         | 20    | 94     | H-40  | 40    |     |      |            |
| SURFACE           | 9 5/8 | 36     | J-55  | 1000  |     | 180  | SURFACE    |
| PRODUCTION        | 5 1/2 | 20     | P-110 | 12810 |     | 1380 | 5500       |

| Liner                                  |      |        |       |        |     |     |           |              |
|--|------|--------|-------|--------|-----|-----|-----------|--------------|
| Type                                   | Size | Weight | Grade | Length | PSI | SAX | Top Depth | Bottom Depth |
| There are no Liner records to display. |      |        |       |        |     |     |           |              |

**Total Depth: 12892**

| Packer                                  |              |
|---|--------------|
| Depth                                   | Brand & Type |
| There are no Packer records to display. |              |

| Plug                                  |           |
|---------------------------------------|-----------|
| Depth                                 | Plug Type |
| There are no Plug records to display. |           |

| Initial Test Data |
|-------------------|
|                   |

| Test Date    | Formation | Oil BBL/Day | Oil-Gravity (API) | Gas MCF/Day | Gas-Oil Ratio Cu FT/BBL | Water BBL/Day | Pumpin or Flowing | Initial Shut-In Pressure | Choke Size | Flow Tubing Pressure |
|--------------|-----------|-------------|-------------------|-------------|-------------------------|---------------|-------------------|--------------------------|------------|----------------------|
| Jul 11, 2017 | WOODFORD  | 35          | 45                | 3500        | 100000                  | 800           | FLOWING           |                          | 64/64      |                      |

**Completion and Test Data by Producing Formation**

Formation Name: WOODFORD

Code: 319WDFD

Class: GAS

**Spacing Orders**

| Order No | Unit Size |
|----------|-----------|
| 662358   | 640       |
| 663578   | MULTIUNIT |

**Perforated Intervals**

| From | To    |
|------|-------|
| 7245 | 12718 |

**Acid Volumes**

There are no Acid Volume records to display.

**Fracture Treatments**

5,416,493 POUNDS SAND, 249,666 BARRELS FLUID

| Formation | Top  |
|-----------|------|
| WOODFORD  | 6650 |

Were open hole logs run? No

Date last log run:

Were unusual drilling circumstances encountered? No

Explanation:

**Other Remarks**

OCC - THIS DOCUMENT IS ACCEPTED BASED ON THE DATA SUBMITTED NEITHER THE FINAL LOCATION EXCEPTION NOR THE FINAL MULTIUNIT ORDERS HAVE BEEN SUBMITTED.

**Lateral Holes**

Sec: 25 TWP: 2N RGE: 9E County: COAL

SE NW NW NW

628 FNL 634 FWL of 1/4 SEC

Depth of Deviation: 6010 Radius of Turn: 966 Direction: 180 Total Length: 6242

Measured Total Depth: 12892 True Vertical Depth: 6620 End Pt. Location From Release, Unit or Property Line: 628

**FOR COMMISSION USE ONLY**

1138502

Status: Accepted

RECEIVED

Form 1002A Rev. 2009

DEC 28 2017

OKLAHOMA CORPORATION COMMISSION

OKLAHOMA CORPORATION COMMISSION  
Oil & Gas Conservation Division  
Post Office Box 52000  
Oklahoma City, Oklahoma 73152-2000  
Rule 165:10-3-25

API NO. 02921351  
OTC PROD UNIT NO. 02921351-0-00

PLEASE TYPE OR USE BLACK INK ONLY

NOTE:  
Attach copy of original 1002A if recompletion or reentry.

ORIGINAL  
 AMENDED (Reason)

COMPLETION REPORT

TYPE OF DRILLING OPERATION  
 STRAIGHT HOLE  DIRECTIONAL HOLE  HORIZONTAL HOLE  
 SERVICE WELL

If directional or horizontal, see reverse for bottom hole location.

COUNTY Coal SEC 13 TWP 2N RGE 9E  
LEASE NAME LDC WELL NO. 1-24/251  
NW 1/4 SW 1/4 SW 1/4 SW 1/4 FSL OF 1/4 SEC 343 FWL OF 1/4 SEC 225  
ELEVATION Derrick FL 763 Ground 748 Latitude (if known) 34.34.13.78 Longitude (if known) 96.19.07.43  
OPERATOR NAME Canyon Creek Energy OTC/OCC OPERATOR NO. 23443  
ADDRESS 2431 E 61st St  
CITY Tulsa STATE OK ZIP 74136

SPUD DATE 1/8/17  
DRLG FINISHED DATE 2/18/17  
DATE OF WELL COMPLETION 5/12/17  
1st PROD DATE 6/20/17  
RECOMP DATE  
Longitude (if known) 96.19.07.43  
OTC/OCC OPERATOR NO. 23443

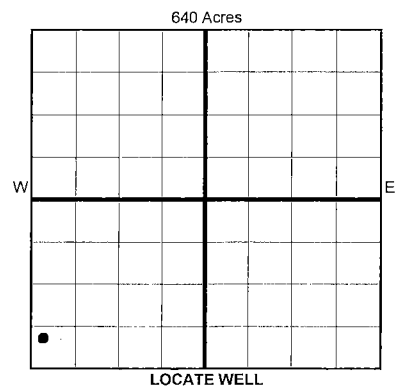

COMPLETION TYPE  
 SINGLE ZONE  
 MULTIPLE ZONE  
 COMMINGLED  
LOCATION EXCEPTION ORDER INCREASED DENSITY ORDER NO. 663101 I.O.

CASING & CEMENT (Form 1002C must be attached)

| TYPE         | SIZE   | WEIGHT | GRADE | FEET  | PSI | SAX  | TOP OF CMT |
|--------------|--------|--------|-------|-------|-----|------|------------|
| CONDUCTOR    | 20"    | 94#    | H-40  | 40    |     |      |            |
| SURFACE      | 9 5/8" | 36#    | J55   | 1000  |     | 180  | Surface    |
| INTERMEDIATE |        |        |       |       |     |      |            |
| PRODUCTION   | 5 1/2" | 20#    | P110  | 12810 |     | 1380 | 5500       |
| LINER        |        |        |       |       |     |      |            |

PACKER @ BRAND & TYPE PLUG @ TYPE PLUG @ TYPE TOTAL DEPTH 12892 Per BHL

COMPLETION & TEST DATA BY PRODUCING FORMATION 319WDFD

| FORMATION | SPACING & SPACING ORDER NUMBER | CLASS: Oil, Gas, Dry, Inj, Disp, Comm Disp, Svc | PERFORATED INTERVALS | ACID/VOLUME     | FRACTURE TREATMENT (Fluids/Prop Amounts) |
|-----------|--------------------------------|---|----------------------|-----------------|--|
| Woodford  | 662358 (640) 663578 Multiunit  | Gas   | 7245 - 12718         | 5.416,493# sand | 249,666 Bbbls Fluid                      |

Monitor Report to FracFuels

Min Gas Allowable (165:10-17-7) Gas Purchaser/Measurer Southwest Energy LP  
OR First Sales Date 6/20/2017  
Oil Allowable (165:10-13-3)

INITIAL TEST DATA

|                          |           |
|--------------------------|-----------|
| INITIAL TEST DATE        | 7/11/2017 |
| OIL-BBL/DAY              | 35        |
| OIL-GRAVITY ( API)       | 45        |
| GAS-MCF/DAY              | 3500      |
| GAS-OIL RATIO CU FT/BBL  | 100,000   |
| WATER-BBL/DAY            | 800       |
| PUMPING OR FLOWING       | Flowing   |
| INITIAL SHUT-IN PRESSURE |           |
| CHOKE SIZE               | 64/64     |
| FLOW TUBING PRESSURE     |           |

AS SUBMITTED

A record of the formations drilled through, and pertinent remarks are presented on the reverse. I declare that I have knowledge of the contents of this report and am authorized by my organization to make this report, which was prepared by me or under my supervision and direction, with the data and facts stated herein to be true, correct, and complete to the best of my knowledge and belief.

C. Daniel Jacobs  
SIGNATURE NAME (PRINT OR TYPE) 12/18/17 918794956  
DATE PHONE NUMBER  
2431 E. 61st Street Suite 400 Tulsa OK 74136  
ADDRESS CITY STATE ZIP djacobs@cceok.com  
EMAIL ADDRESS

PLEASE TYPE OR USE BLACK INK ONLY  
FORMATION RECORD

Give formation names and tops, if available, or descriptions and thickness of formations drilled through. Show intervals cored or drillstem tested.

LEASE NAME \_\_\_\_\_ WELL NO. \_\_\_\_\_

| NAMES OF FORMATIONS | TOP   |
|---------------------|-------|
| Woodford            | 6,650 |

FOR COMMISSION USE ONLY

ITD on file  YES  NO

APPROVED \_\_\_\_\_ DISAPPROVED \_\_\_\_\_

2) Reject Codes \_\_\_\_\_

\_\_\_\_\_

\_\_\_\_\_

\_\_\_\_\_

Were open hole logs run? \_\_\_\_\_ yes  no

Date Last log was run \_\_\_\_\_

Was CO<sub>2</sub> encountered? \_\_\_\_\_ yes  no at what depths? \_\_\_\_\_

Was H<sub>2</sub>S encountered? \_\_\_\_\_ yes  no at what depths? \_\_\_\_\_

Were unusual drilling circumstances encountered? \_\_\_\_\_ yes  no  
If yes, briefly explain below \_\_\_\_\_

Other remarks: \_\_\_\_\_

\_\_\_\_\_

\_\_\_\_\_

\_\_\_\_\_

\_\_\_\_\_

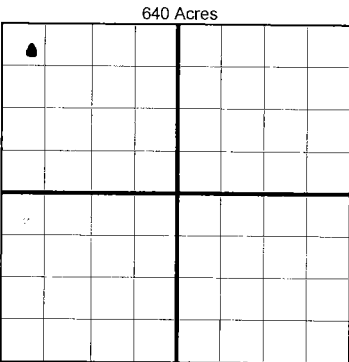

BOTTOM HOLE LOCATION FOR DIRECTIONAL HOLE

| SEC                  | TWP                 | RGE | COUNTY                                  |
|----------------------|---------------------|-----|---|
| Spot Location        | 1/4                 | 1/4 | 1/4                                     |
| Measured Total Depth | True Vertical Depth |     | BHL From Lease, Unit, or Property Line: |

BOTTOM HOLE LOCATION FOR HORIZONTAL HOLE: (LATERALS)

LATERAL #1

| SEC                  | TWP    | RGE                 | COUNTY | Coal                                    |
|----------------------|--------|---------------------|--------|---|
| 25                   | 2N     | 9E                  |        | FNL                                     |
| Spot Location        | 1/4    | 1/4                 | 1/4    |   |
| Depth of Deviation   | 6,010  | Radius of Turn      | 966'   | Direction                               |
| Measured Total Depth | 12,892 | True Vertical Depth | 6,620  | BHL From Lease, Unit, or Property Line: |

FEET FROM 1/4 SEC LINES: 628 FSL, 634 FWL  
Direction: 180 South  
Total Length: 6,242  
628' FNL Sec 25

LATERAL #2

| SEC                  | TWP                 | RGE | COUNTY                                  |
|----------------------|---------------------|-----|---|
| Spot Location        | 1/4                 | 1/4 | 1/4                                     |
| Depth of Deviation   | Radius of Turn      |     | Direction                               |
| Measured Total Depth | True Vertical Depth |     | BHL From Lease, Unit, or Property Line: |

LATERAL #3

| SEC                  | TWP                 | RGE | COUNTY                                  |
|----------------------|---------------------|-----|---|
| Spot Location        | 1/4                 | 1/4 | 1/4                                     |
| Depth of Deviation   | Radius of Turn      |     | Direction                               |
| Measured Total Depth | True Vertical Depth |     | BHL From Lease, Unit, or Property Line: |

If more than three drainholes are proposed, attach a separate sheet indicating the necessary information.

Direction must be stated in degrees azimuth. Please note, the horizontal drainhole and its end point must be located within the boundaries of the lease or spacing unit.

Directional surveys are required for all drainholes and directional wells.

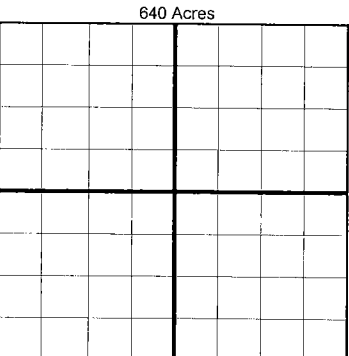

3/1/18  
 Oklahoma Corporation Commission  
 Oil & Gas Conservation Division  
 Post Office Box 52000  
 Oklahoma City, Oklahoma 73152-2000  
 Rule 165: 10-3-25

Form 1002A

**1016EZ**

API No.: ~~0029213510562~~

**Completion Report**

Spud Date: January 08, 2017

OTC Prod. Unit No.: ~~029-218973-000~~

Drilling Finished Date: February 18, 2017

029-218973

1st Prod Date: June 20, 2017

Completion Date: May 12, 2017

**Drill Type: HORIZONTAL HOLE**

Well Name: LDC 1-24/25H

Purchaser/Measurer: SOUTHWEST ENERGY LP

Location: COAL 13 2N 9E  
 NW SW SW SW  
 343 FSL 225 FWL of 1/4 SEC  
 Derrick Elevation: 763 Ground Elevation: 748

First Sales Date: 06/20/2017

Multifruit:

Operator: CANYON CREEK ENERGY OPERATING LLC 23443

Sec. 13(su): -0-

2431 E 61ST ST STE 400  
 TULSA, OK 74136-1237

Sec. 24: 91.7840% 218973 I

Sec. 25: 8.2160% 218973A I

| Completion Type |               |
|-----------------|---------------|
| X               | Single Zone   |
|                 | Multiple Zone |
|                 | Commingled    |

| Location Exception |  |
|--------------------|--|
| Order No           |  |
| 663101             |  |

| Increased Density                                  |  |
|--|--|
| Order No   |  |
| There are no Increased Density records to display. |  |

Multifruit FO:  
 679958

| Casing and Cement |       |        |       |       |     |      |            |
|-------------------|-------|--------|-------|-------|-----|------|------------|
| Type              | Size  | Weight | Grade | Feet  | PSI | SAX  | Top of CMT |
| CONDUCTOR         | 20    | 94     | H-40  | 40    |     |      |            |
| SURFACE           | 9 5/8 | 36     | J-55  | 1000  |     | 180  | SURFACE    |
| PRODUCTION        | 5 1/2 | 20     | P-110 | 12810 |     | 1380 | 5500       |

| Liner                                  |      |        |       |        |     |     |           |              |
|--|------|--------|-------|--------|-----|-----|-----------|--------------|
| Type                                   | Size | Weight | Grade | Length | PSI | SAX | Top Depth | Bottom Depth |
| There are no Liner records to display. |      |        |       |        |     |     |           |              |

**Total Depth: 12892**

| Packer                                  |              |
|---|--------------|
| Depth                                   | Brand & Type |
| There are no Packer records to display. |              |

| Plug                                  |           |
|---------------------------------------|-----------|
| Depth                                 | Plug Type |
| There are no Plug records to display. |           |

2017: 253,834    24: 232,979  
 25: 20,855

| Initial Test Data |
|-------------------|
|                   |

7/11/17

319 W D F A

1  
 XMT-shale

*[Handwritten signature]*  
 1 of 2  
*[Handwritten signature]*

February 07, 2018

*[Handwritten signature]*