

Oklahoma Corporation Commission  
Oil & Gas Conservation Division  
Post Office Box 52000  
Oklahoma City, Oklahoma 73152-2000  
Rule 165: 10-3-25

Form 1002A

API No.: 35019253540001

**Completion Report**

Spud Date: May 21, 2010

OTC Prod. Unit No.: 019-204296

Drilling Finished Date: June 13, 2010

**Amended**

1st Prod Date: July 06, 2010

Amend Reason: SET CIBP AT 6,650 AND ADD TUSSY PERFORATIONS

Completion Date: September 25, 2010

Recomplete Date: September 30, 2017

**Drill Type: STRAIGHT HOLE**

Min Gas Allowable: Yes

Well Name: ARBOR MIST 1-19

Purchaser/Measurer: TARGA PIPELINE

Location: CARTER 19 3S 2W  
N2 S2 SW NE  
410 FSL 660 FWL of 1/4 SEC  
Latitude: 34.282917 Longitude: -97.446306  
Derrick Elevation: 987 Ground Elevation: 973

First Sales Date: 07/08/2010

Operator: CHARTER OAK PRODUCTION CO LLC 21672

13929 QUAIL POINTE DR  
OKLAHOMA CITY, OK 73134-1037

| Completion Type |               | Location Exception |  | Increased Density |  |
|-----------------|---------------|--------------------|--|-------------------|--|
| X               | Single Zone   | Order No           |  | Order No          |  |
|                 | Multiple Zone | 573653             |  | 573578            |  |
|                 | Commingled    |                    |  |                   |  |

| Casing and Cement |       |        |       |      |     |     |            |
|-------------------|-------|--------|-------|------|-----|-----|------------|
| Type              | Size  | Weight | Grade | Feet | PSI | SAX | Top of CMT |
| CONDUCTOR         | 16    |        |       | 40   |     |     | SURFACE    |
| SURFACE           | 9 5/8 | 36     | J-55  | 1130 |     | 510 | SURFACE    |
| PRODUCTION        | 5 1/2 | 17     | N-80  | 8546 |     | 700 | 5235       |

| Liner                                  |      |        |       |        |     |     |           |              |
|--|------|--------|-------|--------|-----|-----|-----------|--------------|
| Type                                   | Size | Weight | Grade | Length | PSI | SAX | Top Depth | Bottom Depth |
| There are no Liner records to display. |      |        |       |        |     |     |           |              |

**Total Depth: 8556**

| Packer                                  |              |
|---|--------------|
| Depth                                   | Brand & Type |
| There are no Packer records to display. |              |

| Plug  |           |
|-------|-----------|
| Depth | Plug Type |
| 6650  | CIBP      |

| Initial Test Data |
|-------------------|
|                   |

| Test Date    | Formation | Oil BBL/Day | Oil-Gravity (API) | Gas MCF/Day | Gas-Oil Ratio Cu FT/BBL | Water BBL/Day | Pumpin or Flowing | Initial Shut-In Pressure | Choke Size | Flow Tubing Pressure |
|--------------|-----------|-------------|-------------------|-------------|-------------------------|---------------|-------------------|--------------------------|------------|----------------------|
| Sep 30, 2017 | TUSSY     | 20          | 41.8              | 47          | 2350                    | 24            | PUMPING           | 1100                     |            |                      |

**Completion and Test Data by Producing Formation**

Formation Name: TUSSY

Code: 404TSSY

Class: OIL

**Spacing Orders**

| Order No | Unit Size |
|----------|-----------|
| 151250   | 160       |

**Perforated Intervals**

| From | To   |
|------|------|
| 6155 | 6165 |

**Acid Volumes**

|      |
|------|
| NONE |
|------|

**Fracture Treatments**

|      |
|------|
| NONE |
|------|

| Formation | Top  |
|-----------|------|
| TUSSY     | 5825 |
| WOODFORD  | 6843 |
| HUNTON    | 6975 |
| SYLVAN    | 7436 |
| VIOLA     | 7705 |

Were open hole logs run? Yes

Date last log run: June 14, 2010

Were unusual drilling circumstances encountered? No

Explanation:

**Other Remarks**

SEE ORIGINAL 1002A FOR INITIAL COMPLETION AND TEST DATA BY PRODUCING FORMATION. OCC - OPERATOR BROKE DOWN FORMATION WITH 70 BO, 36 BW, USING 25 RCN BALL SEALERS.

**FOR COMMISSION USE ONLY**

1138512

Status: Accepted

RECEIVED

Form 1002A Rev. 2009

JAN 03 2018

OKLAHOMA CORPORATION COMMISSION

API NO. 35-019-25354  
OTC PROD. UNIT NO. 019-204296

PLEASE TYPE OR USE BLACK INK ONLY  
NOTE:

Attach copy of original 1002A if recompletion or reentry.

OKLAHOMA CORPORATION COMMISSION  
Oil & Gas Conservation Division  
Post Office Box 52000  
Oklahoma City, Oklahoma 73152-2000  
Rule 165:10-3-25

ORIGINAL  
 AMENDED (Reason) Set CIBP @ 6650' & add Tussy perforations

COMPLETION REPORT

TYPE OF DRILLING OPERATION  
 STRAIGHT HOLE  DIRECTIONAL HOLE  HORIZONTAL HOLE  
 SERVICE WELL  
If directional or horizontal, see reverse for bottom hole location.  
COUNTY Carter SEC 19 TWP 03S RGE 02W  
LEASE NAME Arbor Mist WELL NO. 1-19  
N2 1/4 S2 1/4 SW 1/4 NE 1/4 FSL OF 1/4 SEC 410' FWL OF 1/4 SEC 660'  
ELEVATION N Derrick 987' Ground 973' Latitude (if known) 34.282917 Longitude (if known) -97.446306  
OPERATOR NAME Charter Oak Production Co., LLC OTC/OCC OPERATOR NO. 21672  
ADDRESS 13929 Quail Pointe Dr.  
CITY Oklahoma City STATE OK ZIP 73134

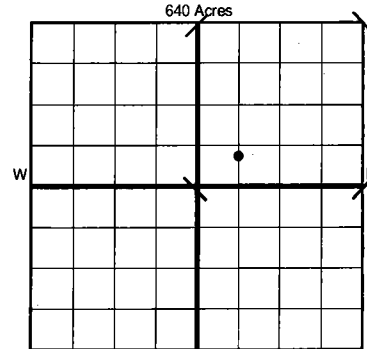

LOCATE WELL

COMPLETION TYPE  
 SINGLE ZONE  
 MULTIPLE ZONE  
 COMMINGLED  
LOCATION EXCEPTION ORDER 573653  
INCREASED DENSITY ORDER NO. 573578

CASING & CEMENT (Form 1002C must be attached)

| TYPE         | SIZE   | WEIGHT | GRADE | FEET  | PSI | SAX | TOP OF CMT |
|--------------|--------|--------|-------|-------|-----|-----|------------|
| CONDUCTOR    | 16"    |        |       | 40'   |     |     | Surface    |
| SURFACE      | 9 5/8" | 36#    | J-55  | 1130' |     | 510 | Surface    |
| INTERMEDIATE |        |        |       |       |     |     |            |
| PRODUCTION   | 5 1/2" | 17#    | N-80  | 8546' |     | 700 | 5235'      |
| LINER        |        |        |       |       |     |     |            |

TOTAL DEPTH 8556'

PACKER @ \_\_\_\_\_ BRAND & TYPE \_\_\_\_\_ PLUG @ 6650' TYPE CBP PLUG @ \_\_\_\_\_ TYPE \_\_\_\_\_  
PACKER @ \_\_\_\_\_ BRAND & TYPE \_\_\_\_\_ PLUG @ \_\_\_\_\_ TYPE \_\_\_\_\_ PLUG @ \_\_\_\_\_ TYPE \_\_\_\_\_

COMPLETION & TEST DATA BY PRODUCING FORMATION

404 TSSY

| FORMATION                   | SPACING & SPACING ORDER NUMBER | CLASS: Oil, Gas, Dry, Inj, Disp, Comm Disp, Svc | PERFORATED INTERVALS   | ACID/VOLUME | FRACTURE TREATMENT (Fluids/Prop Amounts) |
|-----------------------------|--------------------------------|---|--|-------------|--|
| VIO, HNTN, WDFD, TSSY Tussy | 160 Ac. 151250, 155194, 228699 | Oil   | 6711' - 8312' O.A.<br>See original 1002A for individual formation test data. | N/A         | 70 BO<br>36 BW<br>25 RCN ball sealers    |

Min Gas Allowable (165:10-17-7) OR  Oil Allowable (165:10-13-3)  
Gas Purchaser/Measurer \_\_\_\_\_ Targa Pipeline  
First Sales Date \_\_\_\_\_ 7/8/10

INITIAL TEST DATA

|                          |         |          |
|--------------------------|---------|----------|
| INITIAL TEST DATE        | 9/25/10 | 9/30/17  |
| OIL-BBL/DAY              | 40      | 20       |
| OIL-GRAVITY ( API)       | 35.0    | 41.8     |
| GAS-MCF/DAY              | 13      | 47       |
| GAS-OIL RATIO CU FT/BBL  | 325     | 2350     |
| WATER-BBL/DAY            | 145     | 24       |
| PUMPING OR FLOWING       | Pumping | Pumping  |
| INITIAL SHUT-IN PRESSURE | N/A     | 1100 psi |
| CHOKE SIZE               | N/A     | N/A      |
| FLOW TUBING PRESSURE     | N/A     | N/A      |

AS SUBMITTED

A record of the formations drilled through, and pertinent remarks are presented on the reverse. I declare that I have knowledge of the contents of this report and am authorized by my organization to make this report, which was prepared by me, under my supervision and direction, with the data and facts stated herein to be true, correct, and complete to the best of my knowledge and belief.

*John C. Brevetti*  
SIGNATURE NAME (PRINT OR TYPE) JC Brevetti, Engineering Tech.  
13929 Quail Pointe Dr. Oklahoma City OK 73134  
ADDRESS CITY STATE ZIP  
DATE PHONE NUMBER 1/2/18 (405) 286-0361  
EMAIL ADDRESS brevetti@charteroakproduction.com

PLEASE TYPE OR USE BLACK INK ONLY  
FORMATION RECORD

Give formation names and tops, if available, or descriptions and thickness of formations drilled through. Show intervals cored or drillstem tested.

LEASE NAME Arbor Mist

WELL NO. 1-19

| NAMES OF FORMATIONS | TOP   |
|---------------------|-------|
| Tussy               | 5825' |
| Woodford            | 6843' |
| Hunton              | 6975' |
| Sylvan              | 7436' |
| Viola               | 7705' |

FOR COMMISSION USE ONLY

ITD on file  YES  NO

APPROVED \_\_\_\_\_ DISAPPROVED \_\_\_\_\_ 2) Reject Codes \_\_\_\_\_

\_\_\_\_\_

\_\_\_\_\_

\_\_\_\_\_

\_\_\_\_\_

Were open hole logs run?  yes  no

Date Last log was run June 14, 2010

Was CO<sub>2</sub> encountered?  yes  no at what depths? \_\_\_\_\_

Was H<sub>2</sub>S encountered?  yes  no at what depths? \_\_\_\_\_

Were unusual drilling circumstances encountered?  yes  no  
If yes, briefly explain below \_\_\_\_\_

Other remarks: See original 1002A for initial completion & test data by producing formation.

*OCC - Operator broke down formation with ZDRBO, 36BW using 25 RNC ball sealers.*

*↑*

*- front page says*

|  |  |  |  |  |  |  |  |  |  |
|--|--|--|--|--|--|--|--|--|--|
|  |  |  |  |  |  |  |  |  |  |
|  |  |  |  |  |  |  |  |  |  |
|  |  |  |  |  |  |  |  |  |  |
|  |  |  |  |  |  |  |  |  |  |
|  |  |  |  |  |  |  |  |  |  |
|  |  |  |  |  |  |  |  |  |  |
|  |  |  |  |  |  |  |  |  |  |
|  |  |  |  |  |  |  |  |  |  |
|  |  |  |  |  |  |  |  |  |  |
|  |  |  |  |  |  |  |  |  |  |

If more than three drainholes are proposed, attach a separate sheet indicating the necessary information.

Direction must be stated in degrees azimuth. Please note, the horizontal drainhole and its end point must be located within the boundaries of the lease or spacing unit.

Directional surveys are required for all drainholes and directional wells.

640 Acres

|  |  |  |  |  |  |  |  |  |  |
|--|--|--|--|--|--|--|--|--|--|
|  |  |  |  |  |  |  |  |  |  |
|  |  |  |  |  |  |  |  |  |  |
|  |  |  |  |  |  |  |  |  |  |
|  |  |  |  |  |  |  |  |  |  |
|  |  |  |  |  |  |  |  |  |  |
|  |  |  |  |  |  |  |  |  |  |
|  |  |  |  |  |  |  |  |  |  |
|  |  |  |  |  |  |  |  |  |  |
|  |  |  |  |  |  |  |  |  |  |
|  |  |  |  |  |  |  |  |  |  |

LOCATION FOR DIRECTIONAL HOLE

| P                                       | RGE                     | COUNTY                                      |
|---|-------------------------|---|
|   |                         |   |
| Depth                                   | 1/4 True Vertical Depth | 1/4 1/4 1/4 Feet From 1/4 Sec Lines FSL FWL |
| BHL From Lease, Unit, or Property Line: |                         |   |

BOTTOM HOLE LOCATION FOR HORIZONTAL HOLE: (LATERALS)

LATERAL #1

| SEC                  | TWP                 | RGE                                     | COUNTY                                  |
|----------------------|---------------------|---|---|
|                      |                     |   |   |
| Spot Location        | 1/4                 | 1/4                                     | 1/4 1/4 Feet From 1/4 Sec Lines FSL FWL |
| Depth of Deviation   | Radius of Turn      | Direction                               | Total Length                            |
| Measured Total Depth | True Vertical Depth | BHL From Lease, Unit, or Property Line: |   |

LATERAL #2

| SEC                  | TWP                 | RGE                                     | COUNTY                                  |
|----------------------|---------------------|---|---|
|                      |                     |   |   |
| Spot Location        | 1/4                 | 1/4                                     | 1/4 1/4 Feet From 1/4 Sec Lines FSL FWL |
| Depth of Deviation   | Radius of Turn      | Direction                               | Total Length                            |
| Measured Total Depth | True Vertical Depth | BHL From Lease, Unit, or Property Line: |   |

LATERAL #3

| SEC                  | TWP                 | RGE                                     | COUNTY                                  |
|----------------------|---------------------|---|---|
|                      |                     |   |   |
| Spot Location        | 1/4                 | 1/4                                     | 1/4 1/4 Feet From 1/4 Sec Lines FSL FWL |
| Depth of Deviation   | Radius of Turn      | Direction                               | Total Length                            |
| Measured Total Depth | True Vertical Depth | BHL From Lease, Unit, or Property Line: |   |