

OKLAHOMA CORPORATION COMMISSION
OIL & GAS CONSERVATION DIVISION
P.O. BOX 52000
OKLAHOMA CITY, OK 73152-2000
(Rule 165:10-3-1)

API NUMBER: 063 24714

Approval Date: 10/12/2017
Expiration Date: 04/12/2018

Horizontal Hole Oil & Gas

PERMIT TO DRILL

WELL LOCATION: Sec: 10 Twp: 6N Rge: 10E County: HUGHES
SPOT LOCATION: SW NE NW NE FEET FROM QUARTER: FROM NORTH FROM EAST
SECTION LINES: 400 1705

Lease Name: JANA Well No: 3-10/15H Well will be 400 feet from nearest unit or lease boundary.
Operator Name: TRINITY OPERATING (USG) LLC Telephone: 7139515351 OTC/OCC Number: 23879 0

TRINITY OPERATING (USG) LLC
601 TRAVIS ST STE 1900
HOUSTON, TX 77002-3253

BRANDON T. HARDEN & JOHN G. HARDEN
3825 N. 381 RD.
CALVIN OK 74531

Formation(s) (Permit Valid for Listed Formations Only):

Name	Depth	Name	Depth
1 WOODFORD	5524	6	
2		7	
3		8	
4		9	
5		10	

Spacing Orders: 629167

Location Exception Orders:

Increased Density Orders: 664862

Pending CD Numbers: 201702351
201702366
201702353
201702272

Special Orders:

Total Depth: 16161 Ground Elevation: 892 **Surface Casing: 160** Depth to base of Treatable Water-Bearing FM: 110

Under Federal Jurisdiction: No Fresh Water Supply Well Drilled: No Surface Water used to Drill: No

PIT 1 INFORMATION

Type of Pit System: ON SITE
Type of Mud System: AIR

Is depth to top of ground water greater than 10ft below base of pit? Y
Within 1 mile of municipal water well? N
Wellhead Protection Area? N

Pit is located in a Hydrologically Sensitive Area.

Category of Pit: 4

Liner not required for Category: 4

Pit Location is BED AQUIFER

Pit Location Formation: CALVIN

Mud System Change to Water-Based or Oil-Based Mud Requires an Amended Intent (Form 1000).

Approved Method for disposal of Drilling Fluids:

A. Evaporation/dewater and backfilling of reserve pit.

E. Haul to Commercial pit facility: Sec. 19 Twn. 8N Rng. 5E Cnty. 125 Order No: 274874

H. SEE MEMO

This permit does not address the right of entry or settlement of surface damages.
The duration of this permit is SIX MONTHS, except as otherwise provided by Rule 165: 10-3-1.
Rule 165: 10-3-4 (c) (7) (e) - The Operator shall give 24 Hours notice by telephone to the appropriate District Office of the Conservation Division as to when Surface Casing will be run.

PIT 2 INFORMATION

Type of Pit System: CLOSED Closed System Means Steel Pits

Type of Mud System: WATER BASED

Chlorides Max: 8000 Average: 5000

Is depth to top of ground water greater than 10ft below base of pit? Y

Within 1 mile of municipal water well? N

Wellhead Protection Area? N

Pit is located in a Hydrologically Sensitive Area.

Category of Pit: C

Liner not required for Category: C

Pit Location is BED AQUIFER

Pit Location Formation: CALVIN

PIT 3 INFORMATION

Type of Pit System: CLOSED Closed System Means Steel Pits

Type of Mud System: OIL BASED

Chlorides Max: 300000 Average: 200000

Is depth to top of ground water greater than 10ft below base of pit? Y

Within 1 mile of municipal water well? N

Wellhead Protection Area? N

Pit is located in a Hydrologically Sensitive Area.

Category of Pit: C

Liner not required for Category: C

Pit Location is BED AQUIFER

Pit Location Formation: CALVIN

HORIZONTAL HOLE 1

Sec 15 Twp 6N Rge 10E County HUGHES

Spot Location of End Point: SW SW SW SE

Feet From: SOUTH 1/4 Section Line: 1

Feet From: EAST 1/4 Section Line: 2590

Depth of Deviation: 5106

Radius of Turn: 477

Direction: 185

Total Length: 10306

Measured Total Depth: 16161

True Vertical Depth: 5548

End Point Location from Lease,

Unit, or Property Line: 1

Notes:

This permit does not address the right of entry or settlement of surface damages. The duration of this permit is SIX MONTHS, except as otherwise provided by Rule 165: 10-3-1. Rule 165: 10-3-4 (c) (7) (e) - The Operator shall give 24 Hours notice by telephone to the appropriate District Office of the Conservation Division as to when Surface Casing will be run.

Category	Description
HYDRAULIC FRACTURING	10/4/2017 - G71 - OCC 165:10-3-10 REQUIRES: 1) PRIOR TO COMMENCEMENT OF HYDRAULIC FRACTURING OPERATIONS FOR HORIZONTAL WELLS, NOTICE GIVEN FIVE BUSINESS DAYS IN ADVANCE TO OFFSET OPERATORS WITH WELLS COMPLETED IN THE SAME COMMON SOURCE OF SUPPLY WITHIN 1/2 MILE; 2) WITH NOTICE ALSO GIVEN 48 HOURS IN ADVANCE OF HYDRAULIC FRACTURING ALL WELLS TO BOTH THE OCC CENTRAL OFFICE AND LOCAL DISTRICT OFFICES, USING THE "FRAC NOTICE FORM" FOUND AT THE FOLLOWING LINK: OCCEWEB.COM/OG/OGFORMS.HTML ; AND, 3) THE CHEMICAL DISCLOSURE OF HYDRAULIC FRACTURING INGREDIENTS FOR ALL WELLS TO BE REPORTED TO FRACFOCUS WITHIN 60 DAYS AFTER THE CONCLUSION THE HYDRAULIC FRACTURING OPERATIONS, USING THE FOLLOWING LINK: FRACFOCUS.ORG
INCREASED DENSITY - 664862	10/12/2017 - G75 - 10-6N-10E X629167 WDFD 2 WELLS TRINITY OP. (USG), LLC 6-14-2017
MEMO	10/4/2017 - G71 - PIT 2 & 3 - CLOSED SYSTEM=STEEL PITS PER OPERATOR REQUEST, WBM & OBM CUTTINGS CAPTURED IN CONCRETE-LINED PIT, SOLIDIFIED AND HELD UNTIL DISPOSAL APPROVED BY OCC; PIT 3 - OBM TO VENDOR
PENDING CD - 201702272	10/12/2017 - G75 - (E.O.)(640)(HOR) 15-6N-10E EXT 629167 WDFD, OTHERS COMPL. INT. NLT 165' FNL & FSL, NLT 330' FEL & FWL (COEXIST SP. ORDER # 548012 WDFD) TRINITY OP. (USG), LLC REC 10-6-2017 (MCKEOWN)
PENDING CD - 201702351	10/12/2017 - G75 - (E.O.) 10 & 15-6N-10E X629167 WDFD 10-6N-10E X201702272 WDFD 15-6N-10E COMPL. INT. (10-6N-10E) NCT 165' FNL, NCT 0' FSL, NCT 2400' FEL COMPL. INT. (15-6N-10E) NCT 0' FNL, NCT 165' FSL, NCT 2400' FEL TRINITY OP. (USG), LLC REC 10-6-2017 (MCKEOWN)
PENDING CD - 201702353	10/12/2017 - G75 - (E.O.) 15-6N-10E X201702272 WDFD 1 WELL TRINITY OP. (USG), LLC REC 10-6-2017 (MCKEOWN)
PENDING CD - 201702366	10/12/2017 - G75 - (E.O.) 10 & 15-6N-10E EST MULTIUNIT HORIZONTAL WELL X629167 WDFD 10-6N-10E X201702272 WDFD 15-6N-10E 50% 10-6N-10E 50% 15-6N-10E TRINITY OP. (USG), LLC REC 10-6-2017 (MCKEOWN)
SPACING - 629167	10/12/2017 - G75 - (640)(HOR) 10-6N-10E VAC OTHER EST WDFD, OTHERS COMPL. INT. NLT 165' FNL & FSL, NLT 330' FEL & FWL

This permit does not address the right of entry or settlement of surface damages.
The duration of this permit is SIX MONTHS, except as otherwise provided by Rule 165: 10-3-1.
Rule 165: 10-3-4 (c) (7) (e) - The Operator shall give 24 Hours notice by telephone to the appropriate District Office of the Conservation Division as to when Surface Casing will be run.



Well Location Plat

S.H.L. Sec. 10-6N-10E I.M.
B.H.L. Sec. 15-6N-10E I.M.

Operator: TRINITY OPERATING
Lease Name and No.: JANA 3-10/15H
Footage: 400' FNL - 1705' FEL GR. ELEVATION: 892'
Section: 10 Township: 6N Range: 10E I.M.
County: Hughes State of Oklahoma
Alternate Loc.: N/A

API 063-24714

Terrain at Loc.: Location fell on hilltop that slopes down to the East and West from well stakes.
Accessibility: From the Southwest.
Driving Directions: From the junction of US Highway 270 & US Highway 75 in Calving, OK, go 3.0 miles North on HWY 75, then go 0.7 mile East on "EW 1385 Rd." to the proposed lease road entrance in the Northeast 1/4 of Section 10-6N-10E.

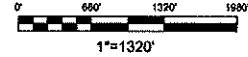

GPS DATUM
NAD 27
OK SOUTH ZONE

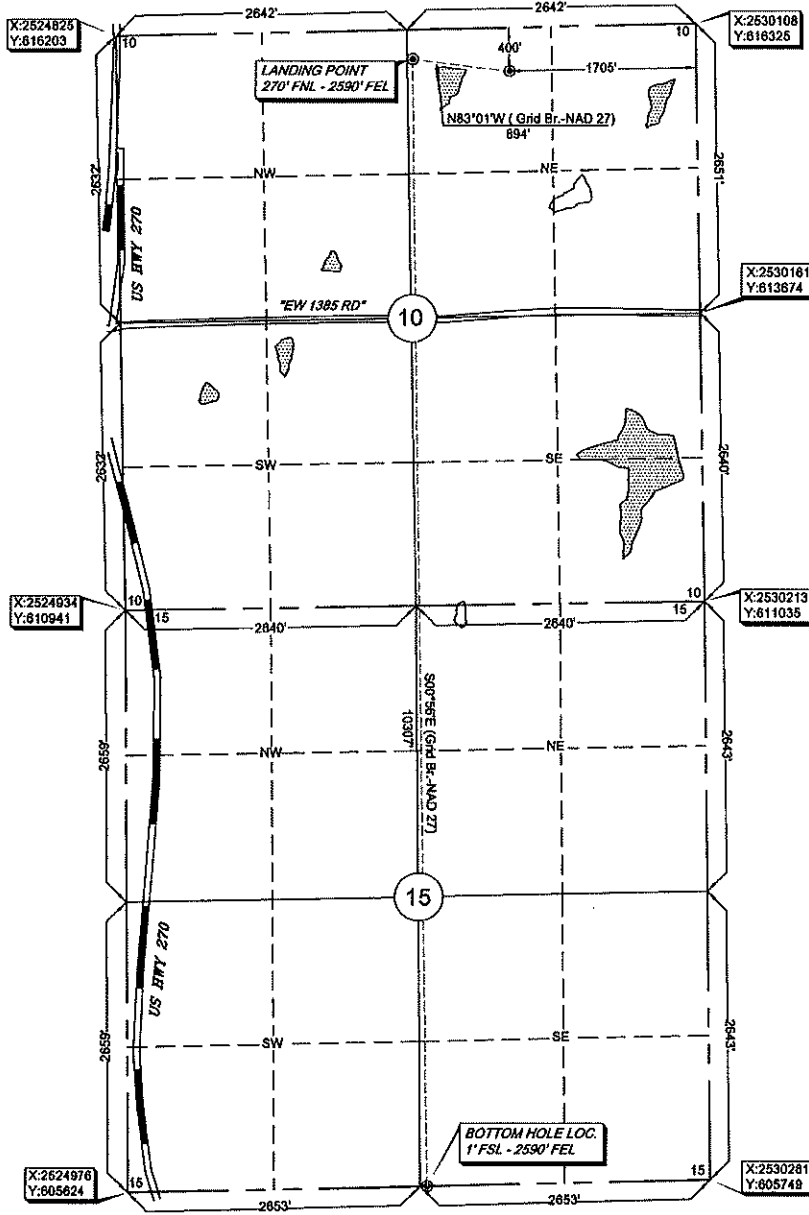

Surface Hole Loc.:
Lat: 35°00'46.86"N
Lon: 96°14'07.10"W
X: 2528411
Y: 615885
Landing Point:
Lat: 35°00'48.10"N
Lon: 96°14'17.74"W
X: 2527524
Y: 615994
Bottom Hole Loc.:
Lat: 34°59'06.15"N
Lon: 96°14'17.88"W
X: 2527692
Y: 605688

Please note that this location was staked on the ground under the supervision of a Licensed Professional Land Surveyor, but the accuracy of this survey is not guaranteed. Please contact Arkoma Surveying and Mapping promptly if any inconsistency is determined. GPS data is observed from RTK - GPS.

Quarter Section distances may be assumed from a Government Survey Plat or assumed at a proportionate distance from opposing section corners, or occupation thereof, and may not have been measured on-the-ground, and further, does not represent a true boundary survey.

NOTE: X and Y data shown, herein for Section Corners may NOT have been surveyed on-the-ground, and further, does NOT represent a true Boundary Survey.

survey and plat by,
Arkoma Surveying and Mapping, PLLC
P.O. Box 238 Wilburton, OK 74578
Ph. 918-465-5711 Fax 918-465-5030
Certificate of Authorization No. 5348
Expires June 30, 2018

Certification:
This is to certify that this Well Location Plat represents the results of a survey made on the ground performed under the supervision of the undersigned.

Lance G. Mathis 08/25/17
LANCE G. MATHIS OK LPLS 1664

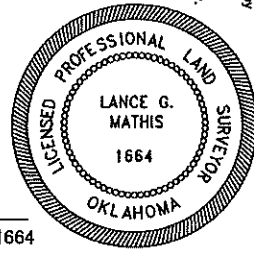

Invoice #6987-A-D
Date Staked: 03/08/17 By: H.S.
Date Drawn: 03/13/17 By: P.B.
Add LP & BHL: 08/25/17 By: K.B.