

Oklahoma Corporation Commission
Oil & Gas Conservation Division
Post Office Box 52000
Oklahoma City, Oklahoma 73152-2000
Rule 165: 10-3-25

Form 1002A

API No.: 35073256000000

Completion Report

Spud Date: May 10, 2017

OTC Prod. Unit No.: 073-219083

Drilling Finished Date: May 28, 2017

1st Prod Date: July 16, 2017

Completion Date: July 06, 2017

Drill Type: HORIZONTAL HOLE

Min Gas Allowable: Yes

Well Name: JOHN 1-10HH

Purchaser/Measurer: SUPERIOR

Location: KINGFISHER 15 16N 5W
NW NE NE NE
113 FNL 500 FEL of 1/4 SEC
Derrick Elevation: 983 Ground Elevation: 968

First Sales Date: 07/16/2017

Operator: PAYNE EXPLORATION COMPANY 918

7005 N ROBINSON AVE
OKLAHOMA CITY, OK 73116-9044

Completion Type	
X	Single Zone
	Multiple Zone
	Commingled

Location Exception	
Order No	
663042	

Increased Density	
Order No	
There are no Increased Density records to display.	

Casing and Cement							
Type	Size	Weight	Grade	Feet	PSI	SAX	Top of CMT
CONDUCTOR	20			80		10	SURFACE
SURFACE	9 5/8	36	J-55	447	60	215	SURFACE
INTERMEDIATE	7	26	J-55	7316	1500	130	5981
PRODUCTION	4.5	11.6	HCP-110	12209	1300	455	3973

Liner								
Type	Size	Weight	Grade	Length	PSI	SAX	Top Depth	Bottom Depth
There are no Liner records to display.								

Total Depth: 12225

Packer	
Depth	Brand & Type
7082	TOOLS PLUS MODEL R

Plug	
Depth	Plug Type
There are no Plug records to display.	

Initial Test Data

Test Date	Formation	Oil BBL/Day	Oil-Gravity (API)	Gas MCF/Day	Gas-Oil Ratio Cu FT/BBL	Water BBL/Day	Pumpin or Flowing	Initial Shut-In Pressure	Choke Size	Flow Tubing Pressure
Jul 16, 2017	HUNTON	18.5	40	78	4216	968	GAS LIFT			200

Completion and Test Data by Producing Formation

Formation Name: HUNTON

Code: 269HNTN

Class: OIL

Spacing Orders

Order No	Unit Size
660106	320

Perforated Intervals

From	To
7370	12106

Acid Volumes

1,388 BARRELS 15% HCL, 2,362 BARRELS MOD
--

Fracture Treatments

192,426 BBLS FRESH WATER, 5,931,720 POUNDS SAND

Formation	Top
LAYTON	5245
HOGSHOOTER	5641
CHECKERBOARD LIME	5766
BIG LIME	6148
OSWEGO	6240
VERDIGRIS	6345
PINK LIME	6453
MISSISSIPPI LIME	6534
WOODFORD SHALE	6968
HUNTON LIMESTONE	7032

Were open hole logs run? Yes

Date last log run: May 26, 2017

Were unusual drilling circumstances encountered? No

Explanation:

Other Remarks

FMI LOG ONLY. NOT REQUIRED TO SUBMIT. OCC - THIS DOCUMENT IS ACCEPTED BASED ON THE DATA SUBMITTED THE FINAL LOCATION EXCEPTION HAS NOT BEEN ISSUED.

Lateral Holes

Sec: 10 TWP: 16N RGE: 5W County: KINGFISHER

NW NW NE NE

112 FNL 1019 FEL of 1/4 SEC

Depth of Deviation: 6536 Radius of Turn: 865 Direction: 352 Total Length: 4909

Measured Total Depth: 12225 True Vertical Depth: 7056 End Pt. Location From Release, Unit or Property Line: 112

FOR COMMISSION USE ONLY

1137502

Status: Accepted

RECEIVED

Form 1002A Rev. 2009

AUG 25 2017

OKLAHOMA CORPORATION COMMISSION

OKLAHOMA CORPORATION COMMISSION
Oil & Gas Conservation Division
Post Office Box 52000
Oklahoma City, Oklahoma 73152-2000
Rule 165-10-3-25

COMPLETION REPORT

API NO. 073-25600
OTC PROD UNIT NO. 073-219083

PLEASE TYPE OR USE BLACK INK ONLY

NOTE:

Attach copy of original 1002A if recompletion or reentry.

ORIGINAL AMENDED (Reason)

TYPE OF DRILLING OPERATION

STRAIGHT HOLE DIRECTIONAL HOLE HORIZONTAL HOLE

If directional or horizontal, see reverse for bottom hole location.

Form with fields for COUNTY (Kingfisher), LEASE NAME (John), WELL NO. (1-10HH), OPERATOR NAME (Payne Exploration Company), ADDRESS (7005 N Robinson), CITY (Oklahoma City), STATE (Oklahoma), ZIP (73116)

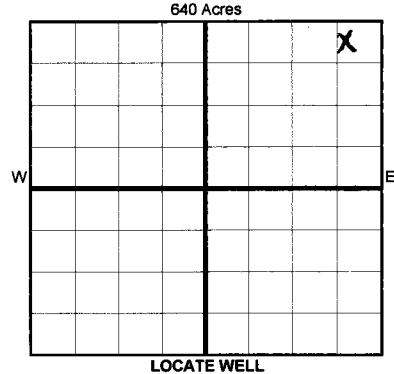

COMPLETION TYPE

Form with fields for SINGLE ZONE, MULTIPLE ZONE, COMMINGLED, LOCATION, EXCEPTION ORDER, INCREASED DENSITY, ORDER NO. (663042 I.O.)

CASING & CEMENT (Form 1002C must be attached)

Table with columns: TYPE, SIZE, WEIGHT, GRADE, FEET, PSI, SAX, TOP OF CMT. Rows include CONDUCTOR, SURFACE, INTERMEDIATE, PRODUCTION, LINER.

PACKER @ 7082' BRAND & TYPE Tools Plus PLUG @ TYPE PLUG @ TYPE
PACKER @ Model R PLUG @ TYPE PLUG @ TYPE

TOTAL DEPTH 12,225'

COMPLETION & TEST DATA BY PRODUCING FORMATION 269HNTN

Table with columns: FORMATION (Hunton), SPACING & SPACING ORDER NUMBER (320 Ac 660106), CLASS (Oil), PERFORATED INTERVALS (7,370' - 12,103'), ACID/VOLUME (15% 1,388 Bbls), FRACTURE TREATMENT (5,931,720# sand)

Monitor Report to Frac Focus

Min Gas Allowable (165-10-17-7) Superior
OR
Oil Allowable (165-10-13-3) First Sales Date 7/16/2017

INITIAL TEST DATA

Table with columns: INITIAL TEST DATE (7/16/2017), OIL-BBL/DAY (18.5), OIL-GRAVITY (API) (40), GAS-MCF/DAY (78), GAS-OIL RATIO CU FT/BBL (4,216), WATER-BBL/DAY (968), PUMPING OR FLOWING (Gas Lift), INITIAL SHUT-IN PRESSURE (0), CHOKE SIZE (NA), FLOW TUBING PRESSURE (200 PSI)

AS SUBMITTED

A record of the formations drilled through, and pertinent remarks are presented on the reverse. I declare that I have knowledge of the contents of this report and am authorized by my organization to make this report, which was prepared by me or under my supervision and direction, with the data and facts stated herein to be true, correct, and complete to the best of my knowledge and belief.

Trent Scaggs
SIGNATURE NAME (PRINT OR TYPE) DATE PHONE NUMBER
7005 N Robinson Oklahoma City OK 73116 tscaggs@payneenergy.com
ADDRESS CITY STATE ZIP EMAIL ADDRESS

Per John Logemann @ Payne

PLEASE TYPE OR USE BLACK INK ONLY
FORMATION RECORD

Give formation names and tops, if available, or descriptions and thickness of formations drilled through. Show intervals cored or drillstem tested.

LEASE NAME John WELL NO. 1-10HH

NAMES OF FORMATIONS	TOP
Layton	5245'
Hogshooter	5641'
Checkerboard Lime	5766'
Big Lime	6148'
Oswego	6240'
Verdigris	6345'
Pink Lime	6453'
Mississippi Lime	6534'
Woodford Shale	6968'
Hunton Limestone	7032'

FOR COMMISSION USE ONLY

ITD on file YES NO

APPROVED _____ DISAPPROVED _____

2) Reject Codes _____

Were open hole logs run? yes no

Date Last log was run 5/26/2017

Was CO₂ encountered? yes no at what depths? _____

Was H₂S encountered? yes no at what depths? _____

Were unusual drilling circumstances encountered? yes no
If yes, briefly explain below

Other remarks: FMI log only. Not required to submit.

640 Acres

If more than three drainholes are proposed, attach a separate sheet indicating the necessary information.

Direction must be stated in degrees azimuth. Please note, the horizontal drainhole and its end point must be located within the boundaries of the lease or spacing unit.

Directional surveys are required for all drainholes and directional wells.

640 Acres

BOTTOM HOLE LOCATION FOR DIRECTIONAL HOLE

SEC	TWP	RGE	COUNTY	Feet From 1/4 Sec Lines		FSL	FWL
Spot Location				1/4	1/4	1/4	
Measured Total Depth				True Vertical Depth		BHL From Lease, Unit, or Property Line:	

BOTTOM HOLE LOCATION FOR HORIZONTAL HOLE: (LATERALS)

LATERAL #1

SEC	TWP	RGE	COUNTY	Feet From 1/4 Sec Lines		FNL	FWL
10	16N	05W	Kingfisher	1/4	1/4	112'	1,019'
Spot Location				NE	NE		
Depth of Deviation				6,536'	Radius of Turn 865'	Direction 352-351.52°	Total Length 4,909'
Measured Total Depth				True Vertical Depth		BHL From Lease, Unit, or Property Line:	
				12,225'		7,056'	

LATERAL #2

SEC	TWP	RGE	COUNTY	Feet From 1/4 Sec Lines		FSL	FWL
Spot Location				1/4	1/4	1/4	
Depth of Deviation				Radius of Turn		Direction	
Measured Total Depth				True Vertical Depth		BHL From Lease, Unit, or Property Line:	

LATERAL #3

SEC	TWP	RGE	COUNTY	Feet From 1/4 Sec Lines		FSL	FWL
Spot Location				1/4	1/4	1/4	
Depth of Deviation				Radius of Turn		Direction	
Measured Total Depth				True Vertical Depth		BHL From Lease, Unit, or Property Line:	