

Oklahoma Corporation Commission
 Oil & Gas Conservation Division
 Post Office Box 52000
 Oklahoma City, Oklahoma 73152-2000
 Rule 165: 10-3-25

Form 1002A

API No.: 35003223030001

Completion Report

Spud Date: June 01, 2012

OTC Prod. Unit No.: 003-208968

Drilling Finished Date: June 23, 2012

1st Prod Date: October 10, 2012

Amended

Completion Date: July 23, 2012

Amend Reason: RECLASSIFY AS TEMPORARILY ABANDONED

Recomplete Date: August 23, 2017

Drill Type: HORIZONTAL HOLE

Well Name: RUTH KNOFF 7-27-11 1H

Purchaser/Measurer:

Location: ALFALFA 7 27N 11W
 N2 N2 NE NE
 200 FNL 660 FEL of 1/4 SEC
 Derrick Elevation: 1230 Ground Elevation: 1215

First Sales Date:

Operator: CHESAPEAKE OPERATING LLC 17441
 PO BOX 18496
 6100 N WESTERN AVE
 OKLAHOMA CITY, OK 73154-0496

Completion Type	
X	Single Zone
	Multiple Zone
	Commingled

Location Exception	
Order No	
603507	

Increased Density	
Order No	
There are no Increased Density records to display.	

Casing and Cement							
Type	Size	Weight	Grade	Feet	PSI	SAX	Top of CMT
SURFACE	13 3/8	48	H-40	416		415	SURFACE
INTERMEDIATE	9 5/8	36	J-55	1492		505	SURFACE
PRODUCTION	7	26	P-110	5495		236	3709

Liner								
Type	Size	Weight	Grade	Length	PSI	SAX	Top Depth	Bottom Depth
LINER	4 1/2	13.5	P-110	4867	0	510	4839	9706

Total Depth: 9741

Packer	
Depth	Brand & Type
4813	R

Plug	
Depth	Plug Type
9630	PBTD

Initial Test Data

Test Date	Formation	Oil BBL/Day	Oil-Gravity (API)	Gas MCF/Day	Gas-Oil Ratio Cu FT/BBL	Water BBL/Day	Pumpin or Flowing	Initial Shut-In Pressure	Choke Size	Flow Tubing Pressure
May 31, 2015	MISSISSIPPIAN	2								

Completion and Test Data by Producing Formation

Formation Name: MISSISSIPPIAN

Code: 359MSSP

Class: TA

Spacing Orders

Order No	Unit Size
598348	320

Perforated Intervals

From	To
5316	9601

Acid Volumes

There are no Acid Volume records to display.

Fracture Treatments

There are no Fracture Treatments records to display.

Formation	Top
MISSISSIPPIAN	5265

Were open hole logs run? No

Date last log run:

Were unusual drilling circumstances encountered? No

Explanation:

Other Remarks

There are no Other Remarks.

Lateral Holes

Sec: 7 TWP: 27N RGE: 11W County: ALFALFA

NE SW SE SE

570 FSL 900 FEL of 1/4 SEC

Depth of Deviation: 4999 Radius of Turn: 301 Direction: 181 Total Length: 4476

Measured Total Depth: 9741 True Vertical Depth: 5300 End Pt. Location From Release, Unit or Property Line: 570

FOR COMMISSION USE ONLY

1137489

Status: Accepted

API NO. 35-003-22303
 OTC PROD.
 UNIT NO. 003-208968

PLEASE TYPE OR USE BLACK INK ONLY
 NOTE: Attach copy of original 1002A if recompletion or reentry.

OKLAHOMA CORPORATION COMMISSION
 Oil & Gas Conservation Division
 Post Office Box 52000
 Oklahoma City, Oklahoma 73152-2000
 Rule 165:10-3-25

RECEIVED
 1002A Rev. 2009

AUG 23 2017

ORIGINAL
 AMENDED
 Reason Amended **Reclassify as Temporarily Abandoned**

TYPE OF DRILLING OPERATION
 STRAIGHT HOLE DIRECTIONAL HOLE HORIZONTAL HOLE
 SERVICE WELL
 If directional or horizontal, see reverse for bottom hole location.

COUNTY ALFALFA SEC 7 TWP 27N RGE 11W
 LEASE NAME RUTH KNOPF 7-27-11 WELL NO 1H
 SHL N2 1/4 N2 1/4 NE 1/4 NE 1/4 200 1/4 SEC 660
 ELEVATION Derrick Fl 1,230 Ground 1,215 Latitude (if Known)
 OPERATOR NAME CHESAPEAKE OPERATING, INC. OTC/OCC OPERATOR NO. 17441
 ADDRESS P.O. BOX 18496
 CITY OKLAHOMA CITY STATE OK ZIP 73154

COMPLETION REPORT
 SPUD DATE 6/1/2012
 DRLG FINISHED DATE 6/23/2012
 DATE OF WELL COMPLETION 7/23/2012
 1ST PROD DATE 10/10/2012
 RECOMP DATE 8-23-2017
 Longitude (if Known)

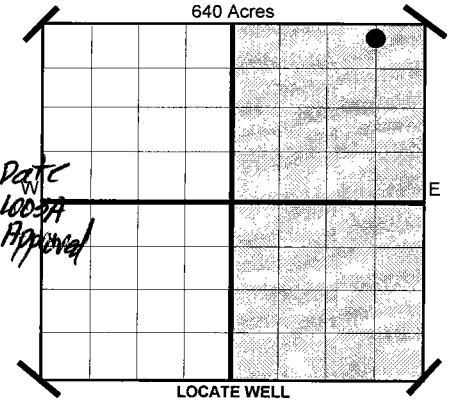

COMPLETION TYPE
 SINGLE ZONE
 MULTIPLE ZONE
 COMMINGLED
 LOCATION EXCEPTION ORDER NO. 598474 (Interim)
 INCREASED DENSITY ORDER NO. N/A

CASING & CEMENT (Form 1002C must be attached)

TYPE	SIZE	WEIGHT	GRADE	FEET	PSI	SAX	TOP	
CONDUCTOR								
SURFACE	13 3/8"	48#	H-40	416		415	Surface	
INTERMEDIATE	9 5/8"	36#	J-55	1,492		505	Surface	
PRODUCTION	7"	26#	P-110	5,495		236	3,709	
LINER	4 1/2"	13.5#	P-110	4,839-9,706		510	4,839	
							TOTAL DEPTH	9,741

PACKER @ 4.813 BRAND & TYPE R
 PLUG @ 9.630 TYPE PBDT
 PLUG @ TYPE

COMPLETION & TEST DATA BY PRODUCING FORMATION

359MSSP

FORMATION	MISSISSIPPIAN
SPACING & SPACING ORDER NUMBER	320 598348
CLASS: Oil, Gas, Dry, Inj. Disp, Comm Disp, Svc	Temporarily Abandoned
PERFORATED INTERVALS	5,316-9,601
ACID/VOLUME	
FRACTURE TREATMENT (Fluids/Prop Amounts)	

Minimum Gas Allowable (165:10-17-7) Gas Purchaser/Measurer
 OR 1st Sales Date

INITIAL TEST DATA

INITIAL TEST DATE	5/31/2015
OIL-BBL/DAY	2
OIL-GRAVITY (API)	
GAS-MCF/DAY	0
GAS-OIL RATIO CU FT/BBL	
WATER-BBL/DAY	0
PUMPING OR FLOWING	
INITIAL SHUT-IN PRESSURE	
CHOKE SIZE	
FLOW TUBING PRESSURE	

AS SUBMITTED

A record of the formations drilled through, and pertinent remarks are presented on the reverse. I declare that I have knowledge of the contents of this report and am authorized by my organization to make this report, which was prepared by me or under my supervision and direction, with the data and facts stated herein to be true, correct, and complete to the best of my knowledge and belief.

Sara Everett
 SIGNATURE Sara Everett, Regulatory Analyst 8/22/2017 DATE 405-848-8000 PHONE NUMBER
 P.O. BOX 18496 OKLAHOMA CITY OK 73154 sara.everett@chk.com EMAIL ADDRESS

PLEASE TYPE OR USE BLACK INK ONLY
FORMATION RECORD

Give formation names and tops, if available, or descriptions and thickness of formations drilled through. Show intervals cored or drillstem tested.

LEASE NAME RUTH KNOPF 7-27-11

WELL NO. 1H

NAMES OF FORMATIONS	TOP
MISSISSIPPIAN	5,265

FOR COMMISSION USE ONLY

ITD on file YES NO

APPROVED _____ DISAPPROVED _____

2) Reject Codes

Were open hole logs run? yes no

Date last log was run N/A

Was CO₂ encountered? yes no at what depths?

Was H₂S encountered? yes no at what depths?

Were unusual drilling circumstances encountered? yes no
If yes, briefly explain.

Other remarks:

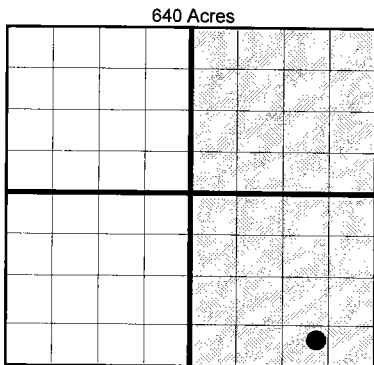

BOTTOM HOLE LOCATION FOR DIRECTIONAL HOLE

SEC	TWP	RGE	COUNTY			
Spot Location				Feet From 1/4 Sec Lines	FSL	FWL
1/4	1/4	1/4	1/4			
Measured Total Depth		True Vertical Depth		BHL From Lease, Unit, or Property Line:		

BOTTOM HOLE LOCATION FOR HORIZONTAL HOLE: (LATERALS)
LATERAL #1

SEC	TWP	RGE	COUNTY				
7	27N	11W	ALFALFA				
Spot Location				Feet From 1/4 Sec Lines	FSL	FEL	
NE 1/4	SW 1/4	SE 1/4	SE 1/4		570	900	
Depth of Deviation		Radius of Turn		Direction	Total Length		
4,999		301		181	4,476		
Measured Total Depth		True Vertical Depth		BHL From Lease, Unit, or Property Line:			
9,741		5,300		570			

If more than three drainholes are proposed, attach a separate sheet indicating the necessary information.

Direction must be stated in degrees azimuth. Please note, the horizontal drainhole and its end point must be located within the boundaries of the lease or spacing unit.

Directional surveys are required for all drainholes and directional wells.

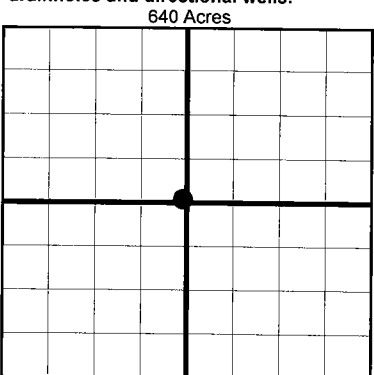

LATERAL #2

SEC	TWP	RGE	COUNTY			
Spot Location				Feet From 1/4 Sec Lines	FSL	FWL
1/4	1/4	1/4	1/4			
Depth of Deviation		Radius of Turn		Direction	Total Length	
Measured Total Depth		True Vertical Depth		BHL From Lease, Unit, or Property Line:		

LATERAL #3

SEC	TWP	RGE	COUNTY			
Spot Location				Feet From 1/4 Sec Lines	FSL	FWL
1/4	1/4	1/4	1/4			
Depth of Deviation		Radius of Turn		Direction	Total Length	
Measured Total Depth		True Vertical Depth		BHL From Lease, Unit, or Property Line:		