

Oklahoma Corporation Commission
Oil & Gas Conservation Division
Post Office Box 52000
Oklahoma City, Oklahoma 73152-2000
Rule 165: 10-3-25

Form 1002A

API No.: 35065202980001

Completion Report

Spud Date: April 01, 2016

OTC Prod. Unit No.: 065-217529

Drilling Finished Date: December 21, 2016

1st Prod Date: February 11, 2017

Completion Date: July 02, 2017

Drill Type: STRAIGHT HOLE
DIRECTIONAL HOLE

Well Name: BREWER 1-30

Purchaser/Measurer:

Location: JACKSON 30 1S 23W
C SW SE SW
330 FSL 1650 FWL of 1/4 SEC
Derrick Elevation: 1430 Ground Elevation: 1419

First Sales Date:

Operator: GLB EXPLORATION INC 18634

7716 MELROSE LN
OKLAHOMA CITY, OK 73127-6002

Completion Type	
X	Single Zone
	Multiple Zone
	Commingled

Location Exception
Order No
There are no Location Exception records to display.

Increased Density
Order No
There are no Increased Density records to display.

Casing and Cement							
Type	Size	Weight	Grade	Feet	PSI	SAX	Top of CMT
CONDUCTOR	16	42	J-55	60		4	SURFACE
SURFACE	8 5/8	24	J-55	320	400	125	SURFACE
PRODUCTION	5 1/2	17	P-110	5894	1000	125	5026
PRODUCTION	5 1/2	15.5 & 17	N-80 & J-55	5924	1400	150	4900

Liner								
Type	Size	Weight	Grade	Length	PSI	SAX	Top Depth	Bottom Depth
There are no Liner records to display.								

Total Depth: 5940

Packer	
Depth	Brand & Type
There are no Packer records to display.	

Plug	
Depth	Plug Type
5700	CEMENT

Initial Test Data

Test Date	Formation	Oil BBL/Day	Oil-Gravity (API)	Gas MCF/Day	Gas-Oil Ratio Cu FT/BBL	Water BBL/Day	Pumpin or Flowing	Initial Shut-In Pressure	Choke Size	Flow Tubing Pressure
Jul 15, 2016	CANYON					75	PUMPING	100		
Jul 02, 2017	CANYON	5				42	PUMPING	100		

Completion and Test Data by Producing Formation

Formation Name: CANYON

Code: 405CNYN

Class: DRY

Spacing Orders

Order No	Unit Size
646345	80

Perforated Intervals

From	To
5794	5802

Acid Volumes

2,000 GALLONS 4% NEFE HCL

Fracture Treatments

400 BARRELS 60 QUANTITY CO2 FOAM WITH 31,000 POUNDS 20/40 SAND
--

Formation Name: CANYON

Code: 405CNYN

Class: OIL

Spacing Orders

Order No	Unit Size
646345	80

Perforated Intervals

From	To
5792	5858

Acid Volumes

3,500 GALLONS 4% NEFE HCL

Fracture Treatments

There are no Fracture Treatments records to display.
--

Formation	Top
CANYON	5500

Were open hole logs run? Yes

Date last log run: December 21, 2016

Were unusual drilling circumstances encountered? No

Explanation:

Other Remarks
INITIAL WELL WAS VERTICAL. CANYON TESTED WET. CUT CASING @ 4,900' AND SIDETRACKED WELL TO NORTH TO TEST CANYON AGAIN.

Bottom Holes

Sec: 30 TWP: 1S RGE: 23W County: JACKSON

NE SW SE SW

506 FSL 1654 FWL of 1/4 SEC

Depth of Deviation: 0 Radius of Turn: 0 Direction: 0 Total Length: 0

Measured Total Depth: 5940 True Vertical Depth: 5928 End Pt. Location From Release, Unit or Property Line: 334

Status: Accepted

RECEIVED

JUL 12 2017

Form 1002A Rev. 2009

API NO. 065-20298
OTC PROD. UNIT NO. 065-217529

PLEASE TYPE OR USE BLACK INK ONLY
NOTE:

Attach copy of original 1002A if recompletion or reenry.

OKLAHOMA CORPORATION COMMISSION
Oil & Gas Conservation Division
Post Office Box 52000
Oklahoma City, Oklahoma 73152-2000
Rule 165:10-3-25

OKLAHOMA CORPORATION COMMISSION

ORIGINAL
 AMENDED (Reason)

COMPLETION REPORT

TYPE OF DRILLING OPERATION
 STRAIGHT HOLE DIRECTIONAL HOLE HORIZONTAL HOLE
 SERVICE WELL

SPUD DATE 4/7/16 + 12/9/16
DRLG FINISHED DATE 4/8/16 + 12/21/16

COUNTY JACKSON SEC 30 TWP 15 RGE 23W
LEASE NAME BREWER

DATE OF WELL COMPLETION 7/12/17
1st PROD DATE 2/1/17

C 1/4 SW 1/4 SE 1/4 SW 1/4 FSL OF 1/4 SEC 330 FWL OF 1/4 SEC 1650

RECOMP DATE

ELEVATIO N Derrick 1430 Ground 1419 Latitude (if known)

Longitude (if known)

OPERATOR NAME GLB EXPLORATION, INC
ADDRESS 7716 MELROSE LANE
CITY OKC STATE OK ZIP 73127

OTC/OCC OPERATOR NO. 18634-0

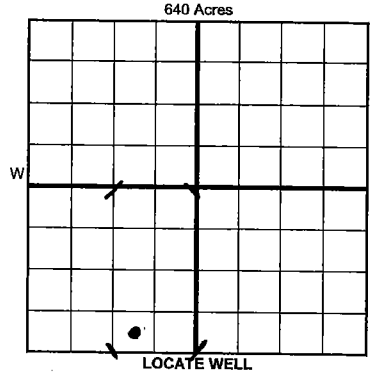

COMPLETION TYPE

SINGLE ZONE
 MULTIPLE ZONE
 COMMINGLED
LOCATION EXCEPTION ORDER INCREASED DENSITY ORDER NO.

CASING & CEMENT (Form 1002C must be attached)

TYPE	SIZE	WEIGHT	GRADE	FEET	PSI	SAX	TOP OF CMT
CONDUCTOR	16	42	J-55	60	-	4 YDS	SURFACE
SURFACE	8 5/8	24	J-55	320	400	125	SURFACE
INTERMEDIATE							
PRODUCTION	5 1/2	17	P-110	5894	1000	125	5026
LINEAR PRODUCTION	5 1/2	15.5	N-80 J-55	5924	1,400	150	4900
TOTAL DEPTH							5940

PACKER @ BRAND & TYPE Cement PLUG @ 5700' TYPE PLUG @ TYPE TOTAL DEPTH 5940

COMPLETION & TEST DATA BY PRODUCING FORMATION 405CNYN 405CNYN

FORMATION	CANYON	CANYON (Directional)	Reported to Real Focus
SPACING & SPACING ORDER NUMBER	80-646345	80-646345	
CLASS: Oil, Gas, Dry, Inj, Disp, Comm Disp, Svc	DRY	OIL	
PERFORATED INTERVALS	5794-5802	5842-58 5792-98	
ACID/VOLUME	2000 gal 4% NE FEHCL	3500 gal 4% NE FEHCL	
FRACTURE TREATMENT (Fluids/Prop Amounts)	400 bbls 60 quality CO2 Foam with 31,000 # 20/40 SD	NONE	

Min Gas Allowable (165:10-17-7) OR Oil Allowable (165:10-13-3) Gas Purchaser/Measurer First Sales Date

INITIAL TEST DATA

INITIAL TEST DATE	7/15/16	7/12/17
OIL-BBL/DAY	0	5
OIL-GRAVITY (API)	-	-
GAS-MCF/DAY	0	0
GAS-OIL RATIO CU FT/BBL	-	-
WATER-BBL/DAY	75	42
PUMPING OR FLOWING	Pumping	Pumping
INITIAL SHUT-IN PRESSURE	100	100
CHOKE SIZE	-	-
FLOW TUBING PRESSURE	-	-

AS SUBMITTED

A record of the formations drilled through, and pertinent remarks are presented on the reverse. I declare that I have knowledge of the contents of this report and am authorized by my organization to make this report, which was prepared by me or under my supervision and direction, with the data and facts stated herein to be true, correct, and complete to the best of my knowledge and belief.
SIGNATURE Glenn Blumstein DATE 7/10/17 PHONE NUMBER 405-787-0099
ADDRESS 7716 Melrose Ln OKC CITY OK STATE ZIP 73127 EMAIL ADDRESS

PLEASE TYPE OR USE BLACK INK ONLY

FORMATION RECORD

Give formation names and tops, if available, or descriptions and thickness of formations drilled through. Show intervals cored or drillstem tested.

LEASE NAME BREWER WELL NO. 1-30

NAMES OF FORMATIONS	TOP
<u>Canyon</u>	<u>5500</u>

FOR COMMISSION USE ONLY

ITD on file YES NO

APPROVED _____ DISAPPROVED _____ 2) Reject Codes _____

Were open hole logs run? yes no

Date Last log was run 12/21/2016

Was CO₂ encountered? yes no at what depths? _____

Was H₂S encountered? yes no at what depths? _____

Were unusual drilling circumstances encountered? yes no
If yes, briefly explain below _____

Other remarks: INITIAL WELL WAS VERTICAL. CANYON TESTED WET. CUT CASING @ 4900' AND SIDETRACKED WELL TO NORTH TO TEST CANYON AGAIN.

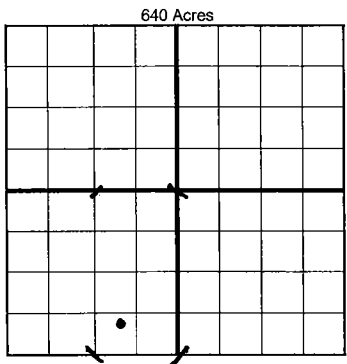

If more than three drainholes are proposed, attach a separate sheet indicating the necessary information.

Direction must be stated in degrees azimuth. Please note, the horizontal drainhole and its end point must be located within the boundaries of the lease or spacing unit.

Directional surveys are required for all drainholes and directional wells.

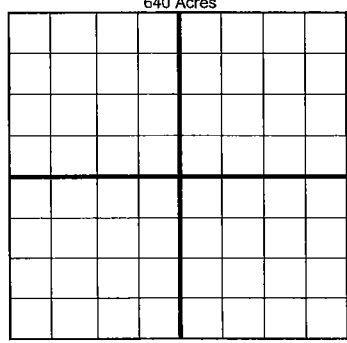

BOTTOM HOLE LOCATION FOR DIRECTIONAL HOLE

SEC <u>30</u>	TWP <u>1S</u>	RGE <u>23W</u>	COUNTY <u>JACKSON</u>
Spot Location <u>NE 1/4 SW 1/4 SE 1/4 SW 1/4</u>		Feet From 1/4 Sec Lines	FSL <u>506.5</u> FWL <u>1654.1</u>
Measured Total Depth <u>5940</u>		True Vertical Depth <u>5928.9</u>	BHL From Lease, Unit, or Property Line: <u>334.1</u>

BOTTOM HOLE LOCATION FOR HORIZONTAL HOLE: (LATERALS)

LATERAL #1

SEC	TWP	RGE	COUNTY
Spot Location		Feet From 1/4 Sec Lines	FSL
Depth of Deviation		Radius of Turn	Total Length
Measured Total Depth		True Vertical Depth	BHL From Lease, Unit, or Property Line:

LATERAL #2

SEC	TWP	RGE	COUNTY
Spot Location		Feet From 1/4 Sec Lines	FSL
Depth of Deviation		Radius of Turn	Total Length
Measured Total Depth		True Vertical Depth	BHL From Lease, Unit, or Property Line:

LATERAL #3

SEC	TWP	RGE	COUNTY
Spot Location		Feet From 1/4 Sec Lines	FSL
Depth of Deviation		Radius of Turn	Total Length
Measured Total Depth		True Vertical Depth	BHL From Lease, Unit, or Property Line: