

Oklahoma Corporation Commission
Oil & Gas Conservation Division
Post Office Box 52000
Oklahoma City, Oklahoma 73152-2000
Rule 165: 10-3-25

Form 1002A

API No.: 35117236830002

Completion Report

Spud Date: December 12, 2016

OTC Prod. Unit No.:

Drilling Finished Date: December 14, 2016

Amended

1st Prod Date:

Amend Reason: CORRECT PRODUCTION CASING SIZE

Completion Date: January 25, 2017

Drill Type: STRAIGHT HOLE

Well Name: J L MILLER 33

Purchaser/Measurer:

Location: PAWNEE 19 21N 8E
SW NE NW NE
561 FNL 1690 FEL of 1/4 SEC
Derrick Elevation: 0 Ground Elevation: 780

First Sales Date:

Operator: MID-CON ENERGY OPERATING LLC 23271

2431 E 61ST ST STE 850
TULSA, OK 74136-1236

Completion Type	
X	Single Zone
	Multiple Zone
	Commingled

Location Exception	
Order No	
There are no Location Exception records to display.	

Increased Density	
Order No	
There are no Increased Density records to display.	

Casing and Cement							
Type	Size	Weight	Grade	Feet	PSI	SAX	Top of CMT
SURFACE	8 5/8			168		125	SURFACE
PRODUCTION	5 1/2			2245		350	SURFACE

Liner								
Type	Size	Weight	Grade	Length	PSI	SAX	Top Depth	Bottom Depth
There are no Liner records to display.								

Total Depth: 2250

Packer	
Depth	Brand & Type
There are no Packer records to display.	

Plug	
Depth	Plug Type
There are no Plug records to display.	

Initial Test Data										
Test Date	Formation	Oil BBL/Day	Oil-Gravity (API)	Gas MCF/Day	Gas-Oil Ratio Cu FT/BBL	Water BBL/Day	Pumpin or Flowing	Initial Shut-In Pressure	Choke Size	Flow Tubing Pressure
Jan 25, 2017	CLEVELAND	1				138				

Completion and Test Data by Producing Formation

Formation Name: CLEVELAND

Code: 405CLVD

Class: OIL

Spacing Orders

Order No	Unit Size
609199	UNIT

Perforated Intervals

From	To
1586	1637

Acid Volumes

1,500 GALLONS 7 1/2% SME

Fracture Treatments

110,292 POUNDS 12/20 SAND, 20,292 POUNDS 12/20 RC

Formation Name: CLEVELAND

Code: 405CLVD

Class: OIL

Spacing Orders

Order No	Unit Size
609199	UNIT

Perforated Intervals

From	To
1500	1562

Acid Volumes

58.95 BARRELS 7 1/2% SME

Fracture Treatments

72,000 POUNDS 12/20, 54,000 POUNDS BRADY, 18,000 POUNDS RC
--

Formation	Top
LAYTON	1150
CHECKERBOARD	1405
CLEVELAND	1500
BIG LIME	1700
OSWEGO	1805
PRUE	1875
SKINNER	2015
PINK LIME	2045
BARTLESVILLE	2110

Were open hole logs run? Yes

Date last log run: December 15, 2016

Were unusual drilling circumstances encountered? No

Explanation:

Other Remarks

There are no Other Remarks.

FOR COMMISSION USE ONLY

1137135

Status: Accepted

-02

RECEIVED

Form 1002A Rev. 2009

JUL 10 2017

API NO. 117-23683-X
OTC PROD.
UNIT NO.

PLEASE TYPE OR USE BLACK INK ONLY
NOTE:

Attach copy of original 1002A if recompletion or reentry.

OKLAHOMA CORPORATION COMMISSION
Oil & Gas Conservation Division
Post Office Box 52000
Oklahoma City, Oklahoma 73152-2000
Rule 165:10-3-25

OKLAHOMA CORPORATION COMMISSION

ORIGINAL
 AMENDED (Reason) **CORRECT PROD CASING SIZE**

COMPLETION REPORT

TYPE OF DRILLING OPERATION
 STRAIGHT HOLE DIRECTIONAL HOLE HORIZONTAL HOLE
 SERVICE WELL
If directional or horizontal, see reverse for bottom hole location.

SPUD DATE 12/12/2016
DRLG FINISHED DATE 12/14/2016
DATE OF WELL COMPLETION 1/25/2017
1st PROD DATE
RECOMP DATE
OTC/OCC OPERATOR NO. 23271

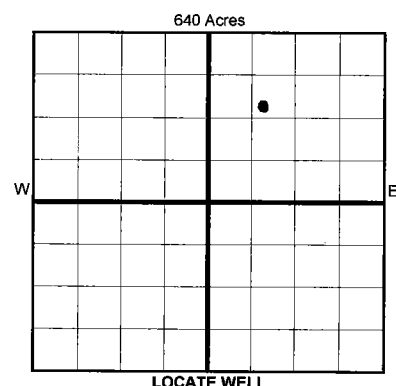

COUNTY PAWNEE SEC 19 TWP 21N RGE 8E
LEASE NAME JL MILLER WELL NO. 33
SW 1/4 SE 1/4 NW 1/4 NE 1/4 FSL OF 1/4 SEC 561 FNL FWL OF 1/4 SEC 1690 FE
ELEVATIO N Derrick Ground 780 Latitude (if known) Longitude (if known)
OPERATOR NAME MID-CON ENERGY OPERATING, LLC
ADDRESS 2341 E 61ST ST., SUITE 850
CITY TULSA STATE OK ZIP 74136

COMPLETION TYPE
 SINGLE ZONE
 MULTIPLE ZONE
Application Date
 COMMINGLED
Application Date
LOCATION
EXCEPTION ORDER
INCREASED DENSITY
ORDER NO.

CASING & CEMENT (Form 1002C must be attached)

TYPE	SIZE	WEIGHT	GRADE	FEET	PSI	SAX	TOP OF CMT
CONDUCTOR							
SURFACE	8 5/8"			168'		125	SURF
INTERMEDIATE							
PRODUCTION	5 1/2"			2245'		350	SURF
LINER							
							2250'

Rec. original 1002A

PACKER @ _____ BRAND & TYPE _____ PLUG @ _____ TYPE _____ PLUG @ _____ TYPE _____
PACKER @ _____ BRAND & TYPE _____ PLUG @ _____ TYPE _____ PLUG @ _____ TYPE _____

COMPLETION & TEST DATA BY PRODUCING FORMATION **2405CLVD**

FORMATION	(Lower) Cleveland	(Upper) Cleveland	
SPACING & SPACING ORDER NUMBER	609199 (unit)	609199 (unit)	
CLASS: Oil, Gas, Dry, Inj, Disp, Comm Disp, Svc	OIL	OIL	
PERFORATED INTERVALS	1586' - 1600'	1500' - 06', 1512' -	
	1612' - 1637'	22', 1534' - 44'	
		1554' - 62'	
ACID/VOLUME	1500 gal 7 1/2%	58.95 BBLS	
FRACTURE TREATMENT (Fluids/Prop Amounts)	SME	7 1/2% SME	
	110,292# 12/20 snd	72,000# 12/20	
	20,292# 12/20 RC	54,000# Brady	18,000# RC

Reported to Frac Focus

Min Gas Allowable (165:10-17-7) Gas Purchaser/Measurer _____
OR
 Oil Allowable (165:10-13-3) First Sales Date _____

INITIAL TEST DATA

INITIAL TEST DATE	1/25/2017	
OIL-BBL/DAY	1.0	
OIL-GRAVITY (API)		
GAS-MCF/DAY		
GAS-OIL RATIO CU FT/BBL		
WATER-BBL/DAY	138	
PUMPING OR FLOWING		
INITIAL SHUT-IN PRESSURE		
CHOKE SIZE		
FLOW TUBING PRESSURE		

AS SUBMITTED

A record of the formations drilled through, and pertinent remarks are presented on the reverse. I declare that I have knowledge of the contents of this report and am authorized by my organization to make this report, which was prepared by me or under my supervision and direction, with the data and facts stated herein to be true, correct, and complete to the best of my knowledge and belief.

Annie Houchin SIGNATURE
2341 E 61ST ST., SUITE 850 ADDRESS
TULSA CITY
OK STATE
74136 ZIP

ANNIE HOUCHIN NAME (PRINT OR TYPE)
7/6/2017 DATE
918-748-3343 PHONE NUMBER
ahouchin@midcon-energy.com EMAIL ADDRESS

PLEASE TYPE OR USE BLACK INK ONLY
FORMATION RECORD

Give formation names and tops, if available, or descriptions and thickness of formations drilled through. Show intervals cored or drillstem tested.

NAMES OF FORMATIONS	TOP
LAYTON	1,150
CHECKERBOARD	1,405
CLEVELAND	1500
BIG LIME	1,700
OSWEGO	1,805
PRUE	1,875
SKINNER	2,015
PINK LIME	2,045
BARTLESVILLE	2,110

LEASE NAME JL MILLER WELL NO. 33

FOR COMMISSION USE ONLY

ITD on file YES NO

APPROVED _____ DISAPPROVED _____

2) Reject Codes _____

Were open hole logs run? yes no

Date Last log was run 12/15/2016

Was CO₂ encountered? yes no at what depths? _____

Was H₂S encountered? yes no at what depths? _____

Were unusual drilling circumstances encountered? yes no
If yes, briefly explain below

Other remarks:

640 Acres

If more than three drainholes are proposed, attach a separate sheet indicating the necessary information.

Direction must be stated in degrees azimuth. Please note, the horizontal drainhole and its end point must be located within the boundaries of the lease or spacing unit.

Directional surveys are required for all drainholes and directional wells.

640 Acres

BOTTOM HOLE LOCATION FOR DIRECTIONAL HOLE

SEC	TWP	RGE	COUNTY								
Spot Location				1/4	1/4	1/4	1/4	Feet From 1/4 Sec Lines	FSL	FWL	
Measured Total Depth				True Vertical Depth				BHL From Lease, Unit, or Property Line:			

BOTTOM HOLE LOCATION FOR HORIZONTAL HOLE: (LATERALS)

LATERAL #1

SEC	TWP	RGE	COUNTY								
Spot Location				1/4	1/4	1/4	1/4	Feet From 1/4 Sec Lines	FSL	FWL	
Depth of Deviation				Radius of Turn				Direction		Total Length	
Measured Total Depth				True Vertical Depth				BHL From Lease, Unit, or Property Line:			

LATERAL #2

SEC	TWP	RGE	COUNTY								
Spot Location				1/4	1/4	1/4	1/4	Feet From 1/4 Sec Lines	FSL	FWL	
Depth of Deviation				Radius of Turn				Direction		Total Length	
Measured Total Depth				True Vertical Depth				BHL From Lease, Unit, or Property Line:			

LATERAL #3

SEC	TWP	RGE	COUNTY								
Spot Location				1/4	1/4	1/4	1/4	Feet From 1/4 Sec Lines	FSL	FWL	
Depth of Deviation				Radius of Turn				Direction		Total Length	
Measured Total Depth				True Vertical Depth				BHL From Lease, Unit, or Property Line:			