

Oklahoma Corporation Commission
Oil & Gas Conservation Division
Post Office Box 52000
Oklahoma City, Oklahoma 73152-2000
Rule 165: 10-3-25

Form 1002A

API No.: 35117200880002

Completion Report

Spud Date: September 04, 1967

OTC Prod. Unit No.:

Drilling Finished Date: September 27, 1967

Amended

1st Prod Date: September 28, 1967

Amend Reason: CONVERT TO PRODUCTION

Completion Date: September 28, 1967

Recomplete Date: November 01, 2016

Drill Type: STRAIGHT HOLE

Well Name: SHIELDS 1

Purchaser/Measurer:

Location: PAWNEE 2 21N 5E
C NW NE SE
2310 FSL 1650 FWL of 1/4 SEC
Derrick Elevation: 820 Ground Elevation: 0

First Sales Date:

Operator: AOG OPERATING LLC 23059

1803 E 17TH ST
TULSA, OK 74104-5304

Completion Type	
X	Single Zone
	Multiple Zone
	Commingled

Location Exception	
Order No	
There are no Location Exception records to display.	

Increased Density	
Order No	
There are no Increased Density records to display.	

Casing and Cement							
Type	Size	Weight	Grade	Feet	PSI	SAX	Top of CMT
SURFACE	8.625			110		80	SURFACE
PRODUCTION	4.5			2952		75	2549

Liner								
Type	Size	Weight	Grade	Length	PSI	SAX	Top Depth	Bottom Depth
There are no Liner records to display.								

Total Depth: 2962

Packer	
Depth	Brand & Type
There are no Packer records to display.	

Plug	
Depth	Plug Type
There are no Plug records to display.	

Initial Test Data										
Test Date	Formation	Oil BBL/Day	Oil-Gravity (API)	Gas MCF/Day	Gas-Oil Ratio Cu FT/BBL	Water BBL/Day	Pumpin or Flowing	Initial Shut-In Pressure	Choke Size	Flow Tubing Pressure
Jun 01, 2017	RED FORK	0.5						110		

Completion and Test Data by Producing Formation

Formation Name: RED FORK

Code: 404RDFK

Class: OIL

Formation	Top
RED FORK	2952

Were open hole logs run? No

Date last log run:

Were unusual drilling circumstances encountered? No

Explanation:

Other Remarks

OCC - THIS WELL IS AN OPEN HOLE COMPLETION FROM BOTTOM OF THE 4 1/2" CASING AT 2,952' TO 2,962' TOTAL DEPTH.

FOR COMMISSION USE ONLY

Status: Accepted

1137132

RECEIVED

JUL 10 2017

OKLAHOMA CORPORATION COMMISSION

API NO. **35-11720088**
OTC PROD. UNIT NO.

PLEASE TYPE OR USE BLACK INK ONLY
NOTE:

Attach copy of original 1002A if recompletion or reentry.

OKLAHOMA CORPORATION COMMISSION
Oil & Gas Conservation Division
Post Office Box 52000
Oklahoma City, Oklahoma 73152-2000
Rule 165:10-3-25

ORIGINAL
 AMENDED (Reason)

Convert to Production

COMPLETION REPORT

TYPE OF DRILLING OPERATION
 STRAIGHT HOLE DIRECTIONAL HOLE HORIZONTAL HOLE
 SERVICE WELL
If directional or horizontal, see reverse for bottom hole location.

SPUD DATE **9/4/67**
DRLG FINISHED DATE **9/27/67**
DATE OF WELL COMPLETION **9/28/67**
1st PROD DATE **9/28/67**
RECOMP DATE **11/1/16**
Longitude (if known)

COUNTY **Pawnee** SEC **2** TWP **21N** RGE **5E**
LEASE NAME **SHIELDS** WELL NO. **1**
C **1/4 NW 1/4 NE 1/4 SE 1/4** FSL OF 1/4 SEC **2310** FWL OF 1/4 SEC **1650**
ELEVATION **820** Ground Latitude (if known)
OPERATOR NAME **AOG OPERATING, LLC** OTC/OCC OPERATOR NO. **23059**
ADDRESS **1803 E. 17TH ST.**
CITY **TULSA** STATE **OK** ZIP **74104**

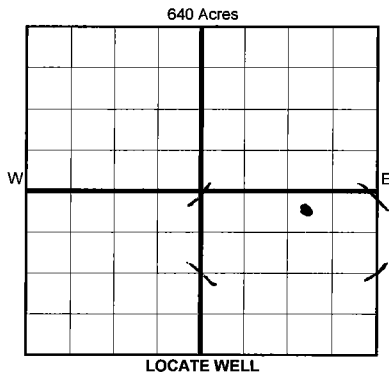

COMPLETION TYPE
 SINGLE ZONE
 MULTIPLE ZONE
Application Date
COMINGLED
Application Date
LOCATION
EXCEPTION ORDER
INCREASED DENSITY
ORDER NO.

CASING & CEMENT (Form 1002C must be attached)

TYPE	SIZE	WEIGHT	GRADE	FEET	PSI	SAX	TOP OF CMT	
CONDUCTOR								
SURFACE	8.625"			110'		80	SURFACE	
INTERMEDIATE								
PRODUCTION	4.5"			2952		75	2549	
LINER								
							TOTAL DEPTH	2,962'

PACKER @ _____ BRAND & TYPE _____ PLUG @ _____ TYPE _____ PLUG @ _____ TYPE _____
PACKER @ _____ BRAND & TYPE _____ PLUG @ _____ TYPE _____ PLUG @ _____ TYPE _____

COMPLETION & TEST DATA BY PRODUCING FORMATION *404RDFK*

FORMATION	SPACING & SPACING ORDER NUMBER	CLASS: Oil, Gas, Dry, Inj, Disp, Comm Disp, Svc	PERFORATED INTERVALS	ACID/VOLUME	FRACTURE TREATMENT (Fluids/Prop Amounts)
REDFORK		<i>oil</i>	<i>OPEN HOLE</i>		
		<i>2952-62-</i>			

Min Gas Allowable (165:10-17-7) OR Gas Purchaser/Measurer First Sales Date
 Oil Allowable (165:10-13-3)

INITIAL TEST DATA

INITIAL TEST DATE	6/1/2017
OIL-BBL/DAY	0.5
OIL-GRAVITY (API)	
GAS-MCF/DAY	0
GAS-OIL RATIO CU FT/BBL	
WATER-BBL/DAY	
PUMPING OR FLOWING	
INITIAL SHUT-IN PRESSURE	110
CHOKE SIZE	
FLOW TUBING PRESSURE	

AS SUBMITTED

A record of the formations drilled through, and pertinent remarks are presented on the reverse. I declare that I have knowledge of the contents of this report and am authorized by my organization to make this report, which was prepared by me or under my supervision and direction, with the data and facts stated herein to be true, correct, and complete to the best of my knowledge and belief.

[Signature] SIGNATURE **DOUGLAS SWIFT** NAME (PRINT OR TYPE) **6/23/2017** DATE **512-497-6496** PHONE NUMBER
1803 E. 17TH ST. ADDRESS **TULSA** CITY **OK** STATE **74104** ZIP **AUSTIN@ASPECTOIL.COM** EMAIL ADDRESS

PLEASE TYPE OR USE BLACK INK ONLY
FORMATION RECORD

Give formation names and tops, if available, or descriptions and thickness of formations drilled through. Show intervals cored or drillstem tested.

LEASE NAME SHIELDS WELL NO. 1

NAMES OF FORMATIONS	TOP
REDFORK	2952'

FOR COMMISSION USE ONLY

ITD on file YES NO

APPROVED _____ DISAPPROVED _____

2) Reject Codes _____

Were open hole logs run? yes no

Date Last log was run _____

Was CO₂ encountered? yes no at what depths? _____

Was H₂S encountered? yes no at what depths? _____

Were unusual drilling circumstances encountered? yes no
If yes, briefly explain below _____

Other remarks: *OCC - This well is an open hole completion from bottom of the 4 1/2" casing at 2952' to 2962' total depth*

640 Acres

If more than three drainholes are proposed, attach a separate sheet indicating the necessary information.

Direction must be stated in degrees azimuth. Please note, the horizontal drainhole and its end point must be located within the boundaries of the lease or spacing unit.

Directional surveys are required for all drainholes and directional wells.

640 Acres

BOTTOM HOLE LOCATION FOR DIRECTIONAL HOLE

SEC	TWP	RGE	COUNTY
Spot Location	1/4	1/4	1/4
Measured Total Depth	True Vertical Depth		Feet From 1/4 Sec Lines
			FSL
			FWL
			BHL From Lease, Unit, or Property Line:

BOTTOM HOLE LOCATION FOR HORIZONTAL HOLE: (LATERALS)

LATERAL #1

SEC	TWP	RGE	COUNTY
Spot Location	1/4	1/4	1/4
Depth of Deviation	Radius of Turn		Direction
			Total Length
Measured Total Depth	True Vertical Depth		BHL From Lease, Unit, or Property Line:

LATERAL #2

SEC	TWP	RGE	COUNTY
Spot Location	1/4	1/4	1/4
Depth of Deviation	Radius of Turn		Direction
			Total Length
Measured Total Depth	True Vertical Depth		BHL From Lease, Unit, or Property Line:

LATERAL #3

SEC	TWP	RGE	COUNTY
Spot Location	1/4	1/4	1/4
Depth of Deviation	Radius of Turn		Direction
			Total Length
Measured Total Depth	True Vertical Depth		BHL From Lease, Unit, or Property Line: