

Oklahoma Corporation Commission
Oil & Gas Conservation Division
Post Office Box 52000
Oklahoma City, Oklahoma 73152-2000
Rule 165: 10-3-25

Form 1002A

API No.: 35003232710000

Completion Report

Spud Date: January 31, 2017

OTC Prod. Unit No.: 003-218875

Drilling Finished Date: March 25, 2017

1st Prod Date: June 19, 2017

Completion Date: June 17, 2017

Drill Type: HORIZONTAL HOLE

Min Gas Allowable: Yes

Well Name: ARUBA 2412 1H-15 C

Purchaser/Measurer: SEMGAS

Location: ALFALFA 15 24N 12W
N2 N2 NW NE
225 FNL 1980 FEL of 1/4 SEC
Latitude: 36.563846017 Longitude: -98.468820699
Derrick Elevation: 0 Ground Elevation: 1320

First Sales Date: 09/23/2017

Operator: MIDSTATES PETROLEUM CO LLC 23079

321 S BOSTON AVE STE 1000
TULSA, OK 74103-3322

Completion Type	
X	Single Zone
	Multiple Zone
	Commingled

Location Exception	
Order No	
662048	

Increased Density	
Order No	
There are no Increased Density records to display.	

Casing and Cement							
Type	Size	Weight	Grade	Feet	PSI	SAX	Top of CMT
SURFACE	13 3/8	48	J-55	452		460	SURFACE
INTERMEDIATE	9 5/8	36	J-55	1223		460	SURFACE
PRODUCTION	7	26	P-110	6792		490	5843

Liner								
Type	Size	Weight	Grade	Length	PSI	SAX	Top Depth	Bottom Depth
LINER	4.5	11.6	P-110	5000	0	595	6608	11608

Total Depth: 11608

Packer	
Depth	Brand & Type
There are no Packer records to display.	

Plug	
Depth	Plug Type
There are no Plug records to display.	

Initial Test Data

Test Date	Formation	Oil BBL/Day	Oil-Gravity (API)	Gas MCF/Day	Gas-Oil Ratio Cu FT/BBL	Water BBL/Day	Pumpin or Flowing	Initial Shut-In Pressure	Choke Size	Flow Tubing Pressure
Jun 29, 2017	MISSISSIPPIAN	230	33	1161	5047	3382	PUMPING	99	64/64	215

Completion and Test Data by Producing Formation

Formation Name: MISSISSIPPIAN

Code: 359MSSP

Class: OIL

Spacing Orders

Order No	Unit Size
661283	640

Perforated Intervals

From	To
6975	11509

Acid Volumes

5,854 BARRELS 15% GELLED AND RET ACID, 1,182 BARRELS 15% HCL

Fracture Treatments

112,998 BARRELS SLICK WATER, 444,240 POUNDS ROCK SALT

Formation	Top
ENDICOTT	4698
TONKAWA	4977
AVANT	5370
COTTAGE GROVE	5420
HOGSHOOTER	5556
BIG LIME	5790
OSWEGO	5822
CHEROKEE	5951
MISSISSIPPI LIME	6300

Were open hole logs run? No

Date last log run:

Were unusual drilling circumstances encountered? No

Explanation:

Other Remarks

OCC - THIS DOCUMENT IS ACCEPTED BASED ON THE DATA SUBMITTED THE FINAL LOCATION EXCEPTION HAS NOT BEEN ISSUED.

Lateral Holes

Sec: 15 TWP: 24N RGE: 12W County: ALFALFA

NE SW SW SE

462 FSL 2007 FEL of 1/4 SEC

Depth of Deviation: 7001 Radius of Turn: 1266 Direction: 180 Total Length: 4816

Measured Total Depth: 11608 True Vertical Depth: 6414 End Pt. Location From Release, Unit or Property Line: 462

FOR COMMISSION USE ONLY

1137129

Status: Accepted

API NO. 003 23271
 OTC PROD. UNIT NO. 003 218875

PLEASE TYPE OR USE BLACK INK ONLY
 NOTE:
 Attach copy of original 1002A if recompletion or reentry.

OKLAHOMA CORPORATION COMMISSION
 Oil & Gas Conservation Division
 Post Office Box 52000
 Oklahoma City, Oklahoma 73152-2000
 Rule 165:10-3-25

RECEIVED

JUL 03 2017

Form 1002A Rev. 2009

ORIGINAL
 AMENDED (Reason)

TYPE OF DRILLING OPERATION
 STRAIGHT HOLE DIRECTIONAL HOLE HORIZONTAL HOLE

SPUD DATE 03/12/2017 - 1-31-2017
 DRLG FINISHED DATE 03/25/2017

COUNTY Alfalfa SEC 15 TWP 24N RGE 12W
 LEASE NAME Aruba 2412 WELL NO. 14-15C
 N2 1/4 N2 1/4 NW 1/4 NE 1/4 OF 225N SW 1/4 OF 1980E
 ELEVATION Ground 1320 Latitude (if known) 36.563846017 Longitude (if known) -98.468820699
 OPERATOR NAME Midstates Petroleum Company LLC OTC/OCC OPERATOR NO. 23079
 ADDRESS 321 South Boston, Suite 1000
 CITY Tulsa STATE OK ZIP 74103

DATE OF WELL COMPLETION 06/17/2017
 1st PROD DATE 06/19/2017
 RECOMP DATE

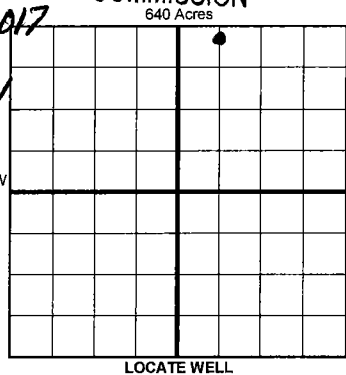

COMPLETION TYPE
 SINGLE ZONE
 MULTIPLE ZONE
 Application Date
 COMMINGLED
 Application Date
 LOCATION EXCEPTION ORDER 662048
 INCREASED DENSITY ORDER NO. N/A

CASING & CEMENT (Form 1002C must be attached)

TYPE	SIZE	WEIGHT	GRADE	FEET	PSI	SAX	TOP OF CMT
CONDUCTOR							
SURFACE	13-3/8	48#	J-55	452'		460	surface
INTERMEDIATE	9-5/8	36#	J-55	1,223'		460	surface
PRODUCTION	7	26#	P-110	6,792'		490	5,843
LINER	4.5	11.6#	P-110	6,608'	11,608'	595	6,607
TOTAL DEPTH							11,608'

PACKER @ _____ BRAND & TYPE _____ PLUG @ _____ TYPE _____ PLUG @ _____ TYPE _____
 PACKER @ _____ BRAND & TYPE _____ PLUG @ _____ TYPE _____ PLUG @ _____ TYPE _____

COMPLETION & TEST DATA BY PRODUCING FORMATION 35A M SSP

FORMATION	Mississippian									Reported to FractFocus
SPACING & SPACING ORDER NUMBER	640/661283									
CLASS: Oil, Gas, Dry, Inj, Disp, Comm Disp, Svc	gas O.I per 60R									
PERFORATED INTERVALS	6,975'-11,509'									
ACID/VOLUME	5854 bbls 15% gelled & ret acid	1182 bbls 15% HCl								
FRACTURE TREATMENT (Fluids/Prop Amounts)	112,998 bbls slk wtr									
	444,240# rock salt									

Min Gas Allowable (165:10-17-7) Gas Purchaser/Measurer SemGas
 OR
 Oil Allowable (165:10-13-3) First Sales Date 09/23/2017

INITIAL TEST DATA	
INITIAL TEST DATE	06/29/2017
OIL-BBL/DAY	230
OIL-GRAVITY (API)	33
GAS-MCF/DAY	1,161
GAS-OIL RATIO CU FT/BBL	5,047
WATER-BBL/DAY	3,382
PUMPING OR FLOWING	Pumping
INITIAL SHUT-IN PRESSURE	99
CHOKE SIZE	64/64
FLOW TUBING PRESSURE	215

AS SUBMITTED

A record of the formations drilled through, and pertinent remarks are presented on the reverse. I declare that I have knowledge of the contents of this report and am authorized by my organization to make this report, which was prepared by me or under my supervision and direction, with the data and facts stated herein to be true, correct, and complete to the best of my knowledge and belief.
 Signature: Chelce Rouse (handwritten) NAME (PRINT OR TYPE) Chelce Rouse DATE 06/21/2017 PHONE NUMBER 918-947-4647
 ADDRESS 321 South Boston, Suite 1000 CITY Tulsa, OK 74103 STATE OK ZIP 74103 EMAIL ADDRESS chelce.rouse@midstatespetroleum.com

PLEASE TYPE OR USE BLACK INK ONLY
FORMATION RECORD

Give formation names and tops, if available, or descriptions and thickness of formations drilled through. Show intervals cored or drillstem tested.

LEASE NAME Aruba 2412

WELL NO. 1H-15 C

NAMES OF FORMATIONS	TOP
ENDICOTT	4,698
TONKAWA	4,977
AVANT	5,370
COTTAGE GROVE	5,420
HOGSHOOTER	5,556
BIG LIME	5,790
OSWEGO	5,822
CHEROKEE	5,951
MISSISSIPPI LIME	6,300

FOR COMMISSION USE ONLY

ITD on file YES NO

APPROVED _____ DISAPPROVED _____

2) Reject Codes _____

Were open hole logs run? yes no

Date Last log was run N/A

Was CO₂ encountered? yes no at what depths? _____

Was H₂S encountered? yes no at what depths? _____

Were unusual drilling circumstances encountered? yes no
If yes, briefly explain below

Other remarks: _____

640 Acres

If more than three drainholes are proposed, attach a separate sheet indicating the necessary information.

Direction must be stated in degrees azimuth. Please note, the horizontal drainhole and its end point must be located within the boundaries of the lease or spacing unit.

Directional surveys are required for all drainholes and directional wells.

640 Acres

BOTTOM HOLE LOCATION FOR DIRECTIONAL HOLE

SEC	TWP	RGE	COUNTY
Spot Location			
1/4	1/4	1/4	1/4
Feet From 1/4 Sec Lines		FSL	FWL
Measured Total Depth		True Vertical Depth	
BHL From Lease, Unit, or Property Line:			

BOTTOM HOLE LOCATION FOR HORIZONTAL HOLE: (LATERALS)

LATERAL #1

SEC	TWP	RGE	COUNTY
15	24N	12W	Alfalfa
Spot Location			
SE 1/4 SW 1/4 SW	1/4	1/4	SE 1/4
Feet From 1/4 Sec Lines		FSL 462	FWL 2007E
Depth of Deviation 7001		Radius of Turn 1,266	Direction 179.8 180
Total Length 4,816			
Measured Total Depth 11,608'		True Vertical Depth 6,414'	
BHL From Lease, Unit, or Property Line: 462			

LATERAL #2

SEC	TWP	RGE	COUNTY
Spot Location			
1/4	1/4	1/4	1/4
Feet From 1/4 Sec Lines		FSL	FWL
Depth of Deviation		Radius of Turn	Direction
Total Length			
Measured Total Depth		True Vertical Depth	
BHL From Lease, Unit, or Property Line:			

LATERAL #3

SEC	TWP	RGE	COUNTY
Spot Location			
1/4	1/4	1/4	1/4
Feet From 1/4 Sec Lines		FSL	FWL
Depth of Deviation		Radius of Turn	Direction
Total Length			
Measured Total Depth		True Vertical Depth	
BHL From Lease, Unit, or Property Line:			