

Oklahoma Corporation Commission
 Oil & Gas Conservation Division
 Post Office Box 52000
 Oklahoma City, Oklahoma 73152-2000
 Rule 165: 10-3-25

Form 1002A

API No.: 35109212130002

Completion Report

Spud Date: October 26, 1985

OTC Prod. Unit No.: 109-88973

Drilling Finished Date: November 08, 1985

1st Prod Date: December 04, 1985

Amended

Completion Date: December 03, 1985

Amend Reason: RECOMPLETION

Recomplete Date: August 08, 2016

Drill Type: STRAIGHT HOLE

Min Gas Allowable: Yes

Well Name: HAMRICK 1-9

Purchaser/Measurer: DCP MIDSTREAM

Location: OKLAHOMA 9 13N 2W
 SW NE NE NW
 2145 FSL 2145 FWL of 1/4 SEC
 Derrick Elevation: 1094 Ground Elevation: 1085

First Sales Date: 08/10/2016

Operator: HOLLRAH EXPLORATION COMPANY 15764
 PO BOX 721174
 8104 NW 122ND ST
 OKLAHOMA CITY, OK 73172-1174

Completion Type	
X	Single Zone
	Multiple Zone
	Commingled

Location Exception	
Order No	
284422	

Increased Density	
Order No	
There are no Increased Density records to display.	

Casing and Cement							
Type	Size	Weight	Grade	Feet	PSI	SAX	Top of CMT
SURFACE	8 5/8	24	J-55	1010		700	SURFACE
PRODUCTION	4 1/2	10.5	J-55	6041		700	5000

Liner								
Type	Size	Weight	Grade	Length	PSI	SAX	Top Depth	Bottom Depth
There are no Liner records to display.								

Total Depth: 6041

Packer	
Depth	Brand & Type
There are no Packer records to display.	

Plug	
Depth	Plug Type
5740	CIBP
5850	CIBP

Initial Test Data

Test Date	Formation	Oil BBL/Day	Oil-Gravity (API)	Gas MCF/Day	Gas-Oil Ratio Cu FT/BBL	Water BBL/Day	Pumpin or Flowing	Initial Shut-In Pressure	Choke Size	Flow Tubing Pressure
Aug 14, 2016	OSWEGO	1	40	8		2	PUMPING	575		

Completion and Test Data by Producing Formation

Formation Name: OSWEGO

Code: 404OSWG

Class: OIL

Spacing Orders

Order No	Unit Size
106744	80

Perforated Intervals

From	To
5684	5706

Acid Volumes

2,500 GALLONS 15% HCL

Fracture Treatments

There are no Fracture Treatments records to display.

Formation	Top
SEE ORIGINAL 1002A	0

Were open hole logs run? No

Date last log run:

Were unusual drilling circumstances encountered? No

Explanation:

Other Remarks

There are no Other Remarks.

FOR COMMISSION USE ONLY

Status: Accepted

1137045

109-21213-02

API NO. 4092421
OTC PROD. UNIT NO. 10988973

PLEASE TYPE OR USE BLACK INK ONLY
NOTE:

Attach copy of original 1002A if recompletion or reentry.

OKLAHOMA CORPORATION COMMISSION
Oil & Gas Conservation Division
Post Office Box 52000
Oklahoma City, Oklahoma 73152-2000
Rule 165:10-3-25

RECEIVED

Form 1002A
Rev. 2009

JUN 21 2017

OKLAHOMA CORPORATION COMMISSION

ORIGINAL
 AMENDED (Reason)

RECOMPLETION

COMPLETION REPORT

TYPE OF DRILLING OPERATION

STRAIGHT HOLE DIRECTIONAL HOLE HORIZONTAL HOLE
 SERVICE WELL

If directional or horizontal, see reverse for bottom hole location.

COUNTY OKLAHOMA SEC 9 TWP 13N RGE 2W
LEASE NAME HAMRICK WELL NO. 1-9
SW 1/4 NE 1/4 NE 1/4 NW 1/4 FSL OF 1/4 SEC 2145 FWL OF 1/4 SEC 2145
ELEVATION Derrick FL 1094 Ground 1085
OPERATOR NAME HOLLRAH EXPLORATION COMPANY OTC/OCC OPERATOR NO. 15764
ADDRESS PO BOX 721174
CITY OKLAHOMA CITY STATE OKLAHOMA ZIP 73172

SPUD DATE 10/26/1985
DRLG FINISHED DATE 11/08/1985
DATE OF WELL COMPLETION 12/03/1985
1st PROD DATE 12/04/1985
RECOMP DATE 08/08/2016
Longitude (if known)

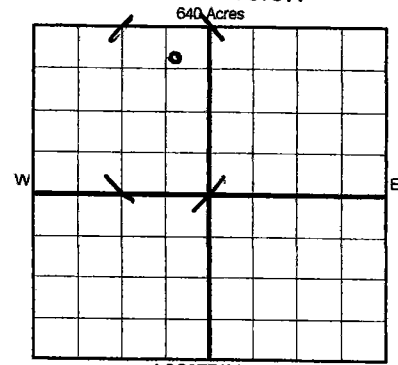

COMPLETION TYPE

SINGLE ZONE
 MULTIPLE ZONE
Application Date COMMINGLED
Application Date
LOCATION EXCEPTION ORDER NO. 284422
INCREASED DENSITY ORDER NO.

CASING & CEMENT (Form 1002C must be attached)

TYPE	SIZE	WEIGHT	GRADE	FEET	PSI	SAX	TOP OF CMT
CONDUCTOR							
SURFACE	8 5/8	24#	J-55	1010		700	SURF
INTERMEDIATE							
PRODUCTION	4 1/2	10.5#	J-55	6041		700	5000'
LINER							

PACKER @ _____ BRAND & TYPE _____ PLUG @ 5740' TYPE CIBP PLUG @ _____ TYPE _____
PACKER @ _____ BRAND & TYPE _____ PLUG @ 5850' TYPE CFBP PLUG @ _____ TYPE _____

TOTAL DEPTH 6041'

COMPLETION & TEST DATA BY PRODUCING FORMATION 4040SWG

FORMATION	OSWEGO							
SPACING & SPACING ORDER NUMBER	18Q/106744 (80)							No Frac
CLASS: Oil, Gas, Dry, Inj, Disp, Comm Disp, Svc	OIL							
PERFORATED INTERVALS	5684-5706'							
ACID/VOLUME	15% HCl 2500 GALS							
FRACTURE TREATMENT (Fluids/Prop Amounts)	NONE							

Min Gas Allowable (165:10-17-7) OR Gas Purchaser/Measurer DCP MIDSTREAM
Oil Allowable (165:10-13-3) First Sales Date 8/10/2016

INITIAL TEST DATA

INITIAL TEST DATE	8/14/2016							
OIL-BBL/DAY	1							
OIL-GRAVITY (API)	40							
GAS-MCF/DAY	8							
GAS-OIL RATIO CU FT/BBL								
WATER-BBL/DAY	2							
PUMPING OR FLOWING	PUMPING							
INITIAL SHUT-IN PRESSURE	575#							
CHOKE SIZE								
FLOW TUBING PRESSURE								

AS SUBMITTED

A record of the formations drilled through, and pertinent remarks are presented on the reverse. I declare that I have knowledge of the contents of this report and am authorized by my organization to make this report, which was prepared by me or under my supervision and direction, with the data and facts stated herein to be true, correct, and complete to the best of my knowledge and belief.

Terry L. Hollrah
SIGNATURE TERRY L. HOLLRAH 6/21/2016 405-773-5440
PO BOX 721174 OKLAHOMA CITY OK 73172 DATE PHONE NUMBER
ADDRESS CITY STATE ZIP HOLLEXCO@SBCGLOBAL.NET
EMAIL ADDRESS

PLEASE TYPE OR USE BLACK INK ONLY
FORMATION RECORD

Give formation names and tops, if available, or descriptions and thickness of formations drilled through. Show intervals cored or drillstem tested.

LEASE NAME _____ WELL NO. _____

NAMES OF FORMATIONS	TOP
SEE ORIGINAL 1002A	

FOR COMMISSION USE ONLY

ITD on file YES NO

APPROVED _____ DISAPPROVED _____

2) Reject Codes _____

Were open hole logs run? _____ yes _____ no

Date Last log was run _____

Was CO₂ encountered? _____ yes _____ no at what depths? _____

Was H₂S encountered? _____ yes _____ no at what depths? _____

Were unusual drilling circumstances encountered? _____ yes _____ no
if yes, briefly explain below: _____

Other remarks: _____

640 Acres

If more than three drainholes are proposed, attach a separate sheet indicating the necessary information.

Direction must be stated in degrees azimuth. Please note, the horizontal drainhole and its end point must be located within the boundaries of the lease or spacing unit.

Directional surveys are required for all drainholes and directional wells.

640 Acres

BOTTOM HOLE LOCATION FOR DIRECTIONAL HOLE

SEC	TWP	RGE	COUNTY
Spot Location			
1/4	1/4	1/4	1/4
Measured Total Depth		True Vertical Depth	Feet From 1/4 Sec Lines FSL FWL
BHL From Lease, Unit, or Property Line:			

BOTTOM HOLE LOCATION FOR HORIZONTAL HOLE: (LATERALS)

LATERAL #1

SEC	TWP	RGE	COUNTY
Spot Location			
1/4	1/4	1/4	1/4
Depth of Deviation		Radius of Turn	Direction
Measured Total Depth		True Vertical Depth	Total Length
BHL From Lease, Unit, or Property Line:			

LATERAL #2

SEC	TWP	RGE	COUNTY
Spot Location			
1/4	1/4	1/4	1/4
Depth of Deviation		Radius of Turn	Direction
Measured Total Depth		True Vertical Depth	Total Length
BHL From Lease, Unit, or Property Line:			

LATERAL #3

SEC	TWP	RGE	COUNTY
Spot Location			
1/4	1/4	1/4	1/4
Depth of Deviation		Radius of Turn	Direction
Measured Total Depth		True Vertical Depth	Total Length
BHL From Lease, Unit, or Property Line:			