

Oklahoma Corporation Commission
Oil & Gas Conservation Division
Post Office Box 52000
Oklahoma City, Oklahoma 73152-2000
Rule 165: 10-3-25

Form 1002A

API No.: 35111274960001

Completion Report

Spud Date: November 14, 2015

OTC Prod. Unit No.:

Drilling Finished Date: June 16, 2016

1st Prod Date:

Completion Date: July 26, 2016

Drill Type: STRAIGHT HOLE

Well Name: BARBRA J 18-5A

Purchaser/Measurer:

Location: OKMULGEE 18 13N 15E
C SE SW NW
330 FSL 990 FWL of 1/4 SEC
Derrick Elevation: 0 Ground Elevation: 719

First Sales Date:

Operator: J & J PRODUCTION COMPANY LLC 4183
PO BOX 561
376060 E 1130 RD
OKEMAH, OK 74859-0561

| Completion Type | |
|-----------------|---------------|
| X | Single Zone |
| | Multiple Zone |
| | Commingled |

| Location Exception |
|---|
| Order No |
| There are no Location Exception records to display. |

| Increased Density |
|--|
| Order No |
| There are no Increased Density records to display. |

| Casing and Cement | | | | | | | |
|-------------------|-------|--------|-------|------|-----|-----|------------|
| Type | Size | Weight | Grade | Feet | PSI | SAX | Top of CMT |
| SURFACE | 7 | | | 124 | | 40 | SURFACE |
| PRODUCTION | 4 1/2 | | | 2442 | | 75 | 1500 |

| Liner | | | | | | | | |
|--|------|--------|-------|--------|-----|-----|-----------|--------------|
| Type | Size | Weight | Grade | Length | PSI | SAX | Top Depth | Bottom Depth |
| There are no Liner records to display. | | | | | | | | |

Total Depth: 3240

| Packer | |
|---|--------------|
| Depth | Brand & Type |
| There are no Packer records to display. | |

| Plug | |
|-------|-----------|
| Depth | Plug Type |
| 1900 | CIBP |

| Initial Test Data | | | | | | | | | | |
|-------------------|--------------|-------------|-------------------|-------------|-------------------------|---------------|-------------------|--------------------------|------------|----------------------|
| Test Date | Formation | Oil BBL/Day | Oil-Gravity (API) | Gas MCF/Day | Gas-Oil Ratio Cu FT/BBL | Water BBL/Day | Pumpin or Flowing | Initial Shut-In Pressure | Choke Size | Flow Tubing Pressure |
| Jul 21, 2016 | GILCREASE | | | | | 15 | | | | |
| Jul 26, 2016 | BARTLESVILLE | | | | | 20 | | | | |

Completion and Test Data by Producing Formation

Formation Name: GILCREASE

Code: 403GLCR

Class: DRY

Spacing Orders

| Order No | Unit Size |
|--|-----------|
| There are no Spacing Order records to display. | |

Perforated Intervals

| From | To |
|------|------|
| 1942 | 1946 |

Acid Volumes

| |
|-------------|
| 350 GALLONS |
|-------------|

Fracture Treatments

| |
|--|
| There are no Fracture Treatments records to display. |
|--|

Formation Name: BARTLESVILLE

Code: 404BRVL

Class: DRY

Spacing Orders

| Order No | Unit Size |
|--|-----------|
| There are no Spacing Order records to display. | |

Perforated Intervals

| From | To |
|------|-----|
| 790 | 794 |

Acid Volumes

| |
|-------------|
| 250 GALLONS |
|-------------|

Fracture Treatments

| |
|--|
| There are no Fracture Treatments records to display. |
|--|

| Formation | Top |
|--------------|------|
| BARTLESVILLE | 790 |
| GILCREASE | 1942 |

Were open hole logs run? Yes
Date last log run: June 16, 2016

Were unusual drilling circumstances encountered? No
Explanation:

Other Remarks

WELL WILL BE USED FOR DISPOSAL OF PRODUCED WATER.

FOR COMMISSION USE ONLY

1137033

Status: Accepted

RECEIVED

Form 1002A Rev. 2009

JUN 28 2017

OKLAHOMA CORPORATION COMMISSION

APT NO 111 27496
OTC PROD UNIT NO.

PLEASE TYPE OR USE BLACK INK ONLY
NOTE:

Attach copy of original 1002A if recompletion or reentry.

OKLAHOMA CORPORATION COMMISSION
Oil & Gas Conservation Division
Post Office Box 52000
Oklahoma City, Oklahoma 73152-2000
Rule 165:10-3-25

COMPLETION REPORT

ORIGINAL AMENDED (Reason)

TYPE OF DRILLING OPERATION

STRAIGHT HOLE DIRECTIONAL HOLE HORIZONTAL HOLE
SERVICE WELL

If directional or horizontal, see reverse for bottom hole location.

COUNTY Okmulgee SEC 18 TWP 13N RGE 15E
LEASE NAME Barbara J WELL NO. 18-5A
C 1/4 SE 1/4 SW 1/4 NW 1/4 FSL OF 1/4 SEC 330 FWL OF 1/4 SEC 990
ELEVATION Derrck FL Ground 719 Latitude (if known) Longitude (if known)

SPUD DATE 11-14-15
DRLG FINISHED DATE 6-16-16
DATE OF WELL COMPLETION 7-26-2016
1st PROD DATE
RECOMP DATE

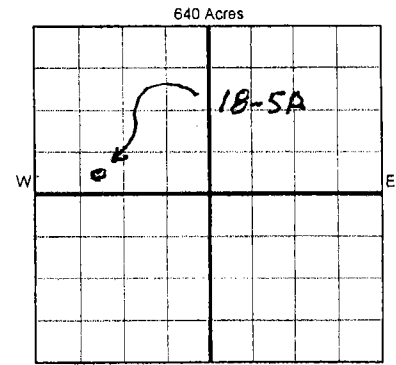

OPERATOR NAME JIJ Production Co. OTC/OCC OPERATOR NO. 04183
ADDRESS Box 561
CITY Okemah STATE Okla ZIP 74859

COMPLETION TYPE

SINGLE ZONE
MULTIPLE ZONE
Application Date
COMMINGLED
Application Date
LOCATION
EXCEPTION ORDER
INCREASED DENSITY
ORDER NO.

CASING & CEMENT (Form 1002C must be attached)

| TYPE | SIZE | WEIGHT | GRADE | FEET | PSI | SAX | TOP OF CMT |
|--------------|--------|--------|-------|------|-----|-----|------------|
| CONDUCTOR | | | | | | | |
| SURFACE | 7" | | | 124' | | 40 | Surface |
| INTERMEDIATE | | | | | | | |
| PRODUCTION | 4 1/2" | | | 2442 | | 75 | 1500 |
| LINER | | | | | | | |

PACKER @ BRAND & TYPE STBP-7 PLUG @ 1900 TYPE CFBP PLUG @ TYPE TOTAL DEPTH 3240
PACKER @ BRAND & TYPE PLUG @ TYPE PLUG @ TYPE

COMPLETION & TEST DATA BY PRODUCING FORMATION 4036LGR-16 404BRVL

| FORMATION | SPACING & SPACING ORDER NUMBER | CLASS: Oil, Gas, Dry, Inj, Disp, Comm Disp, Svc | PERFORATED INTERVALS | ACID/VOLUME | FRACTURE TREATMENT (Fluids/Prop Amounts) |
|--------------|--------------------------------|---|----------------------|-------------|--|
| Gilcrease | | Dry | 1942'-1946' | 350 gals | |
| Bartlesville | | Dry | 790'-794' | 250 gals | |

Min Gas Allowable (165:10-17-7) OR Oil Allowable (165:10-13-3) Gas Purchaser/Measurer First Sales Date

INITIAL TEST DATA

| INITIAL TEST DATE | OIL-BBL/DAY | OIL-GRAVITY (API) | GAS-MCF/DAY | GAS-OIL RATIO CU FT/BBL | WATER-BBL/DAY | PUMPING OR FLOWING | INITIAL SHUT-IN PRESSURE | CHOKE SIZE | FLOW TUBING PRESSURE |
|-------------------|-------------|-------------------|-------------|-------------------------|---------------|--------------------|--------------------------|------------|----------------------|
| 7-21-16 | none | | 3112 bbl | | Est 15 BW | | 0 | | |
| 7-26-16 | none | | none | | Est 30 BW | (See Note) | | | |

AS SUBMITTED

A record of the formations drilled through, and pertinent remarks are presented on the reverse. I declare that I have knowledge of the contents of this report and am authorized by my organization to make this report, which was prepared by me or under my supervision and direction, with the data and facts stated herein to be true, correct, and complete to the best of my knowledge and belief.
Signature: Edward D. Minihan NAME (PRINT OR TYPE) Edward D. Minihan DATE 6-24-17 PHONE NUMBER 817 235-4711
Address: 501 Havenwood Ln Danville, TX 76112 EMAIL ADDRESS eminihan@gmail.com

PLEASE TYPE OR USE BLACK INK ONLY

FORMATION RECORD

Give formation names and tops, if available, or descriptions and thickness of formations drilled through. Show intervals cored or drillstem tested.

LEASE NAME _____

WELL NO. _____

| NAMES OF FORMATIONS | TOP |
|---------------------|------|
| Bartlesville | 790 |
| Gilcrease | 1942 |

FOR COMMISSION USE ONLY

ITD on file YES NO

APPROVED _____ DISAPPROVED _____

2) Reject Codes _____

Were open hole logs run? yes no

Date Last log was run 6-16-2016

Was CO₂ encountered? yes no at what depths? _____

Was H₂S encountered? yes no at what depths? _____

Were unusual drilling circumstances encountered? yes no
If yes, briefly explain below _____

Other remarks: Well will be used for disposal of produced water

640 Acres

| | | | | | | | | | |
|--|--|--|--|--|--|--|--|--|--|
| | | | | | | | | | |
| | | | | | | | | | |
| | | | | | | | | | |
| | | | | | | | | | |
| | | | | | | | | | |
| | | | | | | | | | |
| | | | | | | | | | |
| | | | | | | | | | |
| | | | | | | | | | |
| | | | | | | | | | |

If more than three drainholes are proposed, attach a separate sheet indicating the necessary information.

Direction must be stated in degrees azimuth.
Please note, the horizontal drainhole and its end point must be located within the boundaries of the lease or spacing unit.

Directional surveys are required for all drainholes and directional wells.

640 Acres

| | | | | | | | | | |
|--|--|--|--|--|--|--|--|--|--|
| | | | | | | | | | |
| | | | | | | | | | |
| | | | | | | | | | |
| | | | | | | | | | |
| | | | | | | | | | |
| | | | | | | | | | |
| | | | | | | | | | |
| | | | | | | | | | |
| | | | | | | | | | |
| | | | | | | | | | |

BOTTOM HOLE LOCATION FOR DIRECTIONAL HOLE

| SEC | TWP | RGE | COUNTY | Spot Location | Feet From 1/4 Sec Lines | FSL | FWL |
|----------------------|-----|---------------------|--------|---|-------------------------|-----|-----|
| | | | | 1/4 | 1/4 | 1/4 | 1/4 |
| Measured Total Depth | | True Vertical Depth | | BHL From Lease, Unit, or Property Line: | | | |

BOTTOM HOLE LOCATION FOR HORIZONTAL HOLE: (LATERALS)

LATERAL #1

| SEC | TWP | RGE | COUNTY | Spot Location | Feet From 1/4 Sec Lines | FSL | FWL |
|----------------------|-----|---------------------|--------|---|-------------------------|--------------|-----|
| | | | | 1/4 | 1/4 | 1/4 | 1/4 |
| Depth of Deviation | | Radius of Turn | | Direction | | Total Length | |
| Measured Total Depth | | True Vertical Depth | | BHL From Lease, Unit, or Property Line: | | | |

LATERAL #2

| SEC | TWP | RGE | COUNTY | Spot Location | Feet From 1/4 Sec Lines | FSL | FWL |
|----------------------|-----|---------------------|--------|---|-------------------------|--------------|-----|
| | | | | 1/4 | 1/4 | 1/4 | 1/4 |
| Depth of Deviation | | Radius of Turn | | Direction | | Total Length | |
| Measured Total Depth | | True Vertical Depth | | BHL From Lease, Unit, or Property Line: | | | |

LATERAL #3

| SEC | TWP | RGE | COUNTY | Spot Location | Feet From 1/4 Sec Lines | FSL | FWL |
|----------------------|-----|---------------------|--------|---|-------------------------|--------------|-----|
| | | | | 1/4 | 1/4 | 1/4 | 1/4 |
| Depth of Deviation | | Radius of Turn | | Direction | | Total Length | |
| Measured Total Depth | | True Vertical Depth | | BHL From Lease, Unit, or Property Line: | | | |