

Oklahoma Corporation Commission
 Oil & Gas Conservation Division
 Post Office Box 52000
 Oklahoma City, Oklahoma 73152-2000
 Rule 165: 10-3-25

Form 1002A

API No.: 35153235850000

Completion Report

Spud Date: October 05, 2016

OTC Prod. Unit No.: 153-218572

Drilling Finished Date: November 11, 2016

1st Prod Date: February 17, 2017

Completion Date: February 11, 2017

Drill Type: HORIZONTAL HOLE

Well Name: MOSS 30 1H

Purchaser/Measurer: RED CLIFF MIDSTREAM

Location: WOODWARD 31 20N 18W
 SE NW NE NW
 2240 FSL 1772 FWL of 1/4 SEC
 Derrick Elevation: 1914 Ground Elevation: 1896

First Sales Date: 02/19/2017

Operator: CORLENA OIL COMPANY 23706

619 S TYLER ST STE 210
 AMARILLO, TX 79101-2303

Completion Type	
X	Single Zone
	Multiple Zone
	Commingled

Location Exception
Order No
662705

Increased Density
Order No
There are no Increased Density records to display.

Casing and Cement							
Type	Size	Weight	Grade	Feet	PSI	SAX	Top of CMT
CONDUCTOR	20	94	H-40	90			SURFACE
SURFACE	9 5/8	36	J-55	1472	550	699	SURFACE
INTERMEDIATE	7	26	P-110	10715	2950	683	5888
PRODUCTION	5 1/2 / 4 1/2	20 / 13.5	P-110	15698	1111	531	10012

Liner								
Type	Size	Weight	Grade	Length	PSI	SAX	Top Depth	Bottom Depth
There are no Liner records to display.								

Total Depth: 15700

Packer	
Depth	Brand & Type
10012	BAKER S-3 HYD

Plug	
Depth	Plug Type
There are no Plug records to display.	

Initial Test Data

Test Date	Formation	Oil BBL/Day	Oil-Gravity (API)	Gas MCF/Day	Gas-Oil Ratio Cu FT/BBL	Water BBL/Day	Pumpin or Flowing	Initial Shut-In Pressure	Choke Size	Flow Tubing Pressure
Apr 30, 2017	MISSISSIPPIAN	75	49	5158	68773	1526	FLOWING	950	61/64	950

Completion and Test Data by Producing Formation

Formation Name: MISSISSIPPIAN

Code: 359MSSP

Class: GAS

Spacing Orders

Order No	Unit Size
650484	640

Perforated Intervals

From	To
10881	15588

Acid Volumes

1,355 BARRELS 15% HCL

Fracture Treatments

5MM POUNDS SAND, 216,000 BARRELS HYBRID

Formation	Top
LOWER MORROW	9104
MISSISSIPPIAN LIME	9978
ST GENEVIEVE	10430

Were open hole logs run? Yes

Date last log run: November 09, 2016

Were unusual drilling circumstances encountered? No

Explanation:

Other Remarks

THE 5 1/2" CASING IS A TIE-BACK STRING INTO THE 4 1/2" LINER AT 10012'.

Lateral Holes

Sec: 30 TWP: 20N RGE: 18W County: WOODWARD

NE NW NE NW

275 FNL 1984 FWL of 1/4 SEC

Depth of Deviation: 10025 Radius of Turn: 573 Direction: 3 Total Length: 5385

Measured Total Depth: 15700 True Vertical Depth: 10552 End Pt. Location From Release, Unit or Property Line: 275

FOR COMMISSION USE ONLY

1136764

Status: Accepted

API NO. 153-23585
 OTC PROD. UNIT NO. 153218572

PLEASE TYPE OR USE BLACK INK ONLY
 NOTE:

Attach copy of original 1002A if recompletion or reentry.

OKLAHOMA CORPORATION COMMISSION
 Oil & Gas Conservation Division
 Post Office Box 52000
 Oklahoma City, Oklahoma 73152-2000
 Rule 165:10-3-25

RECEIVED Form 1002A Rev. 2009

MAY 15 2017

OKLAHOMA CORPORATION COMMISSION

ORIGINAL
 AMENDED (Reason)

COMPLETION REPORT

TYPE OF DRILLING OPERATION
 STRAIGHT HOLE DIRECTIONAL HOLE HORIZONTAL HOLE
 SERVICE WELL

SPUD DATE 10/5/2016
 DRLG FINISHED DATE 11/11/2016

If directional or horizontal, see reverse for bottom hole location.

COUNTY Woodward SEC 31 TWP 20N RGE 18W

DATE OF WELL COMPLETION 2/11/2017

LEASE NAME Moss 30 WELL NO. 1H

1st PROD DATE 2/17/2017

SE 1/4 NW 1/4 NE 1/4 NW 1/4 FSL OF 1/4 SEC 2240' FWL OF 1/4 SEC 1772'

RECOMP DATE

ELEVATION Derrick FL 1914 Ground 1896 Latitude (if known) 36.17231N

Longitude (if known) -99.16205W

OPERATOR NAME Corlena Oil Company

OTC/OCC OPERATOR NO. 23706

ADDRESS 619 S Tyler St, Ste 210

CITY Amarillo STATE TX ZIP 79101-2303

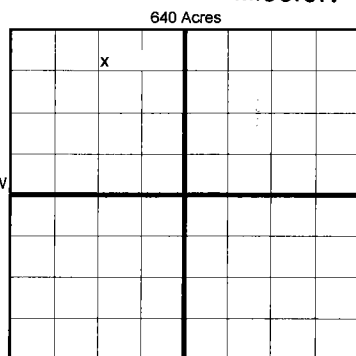

LOCATE WELL

COMPLETION TYPE

SINGLE ZONE
 MULTIPLE ZONE
 Application Date
 COMMINGLED
 Application Date
 LOCATION
 EXCEPTION ORDER INCREASED DENSITY ORDER NO. n/a

CASING & CEMENT (Form 1002C must be attached)

TYPE	SIZE	WEIGHT	GRADE	FEET	PSI	SAX	TOP OF CMT	
CONDUCTOR	20	94	H-40	90			Surface	
SURFACE	9-5/8"	36	J-55	1472	550	699	Surface	
INTERMEDIATE	7"	26	P-110	10,715	2950	683	5888'	
PRODUCTION	5-1/2"	20	P-110	10012'			Tieback	
LINER	4-1/2"	13.5	P-110	10012' - 15698'	1111	531	10012'	
							TOTAL DEPTH	15700'

PACKER @ 10012' BRAND & TYPE Baker S-3 Hyc PLUG @ TYPE PLUG @ TYPE
 PACKER @ BRAND & TYPE PLUG @ TYPE PLUG @ TYPE

COMPLETION & TEST DATA BY PRODUCING FORMATION 359MSSP

FORMATION	Mississippian							
SPACING & SPACING ORDER NUMBER	640 / 650484							
CLASS: Oil, Gas, Dry, Inj, Disp, Comm Disp, Svc	Gas							
PERFORATED INTERVALS	15600' - 10881' 15588							
ACID/VOLUME	15% HCl / 1355 BBL							
FRACTURE TREATMENT (Fluids/Prop Amounts)	5MM# Sand 216k BBL Hybrid							

Reported to Frac Focus

Min Gas Allowable (165:10-17-7)

Gas Purchaser/Measurer Red Cliff Midstream
 First Sales Date 2/19/2017

INITIAL TEST DATA

Oil Allowable (165:10-13-3)

INITIAL TEST DATE	4/30/2017			
OIL-BBL/DAY	75			
OIL-GRAVITY (API)	49			
GAS-MCF/DAY	5158			
GAS-OIL RATIO CU FT/BBL	68773			
WATER-BBL/DAY	1526			
PUMPING OR FLOWING	Flowing			
INITIAL SHUT-IN PRESSURE	950			
CHOKE SIZE	61/64			
FLOW TUBING PRESSURE	950			

AS SUBMITTED

A record of the formations drilled through, and pertinent remarks are presented on the reverse. I declare that I have knowledge of the contents of this report and am authorized by my organization to make this report, which was prepared by me or under my supervision and direction, with the data and facts stated herein to be true, correct, and complete to the best of my knowledge and belief.

J. Frederick
 SIGNATURE NAME (PRINT OR TYPE) DATE 5/8/2017 PHONE NUMBER 806-323-9811
 PO Box 188 Canadian TX 79014 frederick@hadeng.com
 ADDRESS CITY STATE ZIP EMAIL ADDRESS

PLEASE TYPE OR USE BLACK INK ONLY
FORMATION RECORD

Give formation names and tops, if available, or descriptions and thickness of formations drilled through. Show intervals cored or drillstem tested.

LEASE NAME Moss 30 WELL NO. 1H

NAMES OF FORMATIONS	TOP
Lower Morrow	9104' TVD
Mississippian Lime	9978' TVD
St. Genevieve	10430' TVD 10480' MD

FOR COMMISSION USE ONLY

ITD on file YES NO

APPROVED _____ DISAPPROVED _____

2) Reject Codes

Were open hole logs run? yes no

Date Last log was run 11/9/2016

Was CO₂ encountered? yes no at what depths? _____

Was H₂S encountered? yes no at what depths? _____

Were unusual drilling circumstances encountered? yes no
If yes, briefly explain below

Other remarks: The 5-1/2" casing is a tie-back string into the 4-1/2" liner.

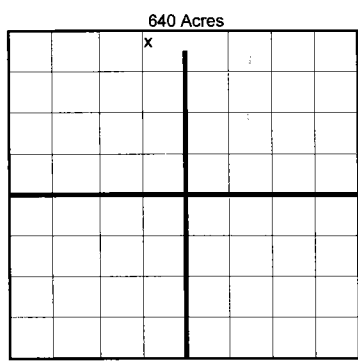

If more than three drainholes are proposed, attach a separate sheet indicating the necessary information.

Direction must be stated in degrees azimuth. Please note, the horizontal drainhole and its end point must be located within the boundaries of the lease or spacing unit.

Directional surveys are required for all drainholes and directional wells.

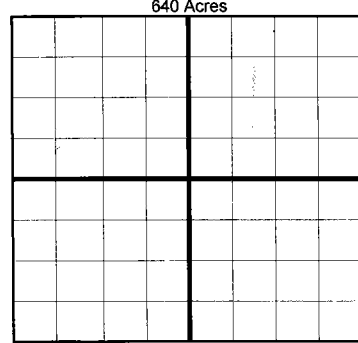

BOTTOM HOLE LOCATION FOR DIRECTIONAL HOLE

SEC	TWP	RGE	COUNTY				
Spot Location	1/4	1/4	1/4	1/4	Feet From 1/4 Sec Lines	FSL	FWL
Measured Total Depth	True Vertical Depth		BHL From Lease, Unit, or Property Line:				

BOTTOM HOLE LOCATION FOR HORIZONTAL HOLE: (LATERALS)

LATERAL #1

SEC	TWP	RGE	COUNTY				
30	20N	18W	Woodward				
Spot Location	N2 NE 1/4	N2 NE 1/4	NE 1/4 NW 1/4	Feet From 1/4 Sec Lines	275' FNL	FSL 2365'	FWL 1984'
Depth of Deviation	10025'	Radius of Turn	573'	Direction	3	Total Length	5385' Vsec
Measured Total Depth	15700'	True Vertical Depth	10552'	BHL From Lease, Unit, or Property Line: 275' FNL			

LATERAL #2

SEC	TWP	RGE	COUNTY				
Spot Location	1/4	1/4	1/4	1/4	Feet From 1/4 Sec Lines	FSL	FWL
Depth of Deviation	Radius of Turn		Direction		Total Length		
Measured Total Depth	True Vertical Depth		BHL From Lease, Unit, or Property Line:				

LATERAL #3

SEC	TWP	RGE	COUNTY				
Spot Location	1/4	1/4	1/4	1/4	Feet From 1/4 Sec Lines	FSL	FWL
Depth of Deviation	Radius of Turn		Direction		Total Length		
Measured Total Depth	True Vertical Depth		BHL From Lease, Unit, or Property Line:				

4/30/17

RECEIVED

Form 1002A Rev. 2009

MAY 15 2017

1016EZ

API NO. 153-23585
OTC PROD. UNIT NO. 153218572

PLEASE TYPE OR USE BLACK INK ONLY
NOTE:

Attach copy of original 1002A if recompletion or reentry.

OKLAHOMA CORPORATION COMMISSION
Oil & Gas Conservation Division
Post Office Box 52000
Oklahoma City, Oklahoma 73152-2000
Rule 165:10-3-25

ORIGINAL
 AMENDED (Reason)

A: 218572 F

COMPLETION REPORT

TYPE OF DRILLING OPERATION
 STRAIGHT HOLE DIRECTIONAL HOLE HORIZONTAL HOLE
 SERVICE WELL
If directional or horizontal, see reverse for bottom hole location

SPUD DATE 10/5/2016
DRLG FINISHED DATE 11/11/2016
DATE OF WELL COMPLETION 2/11/2017
1st PROD DATE 2/17/2017
RECOMP DATE
Longitude (if known) -99.16205W

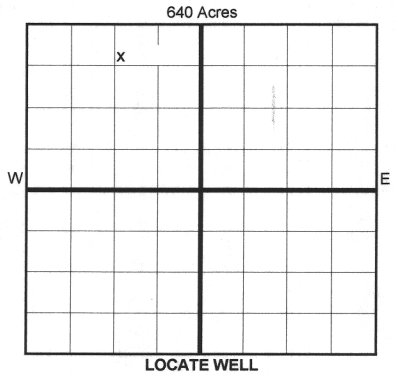

COUNTY Woodward SEC 31 TWP 20N RGE 18W
LEASE NAME Moss 30 WELL NO. 1H
SE 1/4 NW 1/4 NE 1/4 NW 1/4 FSL OF 1/4 SEC 2240' FWL OF 1/4 SEC 1772'
ELEVATION Derrick FL 1914 Ground 1896 Latitude (if known) 36.17231N
OPERATOR NAME Corlena Oil Company OTC/OCC OPERATOR NO. 23706
ADDRESS 619 S Tyler St, Ste 210
CITY Amarillo STATE TX ZIP 79101-2303

COMPLETION TYPE
 SINGLE ZONE
 MULTIPLE ZONE
Application Date COMMINGLED
Application Date
LOCATION
EXCEPTION ORDER 662705FD
INCREASED DENSITY 650976
ORDER NO. n/a

CASING & CEMENT (Form 1002C must be attached)

TYPE	SIZE	WEIGHT	GRADE	FEET	PSI	SAX	TOP OF CMT
CONDUCTOR	20	94	H-40	90			Surface
SURFACE	9-5/8"	36	J-55	1472	550	699	Surface
INTERMEDIATE	7"	26	P-110	10,715	2950	683	5888'
PRODUCTION	5-1/2"	20	P-110	10012'			Tieback
LINER	4-1/2"	13.5	P-110	10012' - 15698'	1111	531	10012'
							TOTAL DEPTH 15700'

PACKER @ 10012' BRAND & TYPE Baker S-3 Hyc PLUG @ TYPE PLUG @ TYPE
PACKER @ BRAND & TYPE PLUG @ TYPE PLUG @ TYPE

COMPLETION & TEST DATA BY PRODUCING FORMATION 359MSSP

FORMATION	SPACING & SPACING ORDER NUMBER	CLASS: Oil, Gas, Dry, Inj, Disp, Comm Disp, Svc	PERFORATED INTERVALS	ACID/VOLUME	FRACTURE TREATMENT (Fluids/Prop Amounts)
Mississippian	640 / 650484 H	Gas	15600' - 10881' 15588	15% HCl / 1355 BBL	5MM# Sand 216k BBL Hybrid

Reported to Frac Focus

Min Gas Allowable (165:10-17-7) OR Oil Allowable (165:10-13-3) Gas Purchaser/Measurer Red Cliff Midstream First Sales Date 2/19/2017

INITIAL TEST DATA

INITIAL TEST DATE	4/30/2017
OIL-BBL/DAY	75
OIL-GRAVITY (API)	49
GAS-MCF/DAY	5158
GAS-OIL RATIO CU FT/BBL	68773
WATER-BBL/DAY	1526
PUMPING OR FLOWING	Flowing
INITIAL SHUT-IN PRESSURE	950
CHOKE SIZE	61/64
FLOW TUBING PRESSURE	950

AS SUBMITTED

A record of the formations drilled through, and pertinent remarks are presented on the reverse. I declare that I have knowledge of the contents of this report and am authorized by my organization to make this report, which was prepared by me or under my supervision and direction, with the data and facts stated herein to be true, correct, and complete to the best of my knowledge and belief.

J. Frederick
SIGNATURE NAME (PRINT OR TYPE) 5/8/2017 806-323-9811
DATE PHONE NUMBER
PO Box 188 Canadian TX 79014
ADDRESS CITY STATE ZIP frederick@hadeng.com
EMAIL ADDRESS

SCANNED

Handwritten initials

Handwritten initials