

Oklahoma Corporation Commission
Oil & Gas Conservation Division
Post Office Box 52000
Oklahoma City, Oklahoma 73152-2000
Rule 165: 10-3-25

Form 1002A

API No.: 35153235880000

Completion Report

Spud Date: November 13, 2016

OTC Prod. Unit No.: 153-218571

Drilling Finished Date: December 25, 2016

1st Prod Date: March 17, 2017

Completion Date: February 18, 2017

Drill Type: HORIZONTAL HOLE

Min Gas Allowable: Yes

Well Name: FENTON 17-1H

Purchaser/Measurer: RED CLIFF MIDSTREAM

Location: WOODWARD 20 20N 17W
N2 N2 NE NW
2440 FSL 1980 FWL of 1/4 SEC
Derrick Elevation: 1815 Ground Elevation: 1797

First Sales Date: 03/22/2017

Operator: CORLENA OIL COMPANY 23706

619 S TYLER ST STE 210
AMARILLO, TX 79101-2303

Completion Type	
X	Single Zone
	Multiple Zone
	Commingled

Location Exception	
Order No	
662707	

Increased Density	
Order No	
There are no Increased Density records to display.	

Casing and Cement							
Type	Size	Weight	Grade	Feet	PSI	SAX	Top of CMT
CONDUCTOR	20	94	H-40	92			SURFACE
SURFACE	9 5/8	36	J-55	1470	525	596	SURFACE
INTERMEDIATE	7	26	P-110	9860	3200	523	4895
PRODUCTION	5 1/2 / 4 1/2	20 / 13.5	P-110	15388	1300	503	9750

Liner								
Type	Size	Weight	Grade	Length	PSI	SAX	Top Depth	Bottom Depth
There are no Liner records to display.								

Total Depth: 15400

Packer	
Depth	Brand & Type
9750	BAKER S-3 HYD

Plug	
Depth	Plug Type
There are no Plug records to display.	

Initial Test Data

Test Date	Formation	Oil BBL/Day	Oil-Gravity (API)	Gas MCF/Day	Gas-Oil Ratio Cu FT/BBL	Water BBL/Day	Pumpin or Flowing	Initial Shut-In Pressure	Choke Size	Flow Tubing Pressure
Apr 26, 2017	MISSISSIPPIAN	393	49	2189	5569	770	FLOWING	610	48/64	610

Completion and Test Data by Producing Formation

Formation Name: MISSISSIPPIAN

Code: 359MSSP

Class: OIL

Spacing Orders

Order No	Unit Size
654363	640

Perforated Intervals

From	To
10492	15272

Acid Volumes

1,731 BARRELS 15% HCL

Fracture Treatments

5.7MM POUNDS SAND, 211,000 BARRELS HYBRID

Formation	Top
MISSISSIPPIAN LIME	8450
ST GENEVIEVE	9580
ST LOUIS	9704
OSAGE	10282

Were open hole logs run? Yes

Date last log run: December 23, 2016

Were unusual drilling circumstances encountered? No

Explanation:

Other Remarks

THE 5 1/2" CASING IS A TIE-BACK STRING INTO THE 4 1/2" LINER AT 9750'

Lateral Holes

Sec: 17 TWP: 20N RGE: 17W County: WOODWARD

NW NE NE NW

241 FNL 2030 FWL of 1/4 SEC

Depth of Deviation: 9900 Radius of Turn: 573 Direction: 360 Total Length: 5241

Measured Total Depth: 15400 True Vertical Depth: 10417 End Pt. Location From Release, Unit or Property Line: 241

FOR COMMISSION USE ONLY

1136763

Status: Accepted

RECEIVED

MAY 15 2017

Form 1002A Rev. 2009

OKLAHOMA CORPORATION COMMISSION

OKLAHOMA CORPORATION COMMISSION
Oil & Gas Conservation Division
Post Office Box 52000
Oklahoma City, Oklahoma 73152-2000
Rule 165:10-3-25

API NO. 153-23588
OTC PROD. UNIT NO. 153218571

PLEASE TYPE OR USE BLACK INK ONLY
NOTE:

Attach copy of original 1002A if recompletion or reentry.

ORIGINAL
AMENDED (Reason)

COMPLETION REPORT

TYPE OF DRILLING OPERATION
STRAIGHT HOLE
DIRECTIONAL HOLE
HORIZONTAL HOLE

SPUD DATE 11/13/2016
DRLG FINISHED DATE 12/25/2016
DATE OF WELL COMPLETION 2/18/2017
1st PROD DATE 3/17/2017
RECOMP DATE
Longitude (if known) -99.03792W

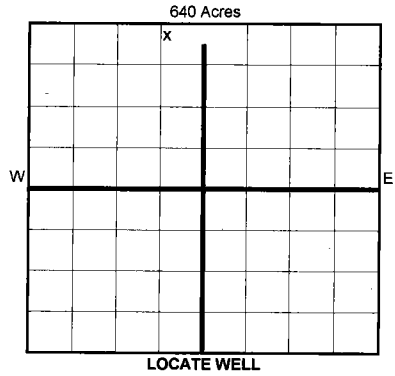

COUNTY Woodward SEC 20 TWP 20N RGE 17W
LEASE NAME Fenton WELL NO. 17-1H
N2 1/4 N2 1/4 NE 1/4 NW 1/4 FSL OF 2440' FWL OF 1980'
ELEVATION 1815 Ground 1797 Latitude (if known) 36.20171N
OPERATOR NAME Corlena Oil Company OTC/OCC OPERATOR NO. 23706
ADDRESS 619 S Tyler St, Ste 210
CITY Amarillo STATE TX ZIP 79101-2303

COMPLETION TYPE

SINGLE ZONE
MULTIPLE ZONE
Application Date COMMINGLED
Application Date 662707.F.V.
LOCATION 658253
EXCEPTION ORDER INCREASED DENSITY ORDER NO. n/a

CASING & CEMENT (Form 1002C must be attached)

Table with columns: TYPE, SIZE, WEIGHT, GRADE, FEET, PSI, SAX, TOP OF CMT. Rows include CONDUCTOR, SURFACE, INTERMEDIATE, PRODUCTION, LINER.

PACKER @ 9750' BRAND & TYPE Baker S-3 Hyc PLUG @ TYPE PLUG @ TYPE TOTAL DEPTH 15400'
PACKER @ BRAND & TYPE PLUG @ TYPE PLUG @ TYPE

COMPLETION & TEST DATA BY PRODUCING FORMATION 359MSSP

Table with columns: FORMATION, SPACING & SPACING ORDER NUMBER, CLASS, PERFORATED INTERVALS, ACID/VOLUME, FRACTURE TREATMENT. Includes handwritten note 'Reported to Flare Focus'.

Min Gas Allowable (165:10-17-7) OR Oil Allowable (165:10-13-3) Gas Purchaser/Measurer Red Cliff Midstream First Sales Date 3/22/2017

INITIAL TEST DATA

Table with columns: INITIAL TEST DATE, OIL-BBL/DAY, OIL-GRAVITY (API), GAS-MCF/DAY, GAS-OIL RATIO CU FT/BBL, WATER-BBL/DAY, PUMPING OR FLOWING, INITIAL SHUT-IN PRESSURE, CHOKE SIZE, FLOW TUBING PRESSURE.

AS SUBMITTED

A record of the formations drilled through, and pertinent remarks are presented on the reverse. I declare that I have knowledge of the contents of this report and am authorized by my organization to make this report, which was prepared by me or under my supervision and direction, with the data and facts stated herein to be true, correct, and complete to the best of my knowledge and belief.
Signature: J. Frederick
NAME (PRINT OR TYPE): J. Frederick
DATE: 5/8/2017
PHONE NUMBER: 806-323-9811
ADDRESS: PO Box 188, Canadian, TX 79014
EMAIL ADDRESS: frederick@hadeng.com

