

Oklahoma Corporation Commission
Oil & Gas Conservation Division
Post Office Box 52000
Oklahoma City, Oklahoma 73152-2000
Rule 165: 10-3-25

Form 1002A

API No.: 35073229680001

Completion Report

Spud Date: July 20, 1981

OTC Prod. Unit No.:

Drilling Finished Date: August 12, 1981

Amended

1st Prod Date: January 22, 1982

Amend Reason: RECOMPLETE TO COMMERCIAL DISPOSAL

Completion Date: January 15, 1982

Recomplete Date: April 14, 2017

Drill Type: STRAIGHT HOLE

SERVICE WELL

Well Name: MURRAY SWD (HILL 1) 1

Purchaser/Measurer:

Location: KINGFISHER 3 17N 9W
C SW SW
660 FSL 660 FWL of 1/4 SEC
Derrick Elevation: 0 Ground Elevation: 1134

First Sales Date:

Operator: ZEPHYR SWD LLC 22964

5225 N SHARTEL AVE STE 200
OKLAHOMA CITY, OK 73118-6035

Completion Type	
X	Single Zone
	Multiple Zone
	Commingled

Location Exception	
Order No	
There are no Location Exception records to display.	

Increased Density	
Order No	
There are no Increased Density records to display.	

Casing and Cement							
Type	Size	Weight	Grade	Feet	PSI	SAX	Top of CMT
SURFACE	8 5/8			605		325	SURFACE
PRODUCTION	5 1/2			9890		1480	4000

Liner								
Type	Size	Weight	Grade	Length	PSI	SAX	Top Depth	Bottom Depth
There are no Liner records to display.								

Total Depth: 9890

Packer	
Depth	Brand & Type
4288	AS1-X

Plug	
Depth	Plug Type
6000	CIBP

Initial Test Data

Test Date	Formation	Oil BBL/Day	Oil-Gravity (API)	Gas MCF/Day	Gas-Oil Ratio Cu FT/BBL	Water BBL/Day	Pumpin or Flowing	Initial Shut-In Pressure	Choke Size	Flow Tubing Pressure
-----------	-----------	-------------	-------------------	-------------	-------------------------	---------------	-------------------	--------------------------	------------	----------------------

There are no Initial Data records to display.

Completion and Test Data by Producing Formation

Formation Name: VIRGILIAN

Code: 406VRGN

Class: COMM DISP

Spacing Orders

Order No	Unit Size
There are no Spacing Order records to display.	

Perforated Intervals

From	To
4326	5590

Acid Volumes

There are no Acid Volume records to display.
--

Fracture Treatments

There are no Fracture Treatments records to display.
--

Formation	Top
------------------	------------

Were open hole logs run? No

Date last log run:

Were unusual drilling circumstances encountered? No

Explanation:

Other Remarks
UIC PERMIT NUMBER 1703870021

FOR COMMISSION USE ONLY

Status: Accepted	1136735
------------------	---------

RUB VED

API NO. 073-22968
OTC PROD. UNIT NO.

PLEASE TYPE OR USE BLACK INK ONLY
NOTE:

Attach copy of original 1002A if recompletion or reentry.

OKLAHOMA CORPORATION COMMISSION
Oil & Gas Conservation Division
Post Office Box 52000
Oklahoma City, Oklahoma 73152-2000
Rule 165:10-3-25

MAY 11 2017

OKLAHOMA CORPORATION COMMISSION

ORIGINAL
 AMENDED (Reason)

Recomplete Commercial Disposal

COMPLETION REPORT

TYPE OF DRILLING OPERATION
 STRAIGHT HOLE DIRECTIONAL HOLE HORIZONTAL HOLE
 SERVICE WELL

SPUD DATE 07/20/1981
DRLG FINISHED DATE 08/12/1981
DATE OF WELL COMPLETION 01/15/1982
1st PROD DATE 01/22/1982
RECOMP DATE 04/14/2017
Longitude (if known)

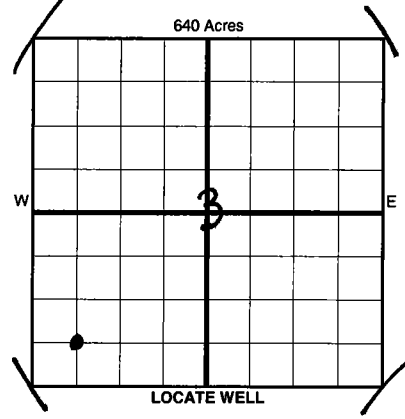

COUNTY Kingfisher SEC 3 TWP 17N RGE 9W
LEASE NAME Murray SWD
WELL NO. 1
1/4 C 1/4 SW 1/4 SW 1/4 FSL OF 1/4 SEC 660' FWL OF 1/4 SEC 660'
ELEVATION Derrick FL Ground 1134
OPERATOR NAME Zephyr SWD, LLC OTC/OCC OPERATOR NO. 22964
ADDRESS 5225 N. Shartel Avenue, Suite 200
CITY Oklahoma City STATE OK ZIP 73118

COMPLETION TYPE
 SINGLE ZONE
 MULTIPLE ZONE
 COMMINGLED
LOCATION EXCEPTION ORDER INCREASED DENSITY ORDER NO.

CASING & CEMENT (Form 1002C must be attached)

TYPE	SIZE	WEIGHT	GRADE	FEET	PSI	SAX	TOP OF CMT
CONDUCTOR							
SURFACE	8 5/8"			605'		325	surf
INTERMEDIATE							
PRODUCTION	5 1/2"			9,890'		1,480	4,000'
LINER							

PACKER @ 4,288' BRAND & TYPE AS1-X PLUG @ 6,000' TYPE CIBP PLUG @ TYPE TOTAL DEPTH 9,890'

COMPLETION & TEST DATA BY PRODUCING FORMATION *406 URGN*

FORMATION	SPACING & SPACING ORDER NUMBER	CLASS: Oil, Gas, Dry, Inj, Disp, Comm Disp, Svc	PERFORATED INTERVALS	ACID/VOLUME	FRACTURE TREATMENT (Fluids/Prop Amounts)
Virgilian		Comm Disp	4,326' -5,590'	none	none

Per Operator

Min Gas Allowable (165:10-17-7) OR Oil Allowable (165:10-13-3)
Gas Purchaser/Measurer First Sales Date

INITIAL TEST DATA

INITIAL TEST DATE	NA				
OIL-BBL/DAY					
OIL-GRAVITY (API)					
GAS-MCF/DAY					
GAS-OIL RATIO CU FT/BBL					
WATER-BBL/DAY					
PUMPING OR FLOWING					
INITIAL SHUT-IN PRESSURE					
CHOKE SIZE					
FLOW TUBING PRESSURE					

AS SUBMITTED

A record of the formations drilled through, and pertinent remarks are presented on the reverse. I declare that I have knowledge of the contents of this report and am authorized by my organization to make this report, which was prepared by me or under my supervision and direction, with the data and facts stated herein to be true, correct, and complete to the best of my knowledge and belief.

Kellee L. Hall Kellee L. Hall 5/10/2017 405.286.4771
SIGNATURE NAME (PRINT OR TYPE) DATE PHONE NUMBER
5225 N. Shartel Ave., Ste. 200 Oklahoma City OK 73118
ADDRESS CITY STATE ZIP
khall@zephyrokc.com
EMAIL ADDRESS

