

Oklahoma Corporation Commission
 Oil & Gas Conservation Division
 Post Office Box 52000
 Oklahoma City, Oklahoma 73152-2000
 Rule 165: 10-3-25

Form 1002A

API No.: 35019239010002

Completion Report

Spud Date: September 06, 1990

OTC Prod. Unit No.:

Drilling Finished Date: September 16, 1990

Amended

1st Prod Date: November 19, 1990

Amend Reason: OPEN ADDITIONAL PERFORATIONS AND FRAC A PORTION OF
 UNITIZED ZONE

Completion Date: November 24, 1990

Recomplete Date: November 24, 2016

Drill Type: STRAIGHT HOLE

Min Gas Allowable: Yes

Well Name: HEWITT UNIT 22-1704

Purchaser/Measurer: C P ENERGY

Location: CARTER 22 4S 2W
 NE NE SE NE
 1124 FSL 2494 FWL of 1/4 SEC
 Derrick Elevation: 850 Ground Elevation: 834

First Sales Date: 11/19/1990

Operator: XTO ENERGY INC 21003

810 HOUSTON ST
 FORT WORTH, TX 76102-6203

| Completion Type | |
|-----------------|---------------|
| X | Single Zone |
| | Multiple Zone |
| | Commingled |

| Location Exception |
|---|
| Order No |
| There are no Location Exception records to display. |

| Increased Density |
|--|
| Order No |
| There are no Increased Density records to display. |

| Casing and Cement | | | | | | | |
|-------------------|--------|--------|-------|------|-----|------|------------|
| Type | Size | Weight | Grade | Feet | PSI | SAX | Top of CMT |
| SURFACE | 10 3/4 | 40.5 | K-55 | 555 | | 720 | SURFACE |
| PRODUCTION | 7 | 20 | K-55 | 3595 | | 1160 | SURFACE |

| Liner | | | | | | | | |
|--|------|--------|-------|--------|-----|-----|-----------|--------------|
| Type | Size | Weight | Grade | Length | PSI | SAX | Top Depth | Bottom Depth |
| There are no Liner records to display. | | | | | | | | |

Total Depth: 3600

| Packer | |
|---|--------------|
| Depth | Brand & Type |
| There are no Packer records to display. | |

| Plug | |
|---------------------------------------|-----------|
| Depth | Plug Type |
| There are no Plug records to display. | |

| Initial Test Data |
|-------------------|
| |

| Test Date | Formation | Oil BBL/Day | Oil-Gravity (API) | Gas MCF/Day | Gas-Oil Ratio Cu FT/BBL | Water BBL/Day | Pumpin or Flowing | Initial Shut-In Pressure | Choke Size | Flow Tubing Pressure |
|--------------|-----------|-------------|-------------------|-------------|-------------------------|---------------|-------------------|--------------------------|------------|----------------------|
| Nov 24, 2016 | HEWITT | 30 | | | | 433 | PUMPING | | | |

Completion and Test Data by Producing Formation

Formation Name: HEWITT

Code: 405HWTT

Class: OIL

Spacing Orders

| Order No | Unit Size |
|----------|-----------|
| 67990 | UNIT |

Perforated Intervals

| From | To |
|------|------|
| 1200 | 3383 |

Acid Volumes

2,000 GALLONS 15% HCL

Fracture Treatments

31,000 GALLONS GEL, 40,000 POUNDS SAND

| Formation | Top |
|-----------|------|
| PONTOTOC | 648 |
| HOXBAR | 1110 |
| DEESE | 2734 |

Were open hole logs run? No

Date last log run:

Were unusual drilling circumstances encountered? No

Explanation:

Other Remarks

IRREGULAR SECTION. OPEN LOWER BAYOU 1,200' - 1,275' @ SPF. FRAC LOWER BAYOU. PUT WELL ON PUMP.

FOR COMMISSION USE ONLY

1136733

Status: Accepted

RECEIVED

MAY 12 2017

Form 1002A Rev. 2009

API NO. 019-23901-X
OTC PROD. UNIT NO.

PLEASE TYPE OR USE BLACK INK ONLY
NOTE:

Attach copy of original 1002A if recompletion or reentry.

OKLAHOMA CORPORATION COMMISSION
Oil & Gas Conservation Division
Post Office Box 52000
Oklahoma City, Oklahoma 73152-2000
Rule 165:10-3-25

OKLAHOMA CORPORATION COMMISSION

ORIGINAL
 AMENDED (Reason)

Open Additional parts to Frac a portion of unitized zone

COMPLETION REPORT

TYPE OF DRILLING OPERATION
 STRAIGHT HOLE DIRECTIONAL HOLE HORIZONTAL HOLE
 SERVICE WELL
If directional or horizontal, see reverse for bottom hole location.

SPUD DATE 9/06/1990
DRLG FINISHED DATE 9/16/1990
DATE OF WELL COMPLETION 11/24/1990
1st PROD DATE 11/19/1990
RECOMP DATE 11/24/2016
Longitude (if known)

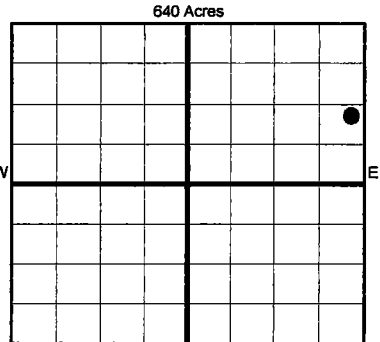

COUNTY Carter SEC 22 TWP 04S RGE 02W
LEASE NAME Hewitt Unit WELL NO. 22-1704
NE 1/4 NE 1/4 SE 1/4 NE 1/4 FSL OF 1/4 SEC 1124 FWL OF 1/4 SEC 2494
ELEVATIO N Derrick 850' Ground 834' Latitude (if known)
OPERATOR NAME XTO Energy Inc. OTC/OCC OPERATOR NO. 21003
ADDRESS 210 Park Avenue, Suite 2350
CITY Oklahoma City STATE Oklahoma ZIP 73102

COMPLETION TYPE
 SINGLE ZONE
 MULTIPLE ZONE
Application Date
 COMMINGLED
Application Date
LOCATION
EXCEPTION ORDER
INCREASED DENSITY
ORDER NO.

CASING & CEMENT (Form 1002C must be attached)

| TYPE | SIZE | WEIGHT | GRADE | FEET | PSI | SAX | TOP OF CMT |
|--------------|---------|--------|-------|-------|-----|------|------------|
| CONDUCTOR | | | | | | | |
| SURFACE | 10 3/4" | 40.5# | K-55 | 555' | | 720 | Surface |
| INTERMEDIATE | | | | | | | |
| PRODUCTION | 7" | 20# | K-55 | 3595' | | 1160 | Surface |
| LINER | | | | | | | |

PACKER @ _____ BRAND & TYPE _____ PLUG @ _____ TYPE _____ PLUG @ _____ TYPE _____
PACKER @ _____ BRAND & TYPE _____ PLUG @ _____ TYPE _____ PLUG @ _____ TYPE _____

TOTAL DEPTH 3600'

COMPLETION & TEST DATA BY PRODUCING FORMATION *405 HUWITT*

| | | | | | | | | | |
|---|-------------------|---------------|--|--|--|--|--|--|--|
| FORMATION | Hewitt Sands | | | | | | | | |
| SPACING & SPACING ORDER NUMBER | 67990 (unit) | | | | | | | | |
| CLASS: Oil, Gas, Dry, Inj, Disp, Comm Disp, Svc | Oil | | | | | | | | |
| PERFORMED INTERVALS | 1200-3383 | | | | | | | | |
| ACID/VOLUME | 2000 gals 15% HCL | (see remarks) | | | | | | | |
| FRACTURE TREATMENT (Fluids/Prop Amounts) | 31,000 gals gel | (see remarks) | | | | | | | |
| | 40,000# sand | | | | | | | | |

Reported to Frac Focus

Min Gas Allowable (165:10-17-7) OR Oil Allowable (165:10-13-3)
Gas Purchaser/Measurer CP Energy
First Sales Date 11/19/1990

INITIAL TEST DATA

| | | | | | |
|--------------------------|------------|--|--|--|--|
| INITIAL TEST DATE | 11/24/2016 | | | | |
| OIL-BBL/DAY | 30 BOPD | | | | |
| OIL-GRAVITY (API) | | | | | |
| GAS-MCF/DAY | | | | | |
| GAS-OIL RATIO CU FT/BBL | | | | | |
| WATER-BBL/DAY | 433 BWPD | | | | |
| PUMPING OR FLOWING | Pumping | | | | |
| INITIAL SHUT-IN PRESSURE | | | | | |
| CHOKE SIZE | | | | | |
| FLOW TUBING PRESSURE | | | | | |

AS SUBMITTED

A record of the formations drilled through, and pertinent remarks are presented on the reverse. I declare that I have knowledge of the contents of this report and am authorized by my organization to make this report, which was prepared by me or under my supervision and direction, with the data and facts stated herein to be true, correct, and complete to the best of my knowledge and belief.

Debbie Waggoner
SIGNATURE NAME (PRINT OR TYPE) 11/28/2016 405-319-3243
DATE PHONE NUMBER
210 Park Avenue, Suite 2350 Oklahoma City Ok 73102
ADDRESS CITY STATE ZIP
debbie_waggoner@xtoenergy.com
EMAIL ADDRESS

PLEASE TYPE OR USE BLACK INK ONLY
FORMATION RECORD

Give formation names and tops, if available, or descriptions and thickness of formations drilled through. Show intervals cored or drillstem tested.

| NAMES OF FORMATIONS | TOP |
|---------------------|-------|
| Pontotoc | 648 |
| Hoxbar | 1,110 |
| Deese | 2734 |

LEASE NAME Hewitt Unit WELL NO. 22-1704

| FOR COMMISSION USE ONLY | |
|-------------------------|--|
| ITD on file | <input type="checkbox"/> YES <input type="checkbox"/> NO |
| APPROVED | DISAPPROVED |
| 2) Reject Codes | |
| _____ | |
| _____ | |
| _____ | |
| _____ | |

Were open hole logs run? yes no

Date Last log was run _____

Was CO₂ encountered? yes no at what depths? _____

Was H₂S encountered? yes no at what depths? _____

Were unusual drilling circumstances encountered? yes no
If yes, briefly explain below _____

Other remarks: Irregular Section
Open Lower Bayou 1200-1275 @ SPF. Frac L. Bayou. Put well on pump.

640 Acres

| | | | | | | | | | |
|--|--|--|--|--|--|--|--|--|--|
| | | | | | | | | | |
| | | | | | | | | | |
| | | | | | | | | | |
| | | | | | | | | | |
| | | | | | | | | | |
| | | | | | | | | | |
| | | | | | | | | | |
| | | | | | | | | | |
| | | | | | | | | | |
| | | | | | | | | | |

If more than three drainholes are proposed, attach a separate sheet indicating the necessary information.

Direction must be stated in degrees azimuth. Please note, the horizontal drainhole and its end point must be located within the boundaries of the lease or spacing unit.

Directional surveys are required for all drainholes and directional wells.

640 Acres

| | | | | | | | | | |
|--|--|--|--|--|--|--|--|--|--|
| | | | | | | | | | |
| | | | | | | | | | |
| | | | | | | | | | |
| | | | | | | | | | |
| | | | | | | | | | |
| | | | | | | | | | |
| | | | | | | | | | |
| | | | | | | | | | |
| | | | | | | | | | |
| | | | | | | | | | |

BOTTOM HOLE LOCATION FOR DIRECTIONAL HOLE

| SEC | TWP | RGE | COUNTY |
|----------------------|-----|---------------------|---|
| Spot Location | | | |
| 1/4 | 1/4 | 1/4 | 1/4 |
| Measured Total Depth | | True Vertical Depth | BHL From Lease, Unit, or Property Line: |

BOTTOM HOLE LOCATION FOR HORIZONTAL HOLE: (LATERALS)

LATERAL #1

| SEC | TWP | RGE | COUNTY |
|----------------------|-----|---------------------|---|
| Spot Location | | | |
| 1/4 | 1/4 | 1/4 | 1/4 |
| Depth of Deviation | | Radius of Turn | Direction |
| Measured Total Depth | | True Vertical Depth | Total Length |
| | | | BHL From Lease, Unit, or Property Line: |

LATERAL #2

| SEC | TWP | RGE | COUNTY |
|----------------------|-----|---------------------|---|
| Spot Location | | | |
| 1/4 | 1/4 | 1/4 | 1/4 |
| Depth of Deviation | | Radius of Turn | Direction |
| Measured Total Depth | | True Vertical Depth | Total Length |
| | | | BHL From Lease, Unit, or Property Line: |

LATERAL #3

| SEC | TWP | RGE | COUNTY |
|----------------------|-----|---------------------|---|
| Spot Location | | | |
| 1/4 | 1/4 | 1/4 | 1/4 |
| Depth of Deviation | | Radius of Turn | Direction |
| Measured Total Depth | | True Vertical Depth | Total Length |
| | | | BHL From Lease, Unit, or Property Line: |