

Oklahoma Corporation Commission  
Oil & Gas Conservation Division  
Post Office Box 52000  
Oklahoma City, Oklahoma 73152-2000  
Rule 165: 10-3-25

Form 1002A

API No.: 35003231830001

**Completion Report**

Spud Date: February 11, 2017

OTC Prod. Unit No.:

Drilling Finished Date: February 26, 2017

1st Prod Date:

Completion Date: March 06, 2017

**Drill Type: STRAIGHT HOLE**

**SERVICE WELL**

Well Name: KELTNER 2512 1-17 SWD

Purchaser/Measurer:

Location: ALFALFA 17 25N 12W  
NW NW NE NW  
200 FNL 1615 FWL of 1/4 SEC  
Derrick Elevation: 0 Ground Elevation: 1393

First Sales Date:

Operator: MIDSTATES PETROLEUM COMPANY LLC 23079

321 S BOSTON AVE STE 1000  
TULSA, OK 74103-3322

Completion Type	
X	Single Zone
	Multiple Zone
	Commingled

Location Exception
Order No
There are no Location Exception records to display.

Increased Density
Order No
There are no Increased Density records to display.

Casing and Cement							
Type	Size	Weight	Grade	Feet	PSI	SAX	Top of CMT
SURFACE	13 3/8	48	J-55	584		510	SURFACE
INTERMEDIATE	9 5/8	36	J-55	1222		570	SURFACE
PRODUCTION	7	26	P-110	6630		445	2875

Liner								
Type	Size	Weight	Grade	Length	PSI	SAX	Top Depth	Bottom Depth
LINER	4.5	11.6	P-110	574	0	40	6582	7156

**Total Depth: 7167**

Packer	
Depth	Brand & Type
4479	TENSION

Plug	
Depth	Plug Type
There are no Plug records to display.	

Initial Test Data

Test Date	Formation	Oil BBL/Day	Oil-Gravity (API)	Gas MCF/Day	Gas-Oil Ratio Cu FT/BBL	Water BBL/Day	Pumpin or Flowing	Initial Shut-In Pressure	Choke Size	Flow Tubing Pressure
-----------	-----------	-------------	-------------------	-------------	-------------------------	---------------	-------------------	--------------------------	------------	----------------------

There are no Initial Data records to display.

**Completion and Test Data by Producing Formation**

Formation Name: HUNTON

Code: 269HNTN

Class: DISP

**Spacing Orders**

Order No	Unit Size
There are no Spacing Order records to display.	

**Perforated Intervals**

From	To
7012	7096

**Acid Volumes**

48 BARRELS 15% NFE
--------------------

**Fracture Treatments**

There are no Fracture Treatments records to display.	
--	--

Formation Name: WILCOX

Code: 202WLCX

Class: DISP

**Spacing Orders**

Order No	Unit Size
There are no Spacing Order records to display.	

**Perforated Intervals**

From	To
6645	7001

**Acid Volumes**

There are no Acid Volume records to display.
--

**Fracture Treatments**

There are no Fracture Treatments records to display.	
--	--

Formation	Top
ENDICOTT	4423
HASKELL	4803
TONKAWA	4811
AVANT	5159
COTTAGE GROVE	5201
HOGSHOOTER	5346
BIG LIME	5539
OSWEGO	5566
CHEROKEE	5677
MISSISSIPPIAN	5935
WOODFORD	6598
HUNTON	6650
SYLVAN	6678
VIOLA	6759
WILCOX	6906
WILCOX BASE	7101
OIL CREEK SHALE	7162

Were open hole logs run? No

Date last log run:

Were unusual drilling circumstances encountered? No

Explanation:

**Other Remarks**

**FOR COMMISSION USE ONLY**

1136667

Status: Accepted

API NO. 003 23183  
 OTC PROD. UNIT NO. N/A

PLEASE TYPE OR USE BLACK INK ONLY  
 NOTE:

Attach copy of original 1002A if recompletion or reentry.

OKLAHOMA CORPORATION COMMISSION  
 Oil & Gas Conservation Division  
 Post Office Box 52000  
 Oklahoma City, Oklahoma 73152-2000  
 Rule 165:10-3-25

RECEIVED Form 1002A Rev. 2009

MAY 01 2017

OKLAHOMA CORPORATION COMMISSION

ORIGINAL  
 AMENDED (Reason)

COMPLETION REPORT

TYPE OF DRILLING OPERATION  
 STRAIGHT HOLE  DIRECTIONAL HOLE  HORIZONTAL HOLE  
 SERVICE WELL  
 If directional or horizontal, see reverse for bottom hole location.

SPUD DATE 02/11/2017  
 DRLG FINISHED DATE 02/26/2017  
 DATE OF WELL COMPLETION 03/06/2017  
 WELL NO. 1-17 SWD  
 1st PROD DATE N/A  
 RECOMP DATE  
 OPERATOR NAME Midstates Petroleum Company LLC  
 OTC/OCC OPERATOR NO. 23079  
 ADDRESS 321 South Boston, Suite 1000  
 CITY Tulsa STATE OK ZIP 74103

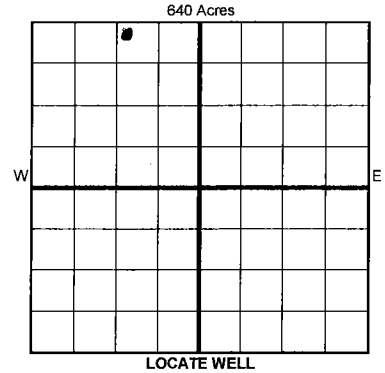

COUNTY Alfalfa SEC 17 TWP 25N RGE 12W  
 LEASE NAME Keltner 2512  
 NW 1/4 NW 1/4 NE 1/4 NW 1/4 OF 1/4 SEC 200N FWL OF 1/4 SEC 1615  
 ELEVATION N Derrick Ground 1,393' Latitude (if known) 36.651679524N Longitude (if known) -98.516701544W

COMPLETION TYPE

SINGLE ZONE  
 MULTIPLE ZONE Application Date  
 COMMINGLED Application Date  
 LOCATION EXCEPTION ORDER N/A  
 INCREASED DENSITY ORDER NO. N/A

CASING & CEMENT (Form 1002C must be attached)

TYPE	SIZE	WEIGHT	GRADE	FEET	PSI	SAX	TOP OF CMT	
CONDUCTOR								
SURFACE	13-3/8	48#	J-55	584'		510	surface	
INTERMEDIATE	9-5/8	36#	J-55	1,222'		570	surface	
PRODUCTION	7	26#	P-110	6,630'		445	2,875'	
LINER	4.5	11.6#	P-110	6,582'	7,156'	40	6,620'	
							TOTAL DEPTH	7,167'

PACKER @ 4.479' BRAND & TYPE Tension PLUG @ TYPE PLUG @ TYPE  
 PACKER @ BRAND & TYPE PLUG @ TYPE PLUG @ TYPE

COMPLETION & TEST DATA BY PRODUCING FORMATION - 269 HNTN - 202 WLCX

FORMATION	Hunton	Wilcox					
SPACING & SPACING ORDER NUMBER	N/A	N/A					No Frac
CLASS: Oil, Gas, Dry, Inj, Disp, Comm Disp, Svc	Non-Comm Disp	Non-Comm Disp					
PERFORATED INTERVALS	7,012'-7,096'	6,645'-7,001'					
ACID/VOLUME	48 bbls 15% NFE						
FRACTURE TREATMENT (Fluids/Prop Amounts)							

Min Gas Allowable (165:10-17-7) OR  Gas Purchaser/Measurer First Sales Date N/A  
 Oil Allowable (165:10-13-3) N/A

INITIAL TEST DATA

INITIAL TEST DATE	N/A DISP WELL					
OIL-BBL/DAY						
OIL-GRAVITY (API)						
GAS-MCF/DAY						
GAS-OIL RATIO CU FT/BBL						
WATER-BBL/DAY						
PUMPING OR FLOWING						
INITIAL SHUT-IN PRESSURE						
CHOKE SIZE						
FLOW TUBING PRESSURE						

**AS SUBMITTED**

A record of the formations drilled through, and pertinent remarks are presented on the reverse. I declare that I have knowledge of the contents of this report and am authorized by my organization to make this report, which was prepared by me or under my supervision and direction, with the data and facts stated herein to be true, correct, and complete to the best of my knowledge and belief.

SIGNATURE Chelce Rouse DATE 04/27/17 PHONE NUMBER 918-947-4647  
 ADDRESS 321 South Boston, Suite 1000 CITY Tulsa STATE OK ZIP 74103 EMAIL ADDRESS chelce.rouse@midstatespetroleum.com

PLEASE TYPE OR USE BLACK INK ONLY  
FORMATION RECORD

Give formation names and tops, if available, or descriptions and thickness of formations drilled through. Show intervals cored or drillstem tested.

LEASE NAME Keltner 2512

WELL NO. 1-17 SWD

NAMES OF FORMATIONS	TOP
ENDICOTT	4,423
HASKELL	4,803
TONKAWA	4,811
AVANT	5,159
COTTAGE GROVE	5,201
HOGSHOOTER	5,346
BIG LIME	5,539
OSWEGO	5,566
CHEROKEE	5,677
MISSISSIPPIAN	5,935
WOODFORD	6,598
HUNTON	6,650
SYLVAN	6,678
VIOLA	6,759
WILCOX	6,906
WILCOX BASE	7,101
OIL CREEK SHALE	7,162

FOR COMMISSION USE ONLY

ITD on file  YES  NO

APPROVED \_\_\_\_\_ DISAPPROVED \_\_\_\_\_

2) Reject Codes \_\_\_\_\_

Were open hole logs run?  yes  no

Date Last log was run N/A

Was CO<sub>2</sub> encountered?  yes  no at what depths? \_\_\_\_\_

Was H<sub>2</sub>S encountered?  yes  no at what depths? \_\_\_\_\_

Were unusual drilling circumstances encountered?  yes  no

If yes, briefly explain below

Other remarks: WIC ORDER 654904

OCC - This well is a multi-zone injector.

640 Acres

If more than three drainholes are proposed, attach a separate sheet indicating the necessary information.

Direction must be stated in degrees azimuth. Please note, the horizontal drainhole and its end point must be located within the boundaries of the lease or spacing unit.

Directional surveys are required for all drainholes and directional wells.

640 Acres

BOTTOM HOLE LOCATION FOR DIRECTIONAL HOLE

SEC	TWP	RGE	COUNTY
Spot Location			
1/4	1/4	1/4	1/4
Measured Total Depth		True Vertical Depth	Feet From 1/4 Sec Lines FSL FWL
BHL From Lease, Unit, or Property Line:			

BOTTOM HOLE LOCATION FOR HORIZONTAL HOLE: (LATERALS)

LATERAL #1

SEC	TWP	RGE	COUNTY
Spot Location			
1/4	1/4	1/4	1/4
Depth of Deviation		Radius of Turn	Direction Total Length
Measured Total Depth		True Vertical Depth	BHL From Lease, Unit, or Property Line:

LATERAL #2

SEC	TWP	RGE	COUNTY
Spot Location			
1/4	1/4	1/4	1/4
Depth of Deviation		Radius of Turn	Direction Total Length
Measured Total Depth		True Vertical Depth	BHL From Lease, Unit, or Property Line:

LATERAL #3

SEC	TWP	RGE	COUNTY
Spot Location			
1/4	1/4	1/4	1/4
Depth of Deviation		Radius of Turn	Direction Total Length
Measured Total Depth		True Vertical Depth	BHL From Lease, Unit, or Property Line: