

Oklahoma Corporation Commission
 Oil & Gas Conservation Division
 Post Office Box 52000
 Oklahoma City, Oklahoma 73152-2000
 Rule 165: 10-3-25

Form 1002A

API No.: 35087217160004

Completion Report

Spud Date: October 12, 2004

OTC Prod. Unit No.:

Drilling Finished Date: November 28, 2004

Amended

1st Prod Date: July 13, 2005

Amend Reason: RECOMPLETE

Completion Date: December 10, 2005

Recomplete Date: March 03, 2017

Drill Type: STRAIGHT HOLE

Min Gas Allowable: Yes

Well Name: IRIS 1-33

Purchaser/Measurer:

Location: MCCLAIN 33 5N 4W
 N2 N2 SE SW
 1310 FSL 660 FEL of 1/4 SEC
 Latitude: 34.85859 Longitude: -97.62855
 Derrick Elevation: 0 Ground Elevation: 1041

First Sales Date:

Operator: RUFFEL LANCE OIL & GAS LLC 15459

210 PARK AVE STE 2150
 OKLAHOMA CITY, OK 73102-5632

Completion Type	
X	Single Zone
	Multiple Zone
	Commingled

Location Exception	
Order No	
659257	

Increased Density	
Order No	
There are no Increased Density records to display.	

Casing and Cement							
Type	Size	Weight	Grade	Feet	PSI	SAX	Top of CMT
SURFACE	9 5/8	36	J-55	270		140	SURFACE
PRODUCTION	5 1/2	17	N-80 & P-110	12410		525	7730

Liner								
Type	Size	Weight	Grade	Length	PSI	SAX	Top Depth	Bottom Depth
There are no Liner records to display.								

Total Depth: 12441

Packer	
Depth	Brand & Type
There are no Packer records to display.	

Plug	
Depth	Plug Type
9100	CIBP
11240	CIBP

Initial Test Data

Test Date	Formation	Oil BBL/Day	Oil-Gravity (API)	Gas MCF/Day	Gas-Oil Ratio Cu FT/BBL	Water BBL/Day	Pumpin or Flowing	Initial Shut-In Pressure	Choke Size	Flow Tubing Pressure
Dec 26, 2016	SYCAMORE	2	42	85	42	9	SHUT IN	1460		220
Mar 03, 2017	SPRINGER	37	42	17	459	67	PUMPING	3544		

Completion and Test Data by Producing Formation

Formation Name: SYCAMORE

Code: 352SCMR

Class: DRY

Spacing Orders

Order No	Unit Size
656870	80

Perforated Intervals

From	To
9418	9460

Acid Volumes

15% KCL

Fracture Treatments

2,279.14 BARRELS

Formation Name: SPRINGER

Code: 401SPRG

Class: OIL

Spacing Orders

Order No	Unit Size
656870	80

Perforated Intervals

From	To
8422	8592

Acid Volumes

15% KCL

Fracture Treatments

There are no Fracture Treatments records to display.

Formation	Top
------------------	------------

Were open hole logs run? No

Date last log run:

Were unusual drilling circumstances encountered? No

Explanation:

Other Remarks
There are no Other Remarks.

FOR COMMISSION USE ONLY

1136666

Status: Accepted

RECEIVED

Form 1002A Rev. 2009

MAY 03 2017

OKLAHOMA CORPORATION COMMISSION

API NO. 087-21716
OTC PROD. UNIT NO. 15459-0

PLEASE TYPE OR USE BLACK INK ONLY
NOTE: Attach copy of original 1002A if recompletion or reentry.

OKLAHOMA CORPORATION COMMISSION
Oil & Gas Conservation Division
Post Office Box 52000
Oklahoma City, Oklahoma 73152-2000
Rule 165:10-3-25

ORIGINAL AMENDED (Reason) Recomplete

COMPLETION REPORT

TYPE OF DRILLING OPERATION
 STRAIGHT HOLE DIRECTIONAL HOLE HORIZONTAL HOLE
 SERVICE WELL

Table with completion dates: SPUD DATE 10/12/2004, DRLG FINISHED DATE 11/28/2004, DATE OF WELL COMPLETION 12/10/2005, 1st PROD DATE 7/13/2005, RECOMP DATE 3/3/2017

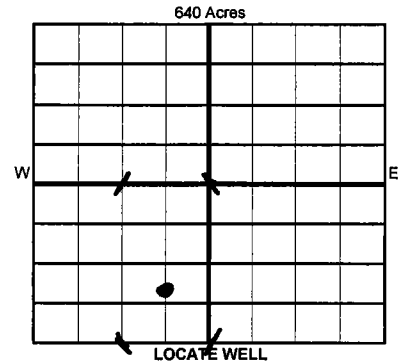

Well location and lease information: COUNTY McClain, SEC 33, TWP 5N, RGE 4W, LEASE NAME Iris, WELL NO. #1-33, N 1/2 1/4 N 1/2 1/4 SE 1/4 SW 1/4, FSL 1310', DIST OF 1/4 SEC 660', ELEVATION 1041', OPERATOR LANCE RUFFEL OIL & GAS LLC, ADDRESS 210 PARK AVENUE, SUITE 2150, CITY OKLAHOMA CITY, STATE OK, ZIP 73102

COMPLETION TYPE: SINGLE ZONE, LOCATION EXCEPTION ORDER INCREASED DENSITY ORDER NO. 659257 F.O.

CASING & CEMENT (Form 1002C must be attached) table with columns: TYPE, SIZE, WEIGHT, GRADE, FEET, PSI, SAX, TOP OF CMT. Includes rows for CONDUCTOR, SURFACE, INTERMEDIATE, PRODUCTION, LINER.

PACKER @ _____ BRAND & TYPE _____ PLUG @ 9,100' TYPE CIBP PLUG @ _____ TYPE _____ TOTAL DEPTH 12,441
PACKER @ _____ BRAND & TYPE _____ PLUG @ 11,240 TYPE CIBP PLUG @ _____ TYPE _____

COMPLETION & TEST DATA BY PRODUCING FORMATION table with columns: FORMATION, Spacing, Class, Perforated Intervals, Acid/Volume, Fracture Treatment. Includes handwritten notes: '3525CMR', '4015PRG', 'No Frac on Recomplete'.

INITIAL TEST DATA section with checkboxes for Min Gas Allowable or Oil Allowable, and fields for Gas Purchaser/Measurer and First Sales Date.

Table with initial test data: INITIAL TEST DATE, OIL-BBL/DAY, OIL-GRAVITY (API), GAS-MCF/DAY, GAS-OIL RATIO CU FT/BBL, WATER-BBL/DAY, PUMPING OR FLOWING, INITIAL SHUT-IN PRESSURE, CHOKE SIZE, FLOW TUBING PRESSURE.

AS SUBMITTED

A record of the formations drilled through, and pertinent remarks are presented on the reverse. I declare that I have knowledge of the contents of this report and am authorized by my organization to make this report, which was prepared by me or under my supervision and direction, with the data and facts stated herein to be true, correct, and complete to the best of my knowledge and belief.
SIGNATURE: [Signature] LANCE RUFFEL
210 PARK AVENUE, SUITE 2150 OKLAHOMA CITY OK 73102
DATE: 5.1.17 PHONE NUMBER: 405/239-7036

PLEASE TYPE OR USE BLACK INK ONLY
FORMATION RECORD

Give formation names and tops, if available, or descriptions and thickness of formations drilled through. Show intervals cored or drillstem tested.

LEASE NAME _____ WELL NO. _____

NAMES OF FORMATIONS	TOP

FOR COMMISSION USE ONLY

ITD on file YES NO

APPROVED DISAPPROVED 2) Reject Codes

Were open hole logs run? ___ yes ___ no

Date Last log was run _____

Was CO₂ encountered? ___ yes ___ no at what depths? _____

Was H₂S encountered? ___ yes ___ no at what depths? _____

Were unusual drilling circumstances encountered? ___ yes ___ no

If yes, briefly explain below

Other remarks: _____

640 Acres

If more than three drainholes are proposed, attach a separate sheet indicating the necessary information.

Direction must be stated in degrees azimuth. Please note, the horizontal drainhole and its end point must be located within the boundaries of the lease or spacing unit.

Directional surveys are required for all drainholes and directional wells.

640 Acres

BOTTOM HOLE LOCATION FOR DIRECTIONAL HOLE

SEC	TWP	RGE	COUNTY	Spot Location	Feet From 1/4 Sec Lines	FSL	FWL
				1/4 1/4 1/4 1/4			
Measured Total Depth		True Vertical Depth		BHL From Lease, Unit, or Property Line:			

BOTTOM HOLE LOCATION FOR HORIZONTAL HOLE: (LATERALS)

LATERAL #1

SEC	TWP	RGE	COUNTY	Spot Location	Feet From 1/4 Sec Lines	FSL	FWL
				1/4 1/4 1/4 1/4			
Depth of Deviation		Radius of Turn		Direction		Total Length	
Measured Total Depth		True Vertical Depth		BHL From Lease, Unit, or Property Line:			

LATERAL #2

SEC	TWP	RGE	COUNTY	Spot Location	Feet From 1/4 Sec Lines	FSL	FWL
				1/4 1/4 1/4 1/4			
Depth of Deviation		Radius of Turn		Direction		Total Length	
Measured Total Depth		True Vertical Depth		BHL From Lease, Unit, or Property Line:			

LATERAL #3

SEC	TWP	RGE	COUNTY	Spot Location	Feet From 1/4 Sec Lines	FSL	FWL
				1/4 1/4 1/4 1/4			
Depth of Deviation		Radius of Turn		Direction		Total Length	
Measured Total Depth		True Vertical Depth		BHL From Lease, Unit, or Property Line:			