

Oklahoma Corporation Commission  
Oil & Gas Conservation Division  
Post Office Box 52000  
Oklahoma City, Oklahoma 73152-2000  
Rule 165: 10-3-25

Form 1002A

API No.: 35087220220001

**Completion Report**

Spud Date: April 04, 2015

OTC Prod. Unit No.: 087-216228

Drilling Finished Date: April 13, 2015

**Amended**

1st Prod Date: June 15, 2015

Amend Reason: RECOMPLETE DEESE AND TEST HUNTON

Completion Date: August 12, 2015

Recomplete Date: March 01, 2017

**Drill Type: STRAIGHT HOLE**

Min Gas Allowable: Yes

Well Name: MORGAN FC 1-5

Purchaser/Measurer: DCP

Location: MCCLAIN 5 5N 2W  
W2 E2 SE SW  
660 FSL 2050 FWL of 1/4 SEC  
Latitude: 34.92979 Longitude: -97.43474  
Derrick Elevation: 1068 Ground Elevation: 1054

First Sales Date: 07/08/2015

Operator: CHARTER OAK PRODUCTION CO LLC 21672

13929 QUAIL POINTE DR  
OKLAHOMA CITY, OK 73134-1037

Completion Type		Location Exception		Increased Density	
X	Single Zone	Order No		Order No	
	Multiple Zone	There are no Location Exception records to display.		There are no Increased Density records to display.	
	Commingled				

Casing and Cement							
Type	Size	Weight	Grade	Feet	PSI	SAX	Top of CMT
CONDUCTOR	16			42			SURFACE
SURFACE	8 5/8	24	J-55	377		250	SURFACE
PRODUCTION	5 1/2	20	N-80	8740		325	6930

Liner								
Type	Size	Weight	Grade	Length	PSI	SAX	Top Depth	Bottom Depth
There are no Liner records to display.								

**Total Depth: 8745**

Packer	
Depth	Brand & Type
There are no Packer records to display.	

Plug	
Depth	Plug Type
7500	CIBP
8200	CIBP

Initial Test Data
-------------------

Test Date	Formation	Oil BBL/Day	Oil-Gravity (API)	Gas MCF/Day	Gas-Oil Ratio Cu FT/BBL	Water BBL/Day	Pumpin or Flowing	Initial Shut-In Pressure	Choke Size	Flow Tubing Pressure
Aug 12, 2015	VIOLA	45	34.5	41	911	42	PUMPING	2375		
Nov 02, 2016	HUNTON	5				17	SWAB	300		
Mar 01, 2017	DEESE	8	38.7	24	3000	8	PUMPING	1790		

#### Completion and Test Data by Producing Formation

Formation Name: VIOLA

Code: 202VIOL

Class: DRY

##### Spacing Orders

Order No	Unit Size
46999	40

##### Perforated Intervals

From	To
8216	8480

##### Acid Volumes

29,232 GALLONS 15% NEFE HCL
-----------------------------

##### Fracture Treatments

8,144 BARRELS SLICK WATER, 99,480 POUNDS 20/40 SAND
---

Formation Name: HUNTON

Code: 269HNTN

Class: DRY

##### Spacing Orders

Order No	Unit Size
50434	480

##### Perforated Intervals

From	To
7554	7566

##### Acid Volumes

2,000 GALLONS 15% NEFE
------------------------

##### Fracture Treatments

50.4 BARRELS 2% KCL WATER
---------------------------

Formation Name: DEESE

Code: 404DEESS

Class: OIL

##### Spacing Orders

Order No	Unit Size
50434	480

##### Perforated Intervals

From	To
7326	7444

##### Acid Volumes

500 GALLONS 7.5% NEFE
-----------------------

##### Fracture Treatments

2,673 BARRELS 2% KCL WATER, 100,000 POUNDS 20/40 SAND
---

Formation	Top
DEESE	6426
BASAL PENN	7427
WOODFORD	7512
HUNTON	7553
SYLVAN	8035
VIOLA	8187
BROMIDE	8641

Were open hole logs run? Yes

Date last log run: April 14, 2015

Were unusual drilling circumstances encountered? No

Explanation:

Other Remarks

There are no Other Remarks.

FOR COMMISSION USE ONLY	
Status: Accepted	1136245

# RECEIVED

Form 1002A  
Rev. 2009

MAR 20 2017

OKLAHOMA CORPORATION COMMISSION

API NO. 35-087-22022  
OTC PROD. UNIT NO. 087-216228

PLEASE TYPE OR USE BLACK INK ONLY  
NOTE:

Attach copy of original 1002A  
if recompletion or reentry.

OKLAHOMA CORPORATION COMMISSION  
Oil & Gas Conservation Division  
Post Office Box 52000  
Oklahoma City, Oklahoma 73152-2000  
Rule 165:10-3-25

☒ ORIGINAL  
☐ AMENDED (Reason) Recomplete Deese & Test Hunton

## COMPLETION REPORT

TYPE OF DRILLING OPERATION  
☒ STRAIGHT HOLE ☐ DIRECTIONAL HOLE ☐ HORIZONTAL HOLE  
☐ SERVICE WELL  
If directional or horizontal, see reverse for bottom hole location.

COUNTY <b>McClain</b>	SEC <b>05</b>	TWP <b>05N</b>	RGE <b>02W</b>	SPUD DATE <b>4/4/15</b>
LEASE NAME <b>Morgan FC</b>				DRLG FINISHED DATE <b>4/13/15</b>
WELL NO. <b>1-5</b>				DATE OF WELL COMPLETION <b>8/12/15</b>
1st PROD DATE <b>6/15/15</b>				RECOMP DATE <b>3/1/17</b>
W2 1/4 E2 1/4 SE 1/4 SW 1/4		FSL OF 1/4 SEC <b>660'</b>	FWL OF 1/4 SEC <b>2050'</b>	Longtitude (if known) <b>-97.43474</b>
ELEVATION <b>1068'</b> Ground <b>1054'</b>		Latitude (if known) <b>34.92979</b>		
OPERATOR NAME <b>Charter Oak Production Co., LLC</b>				OTC/OCC OPERATOR NO. <b>21672</b>
ADDRESS <b>13929 Quail Pointe Dr.</b>				
CITY <b>Oklahoma City</b>		STATE <b>OK</b>	ZIP <b>73134</b>	

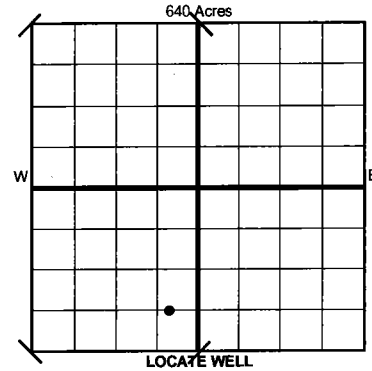

## COMPLETION TYPE

☒ SINGLE ZONE  
☐ MULTIPLE ZONE  
Application Date  
☐ COMINGLED  
Application Date  
LOCATION  
EXCEPTION ORDER **N/A**  
INCREASED DENSITY ORDER NO. **N/A**

## CASING & CEMENT (Form 1002C must be attached)

TYPE	SIZE	WEIGHT	GRADE	FEET	PSI	SAX	TOP OF CMT
CONDUCTOR	16"			42'			Surface
SURFACE	8 5/8"	24#	J-55	377'		250	Surface
INTERMEDIATE							
PRODUCTION	5 1/2"	20#	N-80	8740'		325	6930'
LINER							
				TOTAL DEPTH	8745'		

PACKER @ \_\_\_\_\_ BRAND & TYPE \_\_\_\_\_ PLUG @ 7500 TYPE CIBP \_\_\_\_\_ PLUG @ \_\_\_\_\_ TYPE \_\_\_\_\_  
PACKER @ \_\_\_\_\_ BRAND & TYPE \_\_\_\_\_ PLUG @ 8200 TYPE CIBP \_\_\_\_\_ PLUG @ \_\_\_\_\_ TYPE \_\_\_\_\_

## COMPLETION & TEST DATA BY PRODUCING FORMATION **202V106, 269HNTN, 404DEESS**

FORMATION	Viola	Hunton	Deese		
SPACING & SPACING ORDER NUMBER	40 Ac. - 46999	480 Ac. - 50434	480 Ac. - 50434		<i>Reported to Frac Focus</i>
CLASS: Oil, Gas, Dry, Inj, Disp, Comm Disp, Svc	<i>Oil Dry under Plug</i>	<i>Oil Dry under Plug</i>	Oil		
PERFORATED INTERVALS	8216' - 8480' O.A. See attached schematic	7554' - 7566'	7326' - 7336' 7432' - 7438' 7442' - 7444'		
ACID/VOLUME	29,232 Gal 15% NeFe HCl	2000 Gal 15% NeFe	500 Gal 7.5% NeFe		
FRACTURE TREATMENT (Fluids/Prop Amounts)	8144 BBL slick water 99,480# 20/40 sand	50.4 BBL 2% KCl water	2673 BBL 2% KCl water 100,000# 20/40 sand		

☒ Min Gas Allowable (165:10-17-7) OR ☐ Oil Allowable (165:10-13-3)  
Gas Purchaser/Measurer \_\_\_\_\_ DCP \_\_\_\_\_  
First Sales Date **7/8/15**

## INITIAL TEST DATA

INITIAL TEST DATE	8/12/15	11/2/16	3/1/17
OIL-BBL/DAY	45	5	8
OIL-GRAVITY (API)	34.5	N/A	38.7
GAS-MCF/DAY	41	TSTM	24
GAS-OIL RATIO CU FT/BBL	911	N/A	3000
WATER-BBL/DAY	42	17	8
PUMPING OR FLOWING	Pumping	Swab	Pumping
INITIAL SHUT-IN PRESSURE	2375 psi	300 psi	1790 psi
CHOKE SIZE	N/A	N/A	N/A
FLOW TUBING PRESSURE	N/A	N/A	N/A

**AS SUBMITTED**

A record of the formations drilled through, and pertinent remarks are presented on the reverse. I declare that I have knowledge of the contents of this report and am authorized by my organization to make this report, which was prepared by me or under my supervision and direction, with the data and facts stated herein to be true, correct, and complete to the best of my knowledge and belief.

*Joseph C. Brevetti*  
SIGNATURE NAME (PRINT OR TYPE) **Joseph C. Brevetti, Engineering Tech.**  
13929 Quail Pointe Dr. Oklahoma City OK 73134  
ADDRESS CITY STATE ZIP  
DATE **3/17/17** PHONE NUMBER **(405) 286-0361**  
brevetti@charteroakproduction.com  
EMAIL ADDRESS

Give formation names and tops, if available, or descriptions and thickness of formations drilled through. Show intervals cored or drillstem tested.

WELL NO. 1-5

NAMES OF FORMATIONS	TOP
Deese	6426'
Basal Penn	7427'
Woodford	7512'
Hunton	7553'
Sylvan	8035'
Viola	8187'
Bromide	8641'

FOR COMMISSION USE ONLY	
ITD on file	<input type="checkbox"/> YES <input type="checkbox"/> NO
APPROVED	DISAPPROVED
2) Reject Codes	

Were open hole logs run? ☒ yes ☐ no

Date Last log was run April 14, 2015

Was CO<sub>2</sub> encountered? ☐ yes ☒ no at what depths? \_\_\_\_\_

Was H<sub>2</sub>S encountered? ☐ yes ☒ no at what depths? \_\_\_\_\_

Were unusual drilling circumstances encountered? ☐ yes ☒ no

If yes, briefly explain below

Other remarks:

640 Acres

Direction must be stated in degrees azimuth.  
Please note, the horizontal drainhole and its end  
point must be located within the boundaries of the  
lease or spacing unit.

640 Acres

10x10 Grid

SEC	TWP	RGE	COUNTY
Spot Location			
1/4	1/4	1/4	1/4
Measured Total Depth		True Vertical Depth	BHL From Lease, Unit, or Property Line:

LATERAL #1			LATERAL #2		
SEC	TWP	RGE	COUNTY		
Spot Location			Feet From 1/4 Sec Lines		
1/4	1/4	1/4	FSL		FWL
Depth of Deviation		Radius of Turn	Direction		Total Length
Measured Total Depth		True Vertical Depth	BHL From Lease, Unit, or Property Line:		

SEC	TWP	RGE	COUNTY			
Spot Location			Feet From 1/4 Sec Lines		FSL	FWL
1/4	1/4	1/4	1/4			
Depth of Deviation		Radius of Turn	Direction	Total Length		
Measured Total Depth		True Vertical Depth	BHL From Lease, Unit, or Property Line:			

CERIAL #3						
SEC	TWP	RGE	COUNTY			
Spot Location			Feet From 1/4 Sec Lines		FSL	FWL
1/4		1/4	1/4	1/4		
Depth of Deviation		Radius of Turn	Direction		Total Length	
Measured Total Depth		True Vertical Depth	BHL From Lease, Unit, or Property Line:			