

Oklahoma Corporation Commission  
Oil & Gas Conservation Division  
Post Office Box 52000  
Oklahoma City, Oklahoma 73152-2000  
Rule 165: 10-3-25

Form 1002A

API No.: 35129240840000

**Completion Report**

Spud Date: September 18, 2016

OTC Prod. Unit No.: 129-218371

Drilling Finished Date: September 30, 2016

1st Prod Date: February 10, 2017

Completion Date: January 25, 2017

**Drill Type:** STRAIGHT HOLE

Min Gas Allowable: Yes

Well Name: LUKE 15-11

Purchaser/Measurer: ENBRIDGE PIPELINE

Location: ROGER MILLS 15 13N 24W  
SW NW NE SW  
2000 FSL 1480 FWL of 1/4 SEC  
Derrick Elevation: 2068 Ground Elevation: 2052

First Sales Date: 03/07/2017

Operator: REDLAND RESOURCES LLC 18774

6001 NW 23RD ST  
OKLAHOMA CITY, OK 73127-1253

Completion Type		Location Exception		Increased Density	
X	Single Zone	Order No		Order No	
	Multiple Zone	There are no Location Exception records to display.		There are no Increased Density records to display.	
	Commingled				

Casing and Cement							
Type	Size	Weight	Grade	Feet	PSI	SAX	Top of CMT
CONDUCTOR	20			85		28	SURFACE
SURFACE	8.625	24		559		300	SURFACE
PRODUCTION	5.5	17	L-80	9593		250	6540

Liner								
Type	Size	Weight	Grade	Length	PSI	SAX	Top Depth	Bottom Depth
There are no Liner records to display.								

**Total Depth: 9592**

Packer	
Depth	Brand & Type
There are no Packer records to display.	

Plug	
Depth	Plug Type
There are no Plug records to display.	

Initial Test Data
-------------------

Test Date	Formation	Oil BBL/Day	Oil-Gravity (API)	Gas MCF/Day	Gas-Oil Ratio Cu FT/BBL	Water BBL/Day	Pumpin or Flowing	Initial Shut- In Pressure	Choke Size	Flow Tubing Pressure
Mar 10, 2017	TONKAWA	15	40	20	1333	32	PUMPING	1500		

Completion and Test Data by Producing Formation

Formation Name: TONKAWA

Code: 406TNKW

Class: OIL

Spacing Orders

Order No	Unit Size
115709	640

Perforated Intervals

From	To
9141	9266

Acid Volumes

5,000 GALLONS 10% HCL, 3% HF, 3% CITRIC ACID

Fracture Treatments

4,382 BARRELS 25 POUNDS X-LINK GELLED 4% KCL,  
250,000 POUNDS 20/40 OTTAWA SAND

Formation	Top
TOP VIRGIL WASH	8037
TOP DOUGLAS	8266
BASE DOUGLAS SAND	8357
DOUGLAS LIME	8607
TONKAWA MARKER	9077
TOP TONKAWA SAND	9138

Were open hole logs run? Yes  
Date last log run: October 26, 2016

Were unusual drilling circumstances encountered? No  
Explanation:

Other Remarks
There are no Other Remarks.

FOR COMMISSION USE ONLY

Status: Accepted

1136201

API NO. 129-24084  
OTC PROD UNIT NO. 29-218371

PLEASE TYPE OR USE BLACK INK ONLY  
NOTE:

Attach copy of original 1002A  
if recompletion or reentry.

OKLAHOMA CORPORATION COMMISSION  
Oil & Gas Conservation Division  
Post Office Box 52000  
Oklahoma City, Oklahoma 73152-2000  
Rule 165:10-3-25

RECEIVED

Form 1002A  
Rev. 2009

MAR 14 2017

OKLAHOMA CORPORATION  
COMMISSION

COMPLETION REPORT

☒ ORIGINAL  
☐ AMENDED (Reason) \_\_\_\_\_

TYPE OF DRILLING OPERATION

☒ STRAIGHT HOLE ☐ DIRECTIONAL HOLE ☐ HORIZONTAL HOLE  
☐ SERVICE WELL

If directional or horizontal, see reverse for bottom hole location.

COUNTY	ROGER MILLS	SEC	15	TWP	13N	RGE	24W	SPUD DATE	9-18-16	
LEASE NAME	LUKE	WELL NO.	15-11	DRLG FINISHED DATE	9-30-16	DATE OF WELL COMPLETION			1-25-17	
SW 1/4 NW 1/4 NE 1/4 SW 1/4	FSL OF 1/4 SEC	2000	FWL OF 1/4 SEC	1480	1st PROD DATE	2-10-17			RECOMP DATE	
ELEVATION N Derrick	2068	Ground	2052	Latitude (if known)	35°36'3.4"N	Longitude (if known)	99°44'37.3"W			
OPERATOR NAME	REDLAND RESOURCES, LLC				OTC/OCC OPERATOR NO.	18774				
ADDRESS	6001 N.W. 23RD									
CITY	OKLA. CITY			STATE	OKLA.		ZIP	73127		

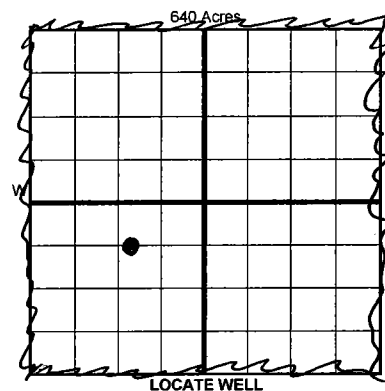

COMPLETION TYPE

<input checked="" type="checkbox"/> SINGLE ZONE
<input type="checkbox"/> MULTIPLE ZONE Application Date
<input type="checkbox"/> COMMINGLED Application Date
LOCATION
EXCEPTION ORDER
INCREASED DENSITY ORDER NO.

CASING & CEMENT (Form 1002C must be attached)

TYPE	SIZE	WEIGHT	GRADE	FEET	PSI	SAX	TOP OF CMT
CONDUCTOR	20"			85		28.5sax	
SURFACE	8.625	24#		559		9.5yd	SURFACE
INTERMEDIATE						300	SURFACE
PRODUCTION	5.5	17#	L-80	9593		250	6540
LINER							
						TOTAL DEPTH	9592

PACKER @ \_\_\_\_\_ BRAND & TYPE \_\_\_\_\_ PLUG @ \_\_\_\_\_ TYPE \_\_\_\_\_ PLUG @ \_\_\_\_\_ TYPE \_\_\_\_\_  
PACKER @ \_\_\_\_\_ BRAND & TYPE \_\_\_\_\_ PLUG @ \_\_\_\_\_ TYPE \_\_\_\_\_ PLUG @ \_\_\_\_\_ TYPE \_\_\_\_\_

COMPLETION & TEST DATA BY PRODUCING FORMATION

FORMATION	TONKAWA						Monitor
SPACING & SPACING ORDER NUMBER	640 AC	115709					Report to Red Focus
CLASS: Oil, Gas, Dry, Inj, Disp, Comm Disp, Svc	OIL						
PERFORATED INTERVALS	9141-56,9160-64,9169-71,9177-91						
	9196-98,9202-09,9221-27,9231-50						
	9260-66						
ACID/VOLUME	5000 GAL. 10% HCL, 3% HF, 3% CITRIC ACID						
FRACTURE TREATMENT (Fluids/Prop Amounts)	4382 BBL. 25# X-LINK GELLED 4% KCL						
	250,000 LBS 20/40 OTTAWA SAND						

Min Gas Allowable (165:10-17-7)

Gas Purchaser/Measurer

ENBRIDGE PIPELINE



OR

First Sales Date

3-7-17

INITIAL TEST DATA

Oil Allowable (165:10-13-3)

INITIAL TEST DATE	3-10-17						
OIL-BBL/DAY	15						
OIL-GRAVITY ( API)	40						
GAS-MCF/DAY	20						
GAS-OIL RATIO CU FT/BBL	1333 : 1						
WATER-BBL/DAY	32						
PUMPING OR FLOWING	PUMPING						
INITIAL SHUT-IN PRESSURE	1500#						
CHOKE SIZE							
FLOW TUBING PRESSURE							

AS SUBMITTED

A record of the formations drilled through, and pertinent remarks are presented on the reverse. I declare that I have knowledge of the contents of this report and am authorized by my organization to make this report, which was prepared by me or under my supervision and direction, with the data and facts stated herein to be true, correct, and complete to the best of my knowledge and belief.

LEROY A. BUCK

3-11-17 405 789-7104

SIGNATURE

NAME (PRINT OR TYPE)

DATE

PHONE NUMBER

6001 N.W. 23RD

OKLA. CITY

OKLA. 73127

redlab5841@gmail.com

ADDRESS

CITY

STATE

ZIP

EMAIL ADDRESS

## FORMATION RECORD

LEASE NAME LUKE

WELL NO. 15-11

NAMES OF FORMATIONS	TOP
TOP VIRGIL WASH	8037
TOP DOUGLAS	8266
BASE DOUGLAS SAND	8357
DOUGLAS LIME	8607
TONKAWA MARKER	9077
TOP TONKAWA SAND	9138

FOR COMMISSION USE ONLY	
ITD on file	<input type="checkbox"/> YES <input type="checkbox"/> NO
APPROVED	DISAPPROVED
<div>2) Reject Codes</div> <div> <div></div> <div></div> <div></div> <div></div> <div></div> </div>	

Were open hole logs run? X yes no  
10-26-16 BOND LOG  
 Date Last log was run \_\_\_\_\_  
 Was CO<sub>2</sub> encountered? \_\_\_\_\_ yes X no at what depths? \_\_\_\_\_  
 Was H<sub>2</sub>S encountered? \_\_\_\_\_ yes X no at what depths? \_\_\_\_\_  
 Were unusual drilling circumstances encountered? \_\_\_\_\_ yes X no  
 If yes, briefly explain below \_\_\_\_\_

Other remarks:

640 Acres

A 10x10 grid representing 640 acres. The grid is divided into four 5x5 quadrants by a thick black cross. The top-left quadrant is shaded light blue, and the bottom-right quadrant is shaded light green. The top-right and bottom-left quadrants are white.

Direction must be stated in degrees azimuth.  
Please note, the horizontal drainhole and its end point must be located within the boundaries of the lease or spacing unit.

640 Acres

**GAS RULES**

**BOTTOM HOLE LOCATION FOR DIRECTIONAL HOLE**

SEC	TWP	RGE	COUNTY
Spot Location			
1/4	1/4	1/4	1/4
Measured Total Depth		True Vertical Depth	Feet From 1/4 Sec Lines
			FSL
		FWL	
BHL From Lease, Unit, or Property Line:			

**BOTTOM HOLE LOCATION FOR HORIZONTAL HOLE: (LATERALS)**

**LATERAL #1**

SEC	TWP	RGE	COUNTY			
Spot Location				Feet From 1/4 Sec Lines	FSL	FWL
1/4	1/4	1/4	1/4			
Depth of Deviation		Radius of Turn	Direction	Total Length		
Measured Total Depth		True Vertical Depth	BHL From Lease, Unit, or Property Line:			

**LATERAL #2**

SEC	TWP	RGE	COUNTY			
Spot Location						
1/4	1/4	1/4	1/4	Feet From 1/4 Sec Lines	FSL	FWL
Depth of Deviation		Radius of Turn		Direction	Total Length	
Measured Total Depth		True Vertical Depth		BHL From Lease, Unit, or Property Line:		

**LATERAL #3**

SEC	TWP	RGE	COUNTY			
Spot Location				Feet From 1/4 Sec Lines	FSL	FWL
1/4	1/4	1/4	1/4			
Depth of Deviation		Radius of Turn	Direction	Total Length		
Measured Total Depth		True Vertical Depth	BHL From Lease, Unit, or Property Line:			