

Oklahoma Corporation Commission  
Oil & Gas Conservation Division  
Post Office Box 52000  
Oklahoma City, Oklahoma 73152-2000  
Rule 165: 10-3-25

Form 1002A

API No.: 35017249410000

**Completion Report**

Spud Date: November 22, 2016

OTC Prod. Unit No.: 017218457

Drilling Finished Date: December 25, 2016

1st Prod Date: February 14, 2017

Completion Date: January 30, 2017

**Drill Type: HORIZONTAL HOLE**

Min Gas Allowable: Yes

Well Name: JOHNSTON 31-12-7 1H

Purchaser/Measurer: CHESAPEAKE OPERATING LLC

Location: CANADIAN 31 12N 7W  
SW SW SE SE  
266 FSL 1180 FEL of 1/4 SEC  
Derrick Elevation: 1407 Ground Elevation: 1382

First Sales Date: 02/14/2017

Operator: CHESAPEAKE OPERATING LLC 17441  
PO BOX 18496  
6100 N WESTERN AVE  
OKLAHOMA CITY, OK 73154-0496

Completion Type		Location Exception		Increased Density	
X	Single Zone	Order No		Order No	
	Multiple Zone	661645		656076	
	Commingled	661646		656077	

Casing and Cement								
Type		Size	Weight	Grade	Feet	PSI	SAX	Top of CMT
SURFACE		9 5/8	36	J-55	1508		749	SURFACE
PRODUCTION		5 1/2	20	P-110	20292		2525	5698

Liner								
Type	Size	Weight	Grade	Length	PSI	SAX	Top Depth	Bottom Depth
There are no Liner records to display.								

**Total Depth: 20292**

Packer		Plug	
Depth	Brand & Type	Depth	Plug Type
There are no Packer records to display.		20179	CIBP

Initial Test Data										
Test Date	Formation	Oil BBL/Day	Oil-Gravity (API)	Gas MCF/Day	Gas-Oil Ratio Cu FT/BBL	Water BBL/Day	Pumpin or Flowing	Initial Shut-In Pressure	Choke Size	Flow Tubing Pressure
Mar 06, 2017	MISSISSIPPIAN	449	58	5985	13330	1858	FLOWING	2460	44/64	1238

**Completion and Test Data by Producing Formation**

Formation Name: MISSISSIPPIAN

Code: 359MSSP

Class: OIL

**Spacing Orders**

Order No	Unit Size
155968	640
164795	640
661644	MULTIUNIT

**Perforated Intervals**

From	To
10290	20165

**Acid Volumes**

5,103 GALLONS HCL ACID

**Fracture Treatments**

464,078 BARRELS FRAC FLUID, 30,018,591 POUNDS PROPPANT

Formation	Top
MISSISSIPPIAN	10284

Were open hole logs run? No

Date last log run:

Were unusual drilling circumstances encountered? No

Explanation:

**Other Remarks**

There are no Other Remarks.

**Lateral Holes**

Sec: 30 TWP: 12N RGE: 7W County: CANADIAN

NW NE NE NE

50 FNL 429 FEL of 1/4 SEC

Depth of Deviation: 9716 Radius of Turn: 303 Direction: 357 Total Length: 10008

Measured Total Depth: 20292 True Vertical Depth: 10019 End Pt. Location From Release, Unit or Property Line: 50

**FOR COMMISSION USE ONLY**

1136181

Status: Accepted

API NO. 017-24941  
OTC PROD.  
UNIT NO. 017-218457

PLEASE TYPE OR USE BLACK INK ONLY  
NOTE:  
Attach copy of original 1002A if recompletion or reentry.

OKLAHOMA CORPORATION COMMISSION  
Oil & Gas Conservation Division  
Post Office Box 52000  
Oklahoma City, Oklahoma 73152-2000  
Rule 165-10-3-25

Form 1002A  
12/28/2009  
**RECEIVED**

MAR 10 2017

☒ ORIGINAL  
☐ AMENDED  
Reason Amended

TYPE OF DRILLING OPERATION  
☐ STRAIGHT HOLE ☐ DIRECTIONAL HOLE ☒ HORIZONTAL HOLE  
SERVICE WELL

If directional or horizontal, see reverse for bottom hole location.

COUNTY CANADIAN SEC 31 TWP 12N RGE 7W  
LEASE NAME JOHNSTON 31-12-7  
SW 1/4 SE 1/4 SE 1/4 SE 1/4 FSL 266 FEL OF 1/4 SEC 1,180  
ELEVATION  
Derrick Ft 1,407 Ground 1,382  
OPERATOR NAME CHESAPEAKE OPERATING, L.L.C. OTC/OCC OPERATOR NO. 17441  
ADDRESS P.O. BOX 18496  
CITY OKLAHOMA CITY STATE OK ZIP 73154

COMPLETION REPORT

SPUD DATE 11/22/2016  
DRLG FINISHED DATE 12/25/2016  
DATE OF WELL COMPLETION 1/30/2017  
1ST PROD DATE 2/14/2017  
RECOMP DATE  
Longitude (if Known)

OKLAHOMA CORPORATION COMMISSION  
640 Acres

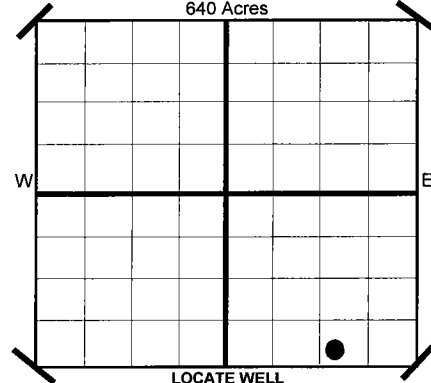

COMPLETION TYPE

☒ SINGLE ZONE  
☐ MULTIPLE ZONE  
Application Date  
COMINGLED  
Application Date  
LOCATION  
EXCEPTION ORDER NO. 661645/661646/661647  
INCREASED DENSITY  
ORDER NO. 656076/656077

CASING & CEMENT (Form 1002C must be attached)

TYPE	SIZE	WEIGHT	GRADE	FEET	PSI	SAX	TOP
CONDUCTOR							
SURFACE	9 5/8"	36#	J-55	1,508		749	SURFACE
INTERMEDIATE							
PRODUCTION	5 1/2"	20#	P-110	20,292		2,525	5,698
LINER							

PACKER @ N/A BRAND & TYPE  
PACKER @ BRAND & TYPE  
PLUG @ TYPE  
PLUG @ TYPE  
PLUG @ 20,179 TYPE CIBP  
TOTAL DEPTH 20,292

COMPLETION & TEST DATA BY PRODUCING FORMATION

FORMATION	MISSISSIPPIAN	MULTI-UNIT					
SPACING & SPACING ORDER NUMBER	640 164795/155968	640 164795/155968					
CLASS: Oil, Gas, Dry, Inj. Disp, Comm Disp, Svc	OIL						
PERFORATED INTERVALS	10,290-20,165						
ACID/VOLUME	HCL Acid 5103 GALS						
FRACTURE TREATMENT (Fluids/Prop Amounts)	Frac Fluid 464,078 BBLS Proppant 30,018,591 LBS						

Minimum Gas Allowable (165-10-17-7) Gas Purchaser/Measurer Chesapeake Operating, L.L.C.  
OR  
Oil Allowable (165-10-13-3) 1st Sales Date 2/14/2017

INITIAL TEST DATA

INITIAL TEST DATE	3/6/2017						
OIL-BBL/DAY	449						
OIL-GRAVITY ( API)	58						
GAS-MCF/DAY	5,985						
GAS-OIL RATIO CU FT/BBL	13,330						
WATER-BBL/DAY	1858						
PUMPING OR FLOWING	FLOWING						
INITIAL SHUT-IN PRESSURE	2,460						
CHOKE SIZE	44/64						
FLOW TUBING PRESSURE	1238						

**AS SUBMITTED**

A record of the formations drilled through, and pertinent remarks are presented on the reverse. I declare that I have knowledge of the contents of this report and am authorized by my organization to make this report, which was prepared by me or under my supervision and direction, with the data and facts stated herein to be true, correct, and complete to the best of my knowledge and belief.

JP Powell, Sr. Regulatory Analyst  
SIGNATURE  
NAME (PRINT OR TYPE)  
R.O. BOX 18496  
ADDRESS  
OKLAHOMA CITY  
CITY  
OK  
STATE  
73154  
ZIP  
3/9/2017  
DATE  
405-848-8000  
PHONE NUMBER  
jp.powell@chk.com  
EMAIL ADDRESS

Give formation names and tops, if available, or descriptions and thickness of formations drilled through. Show intervals cored or drillstem tested.

WELL NO. 1H

NAMES OF FORMATIONS	TOP
MISSISSIPPIAN	10,284

FOR COMMISSION USE ONLY	
ITD on file	<input type="checkbox"/> YES <input type="checkbox"/> NO
APPROVED	DISAPPROVED
	2) Reject Codes <hr/> <hr/> <hr/> <hr/> <hr/>

Were open hole logs run?	_____ yes	<u>X</u> no
Date Last log was run	N/A	
Was CO <sub>2</sub> encountered?	_____ yes	<u>X</u> no at what depths?
Was H <sub>2</sub> S encountered?	_____ yes	<u>X</u> no at what depths?
Were unusual drilling circumstances encountered?	_____ yes	<u>X</u> no
If yes, briefly explain.		

Other remarks:

640 Acres

**If more than three drainholes are proposed, attach a separate sheet indicating the necessary information.**

Direction must be stated in degrees azimuth.  
Please note, the horizontal drainhole and its end  
point must be located within the boundaries of the  
lease or spacing unit.

**Directional surveys are required for all drainholes and directional wells.**  
640 Acres

SEC	TWP	RGE	COUNTY
Spot Location	1/4	1/4	1/4
Measured Total Depth	True Vertical Depth	Feet From 1/4 Sec Lines	FSL
		FWL	
BHL From Lease, Unit, or Property Line:			

LATERAL #1							
SEC	30	TWP	12N	RGE	7W	COUNTY CANADIAN	
Spot Location		NW 1/4		NE 1/4		NE 1/4	
Feet From 1/4 Sec Lines		FNL 50		FEL 429			
Depth of Deviation		9,716		Radius of Turn 303		Direction 357	
Measured Total Depth		20,292		True Vertical Depth 10,019		Total Length 10,008	
						BHL From Lease, Unit, or Property Line: 50	

SEC	TWP	RGE	COUNTY			
Spot Location				Feet From 1/4 Sec Lines	FSL	FWL
1/4	1/4	1/4	1/4			
Depth of Deviation		Radius of Turn	Direction	Total Length		
Measured Total Depth		True Vertical Depth	BHL From Lease, Unit, or Property Line:			

SEC	TWP	RGE	COUNTY			
Spot Location				Feet From 1/4 Sec Lines	FSL	FWL
1/4	1/4	1/4	1/4			
Depth of Deviation		Radius of Turn		Direction	Total Length	
Measured Total Depth		True Vertical Depth		BHL From Lease, Unit, or Property Line:		

CANADIAN County, Oklahoma

266° FSL - 1180° FEL Section 31 Township 12N Range 7W I.M.

35.493402° N  
97.972279° W  
X= 2008253.3  
Y= 179605.3

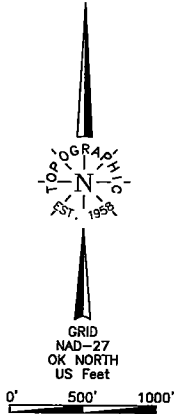

35.493455° N  
97.989875° W  
X= 2003014.9  
Y= 179623.8

35.493429° N  
97.981128° W  
X= 2005618.9  
Y= 179614.7

BOTTOM HOLE  
(20292' MD)  
50° FNL - 429° FEL  
35° 29' 35.6" N  
97° 58' 25.4" W  
35.493268° N  
97.973719° W  
X= 2007824.6  
Y= 179556.8

BOTTOM PERF.  
(20185' MD)  
177° FNL - 422° FEL  
35.492920° N  
97.973897° W  
X= 2007831.2  
Y= 179430.0

EXISTING WELL  
MATHIES 30-2  
35.487804° N  
97.974298° W  
X= 2007652.7  
Y= 177587.5

35.486175° N  
97.972283° W  
X= 2008252.7  
Y= 176974.6

SECTION LINE  
(15076.9' MD)  
DEPTH = 10042.1'

35.478961° N  
97.981136° W  
X= 2005617.5  
Y= 174348.2

35.478952° N  
97.972287° W  
X= 2008252.4  
Y= 174345.5

35.471728° N  
97.972283° W  
X= 2008254.2  
Y= 171716.2

PENETRATION POINT  
(10284' MD)  
482° FSL - 453° FEL  
35.468006° N  
97.973822° W  
X= 2007796.7  
Y= 169560.3

TOP PERF.  
(10290' MD)  
488° FSL - 453° FEL  
35.465822° N  
97.973822° W  
X= 2007797.0  
Y= 169566.2

TOP PERF.  
PENETRATION POINT

35.464489° N  
97.981133° W  
X= 2005618.9  
Y= 169080.6

35.464500° N  
97.989942° W  
X= 2002998.1  
Y= 169084.0

35.464479° N  
97.972305° W  
X= 2008248.4  
Y= 169077.5

Operator: CHESAPEAKE OPERATING, L.L.C.  
Lease Name: JOHNSTON 31-12-7  
Topography & Vegetation Loc. fell in out field, ±236' North of E-W fence  
Good Drill Site? Yes  
Reference Stakes or Alternate Location Stakes Set None  
Best Accessibility to Location From South off county road  
Distance & Direction From Hwy Jct. or Town From Jct. I-40 E-W and US Hwy. 81 N-S, go ±2.5 mi. South on US Hwy. 81, then ±2.0 mi. West to the SE Cor. of Sec. 31-T12N-R7W.  
Well No.: 1H  
ELEVATION: 1382' Gr. at Stake

DATUM: NAD-27  
LAT: 35°27'54.8"N  
LONG: 97°58'34.6"W  
LAT: 35.465215° N  
LONG: 97.976266° W  
STATE PLANE  
COORDINATES: (US Feet)  
ZONE: OK NORTH  
X: 2007068.8  
Y: 169345.0

269595 Date of Drawing: Feb. 11, 2017  
Invoice # 260745 Date Staked: May 24, 2016

JP

## FINAL AS-DRILLED PLAT

AS-DRILLED INFORMATION  
FURNISHED BY CHESAPEAKE OPERATING, L.L.C.