

Oklahoma Corporation Commission
Oil & Gas Conservation Division
Post Office Box 52000
Oklahoma City, Oklahoma 73152-2000
Rule 165: 10-3-25

Form 1002A

API No.: 35071248260000

Completion Report

Spud Date: December 02, 2014

OTC Prod. Unit No.:

Drilling Finished Date: December 10, 2014

1st Prod Date:

Completion Date: March 13, 2017

Drill Type: STRAIGHT HOLE

Well Name: DAN 3-16

Purchaser/Measurer:

Location: KAY 16 25N 1E
C NW NW NE
330 FNL 2310 FEL of 1/4 SEC
Latitude: 36.65108 Longitude: -97.20027
Derrick Elevation: 981 Ground Elevation: 968

First Sales Date:

Operator: AEXCO PETROLEUM INC 17342

1675 BROADWAY STE 1900
DENVER, CO 80202-4631

Completion Type	
<input type="checkbox"/>	Single Zone
<input type="checkbox"/>	Multiple Zone
<input type="checkbox"/>	Commingled

Location Exception	
Order No	
There are no Location Exception records to display.	

Increased Density	
Order No	
There are no Increased Density records to display.	

Casing and Cement							
Type	Size	Weight	Grade	Feet	PSI	SAX	Top of CMT
CONDUCTOR	20	67		43			SURFACE
SURFACE	8 5/8	24	J-55	427		205	SURFACE
PRODUCTION	5 1/2	17	J-55	4580		275	2562

Liner								
Type	Size	Weight	Grade	Length	PSI	SAX	Top Depth	Bottom Depth
There are no Liner records to display.								

Total Depth: 4600

Packer	
Depth	Brand & Type
There are no Packer records to display.	

Plug	
Depth	Plug Type
There are no Plug records to display.	

Initial Test Data

Test Date	Formation	Oil BBL/Day	Oil-Gravity (API)	Gas MCF/Day	Gas-Oil Ratio Cu FT/BBL	Water BBL/Day	Pumpin or Flowing	Initial Shut- In Pressure	Choke Size	Flow Tubing Pressure
There are no Initial Data records to display.										

Completion and Test Data by Producing Formation										
Formation Name: NONE				Code:			Class: TA			

Formation	Top
PAWHUSKA	1830
HOOVER	1920
BASE OF WILDHORSE	2460
HASKELL	2520
TONKAWA	2540
LAYTON (COTTAGE GROVE)	3160
HOGSHOOTER	3370
CHECKERBOARD	3490
BIG LIME	3670
OSWEGO	3720
RED FORK	4050
MISSISSIPPIAN	4220

Were open hole logs run? Yes

Date last log run: December 09, 2014

Were unusual drilling circumstances encountered? No

Explanation:

Other Remarks
There are no Other Remarks.

FOR COMMISSION USE ONLY	
Status: Accepted	1136195

RECEIVED

Form 1002A
Rev. 2009

MAR 13 2017

OKLAHOMA CORPORATION COMMISSION

API NO. 071-24826
OTC PROD.
UNIT NO.

PLEASE TYPE OR USE BLACK INK ONLY

NOTE:

Attach copy of original 1002A
If recompletion or reentry.

OKLAHOMA CORPORATION COMMISSION
Oil & Gas Conservation Division
Post Office Box 52000
Oklahoma City, Oklahoma 73152-2000
Rule 165:10-3-25

☒ ORIGINAL
☐ AMENDED (Reason)

TA

COMPLETION REPORT

TYPE OF DRILLING OPERATION

☒ STRAIGHT HOLE ☐ DIRECTIONAL HOLE ☐ HORIZONTAL HOLE
☐ SERVICE WELL

If directional or horizontal, see reverse for bottom hole location.

COUNTY	KAY	SEC	16	TWP	25N	RGE	1E	SPUD DATE	12/2/2014
LEASE NAME	DAN			WELL NO.	3-16			DRLG FINISHED DATE	12/10/2014
C	1/4 NW 1/4 NW 1/4 NE 1/4	FNL OF 1/4 SEC	330	FEL OF 1/4 SEC	2310			DATE OF WELL COMPLETION	3-13-2017
ELEVATION	981		Ground	968	Latitude (if known)	36.65108		1st PROD DATE	
FL					Longitude (if known)	-97.20027		RECOMP DATE	
OPERATOR NAME	AEXCO PETROLEUM, INC				OTC/OCC OPERATOR NO.	17342			
ADDRESS	1675 BROADWAY, STE 1900								
CITY	DENVER			STATE	CO	ZIP	80202		

Date 1003H Approved

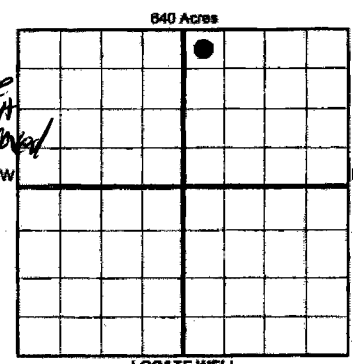

COMPLETION TYPE

SINGLE ZONE	not completed
MULTIPLE ZONE	
Application Date	
COMINGLED	
Application Date	
LOCATION	
EXCEPTION ORDER	
INCREASED DENSITY	
ORDER NO.	

CASING & CEMENT (Form 1002C must be attached)

TYPE	SIZE	WEIGHT	GRADE	FEET	PSI	SAX	TOP OF CMT
CONDUCTOR	20"	67		43			SURFACE
SURFACE	8 5/8"	24	J-55	427		205	SURFACE
INTERMEDIATE							
PRODUCTION	5 1/2"	17	J-55	4,580		275	2,562
LINER							
						TOTAL DEPTH	4,600

PACKER @ BRAND & TYPE PLUG @ TYPE PLUG @ TYPE
PACKER @ BRAND & TYPE PLUG @ TYPE PLUG @ TYPE

COMPLETION & TEST DATA BY PRODUCING FORMATION

FORMATION							
SPACING & SPACING ORDER NUMBER							
CLASS: Oil, Gas, Dry, Int, Disp, Comm Disp, Svc	TA						
PERFORATED INTERVALS							
ACID VOLUME							
FRACTURE TREATMENT (Fluids/Prop Amounts)							

☐ Min Gas Allowable (165:10-17-7) OR Gas Purchaser/Measurer First Sales Date
☐ Oil Allowable (165:10-13-3)

INITIAL TEST DATA

INITIAL TEST DATE							
OIL-BBL/DAY							
OIL-GRAVITY (API)							
GAS-MCF/DAY							
GAS-OIL RATIO CU FT/BBL							
WATER-BBL/DAY							
PUMPING OR FLOWING							
INITIAL SHUT-IN PRESSURE							
CHOKE SIZE							
FLOW TUBING PRESSURE							

AS SUBMITTED

A record of the formations drilled through, and pertinent remarks are presented on the reverse. I declare that I have knowledge of the contents of this report and am authorized by my organization to make this report, which was prepared by me or under my supervision and direction, with the data and facts stated herein to be true, correct, and complete to the best of my knowledge and belief.

SIGNATURE	NAME (PRINT OR TYPE)	DATE	PHONE NUMBER
1675 Broadway, STE 1900	Nicolas Ricca	3/7/2017	303-863-1110
ADDRESS	CITY	STATE	ZIP
	Denver	CO	80202
			EMAIL ADDRESS
			engineering@aexco.net

FORMATION RECORD

LEASE NAME

WELL NO.

NAMES OF FORMATIONS	TOP (MD)
SEE "OTHER REMARKS" BELOW	
Pawhuska	1,830
Hoover	1,920
Base of Wildhorse	2,460
Haskell	2,520
Tonkawa	2,540
Layton (Cottoge Grove)	3,160
Hogshooter	3,370
Checkerboard	3,490
Big Lime	3,670
Oswego	3,720
Red Fork	4,050
Mississippian	4,220

FOR COMMISSION USE ONLY	
ITD on file	<input type="checkbox"/> YES <input type="checkbox"/> NO
APPROVED	DISAPPROVED
2) Reject Codes	

Were open hole logs run? X yes no

Date Last log was run 12/9/2014

Was CO₂ encountered? yes X no at what depths?

Was H₂S encountered? yes X no at what depths?

Were unusual drilling circumstances encountered? yes X no
If yes, briefly explain below

Other estimates:

640 Acres

Direction must be stated in degrees azimuth.
Please note, the horizontal drainhole and its end
point must be located within the boundaries of the
lease or spacing unit.

640 Acres

BOTTOM HOLE LOCATION FOR DIRECTIONAL HOLE

SEC	TWP	RGE	COUNTY
Spot Location			
1/4	1/4	1/4	1/4
Measured Total Depth		True Vertical Depth	BHL From Lease, Unit, or Property Line:

BOTTOM HOLE LOCATION FOR HORIZONTAL HOLE: (LATERALS)

LATERAL #1						
SEC	TWP	RGE	COUNTY			
Spot Location						
1/4		1/4	1/4	Feet From 1/4 Sec Lines		FNL
Depth of Deviation		Radius of Turn		Direction		Total Length
Measured Total Depth		True Vertical Depth		BHL From Lease, Unit, or Property Line:		

LATERAL #2

SEC	TWP	RGE	COUNTY
Spot Location			
1/4	1/4	1/4	1/4
Feet From 1/4 Sec Lines		FSL	FWL
Depth of Deviation	Radius of Turn	Direction	Total Length
Measured Total Depth	True Vertical Depth	BHL From Lease, Unit, or Property Line:	

LATERAL #3

SEC	TWTP	RGE	COUNTY
Spot Location			
1/4	1/4	1/4	1/4
Feet From 1/4 Sec Lines		FSL	FWL
Depth of Deviation	Radius of Turn	Direction	Total Length
Measured Total Depth	True Vertical Depth	BHL From Lease, Unit, or Property Line:	