

Oklahoma Corporation Commission  
Oil & Gas Conservation Division  
Post Office Box 52000  
Oklahoma City, Oklahoma 73152-2000  
Rule 165: 10-3-25

Form 1002A

API No.: 35103247220000

**Completion Report**

Spud Date: October 13, 2016

OTC Prod. Unit No.:

Drilling Finished Date: November 03, 2016

1st Prod Date: February 26, 2017

Completion Date: February 01, 2017

**Drill Type: HORIZONTAL HOLE**

Min Gas Allowable: Yes

Well Name: TUBBS 1-12H

Purchaser/Measurer: ENERGY TRANSFER

Location: NOBLE 12 20N 2W  
SE SW SW  
109 FSL 578 FWL of 1/4 SEC  
Derrick Elevation: 1147 Ground Elevation: 1132

First Sales Date: 03/08/2017

Operator: BLAKE PRODUCTION COMPANY INC 18119

1601 NW EXPRESSWAY STE 777  
OKLAHOMA CITY, OK 73118-1446

Completion Type		Location Exception		Increased Density	
X	Single Zone	Order No		Order No	
	Multiple Zone	660626		There are no Increased Density records to display.	
	Commingled				

Casing and Cement							
Type	Size	Weight	Grade	Feet	PSI	SAX	Top of CMT
SURFACE	9 5/8	36	J-55	295		205	SURFACE
PRODUCTION	7	26	J-55	4935		340	3877

Liner								
Type	Size	Weight	Grade	Length	PSI	SAX	Top Depth	Bottom Depth
LINER	4 1/2	11.6	P-110	4725	0	366	4557	9282

**Total Depth: 9282**

Packer	
Depth	Brand & Type
There are no Packer records to display.	

Plug	
Depth	Plug Type
There are no Plug records to display.	

Initial Test Data										
Test Date	Formation	Oil BBL/Day	Oil-Gravity (API)	Gas MCF/Day	Gas-Oil Ratio Cu FT/BBL	Water BBL/Day	Pumpin or Flowing	Initial Shut-In Pressure	Choke Size	Flow Tubing Pressure
Feb 26, 2017	BIG LIME	1				672	PUMPING	40		

Completion and Test Data by Producing Formation			
Formation Name: BIG LIME		Code: 404BGLM	Class: OIL
<b>Spacing Orders</b>		<b>Perforated Intervals</b>	
<b>Order No</b>	<b>Unit Size</b>	<b>From</b>	<b>To</b>
656096	640	5010	9015
<b>Acid Volumes</b>		<b>Fracture Treatments</b>	
17,500 GALLONS 15% HCL, 28,500 GALLONS 7.5% HCL, 50 BARRELS 15% NEFE		75,003 BARRELS SLICKWATER, 395,150 POUNDS 30/50 SAND, 430,945 POUNDS 12/20 SAND, 339,607 POUNDS 16/30 SAND	

Formation	Top
CHECKERBOARD	4455
CLEVELAND	4479
BIG LIME	4586

Were open hole logs run? Yes  
Date last log run: November 01, 2016  
  
Were unusual drilling circumstances encountered? No  
Explanation:

Other Remarks
OCC - THIS DOCUMENT IS APPROVED DESPITE ERRORS IN FINAL LOCATION EXCEPTION WE ASKED THE OPERATOR TO GET IT FIXED.

Lateral Holes
Sec: 12 TWP: 20N RGE: 2W County: NOBLE  NW NW NW  2377 FSL 615 FWL of 1/4 SEC  Depth of Deviation: 4025 Radius of Turn: 580 Direction: 360 Total Length: 4347  Measured Total Depth: 9282 True Vertical Depth: 4600 End Pt. Location From Release, Unit or Property Line: 546

FOR COMMISSION USE ONLY	
Status: Accepted	1136191

API NO. 3510324722  
OTC PROD.  
UNIT NO.

PLEASE TYPE OR USE BLACK INK ONLY  
NOTE:

Attach copy of original 1002A  
if recompletion or reentry.

OKLAHOMA CORPORATION COMMISSION  
Oil & Gas Conservation Division  
Post Office Box 52000  
Oklahoma City, Oklahoma 73152-2000  
Rule 165:10-3-25

RECEIVED

MAR 13 2017

OKLAHOMA CORPORATION  
COMMISSION

Form 1002A  
Rev. 2009

☒ ORIGINAL  
☐ AMENDED (Reason)

COMPLETION REPORT

TYPE OF DRILLING OPERATION

☐ STRAIGHT HOLE ☐ DIRECTIONAL HOLE ☒ HORIZONTAL HOLE  
SERVICE WELL

If directional or horizontal, see reverse for bottom hole location.

COUNTY	Noble	SEC	12	TWP	20N	RGE	2W	SPUD DATE	10/13/2016	
LEASE NAME	Tubbs			WELL NO.	1-12H			DRLG FINISHED DATE	11/3/2016	
SE 1/4 SW 1/4 SW 1/4 SW 1/4	FSL OF 1/4 SEC	109	FWL OF 1/4 SEC	578	DATE OF WELL COMPLETION	2/1/2017			1st PROD DATE	2/26/2017
ELEVATION Derrick FL	1147	Ground	1132	Latitude (if known)				RECOMP DATE		
OPERATOR NAME	Blake Production Company, Inc				OTC/OCC OPERATOR NO.	18119				
ADDRESS	1601 NW Expressway Ste 777									
CITY	Oklahoma City			STATE	OK	ZIP	73118			

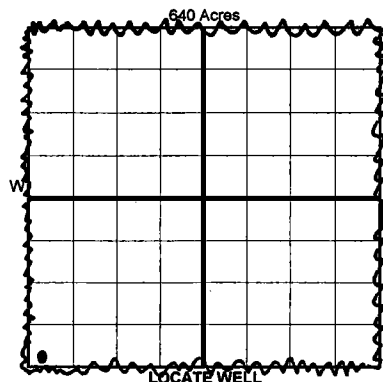

COMPLETION TYPE

<input checked="" type="checkbox"/> SINGLE ZONE
<input type="checkbox"/> MULTIPLE ZONE
Application Date
<input type="checkbox"/> COMMINGLED
Application Date
LOCATION
EXCEPTION ORDER
INCREASED DENSITY
ORDER NO.

CASING & CEMENT (Form 1002C must be attached)

TYPE	SIZE	WEIGHT	GRADE	FEET	PSI	SAX	TOP OF CMT
CONDUCTOR							
SURFACE	9 5/8"	36#	J-55	295'		205	surface
INTERMEDIATE							
PRODUCTION	7"	26#	J-55	4935'		340	3877
LINER	4 1/2"	11.6#	P110	4557- 9282		366	4,725
							9,282

PACKER @ \_\_\_\_\_ BRAND & TYPE none PLUG @ \_\_\_\_\_ TYPE \_\_\_\_\_ PLUG @ \_\_\_\_\_ TYPE \_\_\_\_\_  
PACKER @ \_\_\_\_\_ BRAND & TYPE \_\_\_\_\_ PLUG @ \_\_\_\_\_ TYPE \_\_\_\_\_ PLUG @ \_\_\_\_\_ TYPE \_\_\_\_\_

TOTAL DEPTH

COMPLETION & TEST DATA BY PRODUCING FORMATION

FORMATION	Big Lime					
SPACING & SPACING ORDER NUMBER	656096 - 640					
CLASS: Oil, Gas, Dry, Inj, Disp, Comm Disp, Svc	oil					
PERFORATED INTERVALS	9015'-8990'	8804'-8834'	8460'-8504'	8104'-8064'	7774'-7842'	7448'-7484'
	7210'-7286'	6922'-7087'	6621'-6718'	6422'-6456'	6068'-6098'	5663'-5696'
	5338'-5420'	5102'-5138'	5010'-5028'			
ACID/VOLUME	17,500 Gallons	15% HCl	28,500 Gallons	7.5% HCl	50 bbls	15%NeFe
FRACTURE TREATMENT (Fluids/Prop Amounts)	75,003 bbl slickwater	395,150 lbs	30/50 sand			
		430,945 lbs	12/20 sand			
		339,607 lbs	16/30 sand			

Monitor Report  
to Frac Focus

Min Gas Allowable (165:10-17-7) Gas Purchaser/Measurer  
OR First Sales Date  
Oil Allowable (165:10-13-3) Energy Transfer  
3/8/2017

INITIAL TEST DATA

INITIAL TEST DATE	2/26/2017					
OIL-BBL/DAY	1					
OIL-GRAVITY ( API)						
GAS-MCF/DAY	TSTM					
GAS-OIL RATIO CU FT/BBL	n/a					
WATER-BBL/DAY	672					
PUMPING OR FLOWING	pumping					
INITIAL SHUT-IN PRESSURE	40 psi					
CHOKE SIZE						
FLOW TUBING PRESSURE						

AS SUBMITTED

A record of the formations drilled through, and pertinent remarks are presented on the reverse. I declare that I have knowledge of the contents of this report and am authorized by my organization to make this report, which was prepared by me or under my supervision and direction, with the data and facts stated herein to be true, correct, and complete to the best of my knowledge and belief.

Signature: Renee Coon NAME (PRINT OR TYPE) RENE E COON  
1601 NW Expressway Ste 777 Oklahoma City OK 73118 3/8/2017 405-286-9800  
ADDRESS CITY STATE ZIP DATE PHONE NUMBER  
renee.coon@blakeproduction.com EMAIL ADDRESS

## FORMATION RECORD

LEASE NAME TUBBS WELL NO. 1-12H

NAMES OF FORMATIONS	TOP
Checkerboard	4455'
Cleveland	4479'
Big Lime	4586'

FOR COMMISSION USE ONLY	
ITD on file <input type="checkbox"/> YES <input type="checkbox"/> NO	
APPROVED                      DISAPPROVED	2) Reject Codes

Were open hole logs run? X yes      no

Date Last log was run 11/1/2016

Was CO<sub>2</sub> encountered?      yes X no at what depths?                     

Was H<sub>2</sub>S encountered?      yes X no at what depths?                     

Were unusual drilling circumstances encountered?      yes X no

If yes, briefly explain below

640 Acres

640 Acres

A 10x10 grid representing 640 acres. The grid is divided into four 4x4 quadrants by a thick vertical line after the 4th column and a thick horizontal line after the 4th row. The text '640 Acres' is centered at the top of the grid.

SEC	TWP	RGE	COUNTY		
Spot Location			Feet From 1/4 Sec Lines	FSL	FWL
1/4	1/4	1/4	1/4		
Measured Total Depth		True Vertical Depth	BHL From Lease, Unit, or Property Line:		

LATERAL #1									
SEC 12	TWP 20N	RGE 2W	COUNTY Noble						
Spot Location NW 1/4 NW 1/4 NW 1/4 1/4				Feet From 1/4 Sec Lines		FSL 2377		FWL 615	
Depth of Deviation 4,025		Radius of Turn 580		Direction 360		Total Length 4,347			
Measured Total Depth 9,282		True Vertical Depth 4,600		BHL From Lease, Unit, or Property Line: 546' FNL, 638' FWL					

SEC	TWP	RGE	COUNTY			
Spot Location				Feet From 1/4 Sec Lines	FSL	FWL
1/4	1/4	1/4	1/4			
Depth of Deviation		Radius of Turn	Direction	Total Length		
Measured Total Depth		True Vertical Depth	BHL From Lease, Unit, or Property Line:			

SEC	TWP	RGE	COUNTY			
Spot Location				Feet From 1/4 Sec Lines	FSL	FWL
1/4	1/4	1/4	1/4			
Depth of Deviation		Radius of Turn	Direction	Total Length		
Measured Total Depth		True Vertical Depth	BHL From Lease, Unit, or Property Line:			