

Oklahoma Corporation Commission  
Oil & Gas Conservation Division  
Post Office Box 52000  
Oklahoma City, Oklahoma 73152-2000  
Rule 165: 10-3-25

Form 1002A

API No.: 35151243120002

**Completion Report**

Spud Date: December 22, 2014

OTC Prod. Unit No.: 151-218114

Drilling Finished Date: January 02, 2015

1st Prod Date: November 19, 2016

Completion Date: October 27, 2016

**Amended**

Amend Reason: CHANGE WELL NAME AND UPDATE LOCATION EXCEPTION ORDER NUMBER

**Drill Type: HORIZONTAL HOLE**

Min Gas Allowable: Yes

Well Name: HICKMAN USA 12-28-17 (HICKMAN 12-28-17 1H) 1H

Purchaser/Measurer: CHESAPEAKE OPERATING LLC

Location: WOODS 12 28N 17W  
NW NE NW NW  
280 FNL 770 FWL of 1/4 SEC  
Derrick Elevation: 1913 Ground Elevation: 1891

First Sales Date: 11/19/2016

Operator: CHESAPEAKE OPERATING LLC 17441  
PO BOX 18496  
6100 N WESTERN AVE  
OKLAHOMA CITY, OK 73154-0496

Completion Type	
X	Single Zone
	Multiple Zone
	Commingled

Location Exception	
Order No	
661365	

Increased Density	
Order No	
634362	

Casing and Cement							
Type	Size	Weight	Grade	Feet	PSI	SAX	Top of CMT
SURFACE	13 3/8	48	J-55	467		2142	SURFACE
INTERMEDIATE	9 5/8	36	J-55	1223		336	SURFACE
PRODUCTION	7	26	P-110	5806		233	4322

Liner								
Type	Size	Weight	Grade	Length	PSI	SAX	Top Depth	Bottom Depth
LINER	4 1/2	11.6	P-110	4596	0	531	5651	10247

**Total Depth: 10250**

Packer	
Depth	Brand & Type
5584	AS-3

Plug	
Depth	Plug Type
There are no Plug records to display.	

Initial Test Data

Test Date	Formation	Oil BBL/Day	Oil-Gravity (API)	Gas MCF/Day	Gas-Oil Ratio Cu FT/BBL	Water BBL/Day	Pumpin or Flowing	Initial Shut-In Pressure	Choke Size	Flow Tubing Pressure
Dec 04, 2016	MISSISSIPPI	138		707	5123	729	ARTIFICIA			144

**Completion and Test Data by Producing Formation**

Formation Name: MISSISSIPPI

Code: 351MISS

Class: OIL

**Spacing Orders**

Order No	Unit Size
350439	640

**Perforated Intervals**

From	To
5720	10110

**Acid Volumes**

4,500 GALLONS ACID

**Fracture Treatments**

37,969 BARRELS FLUIDS, 196,505 POUNDS PROPPANT

Formation	Top
MISSISSIPPI	5677

Were open hole logs run? No

Date last log run:

Were unusual drilling circumstances encountered? No

Explanation:

**Other Remarks**

There are no Other Remarks.

**Lateral Holes**

Sec: 12 TWP: 28N RGE: 17W County: WOODS

SE SW SE SW

174 FSL 1930 FWL of 1/4 SEC

Depth of Deviation: 5180 Radius of Turn: 420 Direction: 168 Total Length: 4573

Measured Total Depth: 10250 True Vertical Depth: 5600 End Pt. Location From Release, Unit or Property Line: 174

**FOR COMMISSION USE ONLY**

1136124

Status: Accepted

API NO. 151-24312  
 OTC PROD.  
 UNIT NO. 151-218114

PLEASE TYPE OR USE BLACK INK ONLY  
 NOTE:  
 Attach copy of original 1002A if recompletion or reentry.

OKLAHOMA CORPORATION COMMISSION  
 Oil & Gas Conservation Division  
 Post Office Box 52000  
 Oklahoma City, Oklahoma 73152-2000  
 Rule 165:10-3-25

RECEIVED Form 1002A Rev. 2009

MAR 03 2017

ORIGINAL  
 AMENDED  
 Reason Amended Change well name and update LE Order

TYPE OF DRILLING OPERATION  
 STRAIGHT HOLE  DIRECTIONAL HOLE  HORIZONTAL HOLE  
 SERVICE WELL  
 If directional or horizontal, see reverse for bottom hole location.

COUNTY Woods SEC 12 TWP 28N RGE 17W  
 LEASE NAME Hickman USA 12-28-17 WELL NO 1H  
 SHL FNL FWL OF 280 1/4 SEC 770  
 ELEVATION  
 Derrick Ft 1,913 Ground 1,891 Latitude (if Known)  
 OPERATOR NAME CHESAPEAKE OPERATING, L.L.C. OTC/OCC OPERATOR NO. 17441  
 ADDRESS P.O. BOX 18496  
 CITY OKLAHOMA CITY STATE OK ZIP 73154

COMPLETION REPORT  
 SPUD DATE 12/22/2014  
 DRLG FINISHED DATE 1/2/2015  
 DATE OF WELL COMPLETION 10/27/2016  
 1ST PROD DATE 11/19/2016  
 RECOMP DATE  
 Longitude (if Known)

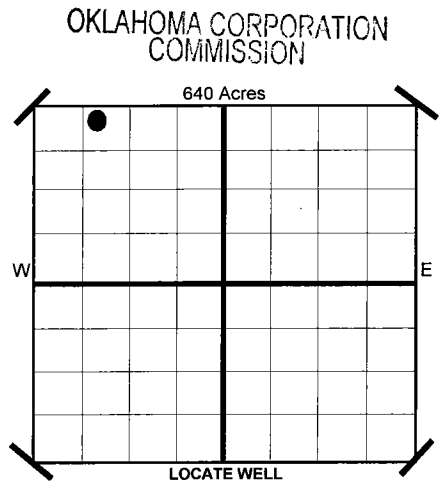

COMPLETION TYPE  
 SINGLE ZONE  
 MULTIPLE ZONE  
 Application Date  
 COMMINGLED  
 Application Date  
 LOCATION EXCEPTION ORDER NO. 661365 F.O.  
 INCREASED DENSITY ORDER NO. 634362

CASING & CEMENT (Form 1002C must be attached)

TYPE	SIZE	WEIGHT	GRADE	FEET	PSI	SAX	TOP	
CONDUCTOR								
SURFACE	13-3/8"	48#	J-55	467		2,142	Surface	
INTERMEDIATE	9-5/8"	36#	J-55	1,223		336	Surface	
PRODUCTION	7"	26#	P-110	5,806		233	4,322	
LINER	4-1/2"	11.6#	P-110	5,651-10,247		531	5,651	
							TOTAL DEPTH	10,250

PACKER @ 5.584 BRAND & TYPE AS-3 PLUG @ \_\_\_\_\_ TYPE \_\_\_\_\_ PLUG @ \_\_\_\_\_ TYPE \_\_\_\_\_  
 PACKER @ \_\_\_\_\_ BRAND & TYPE \_\_\_\_\_ PLUG @ \_\_\_\_\_ TYPE \_\_\_\_\_ PLUG @ \_\_\_\_\_ TYPE \_\_\_\_\_

COMPLETION & TEST DATA BY PRODUCING FORMATION

FORMATION	SPACING & SPACING ORDER NUMBER	CLASS: Oil, Gas, Dry, Inj, Disp, Comm Disp, Svc	PERFORATED INTERVALS	ACID/VOLUME	FRACTURE TREATMENT (Fluids/Prop Amounts)
<u>Mississippi</u>	<u>640</u> <u>350439</u>	<u>Oil</u>	<u>5720 - 10,110</u>	<u>4,500 gals acid</u> <u>37,969 bbls fluids</u> <u>196,505# proppant</u>	

Minimum Gas Allowable (165:10-17-7) OR Oil Allowable (165:10-13-3)  
 Gas Purchaser/Measurer Chesapeake Operating, L.L.C.  
 1st Sales Date 11/19/2016

INITIAL TEST DATA

INITIAL TEST DATE	<u>12/4/2016</u>
OIL-BBL/DAY	<u>138</u>
OIL-GRAVITY ( API)	
GAS-MCF/DAY	<u>707</u>
GAS-OIL RATIO CU FT/BBL	<u>5,123</u>
WATER-BBL/DAY	<u>729</u>
PUMPING OR FLOWING	<u>Artificial Lift</u>
INITIAL SHUT-IN PRESSURE	
CHOKE SIZE	
FLOW TUBING PRESSURE	<u>144</u>

**AS SUBMITTED**

A record of the formations drilled through, and pertinent remarks are presented on the reverse. I declare that I have knowledge of the contents of this report and am authorized by my organization to make this report, which was prepared by me or under my supervision and direction, with the data and facts stated herein to be true, correct, and complete to the best of my knowledge and belief.

Juanita Cooper SIGNATURE  
JUANITA COOPER - SR. REGULATORY ANALYST NAME (PRINT OR TYPE)  
3/2/2017 DATE  
405-848-8000 PHONE NUMBER  
P.O. BOX 18496 ADDRESS  
OKLAHOMA CITY CITY  
OK STATE  
73154 ZIP  
juanita.cooper@chk.com EMAIL ADDRESS

PLEASE TYPE OR USE BLACK INK ONLY  
FORMATION RECORD

Give formation names and tops, if available, or descriptions and thickness of formations drilled through. Show intervals cored or drillstem tested.

LEASE NAME Hickman USA 12-28-17

WELL NO. 1H

NAMES OF FORMATIONS	TOP
Mississippi	5,677

FOR COMMISSION USE ONLY

ITD on file  YES  NO

APPROVED \_\_\_\_\_ DISAPPROVED \_\_\_\_\_

2) Reject Codes

\_\_\_\_\_

\_\_\_\_\_

\_\_\_\_\_

\_\_\_\_\_

Were open hole logs run?      yes  no

Date Last log was run              N/A

Was CO<sub>2</sub> encountered?      yes  no at what depths?

Was H<sub>2</sub>S encountered?      yes  no at what depths?

Were unusual drilling circumstances encountered?      yes  no   
If yes, briefly explain.

Other remarks:

\_\_\_\_\_

\_\_\_\_\_

\_\_\_\_\_

\_\_\_\_\_

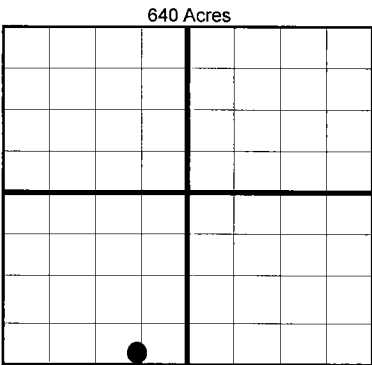

If more than three drainholes are proposed, attach a separate sheet indicating the necessary information.

Direction must be stated in degrees azimuth. Please note, the horizontal drainhole and its end point must be located within the boundaries of the lease or spacing unit.

**Directional surveys are required for all drainholes and directional wells.**

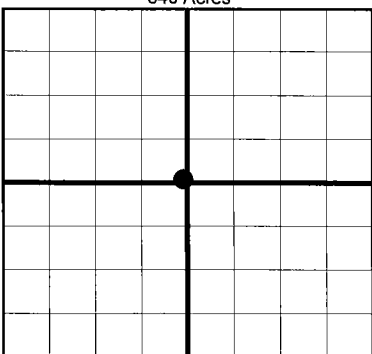

**BOTTOM HOLE LOCATION FOR DIRECTIONAL HOLE**

SEC	TWP	RGE	COUNTY							
Spot Location				1/4	1/4	1/4	1/4	Feet From 1/4 Sec Lines	FSL	FWL
Measured Total Depth				True Vertical Depth		BHL From Lease, Unit, or Property Line:				

**BOTTOM HOLE LOCATION FOR HORIZONTAL HOLE: (LATERALS)**

**LATERAL #1**

SEC	TWP	RGE	COUNTY	Woods							
12	28N	17W		Spot Location				Feet From 1/4 Sec Lines	FSL	FWL	
				SE 1/4	SW 1/4	SE 1/4	SW 1/4	168	174	1,930	
Depth of Deviation				5,180		Radius of Turn		420		Direction	Total Length
Measured Total Depth				10,250		True Vertical Depth		5,600		BHL From Lease, Unit, or Property Line:	
								174			

**LATERAL #2**

SEC	TWP	RGE	COUNTY								
Spot Location				1/4	1/4	1/4	1/4	Feet From 1/4 Sec Lines	FSL	FWL	
Depth of Deviation						Radius of Turn		Direction		Total Length	
Measured Total Depth						True Vertical Depth		BHL From Lease, Unit, or Property Line:			

**LATERAL #3**

SEC	TWP	RGE	COUNTY								
Spot Location				1/4	1/4	1/4	1/4	Feet From 1/4 Sec Lines	FSL	FWL	
Depth of Deviation						Radius of Turn		Direction		Total Length	
Measured Total Depth						True Vertical Depth		BHL From Lease, Unit, or Property Line:			

