

Oklahoma Corporation Commission
Oil & Gas Conservation Division
Post Office Box 52000
Oklahoma City, Oklahoma 73152-2000
Rule 165: 10-3-25

Form 1002A

API No.: 35151244870000

Completion Report

Spud Date: November 10, 2016

OTC Prod. Unit No.: 151-218370

Drilling Finished Date: November 24, 2016

1st Prod Date: January 27, 2017

Completion Date: January 28, 2017

Drill Type: HORIZONTAL HOLE

Min Gas Allowable: Yes

Well Name: TERRI SUE 2616 1H-14 C

Purchaser/Measurer: SEMGAS

Location: WOODS 11 26N 16W
SE SW SW SE
230 FSL 2180 FEL of 1/4 SEC
Latitude: 36.740292405 Longitude: -98.888663557
Derrick Elevation: 0 Ground Elevation: 1590

First Sales Date: 02/09/2017

Operator: MIDSTATES PETROLEUM COMPANY LLC 23079

321 S BOSTON AVE STE 1000
TULSA, OK 74103-3322

Completion Type	
X	Single Zone
	Multiple Zone
	Commingled

Location Exception	
Order No	
658730	

Increased Density	
Order No	
There are no Increased Density records to display.	

Casing and Cement							
Type	Size	Weight	Grade	Feet	PSI	SAX	Top of CMT
SURFACE	9 5/8	36	J-55	1237		575	SURFACE
PRODUCTION	7	26	P-110	6690		295	2429

Liner								
Type	Size	Weight	Grade	Length	PSI	SAX	Top Depth	Bottom Depth
LINER	4.5	11.6	P-110	5347	0	565	6259	11606

Total Depth: 11610

Packer	
Depth	Brand & Type
There are no Packer records to display.	

Plug	
Depth	Plug Type
There are no Plug records to display.	

Initial Test Data

Test Date	Formation	Oil BBL/Day	Oil-Gravity (API)	Gas MCF/Day	Gas-Oil Ratio Cu FT/BBL	Water BBL/Day	Pumpin or Flowing	Initial Shut-In Pressure	Choke Size	Flow Tubing Pressure
Mar 01, 2017	MISSISSIPPI LIME	66	31	2026	30696	8171	PUMPING	381	64/64	481

Completion and Test Data by Producing Formation

Formation Name: MISSISSIPPI LIME

Code: 351MSSLM

Class: GAS

Spacing Orders

Order No	Unit Size
121509	640

Perforated Intervals

From	To
6720	11508

Acid Volumes

4,870 BARRELS 15% GELLED AND RET ACID, 773 BARRELS 15% HCL

Fracture Treatments

95,413 BARRELS SLICK WATER, 168,000 POUNDS ROCK SALT

Formation	Top
HEEBNER SHALE	4577
ENDICOTT	4604
TONKAWA	4932
AVANT	5230
COTTAGE GROVE	5268
HOGSHOOTER	5331
OSWEGO	5516
CHEROKEE	5638
MISSISSIPPI LIME	5899

Were open hole logs run? No

Date last log run:

Were unusual drilling circumstances encountered? No

Explanation:

Other Remarks

OCC - THIS DOCUMENT IS ACCEPTED BASED ON THE DATA SUBMITTED THE FINAL LOCATION EXCEPTION HAS NOT BEEN SUBMITTED.

Lateral Holes

Sec: 14 TWP: 26N RGE: 16W County: WOODS

SW SE SW SE

174 FSL 1967 FEL of 1/4 SEC

Depth of Deviation: 7004 Radius of Turn: 1121 Direction: 179 Total Length: 4920

Measured Total Depth: 11610 True Vertical Depth: 6103 End Pt. Location From Release, Unit or Property Line: 174

FOR COMMISSION USE ONLY

1136122

Status: Accepted

RECEIVED

Form 1002A Rev. 2009

MAR 07 2017

OKLAHOMA CORPORATION COMMISSION

API NO. 151 24487
OTC PROD. UNIT NO. 151 218370

PLEASE TYPE OR USE BLACK INK ONLY
NOTE:

Attach copy of original 1002A if recompletion or reentry.

OKLAHOMA CORPORATION COMMISSION
Oil & Gas Conservation Division
Post Office Box 52000
Oklahoma City, Oklahoma 73152-2000
Rule 165.10-3-25

COMPLETION REPORT

ORIGINAL
AMENDED (Reason)

TYPE OF DRILLING OPERATION
STRAIGHT HOLE
DIRECTIONAL HOLE
HORIZONTAL HOLE

SPUD DATE 11/10/2016
DRLG FINISHED DATE 11/24/2016
DATE OF WELL COMPLETION 01/28/2017
1st PROD DATE 01/27/2017
RECOMP DATE

COUNTY Woods SEC 11 TWP 26N RGE 16W
LEASE NAME Terri Sue 2616

WELL NO. 1H-14 C

SE 1/4 SW 1/4 SW 1/4 SE 1/4 FSL OF 1/4 SEC 230 OF 1/4 SEC 2180E

Longitude (if known) -98.888663557

ELEVATION Ground 1590 Latitude (if known) 36.740292405

OPERATOR NAME Midstates Petroleum Company LLC OTC/OCC OPERATOR NO. 23079

ADDRESS 321 South Boston, Suite 1000

CITY Tulsa STATE OK ZIP 74103

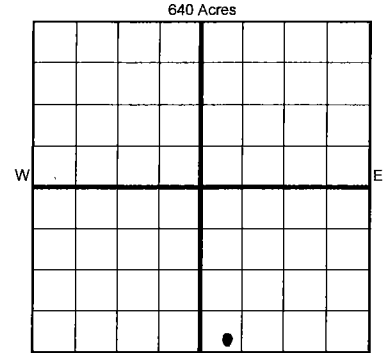

COMPLETION TYPE
SINGLE ZONE
MULTIPLE ZONE
COMMINGLED
LOCATION EXCEPTION ORDER 658730 F.I.O.
INCREASED DENSITY ORDER NO. N/A

Table with columns: TYPE, SIZE, WEIGHT, GRADE, FEET, PSI, SAX, TOP OF CMT. Rows include CONDUCTOR, SURFACE, INTERMEDIATE, PRODUCTION, LINER, and TOTAL DEPTH 11,610'.

PACKER @ BRAND & TYPE PLUG @ TYPE PLUG @ TYPE

COMPLETION & TEST DATA BY PRODUCING FORMATION 351 MISS LIME

Table with columns: FORMATION, SPACING & SPACING ORDER NUMBER, CLASS, PERFORATED INTERVALS, ACID/VOLUME, FRACTURE TREATMENT. Includes handwritten note 'Reported to Fran Focus'.

Min Gas Allowable (165:10-17-7) Gas Purchaser/Measurer SemGas
OR
Oil Allowable (165:10-13-3) First Sales Date 02/09/2017

Table with columns: INITIAL TEST DATE, OIL-BBL/DAY, OIL-GRAVITY (API), GAS-MCF/DAY, GAS-OIL RATIO CU FT/BBL, WATER-BBL/DAY, PUMPING OR FLOWING, INITIAL SHUT-IN PRESSURE, CHOKE SIZE, FLOW TUBING PRESSURE. Includes 'AS SUBMITTED' stamp.

A record of the formations drilled through, and pertinent remarks are presented on the reverse. I declare that I have knowledge of the contents of this report and am authorized by my organization to make this report, which was prepared by me or under my supervision and direction, with the data and facts stated herein to be true, correct, and complete to the best of my knowledge and belief.
Signature: Chelce Rouse
NAME (PRINT OR TYPE): Chelce Rouse
DATE: 03/01/2017
PHONE NUMBER: 918-947-4647
ADDRESS: 321 South Boston, Suite 1000 Tulsa, OK 74103
CITY: Tulsa STATE: OK ZIP: 74103
EMAIL ADDRESS: chelce.rouse@midstatespetroleum.com

PLEASE TYPE OR USE BLACK INK ONLY
FORMATION RECORD

Give formation names and tops, if available, or descriptions and thickness of formations drilled through. Show intervals cored or drillstem tested.

LEASE NAME Terri Sue 2616

WELL NO. 1H-14 C

NAMES OF FORMATIONS	TOP
HEEBNER SHALE	4,577
ENDICOTT	4,604
TONKAWA	4,932
AVANT	5,230
COTTAGE GROVE	5,268
HOGSHOOTER	5,331
OSWEGO	5,516
CHEROKEE	5,638
MISSISSIPPI LIME	5,899

FOR COMMISSION USE ONLY

ITD on file YES NO

APPROVED _____ DISAPPROVED _____

2) Reject Codes

Were open hole logs run? yes no

Date Last log was run N/A

Was CO₂ encountered? yes no at what depths? _____

Was H₂S encountered? yes no at what depths? _____

Were unusual drilling circumstances encountered? yes no
If yes, briefly explain below

Other remarks:

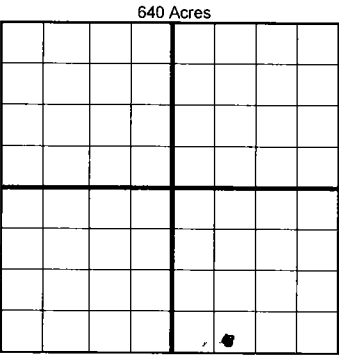

If more than three drainholes are proposed, attach a separate sheet indicating the necessary information.

Direction must be stated in degrees azimuth. Please note, the horizontal drainhole and its end point must be located within the boundaries of the lease or spacing unit.

Directional surveys are required for all drainholes and directional wells.

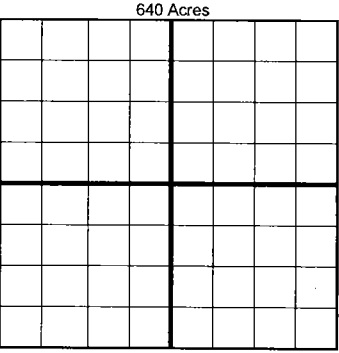

BOTTOM HOLE LOCATION FOR DIRECTIONAL HOLE

SEC	TWP	RGE	COUNTY				
Spot Location	1/4	1/4	1/4	1/4	Feet From 1/4 Sec Lines	FSL	FWL
Measured Total Depth	True Vertical Depth		BHL From Lease, Unit, or Property Line:				

BOTTOM HOLE LOCATION FOR HORIZONTAL HOLE: (LATERALS)

LATERAL #1

SEC	TWP	RGE	COUNTY						
SEC 14	TWP 26N	RGE 16W	County Woods						
Spot Location	<u>S2SW</u> 1/4	<u>S2E</u> 1/4	SW	1/4	SE	1/4	Feet From 1/4 Sec Lines	FSL 174	FWL 1967E
Depth of Deviation	7,004'		Radius of Turn	1,121		Direction	<u>180.50 179</u>		
Measured Total Depth	11,610'		True Vertical Depth	6,103'		Total Length	4,920		
				BHL From Lease, Unit, or Property Line: 174					

LATERAL #2

SEC	TWP	RGE	COUNTY						
Spot Location	1/4	1/4	1/4	1/4	Feet From 1/4 Sec Lines	FSL	FWL		
Depth of Deviation			Radius of Turn			Direction	Total Length		
Measured Total Depth			True Vertical Depth	BHL From Lease, Unit, or Property Line:					

LATERAL #3

SEC	TWP	RGE	COUNTY						
Spot Location	1/4	1/4	1/4	1/4	Feet From 1/4 Sec Lines	FSL	FWL		
Depth of Deviation			Radius of Turn			Direction	Total Length		
Measured Total Depth			True Vertical Depth	BHL From Lease, Unit, or Property Line:					

A: 218370 I 2/9/17

RECEIVED

Form 1002A Rev. 2009

MAR 07 2017

OKLAHOMA CORPORATION COMMISSION 1016EZ

API NO. 151 24487
OTC PROD. UNIT NO. 151 218370

PLEASE TYPE OR USE BLACK INK ONLY
NOTE:

Attach copy of original 1002A if recompletion or reentry.

OKLAHOMA CORPORATION COMMISSION
Oil & Gas Conservation Division
Post Office Box 52000
Oklahoma City, Oklahoma 73152-2000
Rule 165-10-3-25

ORIGINAL
 AMENDED (Reason)

COMPLETION REPORT

TYPE OF DRILLING OPERATION
 STRAIGHT HOLE DIRECTIONAL HOLE HORIZONTAL HOLE
 SERVICE WELL
If directional or horizontal, see reverse for bottom hole location

SPUD DATE 11/10/2016
DRLG FINISHED DATE 11/24/2016
DATE OF WELL COMPLETION 01/28/2017
1st PROD DATE 01/27/2017
RECOMP DATE

LONGITUDE (if known) -98.888663557

OTC/OCC OPERATOR NO. 23079

ADDRESS 321 South Boston, Suite 1000

CITY Tulsa STATE OK ZIP 74103

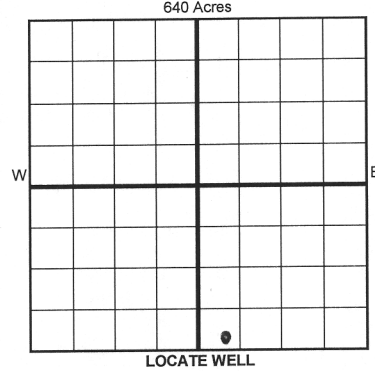

COMPLETION TYPE
 SINGLE ZONE
 MULTIPLE ZONE
 COMMINGLED
LOCATION EXCEPTION ORDER 658730 F.O.
INCREASED DENSITY ORDER NO. N/A

TYPE	SIZE	WEIGHT	GRADE	FEET	PSI	SAX	TOP OF CMT	
CONDUCTOR								
SURFACE								
INTERMEDIATE	9-5/8	36#	J-55	1,237'		575	surface	
PRODUCTION	7	26#	P-110	6,690'		295	2,429'	
LINER	4.5	11.6#	P-110	6,259'	11,606'	565	6,263'	
							TOTAL DEPTH	11,610'

PACKER @ _____ BRAND & TYPE _____ PLUG @ _____ TYPE _____
PACKER @ _____ BRAND & TYPE _____ PLUG @ _____ TYPE _____

COMPLETION & TEST DATA BY PRODUCING FORMATION *351 MISSISSIPPI*

FORMATION	Mississippi Lime								
SPACING & SPACING ORDER NUMBER	640/121509								
CLASS: Oil, Gas, Dry, Inj, Disp, Comm Disp, Svc	Gas								
PERFORATED INTERVALS	6,720'-11,508'								
ACID/VOLUME	4870 bbls 15% gelled & ret acid	773 bbls 15% HCl							
FRACTURE TREATMENT (Fluids/Prop Amounts)	95,413 bbls slk wtr								
	168,000# rock salt								

Reported to Frac Focus

Min Gas Allowable (165:10-17-7) OR Gas Purchaser/Measurer First Sales Date SemGas 02/09/2017
Oil Allowable (165:10-13-3)

INITIAL TEST DATE	03/01/2017						
OIL-BBL/DAY	66						
OIL-GRAVITY (API)	31						
GAS-MCF/DAY	2,026						
GAS-OIL RATIO CU FT/BBL	30,696						
WATER-BBL/DAY	8,171						
PUMPING OR FLOWING	Pumping						
INITIAL SHUT-IN PRESSURE	381						
CHOKE SIZE	64/64						
FLOW TUBING PRESSURE	481						

AS SUBMITTED

SCANNED

A record of the formations drilled through, and pertinent remarks are presented on the reverse. I declare that I have knowledge of the contents of this report and am authorized by my organization to make this report, which was prepared by me or under my supervision and direction, with the data and facts stated herein to be true, correct, and complete to the best of my knowledge and belief.

03/01/2017 918-947-4647

SIGNATURE *Chelce Rouse* NAME (PRINT OR TYPE) Chelce Rouse DATE 03/01/2017 PHONE NUMBER 918-947-4647

321 South Boston, Suite 1000 Tulsa, OK 74103 chelce.rouse@midstatespetroleum.com

ADDRESS CITY STATE ZIP EMAIL ADDRESS

EL

OR