

Oklahoma Corporation Commission  
Oil & Gas Conservation Division  
Post Office Box 52000  
Oklahoma City, Oklahoma 73152-2000  
Rule 165: 10-3-25

Form 1002A

API No.: 35151244900000

**Completion Report**

Spud Date: November 24, 2016

OTC Prod. Unit No.: 151-218357

Drilling Finished Date: December 07, 2016

1st Prod Date: January 30, 2017

Completion Date: January 28, 2017

**Drill Type: HORIZONTAL HOLE**

Min Gas Allowable: Yes

Well Name: TERRI SUE 2616 1H-12A

Purchaser/Measurer: SEMGAS

Location: WOODS 11 26N 16W  
SE SW SW SE  
245 FSL 2180 FEL of 1/4 SEC  
Derrick Elevation: 0 Ground Elevation: 1589

First Sales Date: 02/06/2017

Operator: MIDSTATES PETROLEUM COMPANY LLC 23079

321 S BOSTON AVE STE 1000  
TULSA, OK 74103-3322

Completion Type		Location Exception		Increased Density	
X	Single Zone	<b>Order No</b>		<b>Order No</b>	
	Multiple Zone	660820		659522	
	Commingled				

Casing and Cement							
Type	Size	Weight	Grade	Feet	PSI	SAX	Top of CMT
SURFACE	9 5/8	36	J-55	1248		660	SURFACE
PRODUCTION	7	26	P-110	6889		425	3585

Liner								
Type	Size	Weight	Grade	Length	PSI	SAX	Top Depth	Bottom Depth
LINER	4.5	11.6	P-110	5444	0	590	6826	12270

**Total Depth: 12270**

Packer	
Depth	Brand & Type
There are no Packer records to display.	

Plug	
Depth	Plug Type
There are no Plug records to display.	

Initial Test Data										
Test Date	Formation	Oil BBL/Day	Oil-Gravity (API)	Gas MCF/Day	Gas-Oil Ratio Cu FT/BBL	Water BBL/Day	Pumpin or Flowing	Initial Shut-In Pressure	Choke Size	Flow Tubing Pressure
Mar 03, 2017	MISSISSIPPIAN	142	32	1004	7070	3632	PUMPING	128	64/64	231

**Completion and Test Data by Producing Formation**

Formation Name: MISSISSIPPIAN

Code: 359MSSP

Class: OIL

**Spacing Orders**

Order No	Unit Size
There are no Spacing Order records to display.	

**Perforated Intervals**

From	To
7373	12175

**Acid Volumes**

5,119 BARRELS 15% GELLED AND RET ACID, 783 BARRELS 15% HCL

**Fracture Treatments**

99,260 BARRELS SLICK WATER, 178,500 POUNDS ROCK SALT

Formation	Top
HEEBNER SHALE	4582
ENDICOTT	4599
TONKAWA	4907
AVANT	5237
COTTAGE GROVE	5275
HOGSHOOTER	5339
OSWEGO	5527
CHEROKEE	5647
MISSISSIPPI LIME	5875

Were open hole logs run? No

Date last log run:

Were unusual drilling circumstances encountered? No

Explanation:

**Other Remarks**

OCC - THIS DOCUMENT IS ACCEPTED BASED ON THE DATA SUBMITTED THE FINAL LOCATION EXCEPTION HAS NOT BEEN SUBMITTED.

**Lateral Holes**

Sec: 12 TWP: 26N RGE: 16W County: WOODS

NE NW NW NW

166 FNL 651 FWL of 1/4 SEC

Depth of Deviation: 7468 Radius of Turn: 1625 Direction: 1 Total Length: 5381

Measured Total Depth: 12270 True Vertical Depth: 6018 End Pt. Location From Release, Unit or Property Line: 166

**FOR COMMISSION USE ONLY**

1136121

Status: Accepted

RECEIVED

Form 1002A Rev. 2009

MAR 07 2017

OKLAHOMA CORPORATION COMMISSION

API NO. 151 24490
OTC PROD. UNIT NO. 151 218357

PLEASE TYPE OR USE BLACK INK ONLY
NOTE:

Attach copy of original 1002A if recompletion or reentry.

OKLAHOMA CORPORATION COMMISSION
Oil & Gas Conservation Division
Post Office Box 52000
Oklahoma City, Oklahoma 73152-2000
Rule 165:10-3-25

COMPLETION REPORT

ORIGINAL
AMENDED (Reason)

TYPE OF DRILLING OPERATION
STRAIGHT HOLE
DIRECTIONAL HOLE
HORIZONTAL HOLE
SERVICE WELL

SPUD DATE 11/24/2016
DRLG FINISHED DATE 12/07/2016
DATE OF WELL COMPLETION 01/28/2017
1st PROD DATE 01/30/2017
RECOMP DATE
ELEVATIO N Derrick Ground 1589
Latitude (if known) 36.740333776N
Longitude (if known) -98.888663571W
OPERATOR NAME Midstates Petroleum Company LLC
OTC/OCC OPERATOR NO. 23079
ADDRESS 321 South Boston, Suite 1000
CITY Tulsa STATE OK ZIP 74103

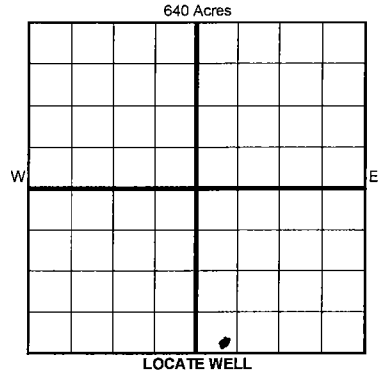

COMPLETION TYPE
SINGLE ZONE
MULTIPLE ZONE
COMMINGLED
LOCATION EXCEPTION ORDER 660820 F.O.
INCREASED DENSITY ORDER NO. 659522

Table with columns: TYPE, SIZE, WEIGHT, GRADE, FEET, PSI, SAX, TOP OF CMT. Rows include CONDUCTOR, SURFACE, INTERMEDIATE, PRODUCTION, LINER, and TOTAL DEPTH 12,270'.

PACKER @ BRAND & TYPE PLUG @ TYPE PLUG @ TYPE
PACKER @ BRAND & TYPE PLUG @ TYPE PLUG @ TYPE

COMPLETION & TEST DATA BY PRODUCING FORMATION 359 MESSP

Table with columns: FORMATION, SPACING & ORDER NUMBER, CLASS, PERFORATED INTERVALS, ACID/VOLUME, FRACTURE TREATMENT. Includes handwritten notes like 'Mississippian', 'No Spacing', 'oil per GOR', and 'Reported to Form Focus'.

Min Gas Allowable (165:10-17-7) Gas Purchaser/Measurer SemGas
Oil Allowable (165:10-13-3) First Sales Date 02/06/2017

Table with columns: INITIAL TEST DATE, OIL-BBL/DAY, OIL-GRAVITY (API), GAS-MCF/DAY, GAS-OIL RATIO CU FT/BBL, WATER-BBL/DAY, PUMPING OR FLOWING, INITIAL SHUT-IN PRESSURE, CHOKE SIZE, FLOW TUBING PRESSURE.

AS SUBMITTED

A record of the formations drilled through, and pertinent remarks are presented on the reverse. I declare that I have knowledge of the contents of this report and am authorized by my organization to make this report, which was prepared by me or under my supervision and direction, with the data and facts stated herein to be true, correct, and complete to the best of my knowledge and belief.
Signature: Chelce Rouse
NAME (PRINT OR TYPE): Chelce Rouse
DATE: 03/03/2017
PHONE NUMBER: 918-947-4647
ADDRESS: 321 South Boston, Suite 1000 Tulsa, OK 74103
EMAIL ADDRESS: chelce.rouse@midstatespetroleum.com

PLEASE TYPE OR USE BLACK INK ONLY  
FORMATION RECORD

Give formation names and tops, if available, or descriptions and thickness of formations drilled through. Show intervals cored or drillstem tested.

LEASE NAME Terri Sue 2616

WELL NO. 1H-12 A

NAMES OF FORMATIONS	TOP
HEEBNER SHALE	4,582
ENDICOTT	4,599
TONKAWA	4,907
AVANT	5,237
COTTAGE GROVE	5,275
HOGSHOOTER	5,339
OSWEGO	5,527
CHEROKEE	5,647
MISSISSIPPI LIME	5,875

FOR COMMISSION USE ONLY

ITD on file  YES  NO

APPROVED \_\_\_\_\_ DISAPPROVED \_\_\_\_\_

2) Reject Codes \_\_\_\_\_

\_\_\_\_\_

\_\_\_\_\_

\_\_\_\_\_

\_\_\_\_\_

Were open hole logs run?  yes  no

Date Last log was run N/A

Was CO<sub>2</sub> encountered?  yes  no at what depths? \_\_\_\_\_

Was H<sub>2</sub>S encountered?  yes  no at what depths? \_\_\_\_\_

Were unusual drilling circumstances encountered?  yes  no  
If yes, briefly explain below

Other remarks:

\_\_\_\_\_

\_\_\_\_\_

\_\_\_\_\_

\_\_\_\_\_

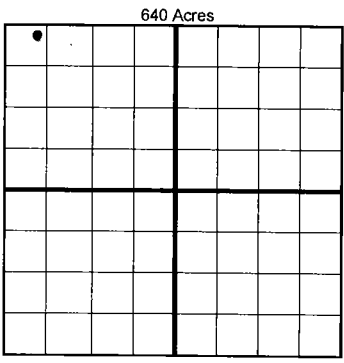

If more than three drainholes are proposed, attach a separate sheet indicating the necessary information.

Direction must be stated in degrees azimuth. Please note, the horizontal drainhole and its end point must be located within the boundaries of the lease or spacing unit.

Directional surveys are required for all drainholes and directional wells.

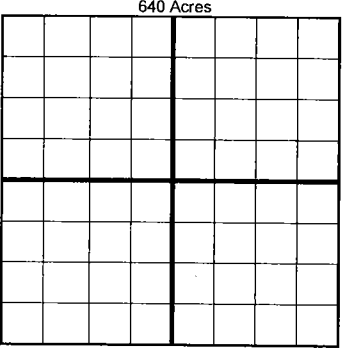

BOTTOM HOLE LOCATION FOR DIRECTIONAL HOLE

SEC	TWP	RGE	COUNTY				
Spot Location	1/4	1/4	1/4	1/4	Feet From 1/4 Sec Lines	FSL	FWL
Measured Total Depth	True Vertical Depth		BHL From Lease, Unit, or Property Line:				

BOTTOM HOLE LOCATION FOR HORIZONTAL HOLE: (LATERALS)

LATERAL #1

SEC 12 TWP 26N RGE 16W COUNTY Woods *Per Survey*

Spot Location	<del>N2</del> NE 1/4	<del>N2</del> NW 1/4	NW 1/4	NW 1/4	Feet From 1/4 Sec Lines	FSL <del>165N</del> 166	FWL <del>650</del> 651
Depth of Deviation	7,468'		Radius of Turn	1,625	Direction	80°	
Measured Total Depth	12,270'		True Vertical Depth	6,018'	BHL From Lease, Unit, or Property Line: 165 166		

LATERAL #2

SEC	TWP	RGE	COUNTY				
Spot Location	1/4	1/4	1/4	1/4	Feet From 1/4 Sec Lines	FSL	FWL
Depth of Deviation	Radius of Turn		Direction		Total Length		
Measured Total Depth	True Vertical Depth		BHL From Lease, Unit, or Property Line:				

LATERAL #3

SEC	TWP	RGE	COUNTY				
Spot Location	1/4	1/4	1/4	1/4	Feet From 1/4 Sec Lines	FSL	FWL
Depth of Deviation	Radius of Turn		Direction		Total Length		
Measured Total Depth	True Vertical Depth		BHL From Lease, Unit, or Property Line:				