

Oklahoma Corporation Commission
 Oil & Gas Conservation Division
 Post Office Box 52000
 Oklahoma City, Oklahoma 73152-2000
 Rule 165: 10-3-25

Form 1002A

API No.: 35073253170002

Completion Report

Spud Date: August 09, 2016

OTC Prod. Unit No.:

Drilling Finished Date: August 22, 2016

Amended

1st Prod Date:

Amend Reason: ADD ADDITIONAL PERFORATIONS AND MOVE PACKER

Completion Date: August 26, 2016

Recomplete Date: March 01, 2017

Drill Type: STRAIGHT HOLE

SERVICE WELL

Well Name: HORN SWD 1A

Purchaser/Measurer:

Location: KINGFISHER 17 17N 5W
 NW NW NW NW
 250 FNL 275 FWL of 1/4 SEC
 Derrick Elevation: 1098 Ground Elevation: 1071

First Sales Date:

Operator: HINKLE OIL & GAS INC 21639

5600 N MAY AVE STE 295
 OKLAHOMA CITY, OK 73112-4275

Completion Type	
X	Single Zone
	Multiple Zone
	Commingled

Location Exception	
Order No	
There are no Location Exception records to display.	

Increased Density	
Order No	
There are no Increased Density records to display.	

Casing and Cement							
Type	Size	Weight	Grade	Feet	PSI	SAX	Top of CMT
SURFACE	9 5/8	36	J-55	360		300	SURFACE
PRODUCTION	7	26	N-80	8099		400	6810

Liner								
Type	Size	Weight	Grade	Length	PSI	SAX	Top Depth	Bottom Depth
There are no Liner records to display.								

Total Depth: 8100

Packer	
Depth	Brand & Type
7760	AS-1X

Plug	
Depth	Plug Type
8060	PLUG

Initial Test Data

Test Date	Formation	Oil BBL/Day	Oil-Gravity (API)	Gas MCF/Day	Gas-Oil Ratio Cu FT/BBL	Water BBL/Day	Pumpin or Flowing	Initial Shut-In Pressure	Choke Size	Flow Tubing Pressure
-----------	-----------	-------------	-------------------	-------------	-------------------------	---------------	-------------------	--------------------------	------------	----------------------

There are no Initial Data records to display.

Completion and Test Data by Producing Formation

Formation Name: WILCOX

Code: 202WLCX

Class: DISP

Spacing Orders

Order No	Unit Size
There are no Spacing Order records to display.	

Perforated Intervals

From	To
7790	7960

Acid Volumes

3,000 GALLONS 15% HCL

Fracture Treatments

190,974 GALLONS 25 POUNDS BORATE GEL, 3,276 GALLONS 25 POUNDS LINEAR, 299,900 POUNDS 20/40 SAND

Formation	Top
CHECKERBOARD	5934
BIG LIME	6200
2ND OSWEGO	6266
3RD OSWEGO	6302
4TH OSWEGO	6324
VERDIGRIS	6437
PINK LIME	6550
MISSISSIPPI	6738
WOODFORD	7273
HUNTON	7356
SYLVAN	7444
VIOLA	7544
WILCOX	7634

Were open hole logs run? Yes

Date last log run: August 18, 2016

Were unusual drilling circumstances encountered? No

Explanation:

Other Remarks

OCC - UIC PERMIT NUMBER 1609550101

FOR COMMISSION USE ONLY

1136120

Status: Accepted

073-25317-02

API NO. 073-38473
OTC PROD. UNIT NO.

PLEASE TYPE OR USE BLACK INK ONLY
NOTE:

Attach copy of original 1002A
if recompletion or reentry.

OKLAHOMA CORPORATION COMMISSION
Oil & Gas Conservation Division
Post Office Box 52000
Oklahoma City, Oklahoma 73152-2000
Rule 165:10-3-25

RECEIVED

Form 1002A
Rev. 2009

MAR 06 2017

OKLAHOMA CORPORATION
COMMISSION
640 Acres

ORIGINAL
 AMENDED (Reason)

**Add Add'l Perfs & Move Pkr

COMPLETION REPORT

TYPE OF DRILLING OPERATION
 STRAIGHT HOLE DIRECTIONAL HOLE HORIZONTAL HOLE
 SERVICE WELL
If directional or horizontal, see reverse for bottom hole location.

SPUD DATE 8/9/16
DRG FINISHED DATE 8/22/16
DATE OF WELL COMPLETION 8/26/16
1st PROD DATE
RECOMP DATE 3/1/17
Longitude (if known) 97 45' 49.9"

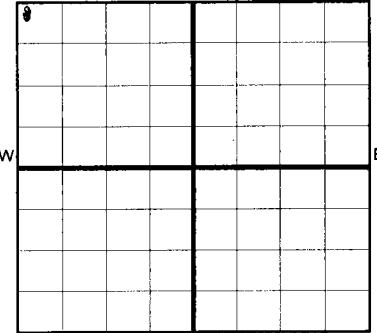

COUNTY Kingfisher SEC 17 TWP 17N RGE 05W
LEASE NAME Horn SWD WELL NO. 1A
NW 1/4 NW 1/4 NW 1/4 NW 1/4 (ENL) OF 1/4 SEC 250' FWL OF 1/4 SEC 275'
ELEVATIO N Derrick 1098' Ground 1071' Latitude (if known) 35 57' 18.7" Longitude (if known) 97 45' 49.9"
OPERATOR NAME Hinkle Oil & Gas, Inc. OTC/OCC OPERATOR NO. 21639
ADDRESS 5600 N. May Avenue, Suite 295
CITY Oklahoma City STATE OK ZIP 73112

COMPLETION TYPE
 SINGLE ZONE
 MULTIPLE ZONE
Application Date
 COMMINGLED
Application Date
LOCATION
EXCEPTION ORDER
INCREASED DENSITY
ORDER NO.

CASING & CEMENT (Form 1002C must be attached)

TYPE	SIZE	WEIGHT	GRADE	FEET	PSI	SAX	TOP OF CMT
CONDUCTOR							
SURFACE	9 5/8"	36#	J-55	360'		300	Surface
INTERMEDIATE							
PRODUCTION	7"	26#	N-80	8099'		400	6810'
LINER							
TOTAL DEPTH							8100'

PACKER @ 7760' BRAND & TYPE AS-1X PLUG @ 8060' TYPE _____ PLUG @ _____ TYPE _____
PACKER @ _____ BRAND & TYPE _____ PLUG @ _____ TYPE _____ PLUG @ _____ TYPE _____

COMPLETION & TEST DATA BY PRODUCING FORMATION *202WLCX*

FORMATION	Wilcox								
SPACING & SPACING ORDER NUMBER	1609550101	see remarks							Reported to Frac Focus
CLASS: Oil, Gas, Dry, Inj, Disp, Comm Disp, Svc	Disposal								
PERFORATED INTERVALS	7790'-7880'-540 holes	**							
	7900'-7960'-360 holes								
ACID/VOLUME									
FRACTURE TREATMENT (Fluids/Prop Amounts)	3000 Gal. 15% HCL								
	190974 Gal. 25# Borate Gel, 3276 Gal. 25# Linear	original Frac							
	299900# 20/40 Sand								

Min Gas Allowable (165:10-17-7) OR Gas Purchaser/Measurer First Sales Date
 Oil Allowable (165:10-13-3)

INITIAL TEST DATA

INITIAL TEST DATE	N/A								
OIL-BBL/DAY									
OIL-GRAVITY (API)									
GAS-MCF/DAY									
GAS-OIL RATIO CU FT/BBL									
WATER-BBL/DAY									
PUMPING OR FLOWING									
INITIAL SHUT-IN PRESSURE									
CHOKE SIZE									
FLOW TUBING PRESSURE									

AS SUBMITTED

A record of the formations drilled through, and pertinent remarks are presented on the reverse. I declare that I have knowledge of the contents of this report and am authorized by my organization to make this report, which was prepared by me or under my supervision and direction, with the data and facts stated herein to be true, correct, and complete to the best of my knowledge and belief.

B. Hinkle
SIGNATURE
5600 N. May Avenue, Suite 295
ADDRESS

Bruce A. Hinkle
NAME (PRINT OR TYPE)
Oklahoma City
CITY

OK
STATE

73112
ZIP

3/2/2017
DATE

405-848-0924
PHONE NUMBER

Laurahinkle@hoagi.com
EMAIL ADDRESS

RECEIVED

MAR 10 2017

OKLAHOMA CORPORATION COMMISSION
840 Acres

API NO. 073-25317
OTC PROD.
UNIT NO.

PLEASE TYPE OR USE BLACK INK ONLY
NOTE:

Attach copy of original 1002A if recompletion or reentry.

OKLAHOMA CORPORATION COMMISSION
Oil & Gas Conservation Division
Post Office Box 52000
Oklahoma City, Oklahoma 73152-2000
Rule 165:10-3-25

ORIGINAL
 AMENDED (Reason)

****Add Add'l Perfs & Move Pkr Edit API#**

COMPLETION REPORT

TYPE OF DRILLING OPERATION
 STRAIGHT HOLE DIRECTIONAL HOLE HORIZONTAL HOLE
 SERVICE WELL
If directional or horizontal, see reverse for bottom hole location.

SPUD DATE 8/9/16
DRLG FINISHED DATE 8/22/16
DATE OF WELL COMPLETION 8/26/16
1st PROD DATE
RECOMP DATE 3/1/17
Longitude (if known) 97 45' 49.9"

COUNTY Kingfisher SEC 17 TWP 17N RGE 05W
LEASE NAME Horn SWD WELL NO. 1A
NW 1/4 NW 1/4 NW 1/4 NW 1/4 FNL OF 1/4 SEC 250' FWL OF 1/4 SEC 275'
ELEVATIO N Derrick 1098' Ground 1071' Latitude (if known) 35 57' 18.7" Longitude (if known) 97 45' 49.9"
OPERATOR NAME Hinkle Oil & Gas, Inc. OTC/OCC OPERATOR NO. 21639
ADDRESS 5600 N. May Avenue, Suite 295
CITY Oklahoma City STATE OK ZIP 73112

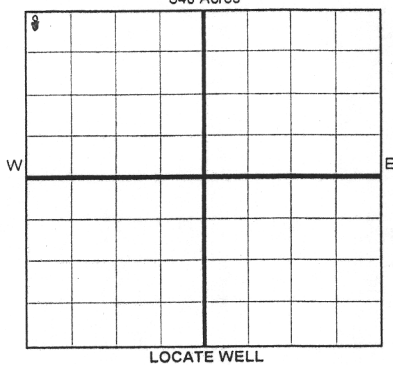

COMPLETION TYPE
 SINGLE ZONE
 MULTIPLE ZONE
Application Date
 COMMINGLED
Application Date
LOCATION
EXCEPTION ORDER
INCREASED DENSITY
ORDER NO.

CASING & CEMENT (Form 1002C must be attached)								
TYPE	SIZE	WEIGHT	GRADE	FEET	PSI	SAX	TOP OF CMT	
CONDUCTOR								
SURFACE	9 5/8"	36#	J-55	360'		300	Surface	
INTERMEDIATE								
PRODUCTION	7"	26#	N-80	8099'		400	6810'	
LINER								
							TOTAL DEPTH	8100'

PACKER @ 7760' BRAND & TYPE AS-1X PLUG @ 8060' TYPE _____ PLUG @ _____ TYPE _____
PACKER @ _____ BRAND & TYPE _____ PLUG @ _____ TYPE _____ PLUG @ _____ TYPE _____

COMPLETION & TEST DATA BY PRODUCING FORMATION 202WLCX

FORMATION	Wilcox							
SPACING & SPACING ORDER NUMBER	1609550101		<i>see remarks</i>				<i>Earlier to New Reports to Frac Focus</i>	
CLASS: Oil, Gas, Dry, Inj, Disp, Comm Disp, Svc	Disposal							
PERFORATED INTERVALS	7790'-7880'-540 holes		**					
	7900'-7960'-360 holes							
ACID/VOLUME								
FRACTURE TREATMENT (Fluids/Prop Amounts)	3000 Gal. 15% HCL							
	190974 Gal. 25#	Borate Gel, 3276	Gal. 25# Linear					
	299900# 20/40 Sand							

Min Gas Allowable (165:10-17-7) OR Gas Purchaser/Measurer First Sales Date
 Oil Allowable (165:10-13-3)

INITIAL TEST DATA

INITIAL TEST DATE	N/A			
OIL-BBL/DAY				
OIL-GRAVITY (API)				
GAS-MCF/DAY				
GAS-OIL RATIO CU FT/BBL				
WATER-BBL/DAY				
PUMPING OR FLOWING				
INITIAL SHUT-IN PRESSURE				
CHOKE SIZE				
FLOW TUBING PRESSURE				

AS SUBMITTED

A record of the formations drilled through, and pertinent remarks are presented on the reverse. I declare that I have knowledge of the contents of this report and am authorized by my organization to make this report, which was prepared by me or under my supervision and direction, with the data and facts stated herein to be true, correct, and complete to the best of my knowledge and belief.

B. A. Hinkle Bruce A. Hinkle 3/2/2017 405-848-0924
SIGNATURE NAME (PRINT OR TYPE) DATE PHONE NUMBER
5600 N. May Avenue, Suite 295 Oklahoma City OK 73112
ADDRESS CITY STATE ZIP
Laurahinkle@hoagi.com
EMAIL ADDRESS

