

Oklahoma Corporation Commission  
 Oil & Gas Conservation Division  
 Post Office Box 52000  
 Oklahoma City, Oklahoma 73152-2000  
 Rule 165: 10-3-25

Form 1002A

API No.: 35083202230001

**Completion Report**

Spud Date: October 30, 1970

OTC Prod. Unit No.: 083-043425-0-3255

Drilling Finished Date: November 13, 1970

1st Prod Date: December 13, 1970

**Amended**

Completion Date: November 28, 1970

Amend Reason: CASING LEAK REPAIR WITH LINER

Recomplete Date: September 20, 2016

**Drill Type: STRAIGHT HOLE**

Min Gas Allowable: Yes

Well Name: NW LAWRIE OSWEGO UNIT 27-1

Purchaser/Measurer: EASON GAS

Location: LOGAN 31 18N 2W  
 SE NW SE NE  
 732 FSL 1888 FWL of 1/4 SEC  
 Derrick Elevation: 932 Ground Elevation: 923

First Sales Date: 12/13/1970

Operator: MCMILLIN C C & COMPANY INC 14594  
 PO BOX 546  
 6 MI N ON HWY 77  
 GUTHRIE, OK 73044-0546

Completion Type	
X	Single Zone
	Multiple Zone
	Commingled

Location Exception
Order No
There are no Location Exception records to display.

Increased Density
Order No
There are no Increased Density records to display.

Casing and Cement							
Type	Size	Weight	Grade	Feet	PSI	SAX	Top of CMT
SURFACE	8.625	32	J-55	403		315	SURFACE
PRODUCTION	4.5	10.5	J-55	5373		140	5063

Liner								
Type	Size	Weight	Grade	Length	PSI	SAX	Top Depth	Bottom Depth
LINER	3.5	9.3	N-80	0	0	180	SURFACE	5091

**Total Depth: 5373**

Packer	
Depth	Brand & Type
There are no Packer records to display.	

Plug	
Depth	Plug Type
5300	CIBP

Initial Test Data

Test Date	Formation	Oil BBL/Day	Oil-Gravity (API)	Gas MCF/Day	Gas-Oil Ratio Cu FT/BBL	Water BBL/Day	Pumpin or Flowing	Initial Shut-In Pressure	Choke Size	Flow Tubing Pressure
Dec 13, 1970	SKINNER-OSWEGO	47	39			10	PUMPING	180		
Oct 09, 2016	OSWEGO	3	39			1	PUMPING	100		

**Completion and Test Data by Producing Formation**

Formation Name: SKINNER

Code: 404SKNR

Class: DRY

**Spacing Orders**

Order No	Unit Size
77847	UNIT

**Perforated Intervals**

From	To
5304	5310

**Acid Volumes**

500 GALLONS 7 1/2%
--------------------

**Fracture Treatments**

There are no Fracture Treatments records to display.
--

Formation Name: OSWEGO

Code: 404OSWG

Class: OIL

**Spacing Orders**

Order No	Unit Size
403591	UNIT

**Perforated Intervals**

From	To
5138	5158

**Acid Volumes**

1,000 GALLONS 15%
-------------------

**Fracture Treatments**

There are no Fracture Treatments records to display.
--

Formation Name: SKINNER-OSWEGO

Code:

Class: DRY

Formation	Top
OSWEGO	5138
SKINNER	5304

Were open hole logs run? No

Date last log run:

Were unusual drilling circumstances encountered? No

Explanation:

**Other Remarks**

SEPTEMBER 20, 2016 REPAIR CASING LEAK WITH 3,500" LINER. CEMENT IN PLACE.

**FOR COMMISSION USE ONLY**

1135841

Status: Accepted

RECEIVED

FEB 02 2017

Form 1002A Rev. 2009

API NO. 083-20223  
 OTC PROD UNIT NO. 043425-0-3  
 083-043425-0-3  
 ORIGINAL 0-3255  
 AMENDED (Reason)

PLEASE TYPE OR USE BLACK INK ONLY NOTE:

Attach copy of original 1002A If recompletion or reentry.

OKLAHOMA CORPORATION COMMISSION  
 Oil & Gas Conservation Division  
 Post Office Box 52000  
 Oklahoma City, Oklahoma 73152-2000  
 Rule 165:10-3-25

OKLAHOMA CORPORATION COMMISSION

casing leak repair with liner?

COMPLETION REPORT

TYPE OF DRILLING OPERATION  
 STRAIGHT HOLE  DIRECTIONAL HOLE  HORIZONTAL HOLE  
 SERVICE WELL

SPUD DATE 10-30-70  
 DRLG FINISHED DATE 11-13-70

County Logan SEC 31 TWP 18N RGE 02W

DATE OF WELL COMPLETION 11-28-70

LEASE NAME NW Lawrie Oswego Unit WELL NO. 27-1

1st PROD DATE 12-13-70

SE 1/4 NW 1/4 SE 1/4 NE 1/4 FSL OF 1/4 SEC 732 FWL OF 1/4 SEC 1888

RECOMP DATE 09-20-16

ELEVATION 932 Ground 923  
 OPERATOR NAME C. C. McMillin & Co., Inc. OTC/OCC OPERATOR NO. 14594

ADDRESS PO Box 546  
 CITY Guthrie STATE OK ZIP 73044

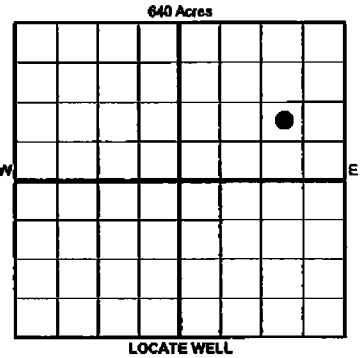

COMPLETION TYPE  
 SINGLE ZONE  
 MULTIPLE ZONE  
 COMMINGLED  
 LOCATION EXCEPTION ORDER NO. na  
 INCREASED DENSITY ORDER NO. na

CASING & CEMENT (Form 1002C must be attached)

TYPE	SIZE	WEIGHT	GRADE	FEET	PSI	SAX	TOP OF CMT	
CONDUCTOR								
SURFACE	8.825	32#	J-55	403		315	GL	
INTERMEDIATE								
PRODUCTION	4.5	10.5#	J-55	5373		140	5063'	
LINER	3.5	9.3#	N-80	5091 - surface		180	2176'	
							TOTAL DEPTH	5,373

PACKER @ \_\_\_\_\_ BRAND & TYPE \_\_\_\_\_ PLUG @ 5300' TYPE CIBP PLUG @ \_\_\_\_\_ TYPE \_\_\_\_\_  
 PACKER @ \_\_\_\_\_ BRAND & TYPE \_\_\_\_\_ PLUG @ \_\_\_\_\_ TYPE \_\_\_\_\_ PLUG @ \_\_\_\_\_ TYPE \_\_\_\_\_

COMPLETION & TEST DATA BY PRODUCING FORMATION

FORMATION	Skinner	Oswego				
SPACING & SPACING ORDER NUMBER	77847	403591				
CLASS: Oil, Gas, Dry, Inj, Disp, Comm Disp, Svc	Dry Air Phase	oil				
PERFORATED INTERVALS	5304'-5310'	5138'-5158'				
ACID/VOLUME	500 gal 7 1/2%	1000 gal 15%				
FRACTURE TREATMENT (Fluids/Prop Amounts)	na	na				

Min Gas Allowable (165:10-17-7) OR  Oil Allowable (165:10-13-3)  
 Gas Purchaser/Measurer Eason Gas  
 First Sales Date 12/13/1970

INITIAL TEST DATA

INITIAL TEST DATE	12/13/1970	10/9/2016			
OIL-BBL/DAY	47	3			
OIL-GRAVITY (API)	39	39			
GAS-MCF/DAY	slight	slight			
GAS-OIL RATIO CU FT/BBL	0	0			
WATER-BBL/DAY	10	1			
PUMPING OR FLOWING	pumping	pumping			
INITIAL SHUT-IN PRESSURE	180	100			
CHOKE SIZE	na	na			
FLOW TUBING PRESSURE	na	na			

AS SUBMITTED

A record of the formations drilled through, and pertinent remarks are presented on the reverse. I declare that I have knowledge of the contents of this report and am authorized by my organization to make this report, which was prepared by me or under my supervision and direction, with the data and facts stated herein to be true, correct, and complete to the best of my knowledge and belief.

Signature: Calvin R. Mays, President  
 Address: PO Box 546, Guthrie, OK 73044  
 Date: 12/21/2016  
 Phone Number: 405-282-3637  
 Email Address: jennifer@maysoilfieldservices.com

