

Oklahoma Corporation Commission
Oil & Gas Conservation Division
Post Office Box 52000
Oklahoma City, Oklahoma 73152-2000
Rule 165: 10-3-25

Form 1002A

API No.: 35049250730000

Completion Report

Spud Date: July 26, 2016

OTC Prod. Unit No.:

Drilling Finished Date: August 04, 2016

1st Prod Date:

Completion Date: December 14, 2016

Drill Type: STRAIGHT HOLE

Well Name: WISE 2

Purchaser/Measurer:

Location: GARVIN 33 3N 3E
C NW NW
1980 FSL 660 FWL of 1/4 SEC
Derrick Elevation: 1015 Ground Elevation: 1010

First Sales Date:

Operator: VALLEY PETROL CONSULTING INC 23160

1117 N ELM ST
DENTON, TX 76201-2938

Completion Type	
X	Single Zone
	Multiple Zone
	Commingled

Location Exception	
Order No	
There are no Location Exception records to display.	

Increased Density	
Order No	
There are no Increased Density records to display.	

Casing and Cement							
Type	Size	Weight	Grade	Feet	PSI	SAX	Top of CMT
SURFACE	8 5/8	24	J-55	422		200	SURFACE
PRODUCTION	5 1/2	15.5	J-55	2026		225	760

Liner								
Type	Size	Weight	Grade	Length	PSI	SAX	Top Depth	Bottom Depth
There are no Liner records to display.								

Total Depth: 2733

Packer	
Depth	Brand & Type
There are no Packer records to display.	

Plug	
Depth	Plug Type
There are no Plug records to display.	

Initial Test Data										
Test Date	Formation	Oil BBL/Day	Oil-Gravity (API)	Gas MCF/Day	Gas-Oil Ratio Cu FT/BBL	Water BBL/Day	Pumpin or Flowing	Initial Shut-In Pressure	Choke Size	Flow Tubing Pressure
There are no Initial Data records to display.										

Completion and Test Data by Producing Formation			
Formation Name: HOXBAR		Code: 405HXBR	Class: DRY
Spacing Orders		Perforated Intervals	
Order No	Unit Size	From	To
634905	40	1411	1532
Acid Volumes		Fracture Treatments	
750 GALLONS		110 BARRELS, 3,000 POUNDS	

Formation	Top
CISCO	1050
HOXBAR	1400
SIMPSON	1590
ARBUCKLE	2270

Were open hole logs run? Yes
Date last log run: August 04, 2016

Were unusual drilling circumstances encountered? No
Explanation:

Other Remarks
OCC - PER OPERATOR, WELL CAPABLE OF MAKING 50,000 CFGPD NO PIPELINE.

FOR COMMISSION USE ONLY	
Status: Accepted	1135788

Per Dale Lowery
049-25073

API NO. 049-25073
OTC PROD.
UNIT NO.

PLEASE TYPE OR USE BLACK INK ONLY
NOTE:
Attach copy of original 1002A if recompletion or reentry.

OKLAHOMA CORPORATION COMMISSION
Oil & Gas Conservation Division
Post Office Box 52000
Oklahoma City, Oklahoma 73152-2000
Rule 165:10-3-25

RECEIVED

JAN 26 2017

OKLAHOMA CORPORATION COMMISSION

☒ ORIGINAL
☐ AMENDED (Reason)

TYPE OF DRILLING OPERATION

☒ STRAIGHT HOLE ☐ DIRECTIONAL HOLE ☐ HORIZONTAL HOLE
☐ SERVICE WELL

If directional or horizontal, see reverse for bottom hole location.

COUNTY Garvin SEC 33 TWP 3N RGE 3E
LEASE NAME Wise WELL NO. 2
1/4 NW 1/4 NW 1/4 FSL 1980 FWL OF 1/4 SEC 660
ELEVATION Derrick FL 1015 Ground 1010 Latitude (if known)
Longitude (if known)
OPERATOR NAME Valley Petrol Consulting, LLC OTC/OCC OPERATOR NO. 23160
ADDRESS 1117 N Elm St.
CITY Denton STATE Texas ZIP 76201

SPUD DATE 7/26/2016
DRLG FINISHED DATE 8/4/2016
DATE OF WELL COMPLETION 12/14/2016
1st PROD DATE
RECOMP DATE

640 Acres
LOCATE WELL

COMPLETION TYPE

☒ SINGLE ZONE
☐ MULTIPLE ZONE
Application Date
COMINGLED
Application Date
LOCATION EXCEPTION ORDER NO.
INCREASED DENSITY ORDER NO.

CASING & CEMENT (Form 1002C must be attached)

TYPE	SIZE	WEIGHT	GRADE	FEET	PSI	SAX	TOP OF CMT
CONDUCTOR							
SURFACE	8-5/8"	24	J55	422		200	surface
INTERMEDIATE							
PRODUCTION	5-1/2"	15.5	J55	2026		225	760
LINER							
TOTAL DEPTH							2,733

PACKER @ BRAND & TYPE PLUG @ TYPE PLUG @ TYPE
PACKER @ BRAND & TYPE PLUG @ TYPE PLUG @ TYPE

COMPLETION & TEST DATA BY PRODUCING FORMATION

FORMATION (Dewey) Hoxbar
SPACING & SPACING 634905 (40)
ORDER NUMBER
CLASS: Oil, Gas, Dry, Inj.
Disp. Comm Disp. Svc
1411' - 1532'
PERFORATED INTERVALS
ACID/VOLUME 750 gal
FRACTURE TREATMENT (Fluids/Prop Amounts) 110 bbl & 3,000#

INITIAL TEST DATA

INITIAL TEST DATE
OIL-BBL/DAY
OIL-GRAVITY (API)
GAS-MCF/DAY 50000/day
GAS-OIL RATIO CU FT/BBL
WATER-BBL/DAY
PUMPING OR FLOWING pumping
INITIAL SHUT-IN PRESSURE
CHOKE SIZE
FLOW TUBING PRESSURE

AS SUBMITTED

A record of the formations drilled through, and pertinent remarks are presented on the reverse. I declare that I have knowledge of the contents of this report and am authorized by my organization to make this report, which was prepared by me or under my supervision and direction, with the data and facts stated herein to be true, correct, and complete to the best of my knowledge and belief.
SIGNATURE DATE 1-26-2017
ADDRESS 3020 Am 1630 CITY Denton STATE Tx ZIP 76201
NAME (PRINT OR TYPE) Jeff Schubert PHONE NUMBER 940-387-6300
EMAIL ADDRESS Upoperating@yahoo.com

PLEASE TYPE OR USE BLACK INK ONLY

FORMATION RECORD

Give formation names and tops, if available, or descriptions and thickness of formations drilled through. Show intervals cored or drillstem tested.

NAMES OF FORMATIONS	TOP
Cisco	1,050
Hoxbar	1,400
Simpson	1590
Arbuckle	2,270

LEASE NAME Wise WELL NO. 2

FOR COMMISSION USE ONLY	
ITD on file <input type="checkbox"/> YES <input type="checkbox"/> NO	
APPROVED _____	DISAPPROVED _____
2) Reject Codes	

Were open hole logs run? X yes no

Date Last log was run 8/4/2016

Was CO₂ encountered? yes X no at what depths?

Was H₂S encountered? yes X no at what depths?

Were unusual drilling circumstances encountered? yes X no

If yes, briefly explain below:

Other remarks:

OCC - Per operator well capable of making 50,000 CFGPD no pipeline

640 Acres

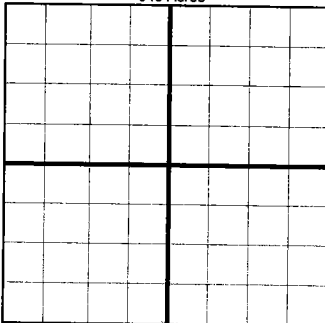

If more than three drainholes are proposed, attach a separate sheet indicating the necessary information.

Direction must be stated in degrees azimuth.

Please note, the horizontal drainhole and its end point must be located within the boundaries of the lease or spacing unit.

Directional surveys are required for all drainholes and directional wells.

640 Acres

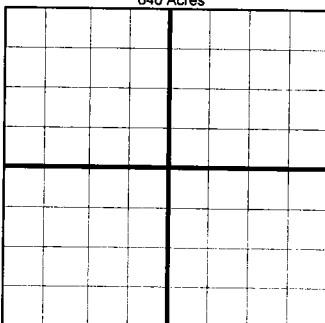

BOTTOM HOLE LOCATION FOR DIRECTIONAL HOLE

SEC	TWP	RGE	COUNTY
Spot Location			
1/4	1/4	1/4	1/4
Measured Total Depth		True Vertical Depth	Feet From 1/4 Sec Lines FSL FWL
BHL From Lease, Unit, or Property Line:			

BOTTOM HOLE LOCATION FOR HORIZONTAL HOLE: (LATERALS)

SEC	TWP	RGE	COUNTY
Spot Location			
1/4	1/4	1/4	1/4
Depth of Deviation	Radius of Turn	Direction	Total Length
Measured Total Depth	True Vertical Depth	BHL From Lease, Unit, or Property Line:	

LATERAL #2

SEC	TWP	RGE	COUNTY
Spot Location			
1/4	1/4	1/4	1/4
Depth of Deviation	Radius of Turn	Direction	Total Length
Measured Total Depth	True Vertical Depth	BHL From Lease, Unit, or Property Line:	

LATERAL #3

SEC	TWP	RGE	COUNTY
Spot Location			
1/4	1/4	1/4	1/4
Depth of Deviation	Radius of Turn	Direction	Total Length
Measured Total Depth	True Vertical Depth	BHL From Lease, Unit, or Property Line:	