

OKLAHOMA CORPORATION COMMISSION
OIL & GAS CONSERVATION DIVISION
P.O. BOX 52000
OKLAHOMA CITY, OK 73152-2000
(Rule 165:10-3-1)

API NUMBER: 063 24646

Approval Date: 02/14/2017
Expiration Date: 08/14/2017

Horizontal Hole Oil & Gas

PERMIT TO DRILL

WELL LOCATION: Sec: 34 Twp: 7N Rge: 10E County: HUGHES
SPOT LOCATION: NE SE SE SE FEET FROM QUARTER: FROM SOUTH FROM EAST
SECTION LINES: 503 289

Lease Name: LETTY Well No: 1-34/27H Well will be 289 feet from nearest unit or lease boundary.
Operator Name: TRINITY OPERATING (USG) LLC Telephone: 7133741573 OTC/OCC Number: 23879 0

TRINITY OPERATING (USG) LLC
601 TRAVIS ST STE 1900
HOUSTON, TX 77002-3253

GEORGE R. ECKLES JR.
P.O. BOX 510
HOLDENVILLE OK 74848

Formation(s) (Permit Valid for Listed Formations Only):

Name	Depth	Name	Depth
1 WOODFORD	5350	6	
2		7	
3		8	
4		9	
5		10	

Spacing Orders: 630886
647111
626818

Location Exception Orders:

Increased Density Orders:

Pending CD Numbers: 201700532
201700533

Special Orders:

Total Depth: 11729 Ground Elevation: 811 **Surface Casing: 350** Depth to base of Treatable Water-Bearing FM: 230

Under Federal Jurisdiction: No Fresh Water Supply Well Drilled: No Surface Water used to Drill: No

PIT 1 INFORMATION

Type of Pit System: ON SITE
Type of Mud System: AIR

Is depth to top of ground water greater than 10ft below base of pit? Y

Within 1 mile of municipal water well? N

Wellhead Protection Area? N

Pit is located in a Hydrologically Sensitive Area.

Category of Pit: 4

Liner not required for Category: 4

Pit Location is BED AQUIFER

Pit Location Formation: CALVIN

Mud System Change to Water-Based or Oil-Based Mud Requires an Amended Intent (Form 1000).

Approved Method for disposal of Drilling Fluids:

A. Evaporation/dewater and backfilling of reserve pit.

E. Haul to Commercial pit facility; Sec. 19 Twn. 8N Rng. 5E Cnty. 125 Order No: 274874

H. SEE MEMO

This permit does not address the right of entry or settlement of surface damages.
The duration of this permit is SIX MONTHS, except as otherwise provided by Rule 165: 10-3-1.
Rule 165: 10-3-4 (c) (7) (e) - The Operator shall give 24 Hours notice by telephone to the appropriate District Office of the Conservation Division as to when Surface Casing will be run.

PIT 2 INFORMATION

Type of Pit System: ON SITE
Type of Mud System: WATER BASED
Chlorides Max: 8000 Average: 5000
Is depth to top of ground water greater than 10ft below base of pit? Y
Within 1 mile of municipal water well? N
Wellhead Protection Area? N
Pit is located in a Hydrologically Sensitive Area.

Category of Pit: 1B
Liner required for Category: 1B
Pit Location is BED AQUIFER
Pit Location Formation: CALVIN

PIT 3 INFORMATION

Type of Pit System: ON SITE
Type of Mud System: OIL BASED
Chlorides Max: 300000 Average: 200000
Is depth to top of ground water greater than 10ft below base of pit? Y
Within 1 mile of municipal water well? N
Wellhead Protection Area? N
Pit is located in a Hydrologically Sensitive Area.

Category of Pit: 3
Liner required for Category: 3
Pit Location is BED AQUIFER
Pit Location Formation: CALVIN

HORIZONTAL HOLE 1

Sec 27 Twp 7N Rge 10E County HUGHES
Spot Location of End Point: SW NE SE SE
Feet From: SOUTH 1/4 Section Line: 900
Feet From: EAST 1/4 Section Line: 578
Depth of Deviation: 5017
Radius of Turn: 477
Direction: 358
Total Length: 5963
Measured Total Depth: 11729
True Vertical Depth: 5350
End Point Location from Lease,
Unit, or Property Line: 578

Notes:

Table with 2 columns: Category, Description. Contains notes about hydraulic fracturing requirements and pit construction details.

This permit does not address the right of entry or settlement of surface damages.
The duration of this permit is SIX MONTHS, except as otherwise provided by Rule 165: 10-3-1.
Rule 165: 10-3-4 (c) (7) (e) - The Operator shall give 24 Hours notice by telephone to the appropriate District Office of the Conservation Division as to when Surface Casing will be run.

Category	Description
PENDING CD - 201700532	<p>2/14/2017 - G75 - (I.O.) 34 & 27-7N-10E EST MULTIUNIT HORIZONTAL WELL X626818 WDFD, OTHERS 34-7N-10E X630886 WDFD, OTHERS 27-7N-10E ** 85.037% 34-7N-10E 14.963% 27-7N-10E NO OP. NAMED REC 2-13-2017 (MCKEOWN)</p> <p>** S/B X630886/647111 WDFD, OTHERS 27-7N-10E; TO BE CORRECTED IN ORDER SUBMITTED TO OCC FOR REVIEW PER ATTORNEY FOR OPERATOR</p>
PENDING CD - 201700533	<p>2/14/2017 - G75 - (I.O.) 34 & 27-7N-10E X626818 WDFD, OTHERS 34-7N-10E X630886 WDFD, OTHERS 27-7N-10E ** COMPL. INT. (34-7N-10E) NCT 165' FSL, NCT 0' FNL, NCT 330' FEL COMPL. INT. (27-7N-10E) NCT 0' FSL, NCT 1100' FSL, NCT 330' FEL NO OP. NAMED REC 2-13-2017 (MCKEOWN)</p> <p>** S/B X630886/647111 WDFD, OTHERS 27-7N-10E; TO BE CORRECTED IN ORDER SUBMITTED TO OCC FOR REVIEW PER ATTORNEY FOR OPERATOR</p>
SPACING - 626818	<p>2/14/2017 - G75 - (640)(HOR) 34-7N-10E EXT 624105 WDFD, OTHERS COMPL. INT. NLT 165' FNL & FSL, NLT 330' FEL & FWL</p>
SPACING - 630886	<p>2/13/2017 - G75 - (640)(HOR) 27-7N-10E VAC OTHERS EXT 626818 WDFD, OTHERS COMPL. INT. NLT 165' FNL & FSL, NLT 330' FEL & FWL</p>
SPACING - 647111	<p>2/13/2017 - G75 - MOD 630886 TO VAC 519790 WDFD NW4 27-7N-10E</p>

This permit does not address the right of entry or settlement of surface damages.
The duration of this permit is SIX MONTHS, except as otherwise provided by Rule 165: 10-3-1.
Rule 165: 10-3-4 (c) (7) (e) - The Operator shall give 24 Hours notice by telephone to the appropriate District Office of the Conservation Division as to when Surface Casing will be run.



Well Location Plat

S.H.L. Sec. 34-7N-10E I.M.
B.H.L. Sec. 27-7N-10E I.M.

Operator: TRINITY OPERATING
Lease Name and No. : LETTY #1-34/27H
Footage : 503' FSL - 289' FEL PAD ELEVATION : 811' Good Site? YES
Section: 34 Township: 7N Range: 10E I.M.
County : Hughes State of Oklahoma
Alternate Loc.: N/A
Terrain at Loc. : Location fell existing Pad.

API 063-24646

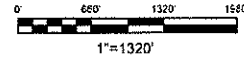

Accessibility : From the North.
Directions : From the town of Horntown, OK, go 4.0 miles South on "US Highway 270/75", then 1.0 mile East on "EW 137 Road" to the Southeast Corner of Section 34-7N-10E.

GPS DATUM
NAD - 27
OK SOUTH ZONE

Conductor Pipe:
Lat: 35°01'48.36"N
Lon: 96°13'50.23"W
X: 2529704
Y: 622125

Landing Point:
Lat: 35°01'45.78"N
Lon: 96°13'53.72"W
X: 2529420
Y: 621859

Bottom Hole Loc.:
Lat: 35°02'44.65"N
Lon: 96°13'53.51"W
X: 2529333
Y: 627810

Quarter Section distances may be assumed from a Government Survey Plat or assumed at a proportionate distance from opposing section corners, or occupation thereof, and may not have been measured on-the-ground, and further, does not represent a true boundary survey.

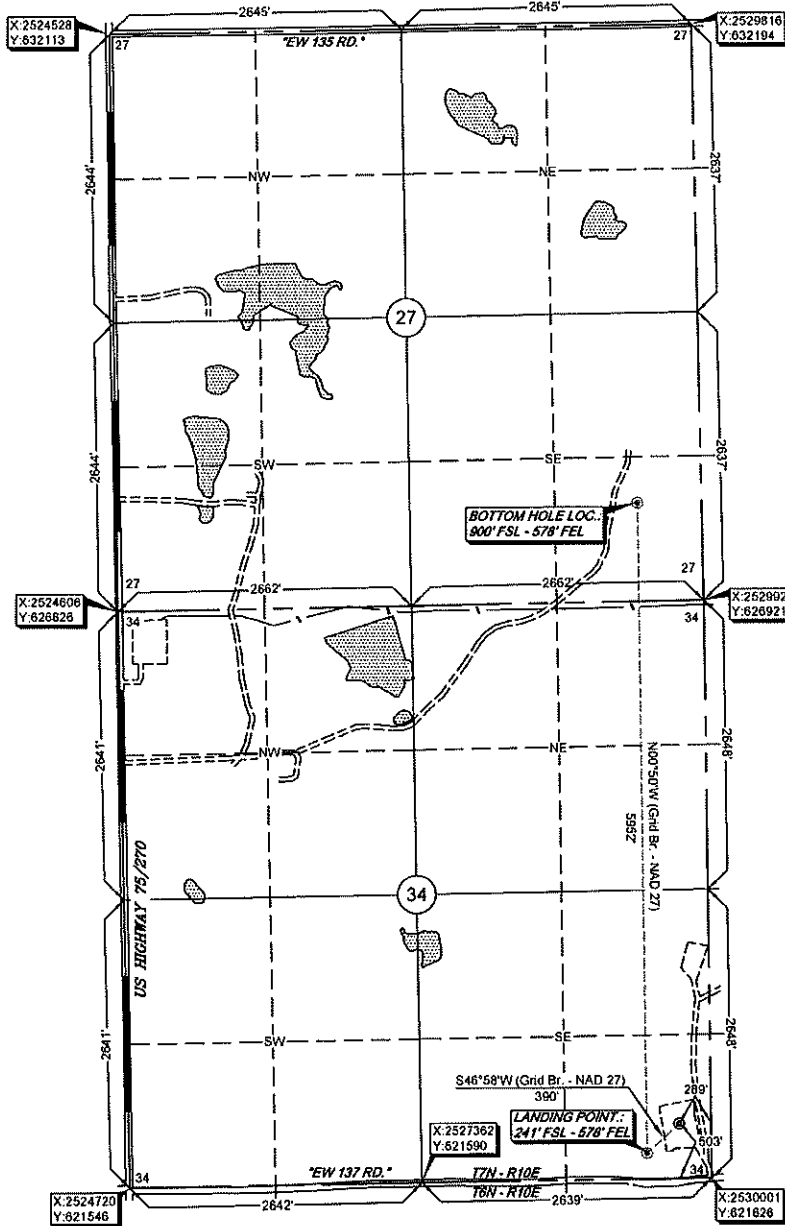

Please note that this location was staked on the ground under the supervision of a Licensed Professional Land Surveyor, but the accuracy of this survey is not guaranteed. Please contact Arkoma Surveying and Mapping promptly if any inconsistency is determined. GPS data is observed from RTK - GPS.

NOTE: X and Y data shown hereon for Section Corners may NOT have been surveyed on-the-ground, and further, does NOT represent a true Boundary Survey.

survey and plat by,
Arkoma Surveying and Mapping, PLLC
P.O. Box 238 Wilburton, OK 74578
Ph. 918-465-5711 Fax 918-465-5030
Certificate of Authorization No. 5348
Expires June 30, 2018

Certification:
This is to certify that this Well Location Plat represents the results of a survey made on the ground performed under the supervision of the undersigned.

Invoice # 4397-A-B
Date Staked : 01/09/17 By: H.S.
Date Drawn : 01/09/17 By: J.H.
Added L.P. & BHL : 02/08/17 By: R.S.

LANCE G. MATHIS 02/09/17
OK LPLS 1664

