

Oklahoma Corporation Commission
Oil & Gas Conservation Division
Post Office Box 52000
Oklahoma City, Oklahoma 73152-2000
Rule 165: 10-3-25

Form 1002A

API No.: 35003232280001

Completion Report

Spud Date: August 01, 2015

OTC Prod. Unit No.: 003-218254

Drilling Finished Date: August 11, 2015

1st Prod Date: December 20, 2016

Amended

Completion Date: December 08, 2016

Amend Reason: SHOW COMPLETION

Drill Type: HORIZONTAL HOLE

Min Gas Allowable: Yes

Well Name: BARBARA ANN 28-27-12 2H

Purchaser/Measurer: CHESAPEAKE OPERATING LLC

Location: ALFALFA 28 27N 12W
SW SE SW SE
245 FSL 1835 FEL of 1/4 SEC
Derrick Elevation: 1318 Ground Elevation: 1296

First Sales Date: 12/20/2016

Operator: CHESAPEAKE OPERATING LLC 17441
PO BOX 18496
6100 N WESTERN AVE
OKLAHOMA CITY, OK 73154-0496

Completion Type		Location Exception		Increased Density	
X	Single Zone	Order No		Order No	
	Multiple Zone	639985		639902	
	Commingled				

Casing and Cement							
Type	Size	Weight	Grade	Feet	PSI	SAX	Top of CMT
SURFACE	9 5/8	36	J-55	1238		431	SURFACE
PRODUCTION	7	26	P-110EC	5898		240	3830

Liner								
Type	Size	Weight	Grade	Length	PSI	SAX	Top Depth	Bottom Depth
LINER	4 1/2	11.6	P-110EC	4926	0	485	5674	10600

Total Depth: 10600

Packer		Plug	
Depth	Brand & Type	Depth	Plug Type
5604	AS-3	There are no Plug records to display.	

Initial Test Data										
Test Date	Formation	Oil BBL/Day	Oil-Gravity (API)	Gas MCF/Day	Gas-Oil Ratio Cu FT/BBL	Water BBL/Day	Pumpin or Flowing	Initial Shut-In Pressure	Choke Size	Flow Tubing Pressure
Jan 07, 2017	MISSISSIPPIAN	84		1835	21845	2426	ARTIFICIA			186

Completion and Test Data by Producing Formation

Formation Name: MISSISSIPPIAN

Code: 359MSSP

Class: GAS

Spacing Orders

Order No	Unit Size
604606	640

Perforated Intervals

From	To
5704	10481

Acid Volumes

6,930 GALLONS HCL ACID

Fracture Treatments

43,833 BARRELS FRAC FLUID, 217,925 POUNDS PROPPANT
--

Formation	Top
MISSISSIPPIAN	5589

Were open hole logs run? No

Date last log run:

Were unusual drilling circumstances encountered? No

Explanation:

Other Remarks

OCC - THIS DOCUMENT IS ACCEPTED BASED ON THE DATA SUBMITTED THE FINAL LOCATION EXCEPTION HAS NOT BEEN ISSUED.

Lateral Holes

Sec: 28 TWP: 27N RGE: 12W County: ALFALFA

NW NE NE NE

176 FNL 659 FEL of 1/4 SEC

Depth of Deviation: 5119 Radius of Turn: 404 Direction: 359 Total Length: 5011

Measured Total Depth: 10600 True Vertical Depth: 5523 End Pt. Location From Release, Unit or Property Line: 176

FOR COMMISSION USE ONLY

1135713

Status: Accepted

Attach copy of original 1002A if recompletion or reentry.

Rule 165:10-3-25

JAN 19 2017

OKLAHOMA CORPORATION
COMMISSION
640 Acres

W E

LOCATE WELL

TYPE	SIZE	WEIGHT	GRADE	FEET	PSI	SAX	TOP
CONDUCTOR							
SURFACE	9 5/8"	36#	J-55	1,238		431	SURFACE
INTERMEDIATE							
PRODUCTION	7"	26#	P-110EC	5,898		240	3,830
LINER	4 1/2"	11.6#	P-110EC	5,674-10,600		485	5,674
G @ TYPE		PLUG @		TYPE		TOTAL DEPTH	10,600

TOTAL DEPTH	10,600
-------------	--------

FORMATION	Mississippian				Reported to FracFocus
SPACING & SPACING	640				
ORDER NUMBER	604606				
CLASS: Oil, Gas, Dry, Inj. Disp, Comm Disp, Svc	Gas				
PERFORATED INTERVALS	5704 - 10,481				
ACID/VOLUME	HCL Acid 6930 Gals				
FRACTURE TREATMENT (Fluids/Prop Amounts)	Frac Fluid 43,833 Bbls Proppant 217,925 lbs				

Reported to FracFocus	
--------------------------	--

INITIAL TEST DATE	1/7/2017					
OIL-BBL/DAY	84					
OIL-GRAVITY (API)						
GAS-MCF/DAY	1,835					
GAS-OIL RATIO CU FT/BBL	21,845					
WATER-BBL/DAY	2426					
PUMPING OR FLOWING	Artificial Lift					
INITIAL SHUT-IN PRESSURE						
CHOKE SIZE						
FLOW TUBING PRESSURE	186					

AS SUBMITTED

A record of the formations drilled through, and pertinent remarks are presented on the reverse. I declare that I have knowledge of the contents of this report and am authorized by my organization to make this report, which was prepared by me or under my supervision and direction, with the data and facts stated herein to be true, correct, and complete to the best of my knowledge and belief.

		Sara Everett, Regulatory Analyst		1/18/2017	405-848-8000
SIGNATURE		NAME (PRINT OR TYPE)		DATE	PHONE NUMBER
P.O. BOX 18496	OKLAHOMA CITY	OK	73154	sara.everett@chk.com	
ADDRESS	CITY	STATE	ZIP	EMAIL ADDRESS	

PLEASE TYPE OR USE BLACK INK ONLY
FORMATION RECORD

Give formation names and tops, if available, or descriptions and thickness of formations drilled through. Show intervals cored or drillstem tested.

LEASE NAME BARBARA ANN 28-27-12

WELL NO. 2H

NAMES OF FORMATIONS	TOP
MISSISSIPPIAN	5,589

FOR COMMISSION USE ONLY	
ITD on file <input type="checkbox"/> YES <input type="checkbox"/> NO	
APPROVED _____	DISAPPROVED _____
2) Reject Codes	

Were open hole logs run?	yes <input type="checkbox"/> no <input checked="" type="checkbox"/>
Date Last log was run	N/A
Was CO ₂ encountered?	yes <input type="checkbox"/> no <input checked="" type="checkbox"/> at what depths?
Was H ₂ S encountered?	yes <input type="checkbox"/> no <input checked="" type="checkbox"/> at what depths?
Were unusual drilling circumstances encountered?	yes <input type="checkbox"/> no <input checked="" type="checkbox"/>
If yes, briefly explain.	

Other remarks:

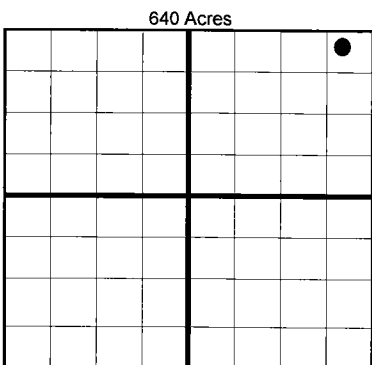

If more than three drainholes are proposed, attach a separate sheet indicating the necessary information.

Direction must be stated in degrees azimuth. Please note, the horizontal drainhole and its end point must be located within the boundaries of the lease or spacing unit.

Directional surveys are required for all drainholes and directional wells.

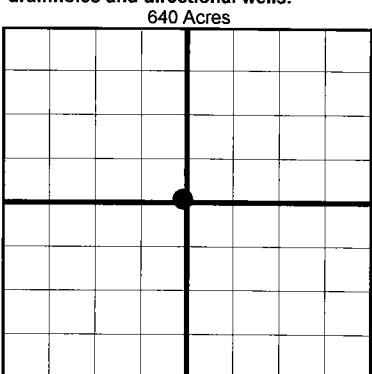

BOTTOM HOLE LOCATION FOR DIRECTIONAL HOLE

SEC	TWP	RGE	COUNTY
Spot Location		Feet From 1/4 Sec Lines	FSL
1/4	1/4	1/4	1/4
Measured Total Depth		True Vertical Depth	BHL From Lease, Unit, or Property Line:

BOTTOM HOLE LOCATION FOR HORIZONTAL HOLE: (LATERALS)

SEC	TWP	RGE	COUNTY
28	27N	12W	ALFALFA
Spot Location		Feet From 1/4 Sec Lines	FSL
NW 1/4	NE 1/4	NE 1/4	NE 1/4
Depth of Deviation		Radius of Turn	Direction
5,119		404	359
Measured Total Depth		True Vertical Depth	Total Length
10,600		5,523	5,011
		BHL From Lease, Unit, or Property Line:	
		176	

LATERAL #2

SEC	TWP	RGE	COUNTY
Spot Location		Feet From 1/4 Sec Lines	FSL
1/4	1/4	1/4	1/4
Depth of Deviation		Radius of Turn	Direction
Measured Total Depth		True Vertical Depth	Total Length
		BHL From Lease, Unit, or Property Line:	

LATERAL #3

SEC	TWP	RGE	COUNTY
Spot Location		Feet From 1/4 Sec Lines	FSL
1/4	1/4	1/4	1/4
Depth of Deviation		Radius of Turn	Direction
Measured Total Depth		True Vertical Depth	Total Length
		BHL From Lease, Unit, or Property Line:	

6709 NORTH CLASSEN BLVD., OKLA. CITY, OKLA. 73116 * LOCAL (405) 843-4847 * OUT OF STATE (800) 654-3219
Certificate of Authorization No. 1293 LS.

Certificate of Authorization No. 1293 LS.

ALFALFA

County, Oklahoma

245' FSL-1835' FEL Section 28 Township 27N Range 12W I.M.



Lease Name: BARBARA ANN 28-27-12

Lease Name: BARBARA ANN 28-27-12 Well No.: 2H

ELEVATION:

1296' Gr. at Level Pad

Topography & Vegetation Loc. fell on level pad, ±200' North of SWD line, ±206' North of power line

Good Drill Site? Yes Reference Stakes or Alternate Location
Stakes Set None

Best Accessibility to Location From South off county road

Distance & Direction

Distance & Direction
from Hwy Jct or Town From Ingersoll, Ok, go ± 5.2 miles West on US. Hwy. 64, then

±1 mile South to the SE Cor. of Sec. 28-T27N-R12W

Invoice # 269175 Date of Drawing: Dec. 19, 2016
241505 Date Staked: Mar. 11, 2015

JP

This information was gathered with a GPS receiver with ± 1 foot Horiz./Vert. accuracy.

DATUM: NAD-27
LAT: 36°47'00.1"N
LONG: 98°29'31.4"W
LAT: 36.783350° N
LONG: 98.492051° W
STATE PLANE
COORDINATES: (US Feet)
ZONE: OK NORTH
X: 1855895.7
Y: 649543.2

AS-DRILLED INFORMATION
FURNISHED BY CHESAPEAKE OPERATING, L.L.C.

