

Oklahoma Corporation Commission  
Oil & Gas Conservation Division  
Post Office Box 52000  
Oklahoma City, Oklahoma 73152-2000  
Rule 165: 10-3-25

Form 1002A

API No.: 35017217920002

**Completion Report**

Spud Date: August 21, 1980

OTC Prod. Unit No.: 017-65990

Drilling Finished Date: September 19, 1980

**Amended**

1st Prod Date: December 17, 1980

Amend Reason: TEMPORARILY ABANDONED STATUS

Completion Date: December 31, 1980

Recomplete Date: December 09, 2016

**Drill Type: STRAIGHT HOLE**

Well Name: BOMHOFF 20-1

Purchaser/Measurer:

Location: CANADIAN 20 12N 7W  
C NW SE  
1980 FSL 660 FWL of 1/4 SEC  
Derrick Elevation: 0 Ground Elevation: 1411

First Sales Date:

Operator: HALCYON NATURAL GAS LLC 19403

6420C N SANTA FE AVE  
OKLAHOMA CITY, OK 73116-9111

Completion Type	
	Single Zone
	Multiple Zone
X	Commingled

Location Exception
Order No
There are no Location Exception records to display.

Increased Density
Order No
305584

Casing and Cement							
Type	Size	Weight	Grade	Feet	PSI	SAX	Top of CMT
CONDUCTOR	16			85			
SURFACE	8 5/8	24	K-55	700	840	450	SURFACE
PRODUCTION	4 1/2	11.6	N + K	11340	3000	900	7400

Liner								
Type	Size	Weight	Grade	Length	PSI	SAX	Top Depth	Bottom Depth
There are no Liner records to display.								

**Total Depth: 11339**

Packer	
Depth	Brand & Type
There are no Packer records to display.	

Plug	
Depth	Plug Type
10850	CIBP

Initial Test Data
-------------------

Test Date	Formation	Oil BBL/Day	Oil-Gravity (API)	Gas MCF/Day	Gas-Oil Ratio Cu FT/BBL	Water BBL/Day	Pumpin or Flowing	Initial Shut- In Pressure	Choke Size	Flow Tubing Pressure
-----------	-----------	----------------	----------------------	----------------	----------------------------	------------------	----------------------	---------------------------------	---------------	-------------------------

There are no Initial Data records to display.

Completion and Test Data by Producing Formation

Formation Name: HUNTONCode: 269HNTNClass: TA

Spacing Orders		Perforated Intervals	
Order No	Unit Size	From	To
147489	640	10312	10568
Acid Volumes		Fracture Treatments	
5,000 GALLONS 7 1/2% NE		3,993 BARRELS 1/2% KCL SLICK	

Formation Name: MISSISSIPPIANCode: 359MSSPClass: TA

Spacing Orders		Perforated Intervals	
Order No	Unit Size	From	To
147489	640	9924	9992
Acid Volumes		Fracture Treatments	
5,000 GALLONS 7 1/2% NE		3,993 BARRELS 1/2% KCL SLICK	

Formation	Top
-----------	-----

Were open hole logs run? No  
Date last log run:  
  
Were unusual drilling circumstances encountered? No  
Explanation:

Other Remarks
There are no Other Remarks.

FOR COMMISSION USE ONLY	
Status: Accepted	1135705

# AS SUBMITTED

API NO.  
017 21792X  
OTC PROD. UNIT NO.  
017-65990

Rule 185-10-3-25  
ORIGINAL

X AMENDED

Reason Amended: ~~Simpson depleted~~  
Applying for T&A Status

## COMPLETION REPORT OKLAHOMA CORPORATION COMMISSION

Oil & Gas Conservation Division  
Post Office Box 52000-2000

Oklahoma City, Oklahoma 73152-2000

Form 1002A  
Rev. 1996

269HNTN 359MSSP  
COMPLETION & TEST DATA BY PRODUCING FORMATION

PLEASE TYPE OR USE BLACK INK ONLY

NOTE: Attach copy of original 1002A if recompletion or reentry

TYPE OF DRILLING OPERATION

X STRAIGHT HOLE \_\_\_\_\_ DIRECTIONAL HOLE \_\_\_\_\_ HORIZONTAL HOLE

If directional or horizontal, see reverse for bottom hole location.

COUNTY Canadian	SEC 20	TWP 12N	RGE 7W
LEASE NAME Bomhoff		WELL NO. 20-1	
SHL C NW/4, SE/4		1980 FSL 660 FWL OF 1/4 SEC	
ELEVATION Derrick Ft		SPUD DATE 4/2/1982 8-21-80	
DRLG FINISHED 9/19 1980		WELL COMPLETION 12-31-80	
1ST PROD DATE 12/17 1980		RECOMP DATE 12-9-2016	

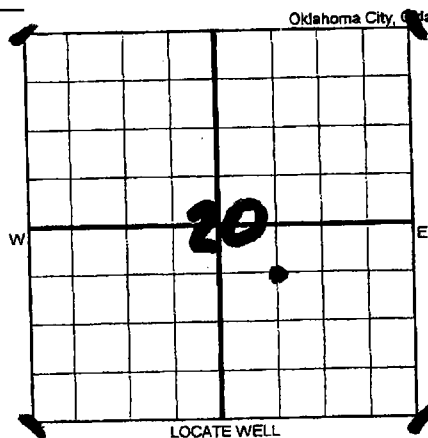

OTC/OCC OPERATOR NO.  
1 9 4 0 3

OPERATOR NAME  
Halcyon Natural Gas, LLC.

ADDRESS  
6420 N. Santa Fe Ave.

CITY  
Oklahoma City

STATE  
OK

ZIP  
7 3 1 1 6

### COMPLETION TYPE

<input type="checkbox"/> SINGLE ZONE
<input type="checkbox"/> MULTIPLE ZONE ORDER NO.
X <input type="checkbox"/> COMMINGLED ORDER NO. Unknown
<input type="checkbox"/> LOCATION EXCEPTION ORDER NO.
<input type="checkbox"/> INCREASED DENSITY ORDER NO. 305584
<input type="checkbox"/> PENALTY 14

### OIL OR GAS ZONES

FORMATIONS	TOP	BOTTOM
Hunton	10 312	10 568
Mississippian	9 932	9 976
Simpson Bridge plug	11 060	TD

### CASING & CEMENT (Form 1002C must be attached)

TYPE	SIZE	WEIGHT	GRADE	FEET	PSI	SAX	FILLUP	TOP
Conductor	18			85				
Surface	8 5/8	24#	K-55	700	8 40	450		Surf.
Intermediate								
Production	4 1/2	11.6#	N+K	11 340	3000	900		7400
Liner								
TOTAL DEPTH								11,339

FORMATION	Hunton	Mississippian
SPACING & SPACING ORDER NUMBER	640: 147489	640: 147489
CLASS: Oil, Gas, Dry, Inj, Disp, Comm Disp	Gas TA	Gas TA
PERFORATED INTERVALS	10,312-568	9924-92
ACID/VOLUME	7 1/2% NE/5000g	Combined
Fracture Treated?	Yes	Yes
Fluids Amounts	3993 bbls 1/2% KCL Slick	3993 bbls 1/2% KCL Slick

INITIAL TEST DATA	ORIGINAL	NEW
INITIAL TEST DATE	1/18/87	1/18/87
OIL-BBL/DAY	5	Combined
OIL-GRAVITY (API)	N/A	N/A
GAS-MCF/DAY	222	Combined
GAS-OIL RATIO CU FT/BBL	250M	250M+
WATER-BBL/DAY	18	Combined
PUMPING OR FLOWING	FLOWING	FLOWING
INITIAL SHUT-IN PRESSURE	690	690
CHOKE SIZE	21/64ths	21/64ths
FLOW TUBING PRESSURE	120	120

A record of the formations drilled through, and pertinent remarks are presented on the reverse. I declare that I have knowledge of the contents of this report and am authorized by my organization to make this report, which was prepared by me or under my supervision and direction, with the data and facts stated herein to be true, correct, and complete to the best of my knowledge and belief.

SIGNATURE

Gerald D. Neff, Manager  
NAME (PRINT OR TYPE)

6420 N. Santa Fe Ave  
ADDRESS

Oklahoma City OK 73116  
CITY STATE ZIP

DATE 12/6/2016

PHONE NUMBER 405-840-2562

RECEIVED  
JAN 20 2017  
OKLAHOMA CORPORATION  
COMMISSION